



## CITY OF WASILLA

290 E. HERNING AVE.  
WASILLA, ALASKA 99654-7091  
PHONE: (907) 373-9050  
FAX: (907) 373-9085

JH  
Jack

### INFORMATION MEMORANDUM NO. 96-16

From: Mayor Stein  
Date: May 31, 1996  
Subject: Lots 14, 19, 20 and 21 - Wasilla Airport Heights

Mr. and Mrs. Ted Nielson contacted us about the possibility of purchasing Lots 14, 19, 20 and 21 of Wasilla Airport Heights for the cost of the Nelson Avenue road paving assessments. Those assessments are about \$3,000 for each lot or \$12,000 total for the four.

The property was used to receive waste soil material and vegetation from various projects in the 1980's and may not be suitable for building foundations. Fill depths may be as deep as 50 feet.

Public Works and Museum and Recreational Services are investigating the site for possible public uses including green belt, snow storage and source of topsoil.

The Nielsens will be in Wasilla until Friday, May 31 and can be reached through their daughter, Phyllis Bosch, 376-8412.

John C. Stein, Mayor

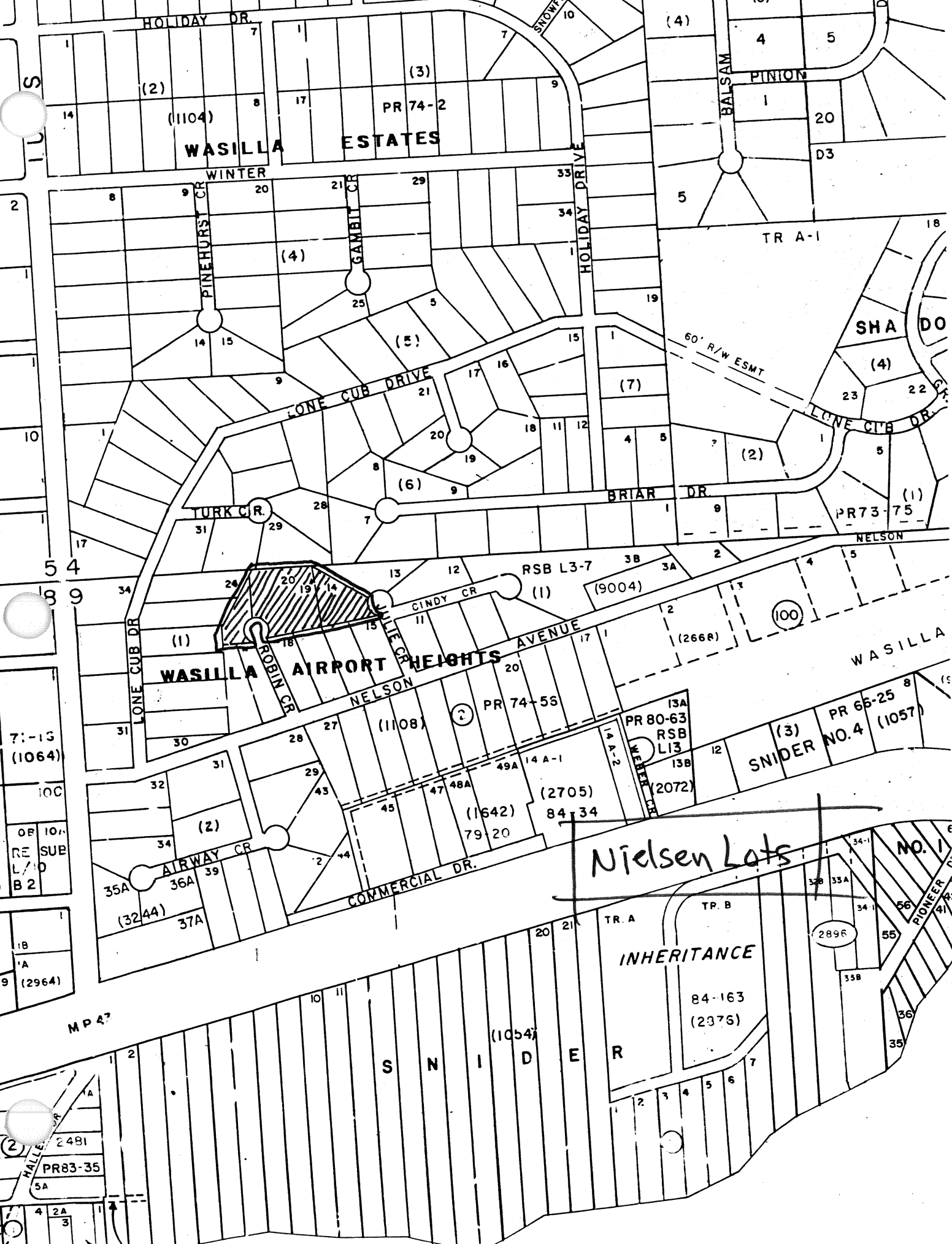

HOLIDAY DR

(2)

(1104)

WASILLA ESTATES

WINTER

PR 74-2

PINION

TR A-1

SHADO

LONE CUB DRIVE

HOLIDAY DRIVE

60' R/W ESMT

LONE CUB DR

TURK CIR

BRIAR DR

PR 73-75

NELSON

RSB L3-7

CINDY CR

AVENUE

WASILLA AIRPORT HEIGHTS

NELSON

PR 74-56

WASILLA

7:13 (1064)

10C

OR 10.1 RE SUB L/10 B 2

1B 1A 9 (2964)

(1)

(1)

(2)

(1108)

(2)

13A PR 80-63 RSB L13 13B (2072)

(3) SNIDER NO. 4 (1057) PR 65-25

35A (3244)

37A

COMMERCIAL DR

(2705) 84 34

Nielsen Lots

INHERITANCE

84-163 (2976)

SNIDER

(1054)

2896

NO. 1

PR 83-35

5A

2A 3