

SUBJECT: GRANT MUSEUM OF ALASKA TRANSPORTATION AND INDUSTRY (MATI) FUNDS TO CONSTRUCT A STAGING AREA ON THEIR PROPERTY

REQUESTED BY: Sarah Palin, Mayor

PREPARED BY: Tim Krug, City Planner

DATE: March 27, 2001

FOR AGENDA OF: April 9, 2001

SUMMARY:

The City of Wasilla has been unable to construct a staging area on tax parcel D2 since the property has not transferred title to the City of Wasilla. This grant expires early this summer. We either need to spend this grant or lose the grant.

The State of Alaska, Department of Natural Resources will allow us to contract with MATI and have them construct a staging area on their property. Their property meets the scope of the grant in that their property is south of the Parks Highway and south of the railroad tracks. MATI is interested in using up to the balance of the existing grant, which is \$10,724.

In accordance with Wasilla Municipal Code chapter 5.24, the Wasilla City Council can grant MATI the balance of grant #CC10795161 to create an additional staging area in Wasilla.

FISCAL IMPACT: X No ___ Yes, amount requested: \$ Fund:

RECOMMENDED ACTION: Grant MATI remaining funds of State of Alaska, Department of Natural Resources grant # CC10795161 to construct a staging area on MATI's property.

Reviewed by: SARAH PALIN, Mayor

- Attachments: 3/21/01 Letter from City
- 3/23/01 Letter from DNR
- 3/27/01 Letter from MATI

Presented to council on 4/9/2001
 Action taken: Approved Denied
 other: _____
 Verified by AK

STATE OF ALASKA

DEPARTMENT OF NATURAL RESOURCES

DIVISION OF PARKS AND OUTDOOR RECREATION

TONY KNOWLES, GOVERNOR

550 W. 7th Avenue, Suite 1390
ANCHORAGE, ALASKA 99501-3561
PHONE: 907-269-8700
FAX: 907-269-8907

March 23, 2001

Tim Krug, City Planner
290 E. Herning Ave.
Wasilla, AK 99654-7091

RECEIVED

MAR 27 2001

Planning Department

RE: Recreational Trails Grant #10795161 – Staging Area.

Dear Tim:

Your request to revise the location and method of accomplishing the project as presented in your March 21st letter is approved. Thank you for sending the map showing the new site.

Please provide documentation from the landowner that public access will be assured for the required 5 years on private land and 10 years if any of the project is on public land.

Good luck with the remainder of your project.

Sincerely,

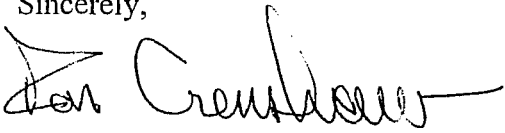

Ron Crenshaw, Chief
Marine Recreation & Trails



CITY OF WASILLA

290 E Herning Avenue
Wasilla, AK 99654-7091
Phone: (907) 373-9050
Fax: (907) 373-9092

March 21, 2001

Ron Crenshaw
Alaska Department of Natural Resources
Division of Parks and Outdoor Recreation
550 W 7th Avenue, Suite 1380
Anchorage, AK 99501

RE: Staging Area – CC10795161

Dear Ron,

We are still in litigation on tax parcel D2 where we originally planned on constructing this proposed staging area. The court ruled in our favor but the case is being appealed.

The Museum of Alaska Transportation and Industry (MATI) a non-profit corporation has indicated they would like to build this staging area on their property and allow public use for five years. Their property is south of the Parks Highway and south of the railroad tracks. Trail users would be capable of crossing municipal owned land to trails that border Lucille Creek and that are used by the Iditarod and Iron Dog.

The City of Wasilla still has additional funding to build the intended staging area at the originally proposed location, once we have proper title to the property. This intended location also has potential future funding through the State Transportation Improvement Program (STIP). With the addition of MATI's staging area this will increase the required demand for parking spaces to facilitate the regular trail use and special events.

MATI would agree that the general public could use this staging area for a period of five years from the completion. They also recognize that the grant requires an equal or greater amount be matched. MATI owns much of the needed construction equipment and has the volunteers to construct a staging area. They have requested that the rates for their equipment be charged at the industry standard rates and that the volunteer labor be recognized at Davis Bacon rates. This will help them easily accomplish the required match.

Please let us know as soon as possible if this alternate location for a staging area would be acceptable with grant # CC10795161. Please call if you have questions.

Sincerely,

Tim Krug, City Planner

COPY

ADMINISTRATION Phone: (907) 373-9055 Fax: (907) 373-9096	CLERK'S OFFICE Phone: (907) 373-9090 Fax: (907) 373-9092	FINANCE Phone: (907) 373-9070 Fax: (907) 373-9085	LIBRARY Phone: (907) 376-5913 Fax: (907) 376-2347	MUSEUM Phone: (907) 373-9071 Fax: (907) 373-9072
PARKS AND RECREATION Phone: (907) 373-9053 Fax: (907) 373-9092	PLANNING Phone: (907) 373-9094 Fax: (907) 373-9089	POLICE Phone: (907) 373-9077 Fax: (907) 373-9051	PUBLIC WORKS Phone: (907) 373-9095 Fax: (907) 373-9054	

CITY OF WASILLA

2

3

4

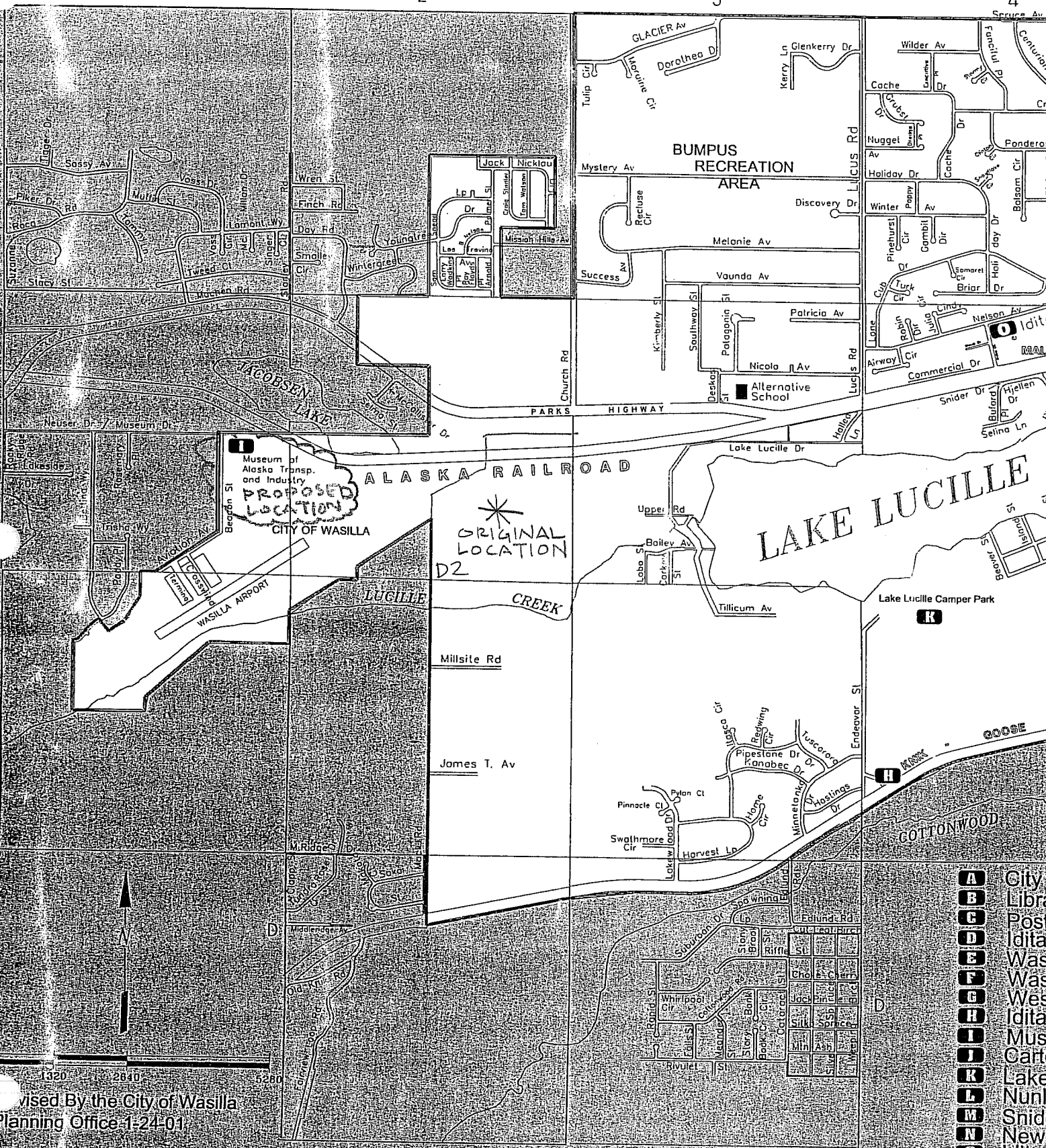

- A** City
- B** Libr
- C** Pos
- D** Idita
- E** Was
- F** Was
- G** Wes
- H** Idita
- I** Mus
- J** Cart
- K** Lake
- L** Nun
- M** Snid
- N** New
- O** Idita
- P** Polic



Museum of Alaska Transportation & Industry

P.O. Box 870646 • Wasilla, AK 99687

Ph: (907) 376-1211 • Fax: (907) 376-3082

March 27, 2001

Sarah Palin, Mayor
City of Wasilla
290 E. Herning Avenue
Wasilla, AK 99654

RE: Staging Area – CC10795161

Dear Honorable Mayor Palin,

Please consider granting the Museum of Alaska Transportation and Industry (MATI) the balance of your Alaska Department of Natural Resources grant CC10795161 which is about to expire.

MATI would like to build this staging area on our property and we will allow public use for five years. Our property is south of the Parks Highway and south of the railroad tracks. Trail users would be capable of crossing municipal owned land to trails that border Lucille Creek and that are used by the Iditarod and Iron Dog.

MATI's staging area will provide additional parking spaces to facilitate the regular trail use and special events. This summer MATI with the Wasilla Chamber of Commerce have plans for a "Transportation Expo and Air Show".

MATI would agree that the general public could use this staging area for a period of five years from the completion. We also recognize that the grant requires an equal or greater amount be matched. MATI owns much of the needed construction equipment and has the volunteers to construct a staging area. We request that the rates for our equipment be charged at the industry standard rates and that the volunteer labor be recognized at Davis Bacon rates. This will help us accomplish the required match.

Sincerely,

A handwritten signature in black ink that reads "Phil Lockwood". The signature is written in a cursive style.

Phil Lockwood, President