

SUBJECT: 1998 Road Bonds/Construction Projects

PREPARED BY: Cindy Roberts, Director Public Works

DATE: 1/6/98

FOR AGENDA OF: January 12, 1998

SUMMARY:

Department of Public Works is in varying stages of development on the following projects. (Cost estimates are not available for all roads).

FISCAL IMPACT: No Yes, amount requested: \$ Fund:

RECOMMENDED ACTION:

Council will be informed as specific projects reach critical stages and approvals are required.

Sarah Palin

Reviewed by: SARAH PALIN, Mayor

- Attachments:
- 1998 Road Bonds/Construction Projects
- 1997 Construction Summary
- Memo

COUNCIL ACTION

Set for public hearing: 1/12/98
 Public hearing: 1/26/98
 Amended as follows: 2/9/98

1	Spruce Avenue (Phase 1-3)	15,000	\$2,000,000	Anticipate MSB dust control funds
2	Weber Drive	900	\$252,000	Figure may be low depending on scope
3	North Country LID	6,000	\$700,000	
4	Susitna Avenue	2,300	\$400,000	Storm drainage included
5	Mystery Avenue	4,000	\$1,600,000	
6	Engineering reserve for summer construction of 1999		\$ 600,000	
TOTAL			\$5,552,000	

Adopted as amended: 2/9/98

APPROVED

DATE: 2/9/98

BY: *K. VanSledright*

1998 Road Bonds / Construction Projects

CIP Projects (funding in place)

Estimates

1. BIKEPATHS

DPW

- a. Nelson / Gray Bark intersection to Lucille
- b. Peck Street Snohomish to Fishhook

\$ 40,000

\$ 40-50,000

STATUS: FY '98 funding in place

2. EAST WESTPOINT DRIVE water / sewer installation

Ak Rim Engineering

\$ 95,000

STATUS: FY '98 funding in place (catalyst: City annexation 3/96)
Preliminary engineering by 1/30/98. Bid documents ready by 3/1/98.

BOND ISSUE and LID PAVING PROJECTS

1. SPRUCE AVENUE

Ak Rim Engineering

\$500,000 to \$900,000

- b. Phase IA continuing west to Lucille

STATUS: Preliminary engineering by 2/15. Option being considered to use "unattached" bike trail design similar to Lucille bikepath and avoid expense of curb and gutter design. This also facilitates using the current road alignment which is not lined in the center of the ROW. The bikepath will be on the north side of Spruce on MSB land. As of 1/19/98, we are still waiting to hear about MSB contribution on (dust control) paving expenses.

2. WEBER DRIVE Parks Highway to Nelson Drive

Denali North

Estimate Pending

STATUS: Replat / Public Use Easement in progress. Discussions held with DOT/PF re: storm drain system coordination and Parks intersection realignment. Property owners (Wendys, Weber, & Johnson) meeting held with DPW 1/6 to coordinate project with adjacent owners. (curb and gutter + bikepath) 900 lf to connect Parks to Nelson.

3. NORTH COUNTRY ESTATES

Paving LID proposed

Denali North

\$881,000

STATUS: Preliminary design completed. Public informational meeting scheduled for Wednesday 1/14. Formal survey of interest will be sent to property owners via registered mail. Public hearings will follow. Total cost of LID estimated \$881,000.

Preliminary estimated cost divided by 67 property owners (if all parcels are assumed to be equal) would result in approximately \$4,5000 assessment per property owner.

4. SUSITNA DRIVE

LID proposed
\$266,000

\$450,000 est. to
lake

STATUS: No new estimates at this time.

Estimates (2/25/93) based on 71 lots. Does not include the last 2000 lf. to Lake Lucille.

The LID was not worked into this process in '93. City's share on Susitna Ave was 66% and 30% on side streets. This would all change to normal LID 66% City share on all paving.

5. EASTERN EXTENSION OF CITY WATER

Estimates Pending

There is interest from commercial developers in extension of the water/sewer utilities in areas which will be affected by the coming Parks Highway up-grades. There may be interest in pushing ahead of major work by DOT/PF.

Revised Road Bond Project Estimates for Construction Seasons 1998-1999

Priority Project	Length (in feet)	Estimated Total Project Cost	Remark
1 Spruce Avenue (Phase 1-3)	15,000	\$2,000,000	Anticipate MSB dust control funds
2 Weber Drive	900	252,000	Figure may be low depending on scope
3 North Country LID	6,000	700,000	
4 Susitna Avenue	2,300	400,000	Storm drainage included
5 Danna Avenue	1,500	300,000	
6 Mystery Avenue	4,000	1,600,000	
7 Engineering reserve for summer construction of 1999		\$ 300,000	
		\$5,552,000	Total

- Church Road South \$3,500,000 estimate
(wetland permit expires 06/16/00)
- Future LID's
 - 1 Recluse/Melanie
 - 2 Winter/Holiday

Recommended Motion: Move to amend CM 98-06 to approve projects 1 - 7 as stated above.

1997 City of Wasilla Construction Summary

File ccrds12.8

1. KGB WATER MAINLINE EXTENSION CIP *Raven Engineering
GCM Construction*

STATUS: Completed on time, within budget. WASI hooked-up. Financial participation requested of WASI, Williwaw Manor, and Chinook Villa.

2. CENTURY PARK SUBDIVISION LID Paving *AK Rim Engineering
Wilder Construction*

STATUS: Completed except for final hydroseed.

CIP Water DPW
Up-grade & MUC purchase

STATUS: MUC Purchase pending APUC approval. Hydrant system in place to be activated following MUC purchase and isolation from previous well.

CIP Sewer DPW
Improvements

STATUS: Installation completed. Water system cost over-runs may be covered by KGB system savings. Additional appropriation will be required to fund sewer portion of Century Park LID and WASI water service line. *

3. GLENWOOD AVENUE CIP Paving *Denali North
Summit Paving*

STATUS: Completed. Final costs pending..

4. WOODCREST SUBDIVISION LID Paving *Denali North
Summit Paving*

STATUS: Completed. Final costs by 12/15/97.

5. PATRICIA AVENUE LID Paving *Ak Rim Engineering
Wilder Construction*

STATUS: Completed. Final costs under negotiation.

6. SPRUCE / FISHHOOK / PECK CIP Paving *Ak Rim Engineering
Intersection
Wilder Construction
Realignment*

STATUS: Completed.

* Council (by resolution 7/97) transferred \$67,000+ from Hallea sewer crossing to CIP sewer construction fund. This was wiped out 8/97 by Finance through ordinance funding CIP Digester and septic tank replacement. Final appropriation request will be made to Council in January.

MEMO

DATE: December 31, 1997
TO: Sarah Palin, Mayor
THRU: Cindy Roberts, PW Director *CR*
FROM: Larry Bridge, Road Superintendent *L*

During our meeting on LID formation on December 30, 1997 you requested public works to investigate the feasibility of an LID project for the Susitna Avenue area on the south side of town.

As I understand it, the original LID formation consisted of Floyd subdivision, Blocks 1 thru 8 and Kennedy Addition, Blocks 2, 3 & 4. This proposal includes Kennedy Addition Blocks 1 thru 14 and Blocks 4 & 5 of Floyd Subdivision.

The roads department continues to hear from the local property owners in that area about the lack of maintenance and dust control. Because of the continuing dust and maintenance problems caused by residential and commercial traffic we propose the following for LID boundaries.

Option 1. Susitna Avenue from Lake Street to Denali Street in its entirety.

Option 2. As specified in option 1 but to include three cross streets, Boundary, Talkeetna and Denali Streets.

REASON: Option 1 - Susitna Avenue west of KGB leads to activity at Carter Park and Lake Lucille boat launch. Although no traffic counts have been done in recent years. it is obvious from the maintenance stand point that traffic use has increased substantially . All utilities are in with the exception of a storm drainage pipeline that would need to be placed before construction. There are no recent soils tests of that area, but several excavations over the past few years indicate good soils.

Susitna Avenue East to Denali Street suggests minor problems from the soils standpoint as well as base utilities and storm drainage to be addressed.

Page 2
Memo
Susitna Ave

The side streets added in option 2 could create some problems such as R-O -W, utilities and drainage. The soil material should be of the same quality as Susitna Avenue. Because of the R-Of -W, some excess materials in the form of overburden may need to be excavated.

I added these streets to the option because of property development as well as the fact that original LID shows good support for the project.

E PARKS HIGHWAY ALASKA RAILROAD

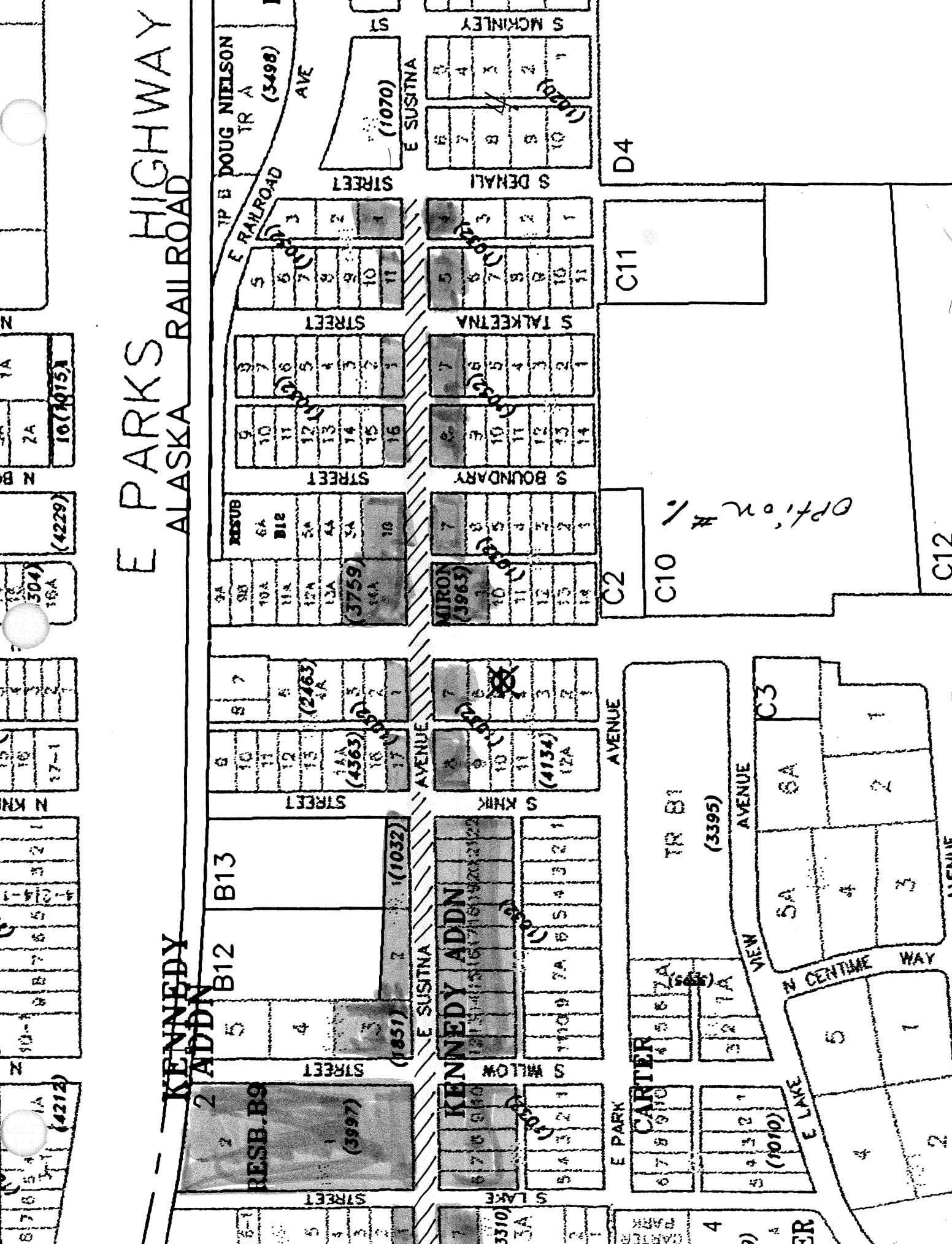

KENNEDY ADDN

B12

B13

B14

B15

B16

B17

B18

B19

B20

B21

B22

B23

B24

B25

B26

B27

B28

B29

B30

B31

B32

B33

B34

B35

B36

B37

B38

B39

B40

B41

B42

B43

B44

B45

B46

B47

B48

B49

B50

B51

B52

B53

B54

B55

B56

B57

B58

B59

B60

B61

B62

B63

B64

B65

B66

B67

B68

B69

B70

B71

B72

B73

B74

B75

B76

B77

B78

B79

B80

B81

B82

B83

B84

B85

B86

B87

B88

B89

B90

B91

B92

B93

B94

B95

B96

B97

B98

B99

B100

B101

B102

B103

B104

B105

B106

B107

B108

B109

B110

B111

B112

B113

B114

B115

B116

B117

B118

B119

B120

B121

B122

B123

B124

B125

B126

B127

B128

B129

B130

B131

B132

B133

B134

B135

B136

B137

B138

B139

B140

B141

B142

B143

B144

B145

B146

B147

B148

B149

B150

B151

B152

B153

B154

B155

B156

B157

B158

B159

B160

B161

B162

B163

B164

B165

B166

B167

B168

B169

B170

B171

B172

B173

B174

B175

B176

B177

B178

B179

B180

B181

B182

B183

B184

B185

B186

B187

B188

B189

B190

B191

B192

B193

B194

B195

B196

B197

B198

B199

B200

B201

B202

B203

B204

B205

B206

B207

B208

B209

B210

B211

B212

B213

B214

B215

B216

B217

B218

B219

B220

B221

B222

B223

B224

B225

B226

B227

B228

B229

B230

B231

B232

B233

B234

B235

B236

B237

B238

B239

B240

B241

B242

B243

B244

B245

B246

B247

B248

B249

B250

B251

B252

B253

B254

B255

B256

B257

B258

B259

B260

B261

B262

B263

B264

B265

B266

B267

B268

B269

B270

B271

B272

B273

B274

B275

B276

B277

B278

B279

B280

B281

B282

B283

B284

B285

B286

B287

1998 Road Bonds / Construction Projects

CIP Projects (funding in place)

Estimates

1. BIKEPATHS

DPW

- a. Nelson / Gray Bark intersection to Lucille
- b. Peck Street Snohomish to Fishhook

\$ 40,000
\$ 40-50,000

STATUS: FY '98 funding in place

2. EAST WESTPOINT DRIVE

Ak Rim Engineering

water / sewer installation

\$ 95,000

STATUS: FY '98 funding in place (catalyst: City annexation 3/96)
Preliminary engineering by 1/30/98. Bid documents ready by 3/1/98.

BOND ISSUE and LID PAVING PROJECTS

1. SPRUCE AVENUE

- a. Phase I Peck Street / Fishhook intersection realignment

Ak Rim Engineering
Wilder Construction

STATUS: Completed.

- b. Phase IA continuing west to Lucille

Ak Rim Engineering

STATUS: Preliminary engineering by 1/5/98.

- c. Phase II Lucille west to Lucas

STATUS: Preliminary engineering contract to be let 5/98.

- d. Phase III Lucas to Church Road

STATUS: Preliminary engineering contract tba

FACTORS TO CONSIDER . . . 12/1/97 the City applied for financial assistance from MSB under matching funds for dust control / air quality. Decision tba.

BOND ISSUE PROJECTS and LIDs continued . . .

2. WEBER DRIVE Parks Highway to Nelson Drive *Denali North*

STATUS: Replat / Public Use Easement in progress. Discussions held with DOT/PF re: storm drain system coordination and Parks intersection realignment. Property owners (Wendys, Weber, & Johnson) meeting scheduled with DPW 1/6 to coordinate project with adjacent owners. (curb and gutter + bikepath)

3. NORTH COUNTRY ESTATES Paving LID proposed *Denali North*

STATUS: Preliminary design completed. Public informational meeting scheduled for Wednesday 1/14. Formal survey of interest will be sent to property owners via registered mail. Public hearings will follow. Total cost of LID estimated \$881,000.

Preliminary estimated cost divided by 67 property owners (if all parcels are assumed to be equal) would result in approximately \$4,5000 assessment per property owner.

4. SUSITNA DRIVE Paving LID proposed See attached memo

5. DANNA DRIVE CIP ??

Approximately 1,500 linear feet of paving would connect Lucille Drive and Fishhook and improve traffic flow. It may be best to delay to coordinate design with DOT/PF and the Bogard / Fishhook intersection

6. CHURCH ROAD SOUTH CIP *R & M Engineering*

STATUS: Engineering completed. Wetlands permit acquired.

7. LUCILLE AVENUE Danna Avenue to Spruce Avenue

STATUS: Needs storm sewer up-grades and re-cap with 1.5" of asphalt. Estimated cost: \$250-350,000. Capping at this point in the maintenance schedule will extend the life of the road 15-20 years, even with current heavy traffic load.

OTHER PAVING PROJECTS not currently on the priority list

(LIDs can be reprioritized to reflect property owner interest.)

1. SWANSON AVENUE

STATUS: Needs resurfacing, storm drain corrections, and subsurface improvements. This project requires engineering to problem solve and maximize return on investment. Costs unknown.

2. MYSTERY AVENUE Church Road east through Bumpus to Lucus

STATUS: No road currently connects the ballfields east to Lucus. R.O.W. acquisition and clearing are required as well as engineering and design on 4,000'. Cost estimate: unknown, but in the \$700,000 range. Improvements on 1,300' developed road have estimated cost of \$145,000 range.

3. RECLUSE Paving LID proposed

STATUS: 14 of the 57 homeowners in the proposed LID responded to letters of interest sent by Jeff Williams. 13 of those returned were in favor of the LID formation. This area is part of the LID proposed for Melanie Avenue which did not go forward summer '97.

4. MELANIE Paving LID proposed *Denali North*

STATUS: There is still interest in dust control / paving. DOT/PF traffic counters were gathering data earlier in December. There may be a method of splitting the previous LID into Recluse and Melanie sections, perhaps with different accounting systems.

5. WINTER / HOLIDAY Paving LID proposed

STATUS: 8/97, 21 property owners (of 87) responded positively to an informal survey re: interest in forming a paving LID. City Council approved funding to obtain preliminary engineering and cost estimates. DPW staff was heavily committed with wrap-up of other projects and the project did not go forward in '97.

6. VAUNDA Paving LID proposed

STATUS: The property owners rejected the previous funding formula.

7. SENECA to PECK Paving LID proposed

STATUS: Initiated, but not active at this time