



## CITY OF WASILLA

290 E. HERNING AVE.  
WASILLA, ALASKA 99654-7091  
PHONE: (907) 373-9050  
FAX: (907) 373-9085

### COUNCIL MEMORANDUM NO. 94-48

From: Deputy Administrator  
Date: August 2, 1994  
Subject: Lone Cub Paving L.I.D.

We have received a petition from interested property owners along the portion of Lone Cub Drive that was not paved when Shadowood Valley was paved in 1993. Several property owners on a portion of Holiday Drive have expressed an interest in having that portion of Holiday Drive from Lone Cub Drive to Briar Drive paved also.

Request Council authority to obtain an engineering cost estimate so a formal survey of property owners may be taken to form a paving L.I.D.

---

Lee A. Wyatt  
Deputy Administrator

**APPROVED**

DATE: 8-8-94  
BY: M. Lewis

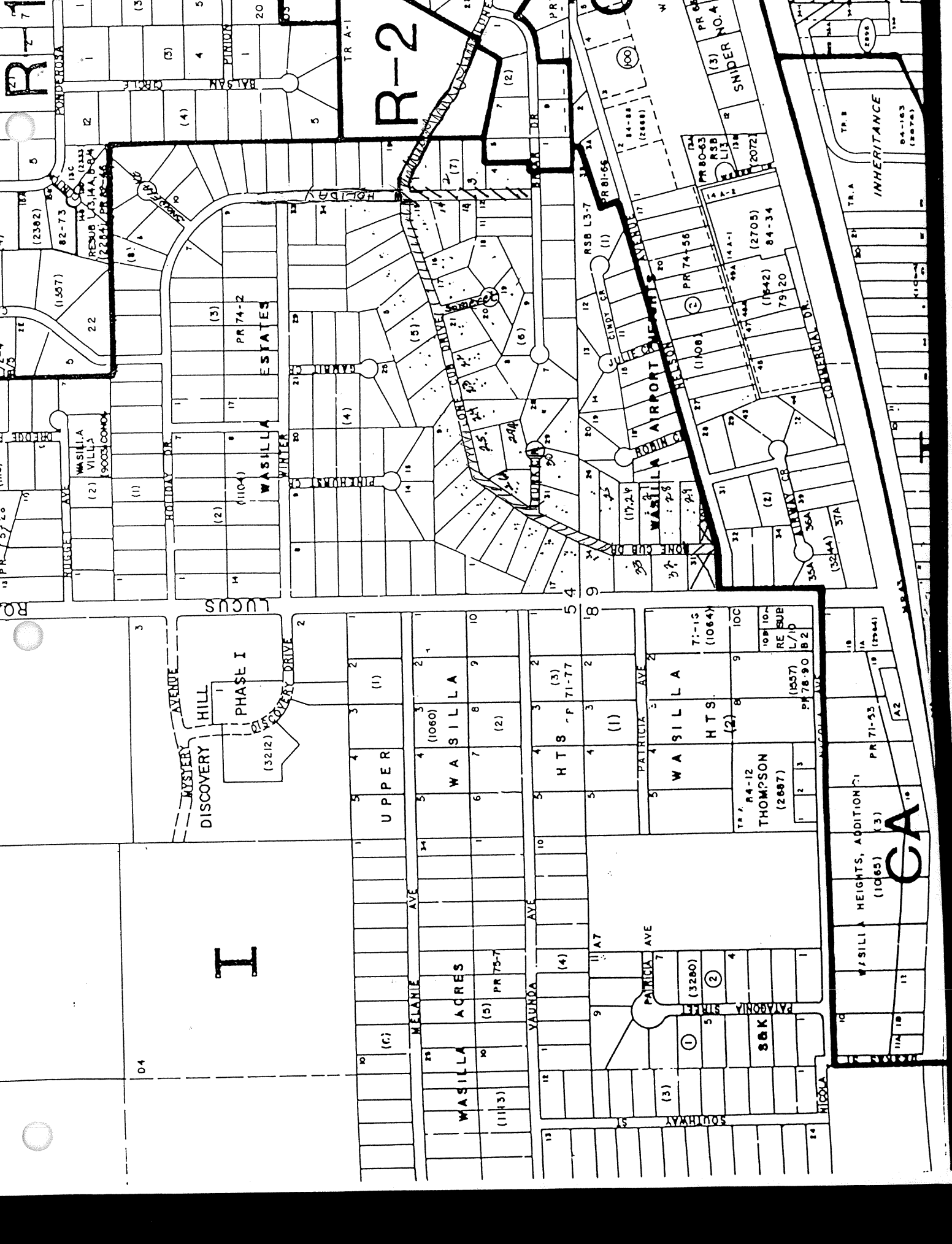

R-2

I

CA

R-2

D4

DISCOVERY HILL  
PHASE I

DISCOVERY DRIVE

UPPER

WASILLA ACRES

HTS - F

WASILLA HTS

THOMPSON

WASILLA HEIGHTS, ADDITION

WASILLA VILLAGES

WASILLA ESTATES

WASILLA

WASILLA

WASILLA

WASILLA

WASILLA

WASILLA

WASILLA

WASILLA

WASILLA VILLAGES

WASILLA ESTATES

WASILLA

WASILLA

WASILLA

WASILLA

WASILLA

WASILLA

WASILLA

WASILLA

WASILLA VILLAGES

WASILLA ESTATES

WASILLA

WASILLA

WASILLA

WASILLA

WASILLA

WASILLA

WASILLA

WASILLA

WASILLA VILLAGES

WASILLA ESTATES

WASILLA

WASILLA

WASILLA

WASILLA

WASILLA

WASILLA

WASILLA

WASILLA

WASILLA VILLAGES

WASILLA ESTATES

WASILLA

WASILLA

WASILLA

WASILLA

WASILLA

WASILLA

WASILLA

WASILLA

WASILLA VILLAGES

WASILLA ESTATES

WASILLA

WASILLA

WASILLA

WASILLA

WASILLA

WASILLA

WASILLA

WASILLA

WASILLA VILLAGES

WASILLA ESTATES

WASILLA

WASILLA

WASILLA

WASILLA

WASILLA

WASILLA

WASILLA

WASILLA

WASILLA VILLAGES

WASILLA ESTATES

WASILLA

WASILLA

WASILLA

WASILLA

WASILLA

WASILLA

WASILLA

WASILLA

WASILLA VILLAGES

WASILLA ESTATES

WASILLA

WASILLA

WASILLA

WASILLA

WASILLA

WASILLA

WASILLA

WASILLA

WASILLA VILLAGES

WASILLA ESTATES

WASILLA

WASILLA

WASILLA

WASILLA

WASILLA

WASILLA

WASILLA

WASILLA