



CITY OF WASILLA

290 E. HERNING AVE.
WASILLA, ALASKA 99654-7091
PHONE: (907) 373-9050
FAX: (907) 373-9085

COUNCIL MEMORANDUM NO. 94-40

FROM: Administration

DATE: July 7, 1994

SUBJECT: Annexation

Administration has reviewed properties that are totally surrounded by or almost surrounded by the current City limits. Now that the City is providing police protection it becomes more important to close these pockets. The Local Boundaries Commission also tends to favor annexing pockets like these.

Administration has contacted the property owners in these areas to see what interest existed in annexing to the City, of the 12 properties involved only 3 responded, all favoring annexation. Administration feels that although response was low it is important to go forward with the annexation process using the legislative review process.

Ordinance Serial No. 94-30 authorizes Administration to proceed with the annexation petition and amends Section 1.08.020(A) of the Wasilla Municipal Code by including the areas for annexation to the City Boundaries. Ordinance Serial No. 94-30 also designates the zoning classification for the proposed annexed areas. A map marked Exhibit 1 is attached and depicts the areas in question.

Administration recommends introduction of Ordinance Serial No. 94-30 for public hearing at the next regular meeting, 07/25/94. A petition will be prepared for the Local Boundaries Commission for the legislative review process and will be available at the next meeting in conjunction with the public hearing on Ordinance Serial No. 94-30.

Administration also recommends that Ordinance Serial No. 94-30 be reviewed by the Wasilla Planning Commission for comment.



John C. Stein, Mayor

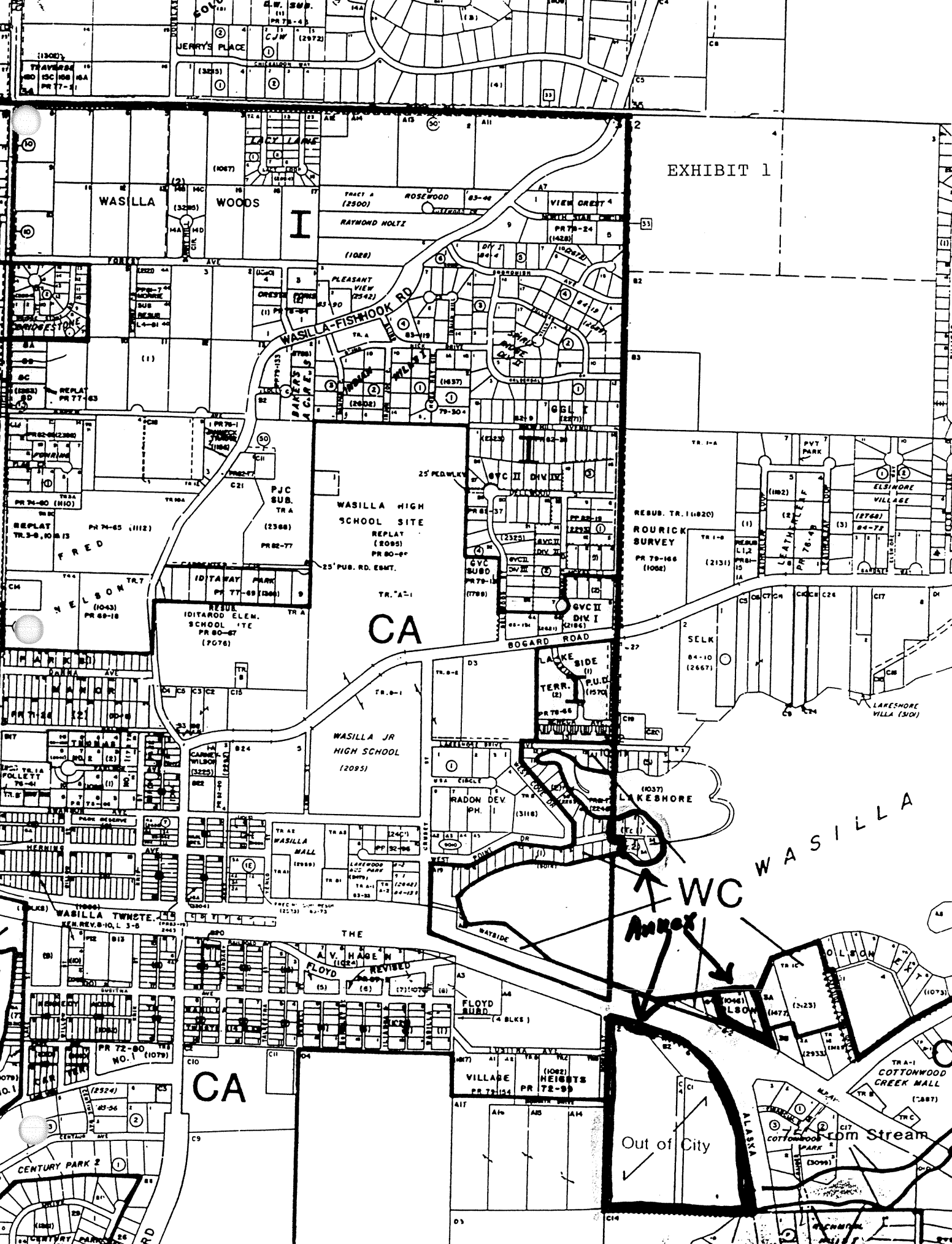

EXHIBIT 1

CA

CA

WC Annex

Out of City

WASILLA HIGH SCHOOL SITE
REPLAY (2095)
PR 80-94

WASILLA JR HIGH SCHOOL
(2095)

REBUR. TR. 1 (1020)
ROURICK SURVEY
PR 79-166
(1068)

LAKE SIDE
TERR. (2)
PR 79-48

RADON DEV. PH. I
(3118)

FLOYD BIRD
(4 BLKS)

VILLAGE PR 72-14
PR 72-14

HEIGHTS PR 72-99
PR 72-99

COTTONWOOD CREEK MALL
PR 72-14
PR 72-14

ALASKA COTTONWOOD CREEK MALL
PR 72-14
PR 72-14

WASILLA

WOODS

TRACT A ROSEWOOD 83-06
RAYMOND HOLTZ
(1028)

VIEW CREST 4
PR 78-24
(1428)

PLEASANT VIEW
2542
WASILLA-FISHHOOK RD

WASILLA JR HIGH SCHOOL
(2095)

REBUR. TR. 1 (1020)
ROURICK SURVEY
PR 79-166
(1068)

LAKE SIDE
TERR. (2)
PR 79-48

RADON DEV. PH. I
(3118)

FLOYD BIRD
(4 BLKS)

VILLAGE PR 72-14
PR 72-14

HEIGHTS PR 72-99
PR 72-99

COTTONWOOD CREEK MALL
PR 72-14
PR 72-14

ALASKA COTTONWOOD CREEK MALL
PR 72-14
PR 72-14

WASILLA

WOODS

TRACT A ROSEWOOD 83-06
RAYMOND HOLTZ
(1028)

VIEW CREST 4
PR 78-24
(1428)

PLEASANT VIEW
2542
WASILLA-FISHHOOK RD

WASILLA JR HIGH SCHOOL
(2095)

REBUR. TR. 1 (1020)
ROURICK SURVEY
PR 79-166
(1068)

LAKE SIDE
TERR. (2)
PR 79-48

RADON DEV. PH. I
(3118)

FLOYD BIRD
(4 BLKS)

VILLAGE PR 72-14
PR 72-14

HEIGHTS PR 72-99
PR 72-99

COTTONWOOD CREEK MALL
PR 72-14
PR 72-14

ALASKA COTTONWOOD CREEK MALL
PR 72-14
PR 72-14

PROPERTY OWNER LIST
PROPOSED ANNEXATION
LAKESHORE SUBDIVISION, OLSON SUBDIVISION AND MISC. TRACTS

David F. Smith
P. O. Box 870110
Wasilla, AK 99687-0110

Kenai Supply Inc.
P. O. Box 1729
Kenai, AK 99611-1729

Jack W. & Ruth E. Jacobson
P. O. Box 872491
Wasilla, AK 99687-2491

William & Helen L. Heairet
1454 E. Parks Highway
Wasilla, AK 99654

Paul & Betty J. Lepors
P. O. Box 870046
Wasilla, AK 99687-0046

Herbert Kopperud
P. O. Box 805
Palmer, AK 99645-0805

Myrtle TR TRE Nussbaumer
29620 Linn Drive
Corvallis, OR 97333-2516

Leonard M. & Anita Michels
P. O. Box 873123
Wasilla, AK 99687-3123

Jack R. DEC of TR Harris
2428 Galewood Street
Anchorage, AK 99508-4054

Mel T. & Emma Jean L. Husa
P. O. Box 874068
Wasilla, AK 99687-4068