



CITY OF WASILLA

290 E. HERNING AVE.

WASILLA, ALASKA 99654-7091

PHONE: (907) 373-9050

FAX: (907) 373-0788

COUNCIL MEMORANDUM NO. 92-72

From: Deputy Administrator
Date: July 14, 1992
Subject: Application for Sewer Connection Loan

The attached request for loan assistance was received on July 14, 1992 from Richard Tzou. He wishes to establish a new restaurant in the building on Lot 1C, Sun Mountain Plaza and connect to the City sewer system. The property does not meet the requirements of the City sewer connection loan/grant program. However, Council did make a previous exception and authorized participation in the program by the El Toro Restaurant.

The applicant was informed that he would have to sign a promissory note and secure it with a deed of trust. I believe he understands the requirements and the pay back of the loan. There is about \$17,000 in uncommitted funds available in the program. The applicant will have to provide engineering and plans to obtain D.E.C. approval to connect to the system.

Recommend Council approve a \$7,500 loan from the sewer connection loan/grant program to Richard Tzou in accordance with the usual procedures.

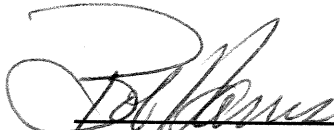

Robert E. Harris
Deputy Administrator

APPROVED
DATE: 7/27/92
BY: [Signature]

PE KING RESTAURANT

P.O. Box 874127 - Wasilla, Alaska 99687 - (907) 376-4919

PE KING WOK - (907) 248-1648

PE KING EXPRESS - (907) 746-5757

City of Wasilla:

My name is Richard Hou. I own the Mountain view place. at this time, I want make city see for my properties. please loan me 7500⁰⁰/₁₂ all cost for me. 18940⁰⁰/₁₂, thank you very much.

Very sincerely.

Richard Hou. 2/4/92.

SEWER REVOLVING LOAN

Ordinance No. 88-34 Appropriation - \$100,000

	<u>Total Expenses</u>	<u>50% City Share</u>	<u>50% Grantee Share</u>	<u>6-15-92 Grantee Payments To Date</u>
Romar	\$13,400.26	\$ 6,700.13	\$ 6,700.13	\$ 6,700.13
A & W Windbreak	\$14,643.83	\$ 7,321.92	\$ 7,321.92	\$ 1,827.41
Bible Baptist	\$14,950.00	\$ 7,475.00	\$ 7,475.00	\$ 805.22
El Toro	\$13,680.00	\$ 6,840.00	\$ 6,840.00	\$ 975.77
One-Hour Martinizing	\$ 8,494.00	\$ 4,247.00	\$ 4,247.00	\$ 2,200.48
Cottonwood Creek Mall	\$15,000.00 =====	\$ 7,500.00 =====	\$ 7,500.00 =====	\$ 647.87 =====
Total	\$80,168.09	\$40,084.05	\$40,084.05	\$13,156.88

\$100,000.00 - Original Funding
(40,084.05) - Loaned
(40,084.05) - Granted
13,156.88 - Repaid to Date

\$32,987.78 - Currently Available in the Program
< \$15,000 > - Council approved for George's Rest 7-13-92

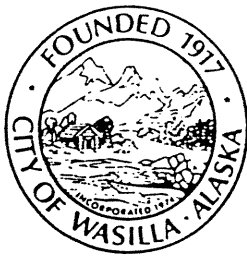

CITY OF WASILLA

290 E. HERNING AVE.
WASILLA, ALASKA 99687
PHONE: (907) 373-9050
FAX: (907) 373-0788

SEWER CONNECTION ASSISTANCE PROGRAM

On October 10, 1988, the Wasilla City Council approved a combination loan and grant program to assist owners of certain properties to connect to the sewer system. The general criteria and conditions of the program are as follows:

(1) ELIGIBILITY

- (a) Must be owner
- (b) Property must be developed and have on-site system
- (c) On-site system in Sewer District 83-S-1 must have been built prior to availability of sewer system and after January 1, 1984. All other systems must have been built prior to availability of sewer system piping.
- (d) Property must be adjacent to sewer lines.
- (e) On-site system must have failed:
 - (1) More than on pump-out per 3 months to function, or
 - (2) Pollution problem per D.E.C.
- (f) Property assessed for sewer off-site construction costs per municipal code.

(2) WORK

- (a) Shall be done by contractor.
- (b) Materials meeting City specifications supplied by:
 - (1) City at cost plus 25%, or
 - (2) Owner, delivered to contractor for installation.

(3) ELIGIBLE COSTS

- (a) Cost of City labor and material plus 25% mark-up.
- (b) Approved invoice costs of owner-supplied materials and labor.
- (c) Engineering, permits and inspection costs.

(4) GRANT-LOAN PROVISIONS

- (a) 50% of eligible cost paid as grant by City - Maximum \$8,000 for Class I (Residential with less than 12 bedrooms or commercial serving less than 25 persons); Maximum \$15,000 for Class II (residential with more than 12 bedrooms or commercial serving more than 25 persons).

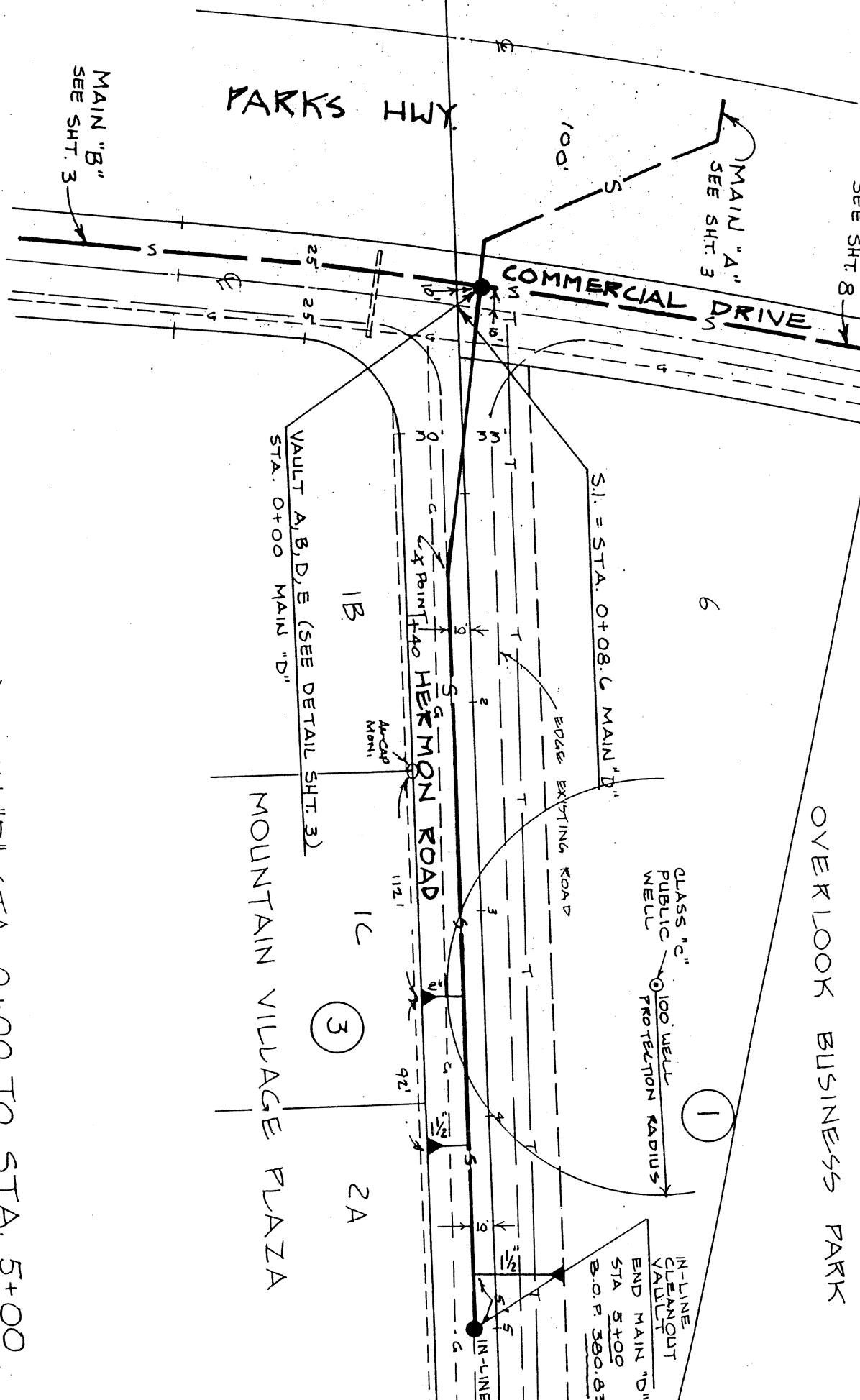

(HERMON ROAD) MAIN "D" STA. 0+00 TO STA. 5+00
 SCALE: 1" = 50'
 6" HDPE

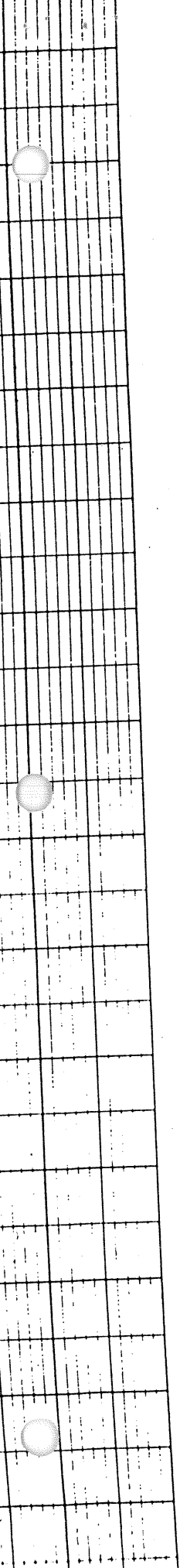

DOLLERHIDE ENGINEERING

May 8, 1992

POST OFFICE BOX 871812 • WASILLA, ALASKA 99687
TELEPHONE (907) 376-5485 FAX (907) 373-1882

Mr. Bob Harris, Director of Public Works
CITY OF WASILLA
290 East Herning Street
Wasilla, Alaska 99654

Re: Lot 1C, Block 3, MOUNTAIN VILLAGE PLAZA
Sewer System Design

Dear Mr. Harris:

The building on the above referenced property would like to connect to the City of Wasilla sewer system on Hermon Road. A submittal has been made to the Department of Environmental Conservation along with this transmittal to you.

The existing sewer serving this structure would be abandoned and the new system installed as shown on the enclosed design

I would appreciate your review of these plans.

Sincerely,



Floyd R. Dollerhide, P.E.

FRD/d

EXISTING SEWER SERVICE CONNECTION

53'

N 00° 02' 00" W

165.71

33' PUBLIC USE EASEMENT

S 89° 52' 04" W

ABANDON EXISTING SEPTIC TANK
INSTALL NEW 2150-GALLON TANK
AND VAULT

2A

N 89° 50' 01" E

260.35

LOT 1C
BLOCK 3

260.57

WELL

S 00° 08' 28" E

165.71