



Staff Report

City of Manhattan Beach

TO: Honorable Mayor Montgomery and Members of the City Council

THROUGH: Geoff Dolan, City Manager

FROM: Jim A. Arndt, Director of Public Works
Juan Price, Maintenance Superintendent

DATE: February 3, 2009

SUBJECT: Manhattan Village Soccer Field Netting Installation

RECOMMENDATION:

Staff recommends in-house construction of a lightweight 4 to 5 foot addition of netting to contain soccer balls within field of play at Manhattan Village Soccer field.

FISCAL IMPLICATION:

The estimated cost is estimated to be approximately \$13,000 to \$15,000.

BACKGROUND:

The City of Manhattan Beach has made a commitment to provide the best in recreation facilities to it's user base. One of the City's proudest achievements includes the new synthetic soccer field recently completed at Manhattan Village. This popular site is used on a daily basis by organized teams and by the general public of all ages.

The soccer field is rectilinear, and the field is oriented on its long axis in a north/south direction. Immediately adjacent to the soccer field, the Manhattan Senior Villas operates a parking lot on the westernmost portion of the field. The soccer field boundary is separated by an existing twelve foot high chain link fence. This fence apparently provided adequate control of errant soccer balls in the past, however, the City has recently incurred several vehicle damage claims due to impact with soccer balls.

DISCUSSION:

The original orientation of the soccer field was in an east /west direction. Impact on the surroundings was non existent. During the development of the Senior Villas project, the City entered into a land swap with the developer over ten years ago. The result was a new soccer field oriented in a north/south direction, but substantial play exists in the east /west orientation, resulting in balls being kicked out of play. The final project included parking for tenants and staff along the western and southern boundaries of the field. Until recently, conflicts between the soccer field and the Senior Villas parking lot were minimal and mostly concerned players crawling under fences to retrieve soccer balls out of play. Recently however, the City has received numerous claims of damage to

vehicles. These claims include broken mirrors, windshields and denting of body work.

Staff recommends a less expensive approach will suffice at the Manhattan Village site due to the density of mature trees and other obstacles along the western border. The addition of the 4 to 5 foot extension should trap most of the soccer balls from going over the fence onto Senior Villa property, certainly the ones that have the most speed, the “line drives” for lack of a better description. Those soccer balls having a higher trajectory are mostly stopped by the eucalyptus trees and have a much lower probability of damage. Because of the unique location and proximity of housing to the field, visual impact is of prime importance and a lighter weight structure is more desirable. The proposed extension should be akin to a “mosquito net” rather than golf course containment net, while still retaining adequate functionality.

Staff’s has reviewed the site, and presents the following options:

1. City staff proposes to attach steel round stock/reinforcing steel to the existing poles to raise the height of the fence by 4 to 5 feet. A lighter gauge cable and netting with larger mesh opening would be used to minimize weight. This construction would be light and airy and strictly to stop soccer balls. The existing fence poles cannot support a more substantial fence height due to footing depth and wind loading factors. The resultant netting would place the soccer overall containment between 16 to 17 feet, which we feel would stop most of the errant balls. This lightweight construction deters any fence climbing activities and presents a more open appearance. Staff at one time proposed a solution similar to the included picture of Marine Ave Park, but the design proposal met with negative comment from the Senior Villas representatives. Additionally, the lighter weight netting will probably have to be replaced every 3 to 4 years at an estimated cost of \$5,000. The initial installation cost is estimated to be \$13,000 to \$15,000 if performed by in-house staff.
2. Standard heavy duty construction. This option proposes to use 8” or greater diameter galvanized steel poles embedded into a reinforced concrete footing. These footings would be installed outside of the existing fenceline and inline with the field lighting poles to provide a uniform appearance and match or exceed the height of the netting currently located at the south goal area. A rough estimate costs of this type of installation in the \$130,000-\$150,000 range. A system of this magnitude requires engineering and must be let as a public works project. The most recent installation similar to this is located at Marine Avenue Park baseball field.
3. Take no action.

CONCLUSION

Staff recommends installing the light weight barrier to ameliorate future claims.

- Attachments: 1. - Site map or drawing
2. - Picture of Marine Ave Park netting installation

Village Soccer Field

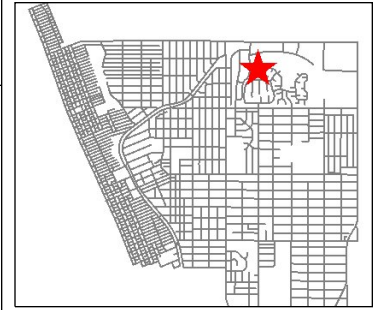

Legend

- Addresses
- Parcels
- 2006 4in color Basemap
- BEACH
- BLOCK
- DEADEND
- PARK
- PIER
- PRIVATE STREET
- SCHOOL
- STREET
- WALK STREET

Scale: 1:1,249



This map is a user-generated static output from the "MB GIS Info" Intranet mapping site and is for general reference only. Data layers that appear on this map may or may not be accurate, current, or otherwise reliable.

