

SURVEY NOTES:

- ALL DISTANCES SHOWN ARE HORIZONTAL GROUND DISTANCES IN U.S. SURVEY FEET (UNLESS OTHERWISE STATED).
- NO NC GRID MONUMENT IS WITHIN 2,000' OF SURVEYED TRACT.
- ALL BEARINGS ARE BASED ON THE NORTH CAROLINA STATE PLANE COORDINATE SYSTEM (NAD 1983/NSRS 2007).
- THIS SURVEY PERFORMED AND MAP PREPARED WITHOUT THE BENEFIT OF A TITLE REPORT. THIS SURVEY IS SUBJECT TO ANY FACTS AND EASEMENTS WHICH MAY BE DISCLOSED BY A FULL AND ACCURATE TITLE SEARCH.
- THIS PROPERTY IS LOCATED IN FLOOD HAZARD ZONE "X", AREAS DETERMINED TO BE OUTSIDE THE 0.2% ANNUAL AS WELL AS ZONE "AE" AS SHOWN ON FEMA FIRM MAP PANEL #3710976500J WITH AN EFFECTIVE DATE OF FEBRUARY 2, 2007.
- PROJECT AREA IS A PORTION OF PARCEL AKP# 82829. A COMPLETE BOUNDARY SURVEY OF THIS PARCEL WAS NOT PERFORMED IN THE COURSE OF THIS SURVEY. AREA CALCULATIONS FOR THIS PARCEL IS BASED ON CHATHAM COUNTY GIS PARCEL DATA.

ADDITIONAL NOTE:

THE DESIGNATIONS AND CONDITIONS OF USAGE OF COMMON AREA/OPEN SPACE ARE AS SET FORTH IN THE DECLARATION OF COVENANTS, CONDITIONS AND RESTRICTIONS FOR BRIAR CHAPEL, RECORDED AT BOOK 1370, PAGE 1020, AND RE-RECORDED AT BOOK 1372, PAGE 864, AS AMENDED AND SUPPLEMENTED (THE "DECLARATION").

Curve Table					
Curve #	Radius	Length	Tangent	Chord Bearing	Ch. Length
C1	360.00'	124.03'	62.64'	S80°17'26"W	123.42'
C2	436.00'	929.73'	789.45'	S29°04'19"W	763.32'
C3	100.00'	22.20'	11.15'	N15°15'44"E	22.16'
C4	100.00'	91.15'	49.01'	N31°12'38"E	88.02'
C5	100.00'	77.84'	41.01'	N34°54'02"E	75.89'
C6	100.00'	89.01'	47.69'	N36°08'00"E	86.10'
C7	81.08'	78.13'	42.40'	N48°46'08"E	75.14'
C8	100.00'	107.31'	59.48'	N33°11'41"E	102.24'
C9	112.33'	95.87'	51.07'	N24°52'07"E	92.98'
C10	96.15'	101.66'	56.16'	N44°36'59"E	96.99'
C11	88.27'	54.68'	28.25'	N55°01'24"E	53.81'
C12	50.00'	34.03'	17.70'	N65°23'42"E	33.38'
C13	50.16'	50.83'	27.84'	N53°10'30"E	48.68'
C14	50.00'	24.90'	12.71'	N53°01'03"E	24.64'
C15	101.93'	29.64'	14.92'	S48°31'53"E	29.53'
C16	50.00'	41.38'	21.96'	S68°05'29"E	40.21'
C17	53.47'	99.40'	71.62'	N31°13'39"E	85.70'
C18	51.19'	106.55'	87.36'	S83°53'34"E	88.33'
C19	53.40'	35.98'	18.70'	N64°35'09"E	35.30'
C20	52.04'	24.63'	12.55'	S86°01'57"E	24.40'
C21	50.00'	45.09'	24.21'	S70°54'44"E	43.58'
C22	153.24'	108.98'	56.91'	S82°24'05"E	106.70'
C23	50.00'	26.77'	13.72'	S72°57'07"E	26.46'
C24	82.17'	35.26'	17.91'	S70°18'25"E	34.99'
C25	179.70'	92.67'	47.39'	S79°59'09"E	91.64'
C26	50.00'	47.72'	25.85'	S69°57'07"E	45.93'
C27	50.00'	23.10'	11.76'	S21°56'09"E	22.90'
C28	141.54'	35.86'	18.03'	S12°02'04"E	35.77'
C29	51.52'	158.86'	1768.92'	N75°23'24"E	103.00'
C30	67.88'	60.27'	32.28'	N20°34'52"W	58.31'
C31	50.00'	17.22'	8.70'	N65°46'01"E	17.14'
C32	51.57'	25.91'	13.24'	N87°48'40"E	25.64'
C33	50.00'	17.51'	8.84'	S70°12'54"E	17.42'
C34	57.81'	44.87'	23.63'	S65°58'36"E	43.75'
C35	50.00'	52.23'	28.78'	S76°16'13"E	49.89'
C36	50.00'	56.96'	32.02'	N80°01'39"E	53.93'
C37	73.00'	56.48'	29.74'	N59°53'09"E	55.08'
C38	72.16'	45.04'	23.28'	N56°18'24"E	44.31'
C39	89.47'	52.47'	27.01'	S89°16'51"E	51.72'
C40	106.40'	22.64'	11.36'	S82°49'34"E	22.60'

Line Table		
Line #	Direction	Length
L1	S01°49'26"E	37.50'
L2	N89°50'21"W	47.47'
L3	N48°04'47"E	59.26'
L4	N55°12'28"E	72.37'
L5	S82°13'29"E	16.92'
L6	N88°12'05"E	20.70'
L7	N65°20'05"E	3.58'
L8	S35°10'19"E	27.00'
L9	N14°36'36"W	16.88'

NNP-BRIAR CHAPEL, LLC  
DB 1657 PG 177  
PB 2005 PG 262  
AKPAR: 82829

10' CHATHAM COUNTY  
NO BUILD ZONE

CHATHAM COUNTY  
STREAM BUFFER

10' CHATHAM COUNTY  
NO BUILD ZONE

NNP-BRIAR CHAPEL, LLC  
DB 1657 PG 177  
PB 2005 PG 262  
AKPAR: 82829

NNP-BRIAR CHAPEL, LLC  
DB 1657 PG 177  
PB 2005 PG 262  
AKPAR: 82828

200' DUKE POWER R/W  
DB 429 PG 599

NNP-BRIAR CHAPEL, LLC  
DB 1208 PG 877  
PB 34 PG 19  
AKPAR: 1184

NNP-BRIAR CHAPEL, LLC  
DB 1722 PG 1163  
PB 2013 PG 214  
AKPAR: 2177

NGS "MEACHAM"  
NC GRID (NAD83/07)  
N: 768,395.12'  
E: 1,963,424.93'  
S05°29'25"W  
11405.88' (GSDUAD)  
11404.83' (GSD)  
CF=0.99990676

CMF  
NC GRID (NAD83/07)  
N: 756,991.62'  
E: 1,963,250.82'

N.C. GRID (NAD 83/07)

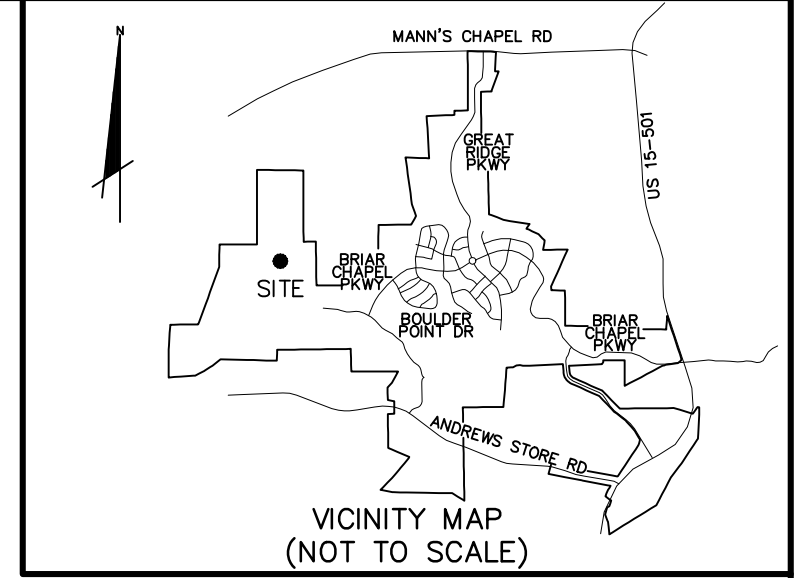

I, DAVID S. CLARK, PLS L-4729, CERTIFY THAT THIS PLAT WAS DRAWN UNDER MY SUPERVISION FROM AN ACTUAL SURVEY MADE UNDER MY SUPERVISION FROM INFORMATION SHOWN IN DEED BOOKS REFERENCED ON MAP AND MAP BOOKS REFERENCED ON MAP. THAT ANY LINES NOT ACTUALLY SURVEYED APPEAR AS BROKEN LINES AND WERE PLOTTED FROM INFORMATION AS NOTED ON THE PLAT; THAT THE RATIO OF PRECISION AS CALCULATED IS BETTER THAN 1:10,000; THAT THE AREA IS COMPUTED BY COORDINATE METHOD; THAT THIS PLAT WAS PREPARED IN ACCORDANCE WITH G.S. 47-30 AS AMENDED. WITNESS MY ORIGINAL SIGNATURE, REGISTRATION NUMBER, AND SEAL THIS THE \_\_\_\_ DAY OF \_\_\_\_\_ A.D., 2015.

DAVID S. CLARK L-4729  
PROFESSIONAL LAND SURVEYOR

I, DAVID S. CLARK, PLS L-4729, CERTIFY THAT THE SURVEY CREATES A SUBDIVISION OF LAND WITHIN THE AREA OF A COUNTY OR MUNICIPALITY THAT HAS AN ORDINANCE THAT REGULATES PARCELS OF LAND.

DATE

PRELIMINARY PLAT  
NOT FOR RECORDATION, CONVEYANCE, OR SALES

CERTIFICATION OF OWNERSHIP AND DEDICATION

I (WE) HEREBY CERTIFY THAT I AM (WE ARE) THE OWNER(S) OF THE PROPERTY SHOWN AND DESCRIBED HEREON AND THAT I (WE) HEREBY ADOPT THIS PLAN OF SUBDIVISION WITH MY (OUR) FREE CONSENT, AND DEDICATE ALL RIGHT-OF-WAYS, STREETS, ALLEYS, WALKS, EASEMENTS, PARKS, AND OTHER OPEN SPACES TO PUBLIC OR PRIVATE USE AS NOTED.

OWNERS OR AUTHORIZED AGENT DATE

REVIEW OFFICER CERTIFICATION  
STATE OF NORTH CAROLINA, COUNTY OF CHATHAM

I, \_\_\_\_\_ REVIEW OFFICER FOR CHATHAM COUNTY, CERTIFY THAT THE MAP OR PLAT TO WHICH THIS CERTIFICATION IS AFFIXED MEETS ALL STATUTORY REQUIREMENTS FOR RECORDING.

REVIEW OFFICER DATE

BY TITLE

CERTIFICATE OF APPROVAL FOR RECORDING

I HEREBY CERTIFY THAT THE SUBDIVISION PLAT SHOWN HEREON HAS BEEN FOUND TO COMPLY WITH THE SUBDIVISION REGULATIONS FOR CHATHAM COUNTY, WITH THE EXCEPTION OF SUCH VARIANCES, IF ANY, AS NOTED IN THE MINUTES OF THE BOARD OF COMMISSIONERS, AND THAT IT HAS BEEN APPROVED BY THE BODY FOR RECORDING IN THE OFFICE OF THE COUNTY REGISTER OF DEEDS.

DATE

CHAIRMAN, CHATHAM COUNTY BOARD OF COMMISSIONERS

LEGEND  
● IRON ROD SET (UNLESS OTHERWISE STATED)  
○ EXISTING IRON ROD  
CMF CONCRETE MONUMENT FOUND  
EX. EXISTING  
N/F NOW OR FORMERLY  
DB DEED BOOK  
PB PLAT BOOK  
PG PAGE  
sq. ft. SQUARE FEET

SCALE: 1" = 100'  
0 50 100 200 300

SITE DATA

ZONING: CONDITIONAL USE DISTRICT - COMPACT COMMUNITY  
TOTAL COMMON AREAS: 5,542 ACRES / 241,394 Sq. Ft.  
REMAINDER OF SUBJECT PARCEL (AKPAR 82829): 88.018 ACRES / 3,834,064 Sq. Ft.

OWNER INFORMATION:

NNP-BRIAR CHAPEL, LLC  
DB 1657, Pg. 177  
16 WINDY KNOLL CIRCLE  
CHAPEL HILL, NC 27516  
PHONE: (919) 951-0700  
FAX: (919) 240-4963  
CONTACT: BILL MUMFORD, P.E.

DATE	REVISION	INITIAL



1730 Varsity Drive Suite 500  
Raleigh, North Carolina 27606  
Phone: (919)233-8091, Fax: (919)233-8031  
NC FIRM # 1222

Internet Site: <http://www.mckimcreed.com>

DATE:

FINAL SUBDIVISION PLAT  
OF  
BRIAR CHAPEL DEVELOPMENT - PHASE 16 SOUTH, COMMON AREA #61  
FOR  
NNP-BRIAR CHAPEL  
DATE: July 9, 2015 SCALE: 1" = 100'  
BALDWIN TOWNSHIP CHATHAM COUNTY NORTH CAROLINA

PROJECT # : 2735-0138  
PROJ. SVYR : DSC  
DRAWN BY : DSC  
FIELD BK. :  
COMP. FILE : VB101-2735\_Ph16-CA.dwg  
SHEET # : 1 OF 1

DWG. # :