

NOTES

No.	Date	Description

TAX CARD ID: 89671

PROPOSED LIGHTING PLAN

BEAVERCREEK STORAGE
BEAVERCREEK ROAD
CHATHAM COUNTY, NC
APEX, NORTH CAROLINA

SCALE: 1"=30'
DRAWN BY: MEG
DATE: 06-30-2014
SHEET NO.: 3 of 3

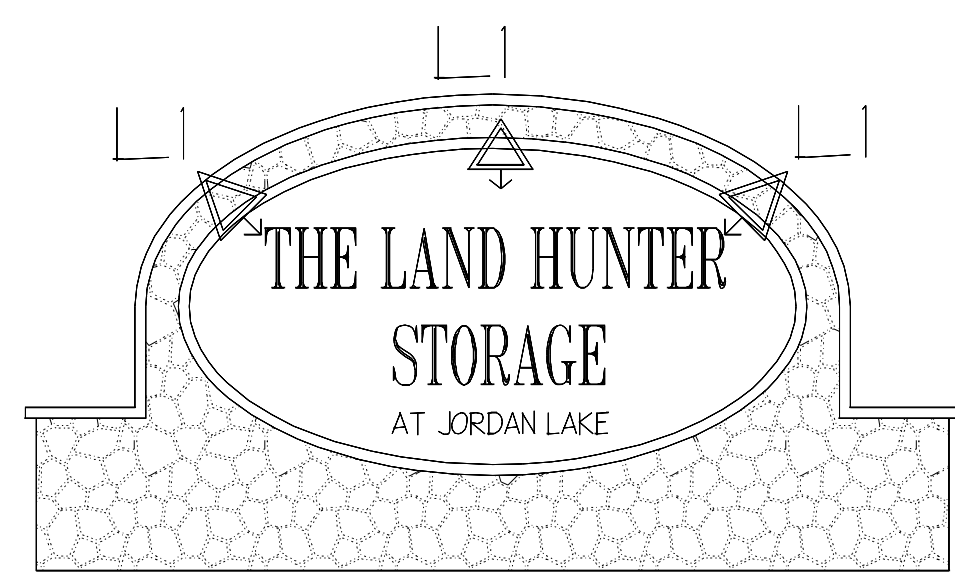

BEAVERCREEK STORAGE SIGNAGE DETAIL

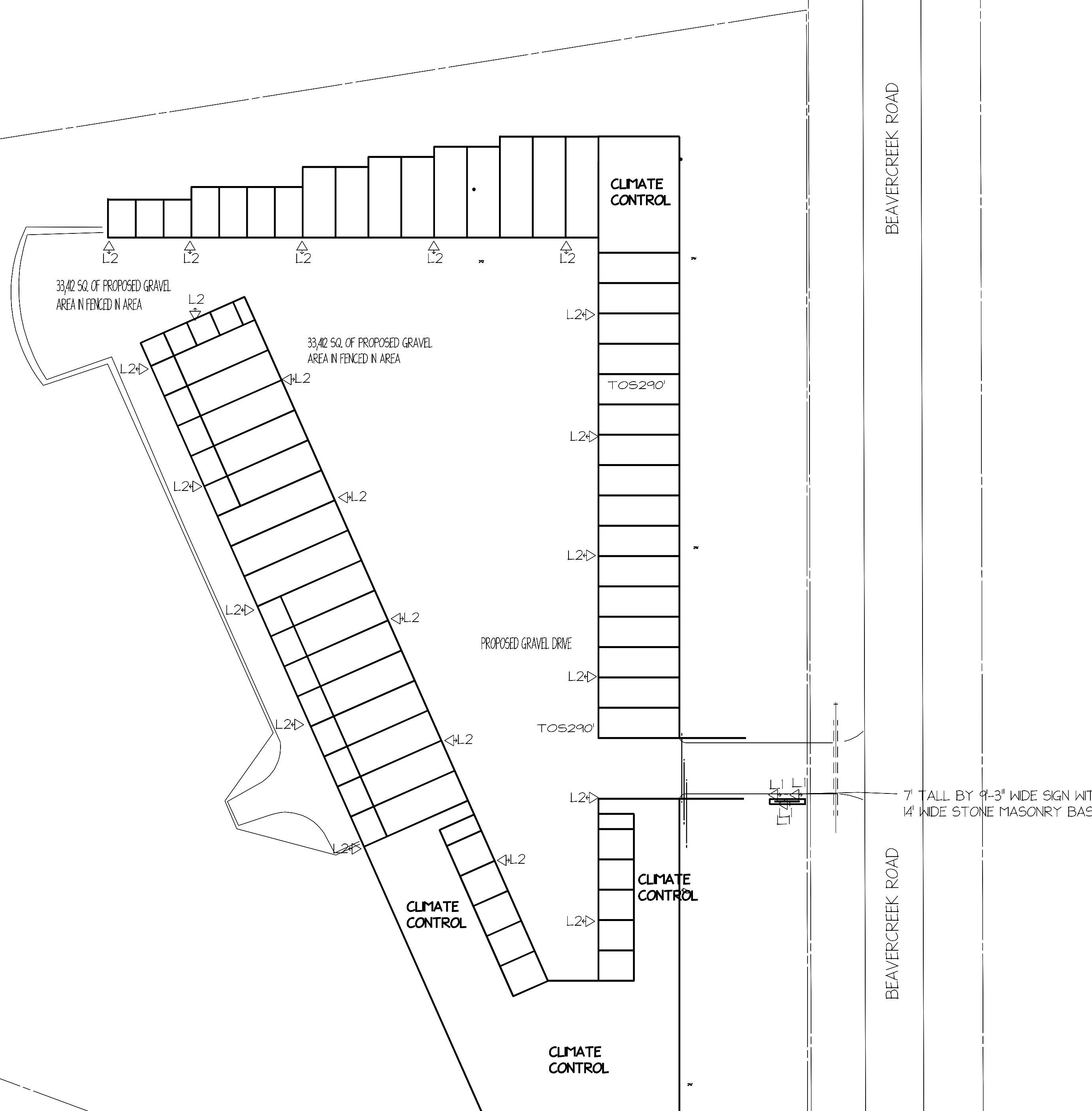

NOTE: ALL LIGHTING WILL COMPLY WITH SECTION 13

LIGHTING PLAN:				
	QTY.	LIGHT TYPE	MAX. WATTAGE PER FIXTURE	HEIGHT OF LIGHT
(L1)	(6)	LOW VOLTAGE DOWNLIGHT	(1) 20 WATT MAX. FOR WATTAGE	6'
(L2)	(22)	LARGER WALL/LATERN TYPE LIGHT	(2) x 60 WATT MAX. FOR WATTAGE	8'

QUERCUS 'WHITE OAK'

BEAVERCREEK ROAD

BEAVERCREEK ROAD

BEAVERCREEK ROAD