

# The Retreat At Haw River Conservation Area & Buffer Widths



Chatham County, North Carolina  
June 6, 2014

227 West Trade St. Suite 1000  
Charlotte, NC 28202

Total Acreage:	646.13 Ac.
Residential Lots:	393
Non-Residential Lots:	2
Total Lots:	395
Conservation Natural Space:	± 252.00 Ac. (39%)
Conservation Open Space:	± 6.45 Ac. (1%)
Subtotal:	± 258.45 Ac. (40%)

- Legend**
- Conservation Natural Space
  - Conservation Open Space
  - Buffer

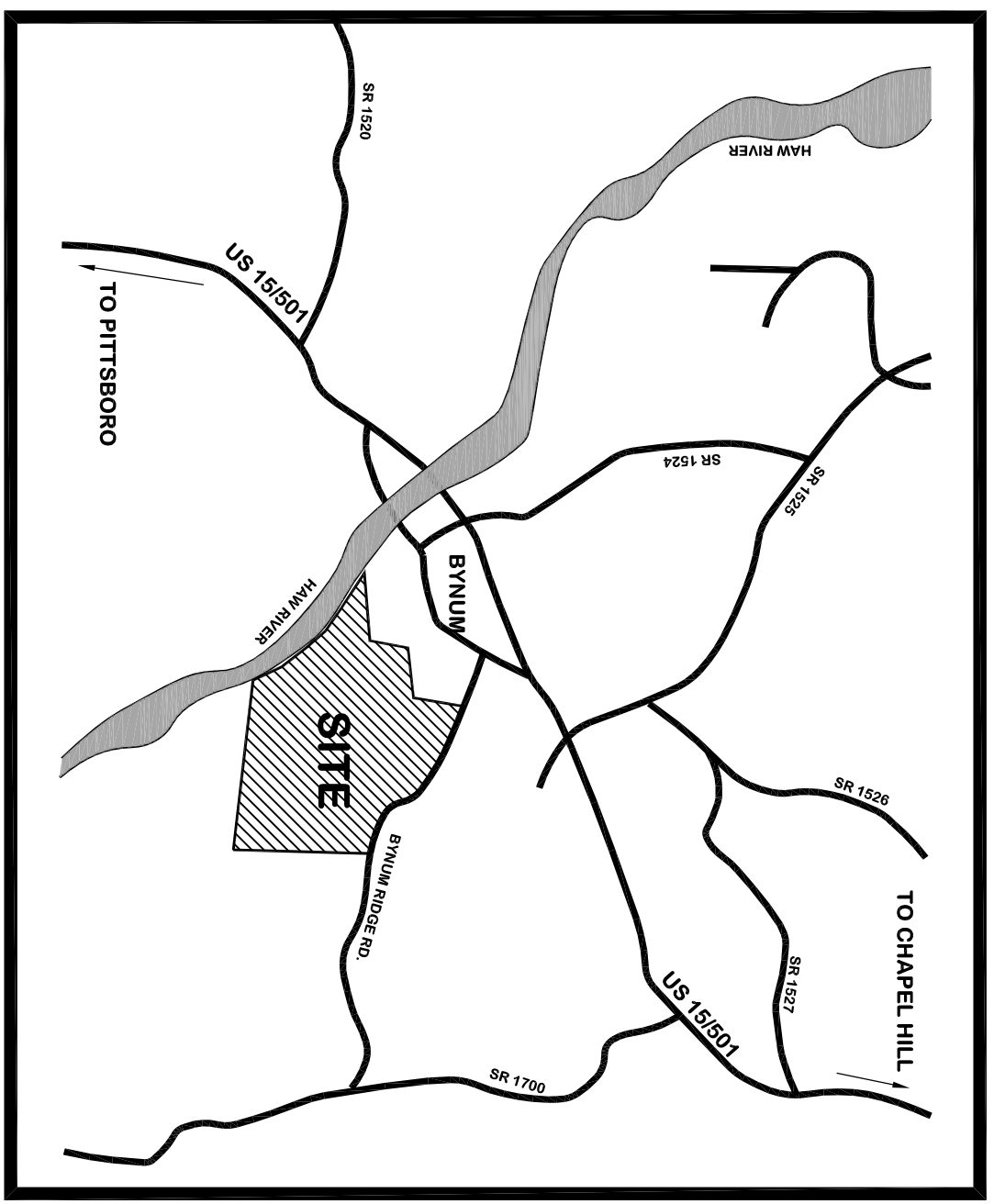
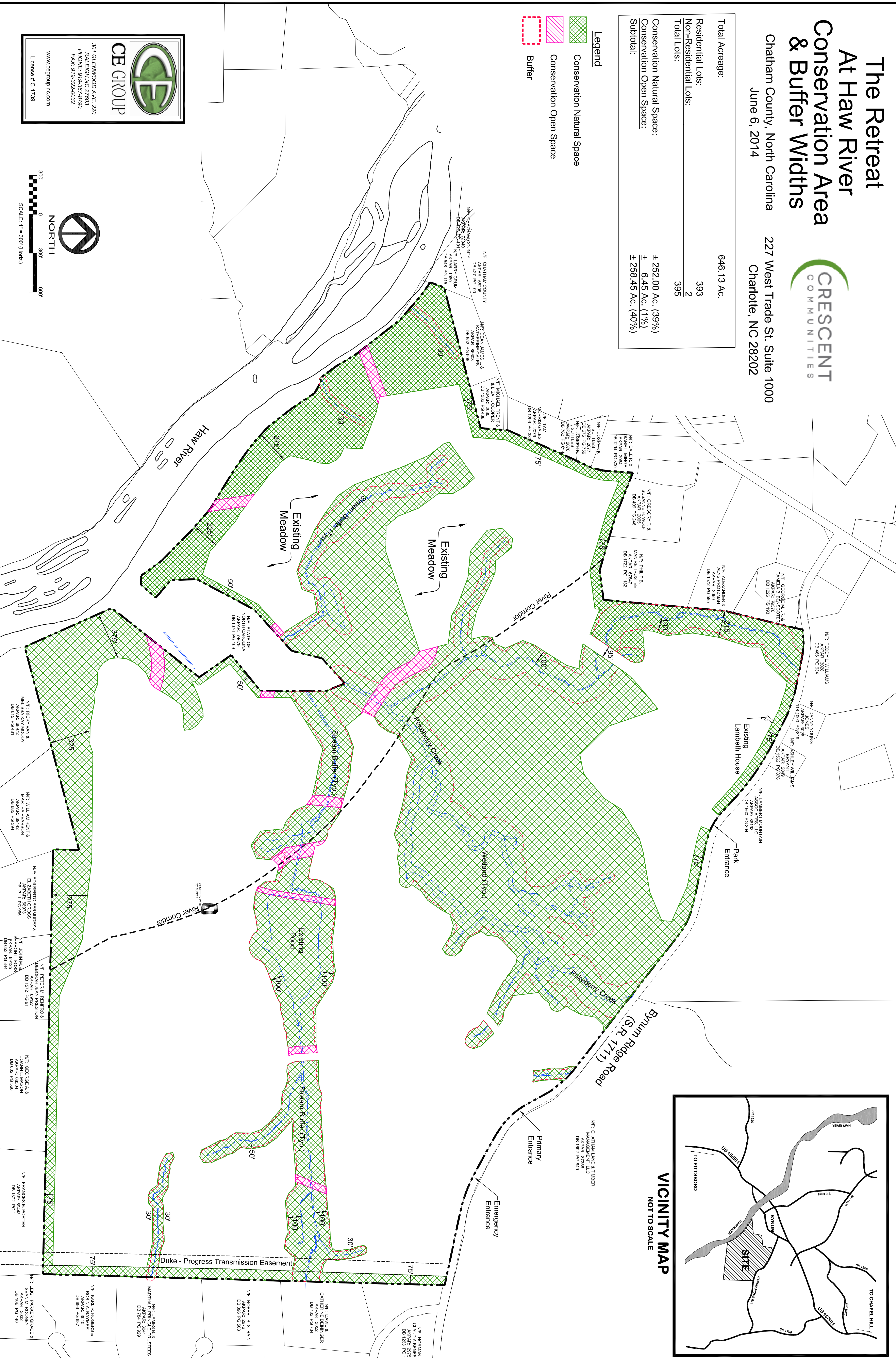

301 GLENWOOD AVE, 220  
FALEIGH, NC 27603  
PHONE: 919-367-8790  
FAX: 919-322-0032  
www.cegroupinc.com  
License # C-1739

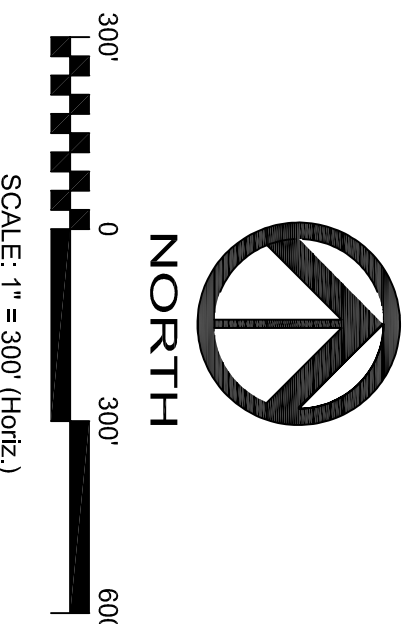

N.F. LEON PARKER BRUCE & SARA M. RICE  
APPAR. 3022  
DB 192 PG 140

N.F. FRANCIS E. PORTER  
DB 192 PG 1

N.F. GEORGE A. & JOANN L. MASON  
APPAR. 2854  
DB 92 PG 588

N.F. PETER M. HENFRO & DEBORAH JEAN PRESTON  
APPAR. 2977  
DB 192 PG 91

N.F. JOHN M. & SHARON L. FOSS  
APPAR. 3041  
DB 65 PG 242

N.F. EDUARDO BERNARDEZ & ELIZABETH GROSS  
APPAR. 2897  
DB 111 PG 585

N.F. WILLIAM KENT & MARTHA PEARSON  
APPAR. 2894  
DB 66 PG 594

N.F. RICK VAN & MELISSA KAY MOODY  
DB 615 PG 451

N.F. STATE OF N.C.  
APPAR. 2473  
DB 1076 PG 108

N.F. PHILIP B. MANIRE TRUSTEE  
DB 1722 PG 1132

N.F. GREGORY T. & SUSANNE H. WOLF  
DB 489 PG 246

N.F. DALE R. & DANIEL L. MINGE  
DB 1294 PG 300

N.F. JOSEPH M.  
APPAR. 2077  
DB 676 PG 756

N.F. JOSEPH M.  
APPAR. 2078  
DB 702 PG 914

N.F. TAMM MORRIS GALES  
APPAR. 2079  
DB 188 PG 573

N.F. MICHAEL TRENT & S. LINDA C. TRENT  
APPAR. 2080  
DB 1382 PG 488

N.F. DEAN JAMES L. & ANNE M. JAMES  
APPAR. 6803  
DB 532 PG 586

N.F. LARRY SCUM  
APPAR. 1880  
DB 548 PG 115

N.F. CHATHAM COUNTY  
APPAR. 65205  
DB 427 PG 190

N.F. NORMAN & CLAUDIA BENSCH  
DB 1283 PG 1

N.F. DAVID & CATHERINE DENINGER  
DB 782 PG 734

N.F. ROBERT S. STRAIN  
DB 388 PG 563

N.F. JAMES B. & MARTHA INDUSTRIES  
DB 774 PG 929

N.F. KARL R. ROGERS & ROBIN A. RAYNER  
APPAR. 3040  
DB 99 PG 350

N.F. EDUARDO BERNARDEZ & ELIZABETH GROSS  
APPAR. 2897  
DB 111 PG 585

N.F. JOHN M. & SHARON L. FOSS  
APPAR. 3041  
DB 65 PG 242

N.F. PETER M. HENFRO & DEBORAH JEAN PRESTON  
APPAR. 2977  
DB 192 PG 91

N.F. GEORGE A. & JOANN L. MASON  
APPAR. 2854  
DB 92 PG 588

N.F. FRANCIS E. PORTER  
DB 192 PG 1

N.F. LEON PARKER BRUCE & SARA M. RICE  
APPAR. 3022  
DB 192 PG 140