

**PLAT PREPARED BY:**

McKIM & CREED, INC.  
1730 VARSITY DRIVE  
SUITE 500  
RALEIGH, NC 27606  
PHONE: (919) 233-8091  
FAX: (919) 233-8031  
CONTACT: RANDY S. RAMBEAU, SR., PLS.

**OWNER INFORMATION:**

NNP BRIAR CHAPEL, LLC  
16 WINDY KNOLL CIRCLE  
CHAPEL HILL, NC 27516  
PHONE: (919) 951-0700  
FAX: (919) 240-4963  
CONTACT: BILL MUMFORD, P.E.

**LEGEND**

PB PLAT BOOK  
PGS PAGES  
R/W RIGHT-OF-WAY  
sq. ft. SQUARE FEET  
● IRON ROD SET  
XXX LOT NUMBER

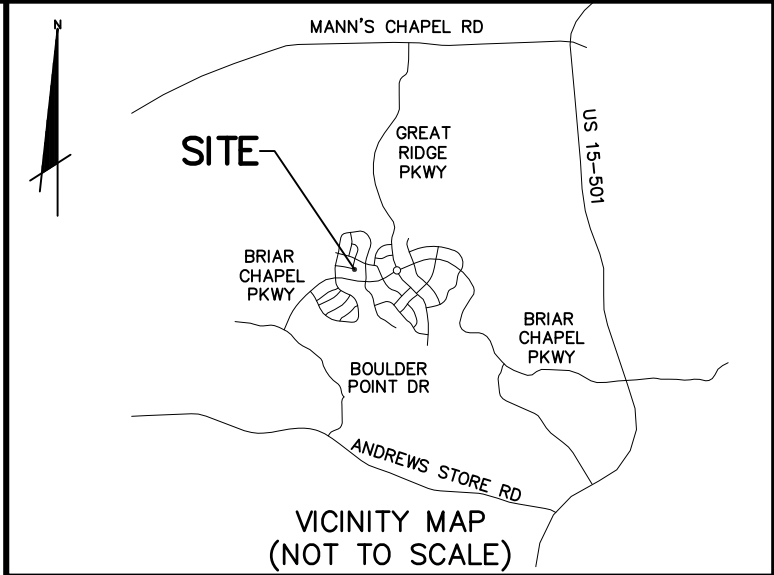
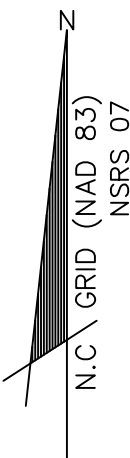

I, RANDY S. RAMBEAU, SR., CERTIFY THAT THIS PLAT WAS DRAWN UNDER MY SUPERVISION FROM AN ACTUAL SURVEY MADE UNDER MY SUPERVISION AS SHOWN AT PB 2011 PAGES 135-140; THAT THE BOUNDARIES NOT SURVEYED ARE CLEARLY INDICATED AS DRAWN FROM INFORMATION FOUND IN PB 2011, PAGE 135-140; THAT THE RATIO OF PRECISION AS CALCULATED IS 1:10,000; THAT THIS PLAT WAS PREPARED IN ACCORDANCE WITH G.S. 47-30 AS AMENDED. WITNESS MY ORIGINAL SIGNATURE, REGISTRATION NUMBER AND SEAL THIS DAY OF \_\_\_\_\_, A.D., 2013.

RANDY S. RAMBEAU, SR.  
L-2520

I, RANDY S. RAMBEAU, SR., PLS L-2520 CERTIFY THAT THE SURVEY IS OF ANOTHER CATEGORY, SUCH AS THE RECOMBINATION OF EXISTING PARCELS, A COURT-ORDERED SURVEY, OR OTHER EXCEPTION TO THE DEFINITION OF SUBDIVISION;

DATE \_\_\_\_\_

NORTH CAROLINA, \_\_\_\_\_ COUNTY  
THIS INSTRUMENT IS DULY RECORDED AND VERIFIED  
THIS \_\_\_\_\_ DAY OF \_\_\_\_\_, A.D. 2013,  
AT \_\_\_\_\_ O'CLOCK IN MAP BOOK/SLIDE  
CABINET \_\_\_\_\_, PAGE/SLIDE \_\_\_\_\_.

REGISTER OF DEEDS

LINE TABLE		
LINE	BEARING	LENGTH
L1	S78°17'01"E	23.99
L2	S78°17'01"E	19.15

DEPARTMENT OF TRANSPORTATION  
DIVISION OF HIGHWAYS

PROPOSED SUBDIVISION ROAD  
CONSTRUCTION STANDARDS CERTIFICATION

APPROVED \_\_\_\_\_  
DISTRICT ENGINEER

DATE \_\_\_\_\_

**CERTIFICATION OF OWNERSHIP AND DEDICATION**

I (WE) HEREBY CERTIFY THAT I AM (WE ARE) THE OWNER(S) OF THE PROPERTY SHOWN AND DESCRIBED HEREON AND THAT I (WE) HEREBY ADOPT THIS PLAN OF SUBDIVISION WITH MY (OUR) FREE CONSENT, AND DEDICATE ALL RIGHT-OF-WAYS, STREETS, ALLEYS, WALKS, EASEMENTS, PARKS, AND OTHER OPEN SPACES TO PUBLIC OR PRIVATE USE AS NOTED.

OWNERS OR AUTHORIZED AGENT \_\_\_\_\_ DATE \_\_\_\_\_

**CERTIFICATE OF APPROVAL FOR RECORDING**

I HEREBY CERTIFY THAT THE SUBDIVISION PLAT SHOWN HEREON HAS BEEN FOUND TO COMPLY WITH THE SUBDIVISION REGULATIONS FOR CHATHAM COUNTY, WITH THE EXCEPTION OF SUCH VARIANCES, IF ANY, AS NOTED IN THE MINUTES OF THE BOARD OF COMMISSIONERS, AND THAT IT HAS BEEN APPROVED BY THE BODY FOR RECORDING IN THE OFFICE OF THE COUNTY REGISTER OF DEEDS.

DATE \_\_\_\_\_

CHAIRMAN, CHATHAM COUNTY BOARD OF COMMISSIONERS

**REVIEW OFFICER CERTIFICATION**

STATE OF NORTH CAROLINA, COUNTY OF CHATHAM

I, \_\_\_\_\_, REVIEW OFFICER FOR CHATHAM COUNTY, CERTIFY THAT THE MAP OR PLAT TO WHICH THIS CERTIFICATION IS AFFIXED MEETS ALL STATUTORY REQUIREMENTS FOR RECORDING.

REVIEW OFFICER \_\_\_\_\_ DATE \_\_\_\_\_

BY \_\_\_\_\_ TITLE \_\_\_\_\_

**NOTE:**

This is a revision plat related to the plat recorded at PS 2011-135, Chatham County Registry. The sole purpose of this revision plat is to show the change in the street right-of-way from 40' wide to 50' wide on Pokeberry Bend Drive and Owen Towne Road. All other information set forth on the original plat recorded at PS 2011-135, Chatham County Registry remains valid and unchanged.

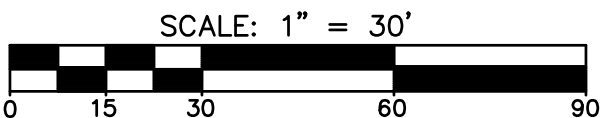

CURVE TABLE						
CURVE	RADIUS	LENGTH	TANGENT	BEARING	CHORD	DELTA
C1	670.00	117.49	58.90	N68°46'17"W	117.34	10°02'50"
C2	15.00	22.86	14.31	N30°08'03"W	20.71	87°19'19"
C3	15.00	23.09	14.53	N57°37'18"E	20.88	88°11'23"
C4	130.00	219.85	146.67	S29°50'09"E	194.57	96°53'44"
C5	180.00	12.50	6.25	S20°36'08"W	12.50	3°58'44"
C6	15.00	24.52	15.99	S69°25'19"W	21.88	93°39'38"
C7	670.00	5.16	2.58	N73°34'28"W	5.16	0°26'30"
C8	10.00	15.16	9.47	N29°54'48"W	13.75	86°52'49"
C9	10.00	15.39	9.69	N57°37'18"E	13.92	88°11'23"
C10	120.00	202.94	135.39	S29°50'09"E	179.60	96°53'44"
C11	170.00	11.81	5.91	S20°36'08"W	11.80	3°58'44"
C12	670.00	4.62	2.31	N63°56'43"W	4.62	0°23'42"
C13	10.00	16.28	10.59	S69°13'28"W	14.54	93°15'56"
C14	670.00	107.71	53.97	N68°44'54"W	107.59	9°12'38"

DATE	REVISION	INITIAL



**McKIM & CREED**

1730 Varsity Drive, Suite 500  
Raleigh, North Carolina 27606  
Phone: (919)233-8091, Fax: (919)233-8031  
F-1222

Internet Site: <http://www.mckimcreed.com>

DATE: \_\_\_\_\_

**NNP-BRIAR CHAPEL, LLC REVISION PLAT**

OPEN SPACE #17 PHASE 5 NORTH,  
AS PREVIOUSLY SHOWN ON P.B. 2011, PGS 135-140.

DATE: DECEMBER 3, 2013 SCALE: 1" = 30'  
BALDWIN TOWNSHIP CHATHAM COUNTY NORTH CAROLINA

PROJECT # : 2735-0094  
PROJ. SVYR : RSR,SR.  
DRAWN BY : MWH  
FIELD BK. :  
COMP. FILE : OPEN SPACE #17 ROW  
SHEET # : 1 OF 1

DWG. # : R.1.3.10.1071