

© JERRY TURNER & ASSOCIATES, INC. THIS DOCUMENT IS THE PROPERTY OF JERRY TURNER & ASSOCIATES, INC. ALL RIGHTS ARE RESERVED AND ANY REPRODUCTION, REPRODUCTION, OR OTHER USE OF THIS DOCUMENT WITHOUT THE PRIOR PERMISSION OF JERRY TURNER & ASSOCIATES, INC. EXPRESSLY PROHIBITED.

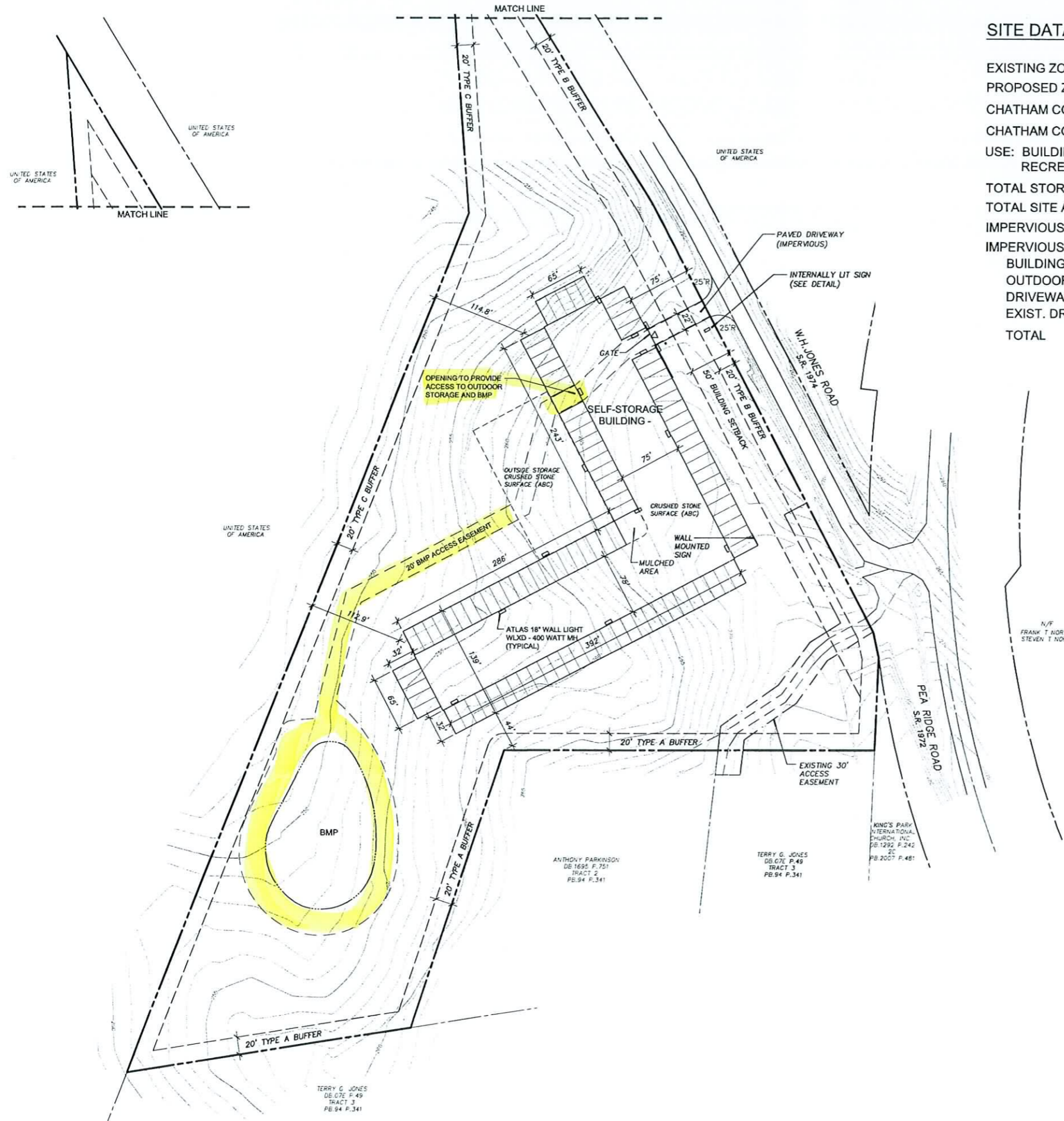

SITE DATA

EXISTING ZONING	R-1
PROPOSED ZONING	CD-NB (NEIGHBORHOOD BUSINESS)
CHATHAM COUNTY PARCEL #'S (AKPAR)	74879, 5131
CHATHAM COUNTY PINS	9780-60-8290, 9780-60-8800
USE: BUILDING WILL BE USED FOR STORAGE OF RECREATIONAL VEHICLES AND BOATS	
TOTAL STORAGE UNITS PROPOSED	100 UNITS
TOTAL SITE AREA	11.17 AC 486,565 SF
IMPERVIOUS SURFACE PERMITTED	116,775 SF (24%)
IMPERVIOUS SURFACE PROPOSED	
BUILDING AND INTERIOR PAVING	95,071 SF
OUTDOOR STORAGE	17,240 SF
DRIVEWAY	1,650 SF
EXIST. DRIVE IN ACCESS EASEMENT	2,814 SF
TOTAL	116,775 SF (24%)

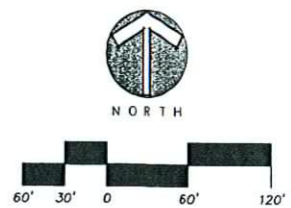
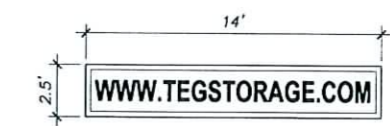
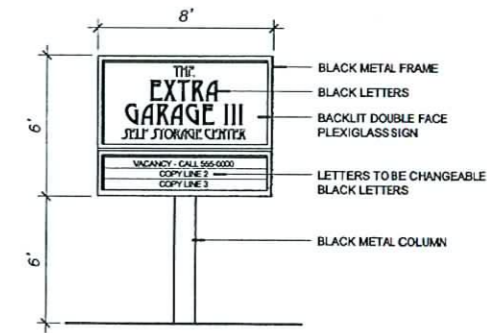

JT
INC.
JERRY TURNER & ASSOCIATES, INC.
Landscape Architecture
Land Planning
Environmental Design

905 Jones Franklin Road
Raleigh, North Carolina 27606
(919) 851-7150 fax (919) 851-7547
277 S.E. 5th Avenue
Delray Beach, Florida 33483
(561) 276-0453 fax (561) 272-7593

THE EXTRA GARAGE III
SELF-STORAGE CENTER
CHATHAM COUNTY, NC

OWNER/DEVELOPER:
WALTER LEWIS

REVISIONS

DRAWN	CHECKED
RT	WH
SCALE	DATE
1"=60'	1/3/14
TITLE	

SITE PLAN

FILE NO. _____ JOB NO. _____
SEAL _____ SHEET NO. _____

© JERRY TURNER & ASSOCIATES, INC. THIS DOCUMENT IS THE PROPERTY OF JERRY TURNER & ASSOCIATES, INC. ALL RIGHTS ARE RESERVED AND ANY REPRODUCTION, REPRODUCTION, OR OTHER USE OF THIS DOCUMENT WITHOUT THE WRITTEN PERMISSION OF JERRY TURNER & ASSOCIATES, INC. IS EXPRESSLY PROHIBITED.

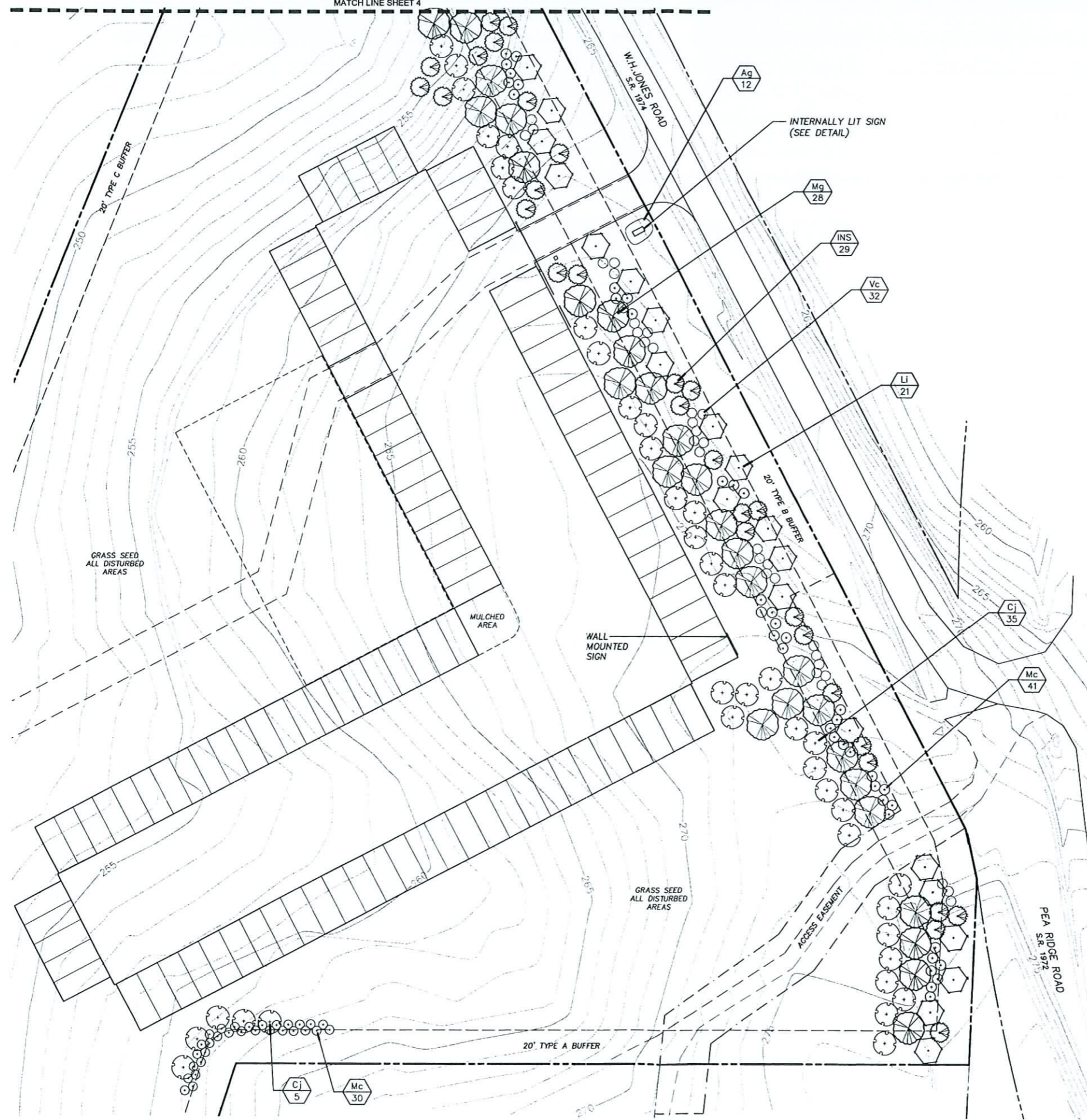

PLANT TAG (SEE PLANT LIST - SHEET 4)

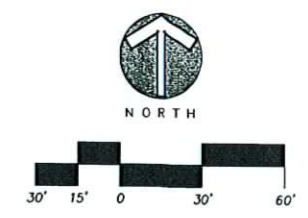
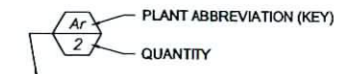

JERRY TURNER & ASSOCIATES, INC.

Landscape Architecture
Land Planning
Environmental Design

905 Jones Franklin Road
Raleigh, North Carolina 27606
(919) 851-7150 fax: (919) 851-7547

277 S.E. 5th Avenue
Delray Beach, Florida 33483
(561) 276-0453 fax: (561) 272-7593

PROJECT

**THE
EXTRA
GARAGE III
SELF-STORAGE
CENTER**
CHATHAM COUNTY, NC

OWNER/DEVELOPER:
WALTER LEWIS

REVISIONS

DRAWN	CHECKED
RT	WH
SCALE	DATE
1"=30'	1/3/14
TITLE	

**DETAILED
LANDSCAPE
PLAN**

FILE NO. _____ JOB NO. _____
SEAL _____ SHEET NO. _____

© JERRY TURNER & ASSOCIATES, INC. THIS DOCUMENT IS THE PROPERTY OF JERRY TURNER & ASSOCIATES. ALL RIGHTS ARE RESERVED AND ANY REPRODUCTION, REPRODUCTION, OR OTHER USE OF THIS DOCUMENT WITHOUT THE PRIOR PERMISSION OF JERRY TURNER & ASSOCIATES IS EXPRESSLY PROHIBITED.



JERRY TURNER & ASSOCIATES, INC.

Landscape Architecture
Land Planning
Environmental Design

905 Jones Franklin Road
Raleigh, North Carolina 27606
(919) 851-7150 fax (919) 851-7547

277 S.E. 5th Avenue
Delray Beach, Florida 33483
(561) 276-0453 fax (561) 272-7593

PROJECT

THE EXTRA GARAGE III SELF-STORAGE CENTER

CHATHAM COUNTY, NC

OWNER/DEVELOPER:
WALTER LEWIS

REVISIONS

DRAWN: RT
CHECKED: WH
SCALE: 1"=30'
DATE: 1/3/14

LANDSCAPE PLAN, PLANT LIST & DETAILS

FILE NO. _____ JOB NO. _____
SEAL _____ SHEET NO. _____

KEY	PLANT LIST		QUANTITY	CALIPER	HEIGHT	SPREAD	ROOT	REMARKS
	BOTANICAL NAME	COMMON NAME						
Trees								
Cj	<i>Cryptomeria japonica</i>	Japanese Cryptomeria	54		6-8'		BB	
INS	<i>Ilex 'Nellie R. Stevens'</i>	Nellie Stevens Holly	41		6-8'		BB	
Li	<i>Lagerstroemia indica 'Notchez'</i>	Notchez Crape Myrtle	21		6-8'		BB	multi-stem
Mg	<i>Magnolia grandiflora 'Brown Beauty'</i>	Brown Beauty Magnolia	41		6-8'		BB	
Shrubs								
Ag	<i>Abelia grandiflora 'Kaleidoscope'</i>	Kaleidoscope Abelia	12				cont	3 gal
Vc	<i>Viburnum 'Chindo'</i>	Chindo Viburnum	32				cont	5 gal
Mc	<i>Morrello cerifera</i>	Wax Myrtle	82				cont	7 gal
Buffer Plants (if necessary to supplement exist. vegetation)								
	<i>Juniperus virginiana</i>	Red Cedar						
	<i>Morrello cerifera</i>	Wax Myrtle						
	<i>Pinus taeda</i>	Loblolly Pine						
	<i>Thuja orientalis</i>	Green Giant Arborvitae						

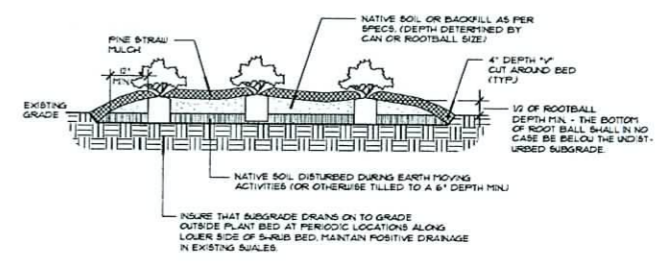
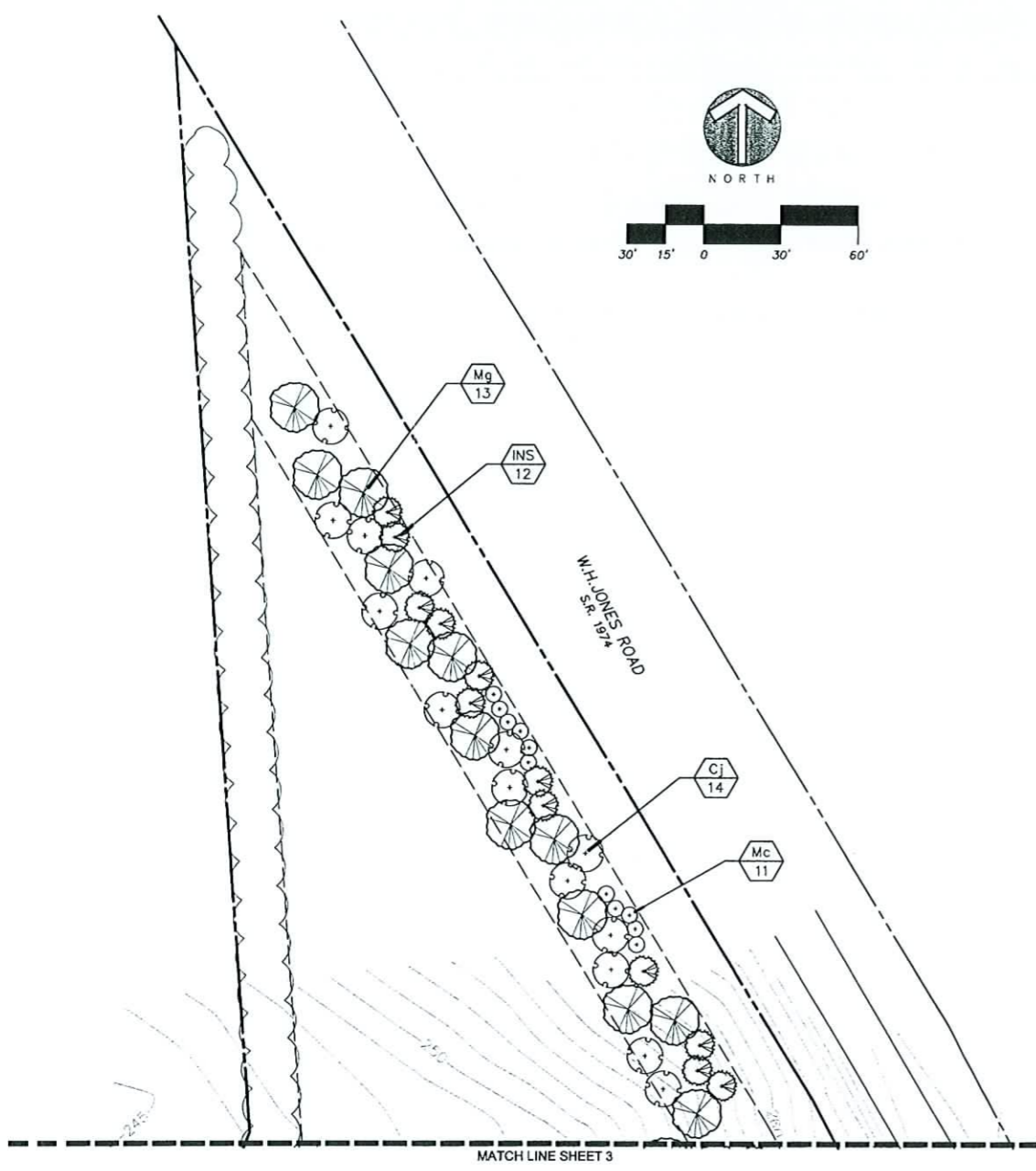

SHRUB PLANTING DETAIL
NOT TO SCALE

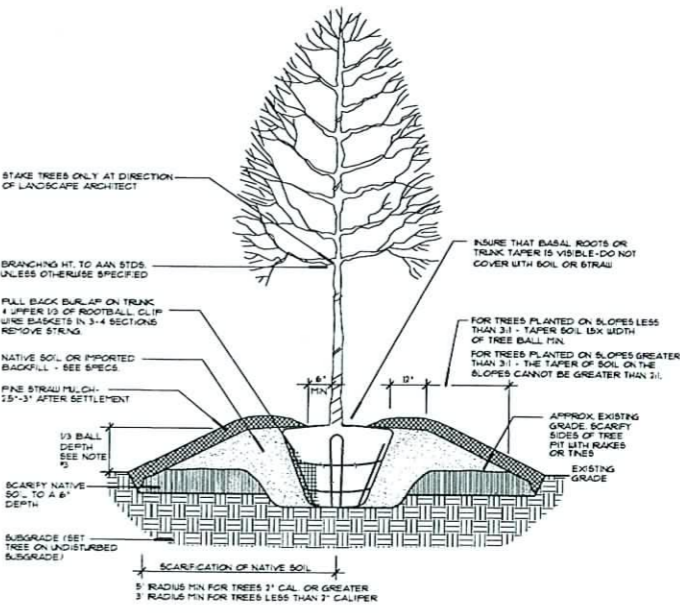

LARGE TREE
TREE PLANTING DETAIL
NOT TO SCALE

TREE PLANTING NOTES:

- TREE WRAP IS TO BE USED ON THIN BARK SPECIES ONLY (SUCH AS MAPLES). THE LANDSCAPE ARCHITECT SHALL BE THE SOLE JUDGE OF WHICH SPECIES SHOULD BE WRAPPED IF THERE IS ANY QUESTION.
- IF TREES SETTLE OR ARE BLOWN OUT OF PLUMB POSITION THEY SHOULD BE STRAIGHTENED BY MAKING ADJUSTMENTS TO THE POSITION OF THE ROOTBALL - NOT BY PUSHING ON THE TRUNK. TREES SHALL BE STRAIGHTENED DURING THE LIFE OF THE PROJECT AS THEY GET OUT OF PLUMB, NOT JUST AT THE END OF THE PROJECT.
- BALL DEPTHS ON SOME TREES IN A SINGLE GROUP MAY VARY. IN GENERAL, 1/3 THE BALL SHOULD BE ABOVE GRADE BUT IF DEPTHS VARY ALL TREES IN A GROUP SHOULD BE SET SO THAT THE BASE OF THE TRUNKS WILL APPEAR TO BE AT THE SAME RELATIVE ELEVATION ABOVE GRADE.
- NO DECIDUOUS OR EVERGREEN TREES WILL BE ACCEPTED IF THERE IS MORE THAN ONE LEADER UNLESS THE TREE IS SPECIFIED AS MULTI-TRUNK.

PLANT TAG (SEE PLANT LIST)

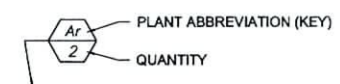

GENERAL NOTES

- BAB AS LISTED UNDER 'ROOT' IN THE PLANT LIST INDICATED BALLED AND BURLAPPED.
- VERIFICATION OF TOTAL QUANTITIES AS SHOWN IN THE PLANT LIST SHALL BE THE RESPONSIBILITY OF THE PLANTING CONTRACTOR AND THE TOTAL QUANTITIES SHALL BE AS REQUIRED ON THE PLANTING PLAN.
- ALL TREES, SHRUBS, AND PLANTS SHALL CONFORM TO ACCEPTED STANDARDS ESTABLISHED BY THE AMERICAN ASSOCIATION OF NURSERYMEN.
- ALL SAUCERS SHALL BE SOAKED WITH WATER AND MULCHED IMMEDIATELY FOLLOWING INSTALLATION.
- PRUNING: THIN BRANCHES AND FOLIAGE (NOT ALL END TIPS) RETAINING NORMAL PLANT SHAPE. NEVER CUT EVERGREEN LEADER.
- EACH PLANT SHALL BEAR THE SAME RELATIONSHIP TO FINISH GRADE AS IT BORE TO PREVIOUS EXISTING GRADE.
- ALL ROOT BALLS REMOVED FROM CONTAINERS SHALL BE SCARIFIED PRIOR TO BACKFILLING.
- VERIFICATION OF LOCATIONS OF UNDERGROUND UTILITIES IS RECOMMENDED PRIOR TO PLANTING.
- MULCH ALL BEDS W/TRIPLE SHREDDED HARDWOOD MULCH.