

Scientific Name	Common Name	Type	Ht	Width	Zone Size	Density
Acer palmatum 'Bloodgood'	Bloodgood Japanese Maple	Tree	20'	20'	5-8 3 Gal	10' O.C.
Hamamelis virginiana	Witchhazel	Tree	25'	20'	3-8 3 Gal	10' O.C.
Magnolia virginiana	Sweetbay Magnolia	Tree	30'	20'	5-9 3 Gal	10' O.C.
Thuja plicata 'Green Giant'	Green Giant Arborvitae	Tree	40'	15'	5-8 3 Gal	10' O.C.
Acuba japonica 'Picturata'	Picturata Acuba	Shrub	10'	7'	6-10 3 Gal	5' O.C.
Adina rubella	Glossy Adina	Shrub	5-10'	5-10'	6-9b 3 Gal	5' O.C.
Buxus sempervirens	American Boxwood	Shrub	20'	20'	6-8 3 Gal	5' O.C.
Calycanthus 'Hartledge Wine'	Sweet Shrub	Shrub	15	8-10	5-8 3 Gal	5' O.C.
Camellia japonica 'Professors Sargent'	Professors Sargent Camella	Shrub	15'	10'	7-9 3 Gal	5' O.C.
Camellia sasanqua 'Setsugekka'	Setsubekka Camella	Shrub	15'	8'	7-9 3 Gal	5' O.C.
Cleyera japonica 'Bronze Beauty'	Clayara Bronze Beauty	Shrub	8'-10'	5'-6'	7-10 3 Gal	5' O.C.
Cyrtilla racemiflora	Swamp Cyrtilla/Titi	Shrub	7'-15'	7'-15'	6-11 3 Gal	5' O.C.
Daphne Odora	Daphne	Shrub	6'	6'	7-9 3 Gal	5' O.C.
Elaeagnus pungens 'Maculata'	Maculata Elaegagnus	Shrub	15'	15'	6-10 3 Gal	5' O.C.
Euonymus alatus	Dwarf Burning Bush	Shrub	10'	10'	4-8 3 Gal	5' O.C.
Fatsia japonica	Japanese Fatsia	Shrub	10'	10'	8-10 3 Gal	5' O.C.
Hydrangia tardiva	Tardiva Hydrangea	Shrub	15'	8'	3-8 3 Gal	5' O.C.
Ilex opaca	American Holly	Shrub	15'-30'	10'-20'	5-9 3 Gal	5' O.C.
Ilex vomitoria 'Pendula'	Pendula Youpon Holly	Shrub	25'	15'	7-10 3 Gal	5' O.C.
Illicium parviflorum	Small Anise Tree	Shrub	10'-15'	6'-10'	7-10 3 Gal	5' O.C.
Kalmia latifolia	Mountain Laurel	Shrub	7'-15'	5'-8'	4-9 3 Gal	5' O.C.
Loropetalum chinensis v.r. 'Pizazz'	Chinese Fringe Flower	Shrub	8'	8'	7-9 3 Gal	5' O.C.
Mahonia x media 'Charity'	Charity Mahonia	Shrub	15'	12'	7-9 3 Gal	5' O.C.
Morella cerifera	Southern Waxmyrtle	Shrub	10'-15'	12'	7b-11 3 Gal	5' O.C.
Pieris japonica 'Mountain Fire'	Japanese Pieris	Shrub	8'	8'	5-7b 3 Gal	5' O.C.
Rhododendron catawbiense 'English Roseum'	Rhododendron English Roseum	Shrub	10'	8'	4-8 3 Gal	5' O.C.
Taxus baccata 'Fastigata'	Irish Yew	Shrub	20'	8'	6-9 3 Gal	5' O.C.
Taxus x media 'Hicksii'	Hicksii Yew	Shrub	20'	8'	4-7 3 Gal	5' O.C.
Viburnum x pragebae	Prague Viburnum	Shrub	10'	10'	5-8 3 Gal	5' O.C.
Heuchera micrantha 'Plum Pudding'	Plum Pudding Coral Bells	Perennial	7'	7'	5-8 1 Gal	3' O.C.
Polygonatum biflorum	Solomon's Seal	Perennial	36"-48"	7'	1 Gal	3' O.C.
Vinca minor	Periwinkle	Perennial	5"	4"	4-8 4" Pot	2' O.C.
Athyrium augustum forma rebellum	Lady in Red Fern	Fern	2.5'	2.5'	3-8 1 Gal	3' O.C.
Cyrtium falcatum 'Rochfordianum'	Holly Fern	Fern	2'	3'	7b-10 1 Gal	3' O.C.
Mateuccia struthiopteris 'The King'	The King Ostrich Fern	Fern	5'	4'	2-8 1 Gal	3' O.C.
Osmunda cinnamomea	Cinnamon Fern	Fern	2.5'	3'	2-10 1 Gal	3' O.C.
Polystichum polyblepharum	Tassel Fern	Fern	2'	2'	5-9 1 Gal	3' O.C.

# Preliminary Concept Plan

Scale: 1" = 50' - 0"

**Jordan Lake RV Park**  
8168 Moncure Pittsboro Rd.  
Moncure, NC

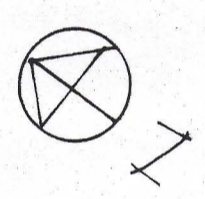

Crepe Myrtle & Juniper Existing on Both Sides of Entrance

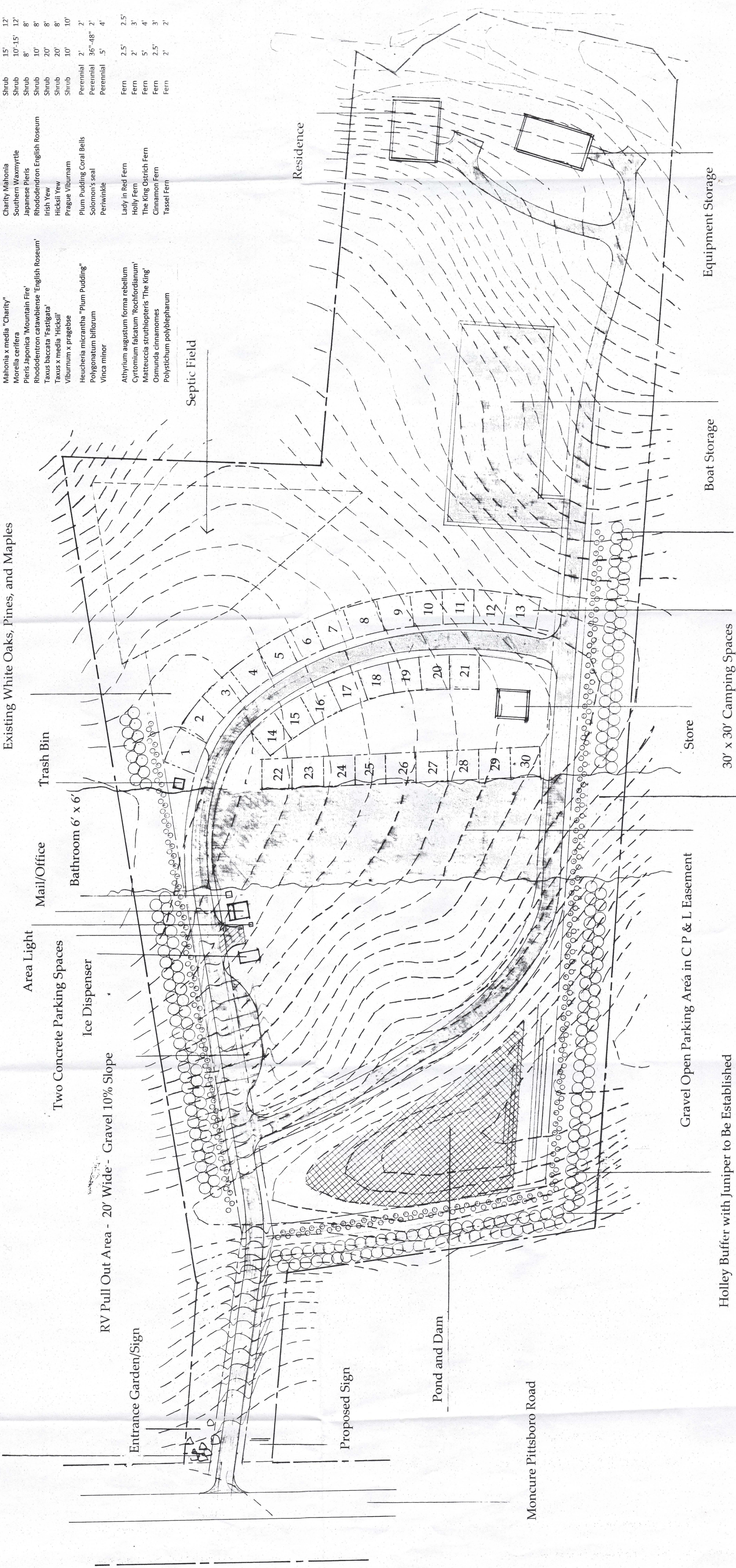

Holley Buffer with Juniper to Be Established

30' x 30' Camping Spaces

Holley Buffer with Juniper to Be Established

Equipment Storage

50' Stream Setback