



North Carolina Department of Environment and Natural Resources

Division of Water Quality

Pat McCrory
Governor

Charles Wakild, P. E.
Director

John E. Skvarla, III
Secretary

January 9, 2013

Kevin Graham, Vice President Operations
NNP Briar Chapel, LLC
16 Windy Knoll Circle
Chapel Hill, NC 27516

Subject: Permit No. WQ0036318
NNP Briar Chapel, LLC
Great Ridge Parkway Extension
Wastewater Collection System Extension
Chatham County

Dear Mr. Graham,

In accordance with your application received December 21, 2012, and additional information received on January 8, 2013, we are forwarding herewith Permit No. WQ0036318, dated January 9, 2013, to NNP Briar Chapel, LLC, for the construction and operation of the subject wastewater collection system extension. This permit shall be effective from the date of issuance until rescinded and shall be subject to the conditions and limitations as specified therein. This cover letter and supplement shall be considered a part of this permit and are therefore incorporated therein by reference.

Please pay particular attention to the following conditions contained within this permit:

Condition I.1: This permit shall be for the construction of the wastewater collection facilities only. No flow shall be made tributary to the subject facilities until a separate permit application has been received and a new permit issued for any future connections made to the sewer line permitted herein.

Condition II.4: Requires that the wastewater collection facilities be properly operated and maintained in accordance with 15A NCAC 2T .0403 or any individual system-wide collection system permit issued to the Permittee.

It shall be responsibility of NNP Briar Chapel, LLC, to ensure that the as-constructed project meets the appropriate design criteria and rules. Failure to comply may result in penalties in accordance with North Carolina General Statute §143-215.6A through §143-215.6C, construction of additional or replacement wastewater collection facilities, and/or referral of the North Carolina-licensed Professional Engineer to the licensing board.

NNP Briar Chapel, LLC
WQ0036318

If any parts, requirements, or limitations contained in this permit are unacceptable, you have the right to request an adjudicatory hearing upon written request within 30 days following receipt of this permit. This request must be in the form of a written petition, conforming to Chapter 150B of North Carolina General Statutes, and filed with the Office of Administrative Hearings, 6714 Mail Service Center, Raleigh, NC 27699-6714. Unless such demands are made, this permit shall be final and binding.

If you need additional information concerning this matter, please contact Barry Herzberg at (919) 791-4249 or via e-mail to Barry.Herzberg@ncdenr.gov.

Sincerely,



for Charles Wakild, P.E., Director
Division of Water Quality

by S. Daniel Smith
Surface Water Quality Supervisor
Raleigh Regional Office

cc: Grant Livengood, PE; McKim & Creed, 1730 Varsity Drive Suite 500, Raleigh, NC 27606
Chatham County Health Department
Raleigh Regional Office, Surface Water Protection Section
Water Quality Central Files
PERCS (electronic copy)



STATE OF NORTH CAROLINA
ENVIRONMENTAL MANAGEMENT COMMISSION
DEPARTMENT OF ENVIRONMENT AND NATURAL RESOURCES

WASTEWATER COLLECTION SYSTEM EXTENSION PERMIT

In accordance with the provisions of Article 21 of Chapter 143, General Statutes of North Carolina as amended, and other applicable Laws, Rules, and Regulations, permission is hereby granted to

NNP Briar Chapel, LLC
Chatham County

for the construction and operation of approximately 4,295 linear feet of 8-inch gravity sewer to serve as an interceptor line as part of the Great Ridge Parkway Extension project, and the discharge of no additional gallons per day of collected domestic wastewater into the Briar Chapel Utilities existing sewerage system, pursuant to the application received December 21, 2012, and additional information received January 8, 2013, and in conformity with 15A NCAC 2T; the Division's Gravity Sewer Minimum Design Criteria adopted February 12, 1996 as applicable; the Division's Minimum Design Criteria for the Fast-Track Permitting of Pump Stations and Force Mains adopted June 1, 2000 as applicable; and other supporting data subsequently filed and approved by the Department of Environment and Natural Resources and considered a part of this permit.

This permit shall be effective from the date of issuance until rescinded and shall be subject to the specified conditions and limitations contained therein.

Permit issued this the 9th Day of January 2013.

for Charles Wakild, P.E., Director
Division of Water Quality
By Authority of The Environmental Management Commission

Permit Number: WQ0036318

SUPPLEMENT TO PERMIT COVER SHEET

NNP Briar Chapel, LLC, is hereby authorized to:

Construct, and then operate upon certification the aforementioned wastewater collection extension. The sewage and wastewater collected by this system, prior to being land applied by spray irrigation, shall be treated in the Briar Chapel Utilities Wastewater Treatment Facility, WQ0028552.

Permitting of this project does not constitute an acceptance of any part of the project that does not meet 15A NCAC 2T; the Division of Water Quality's (Division) Gravity Sewer Minimum Design Criteria adopted February 12, 1996 as applicable; and the Division's ~~Minimum Design Criteria~~ for the Fast-Track Permitting of Pump Stations and Force Mains adopted June 1, 2000 as applicable, unless specifically mentioned herein. Division approval is based on acceptance of the certification provided by a North Carolina-licensed Professional Engineer in the application. It shall be the Permittee's responsibility to ensure that the as-constructed project meets the appropriate design criteria and rules.

Construction and operation is contingent upon compliance with the Standard Conditions and any Special Conditions identified below.

I. SPECIAL CONDITIONS

1. This permit shall be for the construction of the wastewater collection facilities only. No flow shall be made tributary to the subject facilities until a separate permit application has been received and a new permit issued for any future connections made to the sewer line permitted herein.

II. STANDARD CONDITIONS

1. **This permit shall not be transferable.** In the event there is a desire for the wastewater collection facilities to change ownership, or there is a name change of the Permittee, a formal permit request shall be submitted to the Division accompanied by documentation from the parties involved, and other supporting materials as may be appropriate. The approval of this request shall be considered on its merits and may or may not be approved.
2. This permit shall become voidable unless the wastewater collection facilities are constructed in accordance with the conditions of this permit; 15A NCAC 2T; the Division of Water Quality's (Division) Gravity Sewer Minimum Design Criteria adopted February 12, 1996 as applicable; the Division's Minimum Design Criteria for the Fast-Track Permitting of Pump Stations and Force Mains adopted June 1, 2000 as applicable; and other supporting materials unless specifically mentioned herein.
3. This permit shall be effective only with respect to the nature and volume of wastes described in the application and other supporting data.
4. The wastewater collection facilities shall be properly maintained and operated at all times. The Permittee shall maintain compliance with an individual system-wide collection system permit for the operation and maintenance of these facilities as required by 15A NCAC 2T .0403. If an individual permit is not required, the following performance criteria shall be met as provided in 15A NCAC 2T .0403:
 - a. The sewer system shall be effectively maintained and operated at all times to prevent discharge to land or surface waters, and to prevent any contravention of groundwater standards or surface water standards.
 - b. A map of the sewer system shall be developed and shall be actively maintained.
 - c. An operation and maintenance plan including pump station inspection frequency, preventative maintenance schedule, spare parts inventory and overflow response has been developed and implemented.
 - d. Pump stations that are not connected to a telemetry system shall be inspected every day (i.e. 365 days per year). Pump stations that are connected to a telemetry system shall be inspected at least once per week.

- e. High-priority sewer lines shall be inspected at least once per every six-months and inspections are documented.
- f. A general observation of the entire sewer system shall be conducted at least once per year.
- g. Overflows and bypasses shall be reported to the appropriate Division regional office in accordance with 15A NCAC 2B .0506(a), and public notice shall be provided as required by North Carolina General Statute §143-215.1C.
- h. A Grease Control Program is in place as follows:
 - 1. For public owned collection systems, the Grease Control Program shall include at least biannual distribution of educational materials for both commercial and residential users and the legal means to require grease interceptors at existing establishments. The plan shall also include legal means for inspections of the grease interceptors, enforcement for violators and the legal means to control grease entering the system from other public and private satellite sewer systems.
 - 2. For privately owned collection systems, the Grease Control Program shall include at least bi-annual distribution of grease education materials to users of the collection system by the Permittee or its representative.
 - 3. Grease education materials shall be distributed more often than required in Parts (1) and (2) of this Subparagraph if necessary to prevent grease-related sanitary sewer overflows.
- i. Right-of-ways and easements shall be maintained in the full easement width for personnel and equipment accessibility.
- j. Documentation shall be kept for Subparagraphs (a) through (i) of this Rule for a minimum of three years with exception of the map, which shall be maintained for the life of the system.

5. **Noncompliance Notification:**

The Permittee shall report by telephone to a water quality staff member at the Raleigh Regional Office, telephone number 919-791-4200, as soon as possible, but in no case more than 24 hours or on the next working day, following the occurrence or first knowledge of the occurrence of either of the following:

- a. Any process unit failure, due to known or unknown reasons, that renders the facility incapable of adequate wastewater transport, such as mechanical or electrical failures of pumps, line blockage or breakage, etc.; or
- b. Any SSO and/or spill over 1,000 gallons; or
- c. Any SSO and/or spill, regardless of volume, that reaches surface water

Voice mail messages or faxed information is permissible, but this shall not be considered as the initial verbal report. Overflows and spills occurring outside normal business hours may also be reported to the Division of Emergency Management at telephone number (800) 858-0368 or (919) 733-3300. Persons reporting any of the above occurrences shall file a spill report by completing and submitting Part I of Form CS-SSO (or the most current Division approved form) within five days following first knowledge of the occurrence. This report must outline the actions taken or proposed to be taken to ensure that the problem does not recur. Part II of Form CS-SSO (or the most current Division approved form) can also be completed to show that the SSO was beyond control.

- 6. Construction of the gravity sewers, pump stations, and force mains shall be scheduled so as not to interrupt service by the existing utilities nor result in an overflow or bypass discharge of wastewater to the surface waters of the State.
- 7. Per 15A NCAC 2T.0116, upon completion of construction and prior to operation of these permitted facilities, the completed Engineering Certification form attached to this permit shall be submitted with the required supporting documents to the address provided on the form. A complete certification is one where the form is fully executed and the supporting documents are provided as applicable. Any wastewater flow made tributary to the wastewater collection system extension prior to completion of this Engineer's Certification shall be considered a violation of the permit and shall subject the Permittee to appropriate enforcement actions.

If the permit is issued to a private entity with an Operational Agreement, then a copy of the Articles of Incorporation, Declarations/Covenants/Restrictions, and Bylaws that have been appropriately filed with the applicable County's Register of Deeds office shall be submitted with the certification.

A complete certification is one where the form is fully executed and the supporting documents are provided as applicable. Supporting documentation shall include the following:

- a. One copy of the project construction record drawings (plan & profile views of sewer lines & force mains) of the wastewater collection system extension. Final record drawings should be clear on the plans or on digital media (CD or DVD disk) and are defined as the design drawings that are marked up or annotated with after construction information and show required buffers, separation distances, material changes, etc.
- b. One copy of the supporting pump station design calculations (selected pumps, system curve, operating point, buoyancy calculations, available storage if portable generator(s) or storage greater than longest past three year outage reliability option selected) for any pump stations permitted as part of this project.
- c. Changes to the project that do not result in non-compliance with this permit, regulations, or the Minimum Design Criteria should be clearly identified on the record drawings, on the certification in the space provided, or in written summary form.

Prior to Certification (Final or Partial): Permit modifications are required for any changes resulting in non-compliance with this permit (including pipe length increases of 10% or greater, increased flow, pump station design capacity design increases of 5% or greater, and increases in the number/type of connections), regulations, or the Minimum Design Criteria. Requested modifications or variances to the Minimum Design Criteria will be reviewed on a case-by-case basis and each on its own merit. Please note that variances to the Minimum Design Criteria should be requested and approved during the permitting process prior to construction. After-construction requests are discouraged by the Division and may not be approved, thus requiring replacement or repair prior to certification & activation.

8. A copy of the construction record drawings shall be maintained on file by the Permittee for the life of the wastewater collection facilities.
9. Failure to abide by the conditions and limitations contained in this permit; 15A NCAC 2T; the Division's Gravity Sewer Design Criteria adopted February 12, 1996 as applicable; the Division's Minimum Design Criteria for the Fast-Track Permitting of Pump Station and Force Mains adopted June 1, 2000 as applicable; and other supporting materials may subject the Permittee to an enforcement action by the Division, in accordance with North Carolina General Statutes §143-215.6A through §143-215.6C, construction of additional or replacement wastewater collection facilities, and/or referral of the North Carolina-licensed Professional Engineer to the licensing board.
10. In the event that the wastewater collection facilities fail to perform satisfactorily, including the creation of nuisance conditions, the Permittee shall take immediate corrective action, including those as may be required by this Division, such as the construction of additional or replacement facilities.
11. The issuance of this permit shall not exempt the Permittee from complying with any and all statutes, rules, regulations, or ordinances that may be imposed by other government agencies (local, state and federal) which have jurisdiction, including but not limited to applicable river buffer rules in 15A NCAC 2B .0200, erosion and sedimentation control requirements in 15A NCAC Ch. 4 and under the Division's General Permit NCG010000, and any requirements pertaining to wetlands under 15A NCAC 2B .0200 and 15A NCAC 2H .0500.

FAST TRACK ENGINEERING CERTIFICATION

Permittee: NNP Briar Chapel, LLC
Project: Great Ridge Parkway Extension

Permit No. WQ0036318
Issue Date: January 9, 2013

Complete and submit this form to the permit issuing regional office with the following:

- One copy of the project record drawings (plan & profile views and detail drawings of sewer lines) of the wastewater collection system extension. Final record drawings should be clear on the plans or on digital media (CD or DVD disk) in pdf format. Record drawings should indicate the design and the marked up changes during construction.
- Supporting design calculations (selected pumps, system curve, operating point, available storage if portable generator(s) or storage greater than longest past three year outage reliability option selected) for any pump stations permitted as part of this project
- Changes to the project should be clearly identified on the record drawings or in written summary form. **Permit modifications are required for any changes resulting in non-compliance with this permit, regulations or minimum design criteria. Modifications should be submitted prior to certification.**

This project shall not be considered complete nor allowed to operate until the Division has received this Engineer's Certification and all required supporting documentation. **Therefore, it is highly recommended that this certification be sent in a manner that provides proof of receipt by the Division.**

PERMITTEE'S CERTIFICATION

I, _____, the undersigned agent for the Permittee, hereby state that this project has been constructed pursuant to the applicable standards & requirements, the Professional Engineer below has provided applicable design/construction information to the Permittee, and the Permittee is prepared to operate & maintain the wastewater collection system permitted herein or portions thereof.

| | | |
|---------------------|-----------|------|
| | | |
| Printed Name, Title | Signature | Date |

ENGINEER'S CERTIFICATION

Partial Final

I, _____, as a duly registered Professional Engineer in the State of North Carolina, having been authorized to observe (periodically, weekly, full time) the construction of the subject project for the Permittee hereby state that, to the best of my abilities, due care and diligence was used in the observation of the construction such that the construction was observed to be built within substantial compliance of this permit; 15A NCAC 02T; the Division of Water Quality's (Division) Gravity Sewer Minimum Design Criteria adopted February 12, 1996 as applicable; the Division's Minimum Design Criteria for the Fast-Track Permitting of Pump Stations and Force Mains adopted June 1, 2000 as applicable; and other supporting materials.

North Carolina Professional Engineer's Seal, signature, and date:

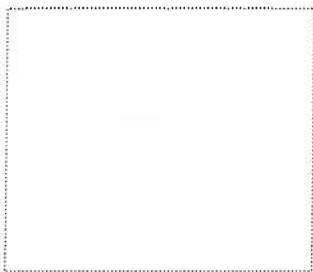

SEND THIS FORM & SUPPORTING DOCUMENTATION WITH REQUIRED ATTACHMENTS TO THE FOLLOWING ADDRESS

**Surface Water Protection Supervisor
Raleigh Regional Office
1628 Mail Service Center
Raleigh, NC 27699-1628**

The Permittee is responsible for tracking all partial certifications up until a final certification is received. Any wastewater flow made tributary to the wastewater collection system extension prior to completion of this Engineer's Certification shall be considered a violation of the permit and shall subject the Permittee to appropriate enforcement actions.

DWQ use only:

Flow from this project is tributary to: Briar Chapel



North Carolina Department of Environment and Natural Resources

Division of Water Quality

Coleen H. Sullins

Director

Beverly Eaves Perdue
Governor

Dee Freeman
Secretary

May 18, 2009

WILLIAM MUMFORD – ASSISTANT SECRETARY
BRIAR CHAPEL UTILITIES, LLC
16 WINDY KNOLL CIRCLE
CHAPEL HILL, NORTH CAROLINA 27516

Subject: Permit No. WQ0028552
Briar Chapel Development
Wastewater Treatment, Irrigation
and Non-Conjunctive Reclaimed
Water Utilization System
Chatham County

Dear Mr. Mumford:

In accordance with your permit modification request received April 23, 2009, and subsequent additional information received May 7, 2009, we are forwarding herewith Permit No. WQ0028552, dated May 18, 2009, to Briar Chapel Utilities, LLC for the continued operation of the Phase A wastewater treatment plant, 5-day upset pond and main wet weather storage pond, and the construction and operation of the remaining subject wastewater treatment, wastewater irrigation and non-conjunctive reclaimed water utilization facilities.

The subject modification is to add approximately 9.5 acres of non-conjunctive reclaimed utilization area along the existing parkway between US 15-501 and the bridge at Pokeberry Creek. This additional utilization area shall be known as Phase 1C.

This permit shall be effective from the date of issuance until March 31, 2010, shall void Permit No. WQ0028552 issued May 22, 2008, and shall be subject to the conditions and limitations as specified therein. Please pay particular attention to the monitoring requirements in this permit. Failure to establish an adequate system for collecting and maintaining the required operational information will result in future compliance problems.

Please note this permit contains two new permit conditions since the last permit issuance. Please review these conditions carefully:

- Condition I.3. – This condition requires the Permittee to abandon water supply well WSW-38 prior to operation of Phase 1C spray heads that throw within 100 feet of the aforementioned well.

AQUIFER PROTECTION SECTION

1636 Mail Service Center, Raleigh, North Carolina 27699-1636

Location: 2726 Capital Boulevard, Raleigh, North Carolina 27604

Phone: 919-733-3221 \ FAX 1: 919-715-0588; FAX 2: 919-715-6048 \ Customer Service: 1-877-623-6748

Internet: www.ncwaterquality.org

An Equal Opportunity \ Affirmative Action Employer

One
North Carolina
Naturally

- Condition II.17. – This condition requires the Permittee to aerate those areas in Phase 1C affected by significant compaction prior to any utilization of reclaimed water on those sites.

If any parts, requirements, or limitations contained in this permit are unacceptable, you have the right to request an adjudicatory hearing upon written request within thirty (30) days following receipt of this permit. This request must be in the form of a written petition, conforming to Chapter 150B of the North Carolina General Statutes, and filed with the Office of Administrative Hearings, 6714 Mail Service Center, Raleigh, NC 27699-6714. Unless such demands are made this permit shall be final and binding.

One set of approved plans and specifications is being forwarded to you. If you need additional information concerning this matter, please contact Nathaniel Thornburg at (919) 715-6160 or nathaniel.thornburg@ncdenr.gov.

Sincerely,

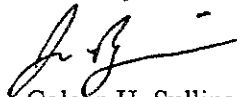
Coleen H. Sullins

cc: Chatham County Health Department
Raleigh Regional Office, Aquifer Protection Section
Mark P. Ashness, PE – CE Group
Technical Assistance and Certification Unit
APS Central Files
LAU Files

NORTH CAROLINA
ENVIRONMENTAL MANAGEMENT COMMISSION
DEPARTMENT OF ENVIRONMENT AND NATURAL RESOURCES
RALEIGH

**WASTEWATER TREATMENT, WASTEWATER IRRIGATION AND NON-CONJUNCTIVE
RECLAIMED WATER UTILIZATION SYSTEM PERMIT**

In accordance with the provisions of Article 21 of Chapter 143, General Statutes of North Carolina as amended, and other applicable Laws, Rules, and Regulations

PERMISSION IS HEREBY GRANTED TO

Briar Chapel Utilities, LLC
Chatham County

FOR THE

operation of a wastewater treatment, wastewater irrigation and non-conjunctive reclaimed water utilization facility consisting of the:

continued operation of a 250,000 gallon per day (GPD) extended aeration wastewater treatment plant (i.e., Phase A) consisting of: dual static screens for grit removal (serving Phases A, B and C); a manually cleaned bar screen; a 75,400 gallon aerated flow equalization basin with two (2) 225 gallon per minute (GPM) variable speed pumps each with an influent flow meter and one (1) 7.5 horsepower (hp) aerator; two (2) 31,500 gallon anoxic chambers each with two (2) 3 hp mixers; two (2) 189,000 gallon aeration basins each with two (2) 10 hp aerators; two (2) 31,500 gallon clarifiers each with one (1) variable speed sludge return pump; a 75,400 gallon sludge holding basin with one (1) variable speed decanting pump and one (1) 7.5 hp aerator; a 10,730 gallon chlorine contact chamber with two (2) variable speed chlorine injection pumps; a 16,800 gallon mudwell with two (2) 200 GPM return pumps; two (2) 90 square foot (ft²) tertiary filters; a 13,800 gallon clearwell with four (4) 675 GPM backwash pumps (pumps serve Phases A, B and C); dual banks of ultraviolet (UV) modules each with 10 bulbs; a 6,850 gallon dechlorination chamber with two (2) air diffusers; an effluent flow measuring device (serving Phases A, B and C); an effluent turbidimeter (serving Phases A, B and C); a permanent auxiliary generator (serving Phases A, B and C); and all associated piping, valves and appurtenances; the

continued operation of: a 3.5 million gallon (MG) clay lined five day upset pond with a 400 GPM dual submersible pumps station and audible/visual alarms; and a 21.3 MG clay lined central storage pond with dual 2,000 GPM flooded suction pumps; the

construction and operation of two additional 250,000 GPD extended aeration wastewater treatment plants to be constructed (i.e., Phases B and C) with each phase consisting of: a manually cleaned bar screen; a 75,400 gallon aerated flow equalization basin with two (2) 225 GPM variable speed pumps each with an influent flow meter and one (1) 7.5 hp aerator; two (2) 31,500 gallon anoxic chambers each with two (2) 3 hp mixers; two (2) 189,000 gallon aeration basins each with two (2) 10 hp aerators; two (2) 31,500 gallon clarifiers each with one (1) variable speed sludge return pump; a 75,400 gallon sludge holding basin with one (1) variable speed decanting pump and one (1) 7.5 hp aerator; a 10,730 gallon chlorine contact chamber with two (2) variable speed chlorine injection pumps; a 16,800 gallon mudwell with two (2) 200 GPM return pumps; two (2) 90 ft² tertiary filters; dual banks of ultraviolet (UV) modules each with 10

bulbs; a 6,850 gallon dechlorination chamber with two (2) air diffusers; and all associated piping, valves and appurtenances; the

construction and operation of a 253,027 GPD reclaimed water utilization system (Phase 1A: Fields C-1A through E-4C) consisting of: thirty-five (35) irrigation zones comprising approximately 82.2 acres; a 14.1 MG clay lined east storage pond with dual 1,200 GPM vertical turbine pumps serving nine (9) irrigation zones consisting of approximately 42.1 acres; and all associated piping, valves and appurtenances; the

construction and operation of a 51,499 GPD wastewater irrigation system (Phase 1B: Fields B-1A through B-9C) consisting of: sixteen (16) irrigation zones comprising approximately 22.0 acres; and all associated piping, valves and appurtenances; and the

construction and operation of a 21,749 GPD non-conjunctive reclaimed water utilization system (Phase 1C) consisting of: one (1) irrigation zone comprising approximately 9.48 acres; and all associated piping, valves and appurtenances; and the

to serve the Briar Chapel Development, with no discharge of wastes to the surface waters, pursuant to the application received April 23, 2009, and subsequent additional information received by the Division of Water Quality (Division), and in conformity with the project plan, specifications, and other supporting data subsequently filed and approved by the Department of Environment and Natural Resources and considered a part of this permit.

This permit shall be effective from the date of issuance until March 31, 2010, shall void Permit No. WQ0028552 issued May 22, 2008, and shall be subject to the following specified conditions and limitations:

I. SCHEDULES

1. Upon completion of construction and prior to operation of this permitted facility, a certification (see attached form) must be received from a professional engineer certifying that the permitted facility has been installed in accordance with this permit, the approved plans and specifications, and other supporting materials including the location of all monitoring wells as applicable. If this project is to be completed in phases and partially certified, you shall retain the responsibility to track further construction approved under the same permit, and shall provide a final certificate of completion once the entire project has been completed. Mail the Certification to the Aquifer Protection Section, Division of Water Quality, 1636 Mail Service Center, Raleigh, NC 27699-1636.
2. The Raleigh Regional Office, telephone number (919) 791-4200, shall be notified at least forty-eight (48) hours in advance (excluding weekends and holidays) of operation of the installed facilities so that an in-place inspection can be made. Such notification to the regional supervisor shall be made during the normal office hours from 8:00 a.m. until 5:00 p.m. on Monday through Friday, excluding State Holidays.
3. Prior to operation of any Phase 1C spray heads that throw within 100 feet of water supply well WSW-38, said well shall be permanently abandoned. Within thirty (30) days of abandonment, a Well Abandonment Record (GW-30 form) that lists this permit number and the appropriate well identification number shall be completed for each well abandoned and mailed to N.C. Division of Water Quality, Aquifer Protection Section, 1636 Mail Service Center, Raleigh, N.C. 27699-1636. The well shall be abandoned by a North Carolina Certified Well Contractor according to the North Carolina Well Construction Standards (15A NCAC 02C .0113) and local county rules.

4. No later than six months prior to the expiration of this permit, the Permittee shall request renewal of this permit on official Division forms. Upon receipt of the request, the Division will review the adequacy of the facilities described therein, and if warranted, will renew the permit for such period of time and under such conditions and limitations as it may deem appropriate. Please note that Rule 15A NCAC 02T .0105(d) requires an updated site map to be submitted with the permit renewal application.
5. Prior to commencement of irrigation, an updated soil scientist site evaluation shall be submitted for all areas that have been significantly impacted during construction or altered by grading, cutting or filling. This report shall specifically address, but not be limited to, soil features such as soil compaction and saturated hydraulic conductivity of the least permeable layer, as well as any other properties that might impact the soil's ability to accept irrigation water. The report shall certify that the disturbed areas are capable of accepting the designed annual hydraulic loading rate. The requested information must be received and acknowledged in writing by the Aquifer Protection Section, 1628 Mail Service Center, Raleigh, NC 27699-1628, prior to any irrigation of wastewater.

II. PERFORMANCE STANDARDS

1. The wastewater irrigation and non-conjunctive reclaimed water utilization facilities shall be effectively maintained and operated at all times so that there is no discharge to the surface waters, nor any contravention of groundwater or surface water standards. In the event that the facilities fail to perform satisfactorily, including the creation of nuisance conditions due to improper operation and maintenance, or failure of the irrigation area to adequately assimilate the wastewater, the Permittee shall take immediate corrective actions including those actions that may be required by the Division, such as the construction of additional or replacement wastewater treatment and disposal facilities.
2. The issuance of this permit shall not relieve the Permittee of the responsibility for damages to ground or surface waters resulting from the operation of this facility.
3. Effluent limitations shall not exceed those specified in Attachment A.
4. Application rates, whether hydraulic, nutrient, or other pollutant shall not exceed those specified in Attachment B.
5. The compliance and review boundaries for the specified reclaimed utilization areas (i.e., Phase 1A) are established at the property boundary. Any exceedance of standards at the Compliance or Review Boundary shall require action in accordance with 15A NCAC 02L .0106.
6. The compliance and review boundaries for the specified reclaimed utilization areas (i.e., Phase 1C) and the wastewater irrigation areas complying with 15A NCAC 02T .0506(c) (i.e., Phase 1B) are established at the irrigation/utilization area boundaries. Any exceedance of standards at the Compliance or Review Boundary shall require action in accordance with 15A NCAC 02L .0106.
7. The Permittee shall apply for a permit modification prior to any sale or transfer of property that affects a compliance boundary to establish a new compliance boundary.
8. In accordance with 15A NCAC 02L .0107(d), no wells, other than monitoring wells, shall be constructed within the compliance boundary except as provided by 15A NCAC 02L .0107(g).

9. Except as provided for in 15A NCAC 02L .0107(g), the Permittee shall ensure that any landowner who owns land within the compliance boundary, but who is not the Permittee, shall execute and file with the Register of Deeds in the county in which the land is located an easement running with the land that contains the following items:
- a. A notice of the permit and number or other description as allowed in 15A NCAC 02L .0107(f)(1);
 - b. Prohibits construction and operation of water supply wells within the compliance boundary; and
 - c. Reserves the right of the Permittee or the State to enter the property within the compliance boundary for purposes related to the permit.

The Director may terminate the easement when its purpose has been fulfilled or is no longer needed.

10. The facilities permitted herein must be constructed according to the following setbacks:

- a. The setbacks for reclaimed utilization sites (Phase 1A & Phase 1C) shall be as follows (all distances in feet):

| | |
|--|-----|
| i. Surface waters not classified SA: | 25 |
| ii. Surface waters classified SA: | 100 |
| iii. Any well with exception to monitoring wells | 100 |

- b. The setbacks for the wastewater irrigation sites (Phase 1B) shall be as follows (all distances in feet):

| | |
|--|-------|
| a. Any habitable residence or place of public assembly under separate ownership: | 400 |
| b. Any habitable residence or place of public assembly owned by the Permittee: | 200 |
| c. Any private or public water supply source: | 100 |
| d. Surface waters: | 100 |
| e. Groundwater lowering ditches: | 100 |
| f. Surface water diversions: | 25 |
| g. Any well with exception of monitoring wells: | 100 |
| h. Any property line: | 150 * |
| i. Top of slope of embankments or cuts of two feet or more in vertical height: | 15 |
| j. Any water line from a disposal system: | 10 |
| k. Subsurface groundwater lowering drainage systems: | 100 |
| l. Any swimming pool: | 100 |
| m. Public right of way: | 50 |
| n. Nitrification field: | 20 |
| o. Any building foundation or basement: | 15 |

* Setback may be reduced to zero in accordance with 15A NCAC 2T .0506(c).

- c. The setbacks for treatment and storage units shall be as follows (all distances in feet):

| | |
|--|-----|
| i. Any habitable residence or place of public assembly under separate ownership: | 100 |
| ii. Any private or public water supply source: | 100 |
| iii. Surface waters: | 50 |
| iv. Any well with exception of monitoring wells: | 100 |
| v. Any property line: | 50 |

11. The following shall be requirements for the reclaimed water distribution, storage, and utilization facilities (at a minimum Phase 1A & Phase 1C, but may include Phase 1B at the Permittee's discretion):
 - a. All reclaimed water valves, storage facilities, and outlets shall be tagged or labeled to warn the public or employees that the water is not intended for drinking. Where appropriate, such warning shall inform the public or employees to avoid contact with the water.
 - b. All reclaimed water piping, valves, outlets, and other appurtenances shall be color-coded, taped, or otherwise marked to identify the source of the water as being reclaimed water.
 - i. All reclaimed water piping and appurtenances shall be either colored purple (i.e., Pantone 522) and embossed or integrally stamped or marked "CAUTION: RECLAIMED WATER – DO NOT DRINK" or be installed with a purple (i.e., Pantone 522) identification tape or polyethylene vinyl wrap. The warning shall be stamped on opposite sides of the pipe and repeated every three feet or less.
 - ii. Identification tape shall be at least three inches wide and have white or black lettering on purple (i.e., Pantone 522) field stating "CAUTION: RECLAIMED WATER – DO NOT DRINK." Identification tape shall be installed on top of reclaimed water pipelines, fastened at least every 10 feet to each pipe length and run continuously the entire length of the pipe.
 - c. All reclaimed water valves and outlets shall be of a type, or secured in a manner, that permits operation by authorized personnel only.
 - d. Above-ground hose bibs (i.e., spigots or other hand-operated connections) shall not be present. Hose bibs shall be located in locked below-grade vaults that shall be clearly labeled as being of non-potable quality. As an alternative to the use of locked below-grade vaults with standard hose bib services, hose bibs, which can only be operated by a special tool or connected to a special hose connection, may be placed in non-lockable underground services boxes clearly labeled as non-potable water.
12. The Permittee shall maintain an active cross-connection control program that shall have the following minimum requirements (at a minimum Phase 1A & Phase 1C, but may include Phase 1B at the Permittee's discretion):
 - a. No direct cross-connections shall be allowed between the reclaimed water and potable water systems.
 - b. A reduced pressure principle backflow preventer, an approved air gap separation, or other device approved by the Division of Environmental Health shall be installed at the potable water service connection to the use area where both reclaimed water and potable water are supplied to a reclaimed water use area. The installation of the reduced pressure principle backflow prevention device shall allow proper testing.
 - c. An air gap separation, approved and regularly inspected by the Permittee shall be provided between the potable water and reclaimed water systems where potable water is used to supplement a reclaimed water system.
13. Reclaimed water distribution lines (at a minimum Phase 1A & Phase 1C, but may include Phase 1B at the Permittee's discretion) shall be located 10 feet horizontally from and 18 inches below any water line where practicable. Where these separation distances cannot be met, the piping and integrity testing procedures shall meet water main standards in accordance with 15A NCAC 18C.
14. Reclaimed water distribution lines (at a minimum Phase 1A & Phase 1C, but may include Phase 1B at the Permittee's discretion) shall not be less than 100 feet from a well unless the piping and integrity testing procedures meet water main standards in accordance with 15A NCAC 18C, but no case shall they be less than 25 feet from a private well or 50 feet from a public well.

15. Reclaimed water distribution lines (at a minimum Phase 1A & Phase 1C, but may include Phase 1B at the Permittee's discretion) shall meet the separation distances to sewer lines in accordance with Rule .0305 of Subchapter 02T.
16. The wastewater irrigation and reclaimed water utilization systems shall be connected to a rain or moisture sensor that shall indicate when reclaimed water application is not appropriate in accordance with Condition III.4. and III.5. of this permit.
17. Areas in Phase 1C affected by significant compaction shall be identified and the soil aerated prior to any irrigation in Zone C with reclaimed water.

III. OPERATION AND MAINTENANCE REQUIREMENTS

1. The facilities shall be properly maintained and operated at all times. The facilities shall be effectively maintained and operated as a non-discharge system to prevent the discharge of any wastewater resulting from the operation of this facility. The Permittee shall maintain an Operation and Maintenance Plan pursuant to 15A NCAC 02T .0507 & .0913 including operational functions, maintenance schedules, safety measures, and a spill response plan.
2. Upon classification of the wastewater treatment, wastewater irrigation and non-conjunctive reclaimed water utilization facilities by the Water Pollution Control System Operators Certification Commission (WPCSOCC), the Permittee shall designate and employ a certified operator to be in responsible charge (ORC) and one or more certified operator(s) to be back-up ORC(s) of the facilities in accordance with 15A NCAC 08G .0200. The ORC shall visit the facilities in accordance with 15A NCAC 08G .0200 or as specified in this permit and shall comply with all other conditions specified in these rules.
3. A suitable year round vegetative cover shall be maintained such that crop health is optimized, allows for even distribution of effluent, and allows inspection of the wastewater irrigation and non-conjunctive reclaimed water utilization systems.
4. Adequate measures shall be taken to prevent wastewater ponding or runoff from the wastewater irrigation and non-conjunctive reclaimed water utilization sites.
5. Wastewater irrigation and non-conjunctive reclaimed water utilization shall not be performed during inclement weather or when the ground is in a condition that will cause ponding or runoff.
6. All waste application equipment must be tested and calibrated at least once per permit cycle. Records of the calibration must be maintained for five years.
7. No type of wastewater other than that from the Briar Chapel Development shall be applied to the wastewater irrigation and non-conjunctive reclaimed water utilization sites.
8. An automatically activated standby power source shall be on site and operational at all times capable of powering all essential treatment units. If a generator is employed as an alternate power supply, it shall be tested weekly by interrupting the primary power source.
9. No traffic or equipment shall be allowed on the wastewater irrigation and non-conjunctive reclaimed water utilization sites except while installation occurs or while normal maintenance is being performed.
10. Public access to the land application sites shall be controlled.
11. The residuals generated from these treatment facilities must be disposed / utilized in accordance with 15A NCAC 02T .1100. The Permittee shall maintain a residual management plan pursuant to 15A NCAC 02T .0508 & .0914.

12. Diversion or bypassing of the untreated wastewater from the treatment facilities is prohibited.
13. Freeboard in the five-day upset pond, central storage pond and east storage pond shall not be less than two (2) feet at any time.
14. Gauges to monitor waste levels in the five-day upset pond, central storage pond and east storage pond shall be provided. These gauges shall have readily visible permanent markings indicating the maximum liquid level at the top of the temporary liquid storage volume, minimum liquid level at the bottom of the temporary liquid storage volume, and the lowest point on top of the dam elevations.
15. A protective vegetative cover shall be established and maintained on all earthen basin embankments (outside toe of embankment to maximum allowable temporary storage elevation on the inside of the embankment), berms, pipe runs, erosion control areas, and surface water diversions. Trees, shrubs, and other woody vegetation shall not be allowed to grow on the earthen basin dikes or embankments. Earthen basin embankment areas shall be kept mowed or otherwise controlled and accessible.
16. All wastewater shall be routed to the five-day holding pond should the limit for fecal coliform (daily maximum concentration of 25 per 100 ml) or turbidity (instantaneous maximum of 10 NTU) be exceeded, until such time that the problems associated with the treatment capability of the wastewater treatment plant have been corrected. The wastewater in the five-day holding pond shall be pumped back to the treatment plant for re-treatment or treated in the five-day pond prior to discharge to the storage pond.
17. The permitted wastewater treatment facility shall treat domestic strength wastewater only. The wastewater treatment plant shall not accept any wastewater from commercial facilities deemed industrial (i.e., from processes of trade or business, Laundromats, or vehicle/equipment washes) per Regulation 15A NCAC 2T .0103(20).

IV. MONITORING AND REPORTING REQUIREMENTS

1. Any monitoring (including groundwater, surface water, soil or plant tissue analyses) deemed necessary by the Division to ensure surface and ground water protection will be established and an acceptable sampling reporting schedule shall be followed.
2. All laboratory analyses for effluent, ground waters, or surface waters shall be made by a laboratory certified by the Division for the required parameter(s) under 15A NCAC 02H .0800.
3. Flow through the treatment facility shall be continuously monitored and daily flow values shall be reported on Form NDMR.

The Permittee shall install and maintain an appropriate flow measurement device consistent with approved engineering and scientific practices to ensure the accuracy and reliability of flow measurement. Flow measurement devices selected shall be capable of measuring flows with a maximum deviation of less than 10 percent from true flow, accurately calibrated at a minimum of once per year, and maintained to ensure that the accuracy of the measurements is consistent with the accepted capability of that type of device. The Permittee shall keep records of flow measurement device calibration on file for a period of at least three years. At a minimum, data to be included in this documentation shall be:

- a. Date of flow measurement device calibration,
 - b. Name of person performing calibration, and
 - c. Percent from true flow.
4. The effluent from the subject facilities shall be monitored by the Permittee at the frequencies and locations for the parameters specified in Attachment A.

5. The Permittee tracking the amount of wastewater irrigation and non-conjunctive reclaimed water utilization shall maintain adequate records. These records shall include, but are not necessarily limited to, the following information:
 - a. Date of wastewater irrigation and non-conjunctive reclaimed water utilization,
 - b. Volume of wastewater irrigated and reclaimed water utilized,
 - c. Field irrigated/utilized,
 - d. Length of time field is irrigated/utilized,
 - e. Continuous weekly, monthly, and year-to-date hydraulic (inches/acre) loadings for each field,
 - f. Continuous monthly and year-to-date loadings for any non-hydraulic parameter specifically limited in Attachment B for each field,
 - g. Weather conditions, and
 - h. Maintenance of cover crops.
6. Freeboard (waste level to the lowest elevation on the top of the embankment) in the 5-day upset pond, central storage pond and east storage pond shall be recorded weekly.
7. A record shall be maintained of all residuals removed from this facility. This record shall include the name of the hauler, permit authorizing the disposal or a letter from a municipality agreeing to accept the residuals, date the residuals were hauled, and volume of residuals removed.
8. A maintenance log shall be maintained at this facility including but not limited to the following items:
 - a. Visual observations of the plant and plant site.
 - b. Record of preventative maintenance (i.e., changing of equipment, adjustments, testing, inspections and cleanings, etc.).
 - c. Date of calibration of flow measurement device.
 - d. Date and results of power interruption testing on alternate power supply.
9. Three (3) copies of all monitoring data [as specified in Conditions IV.3. and IV.4.] on Form NDMR for each PPI and three (3) copies of all operation and disposal records [as specified in Conditions IV.5 and IV.6.] on Form NDAR-1 for every field shall be submitted on or before the last day of the following month. If no activities occurred during the monitoring month, monitoring reports are still required documenting the absence of the activity. All information shall be submitted to the following address:

Division of Water Quality
 Information Processing Unit
 1617 Mail Service Center
 Raleigh, North Carolina 27699-1617
10. An annual representative soils analysis (Standard Soil Fertility Analysis) shall be conducted on each wastewater irrigation field (i.e., Phase 1B) and the results maintained on file by the Permittee for a minimum of five years. The Standard Soil Fertility Analysis shall include, but is not necessarily limited to, the following parameters:

| | | |
|--------------------------|----------------------------------|------------|
| Acidity | Manganese | Potassium |
| Calcium | Percent Humic Matter | Sodium |
| Copper | pH | Zinc |
| Magnesium | Base Saturation (by calculation) | Phosphorus |
| Cation Exchange Capacity | Exchangeable Sodium Percentage | |

11. Noncompliance Notification:

The Permittee shall report by telephone to the Raleigh Regional Office, telephone number (919) 791-4200, as soon as possible, but in no case more than 24 hours or on the next working day following the occurrence or first knowledge of the occurrence of any of the following:

- a. Any occurrence at the wastewater treatment facility which results in the treatment of significant amounts of wastes which are abnormal in quantity or characteristic, such as the dumping of the contents of a sludge digester; the known passage of a slug of hazardous substance through the facility; or any other unusual circumstances including ponding in the wastewater irrigation or reclaimed utilization areas or runoff from the wastewater irrigation or reclaimed utilization areas.
- b. Any process unit failure, due to known or unknown reasons, that render the facility incapable of adequate wastewater treatment such as mechanical or electrical failures of pumps, aerators, compressors, etc.
- c. Any failure of disposal system resulting in a by-pass directly to receiving waters.
- d. Any time that self-monitoring information indicates that the facility has gone out of compliance with its permit limitations including, but not limited to, freeboard measurements, effluent limitations, exceedances of groundwater standards, or overloading of any irrigation or utilization area.

For any emergency that requires immediate reporting (e.g., discharges to surface waters, imminent failure of a storage structure, etc.) outside normal business hours must be reported to the Division's Emergency Response personnel at telephone number (800) 662-7956, (800) 858-0368, or (919) 733-3300. Persons reporting such occurrences by telephone shall also file a written report in letter form within five (5) days following first knowledge of the occurrence. This report must outline the actions taken or proposed to be taken to ensure that the problem does not recur.

V. INSPECTIONS

1. Adequate inspection and maintenance shall be provided by the Permittee to ensure proper operation of the subject facilities.
2. The Permittee or his designee shall inspect the wastewater treatment and disposal facilities to prevent malfunctions and deterioration, operator errors and discharges which may cause or lead to the release of wastes to the environment, a threat to human health, or a nuisance. The Permittee shall keep an inspection log or summary including at least the date and time of inspection, observations made, and any maintenance, repairs, or corrective actions taken by the Permittee. This log of inspections shall be maintained by the Permittee for a period of five years from the date of the inspection and shall be made available upon request to the Division or other permitting authority.
3. Any duly authorized officer, employee, or representative of the Division may, upon presentation of credentials, enter and inspect any property, premises or place on or related to the disposal site or facility at any reasonable time for the purpose of determining compliance with this permit; may inspect or copy any records that must be maintained under the terms and conditions of this permit, and may obtain samples of groundwater, surface water, or leachate.

VI. GENERAL CONDITIONS

1. Failure to abide by the conditions and limitations contained in this permit may subject the Permittee to an enforcement action by the Division in accordance with North Carolina General Statute 143-215.6A to 143-215.6C.
2. This permit shall become voidable unless the facilities are constructed in accordance with the conditions of this permit, the approved plans and specifications, and other supporting data.
3. This permit is effective only with respect to the nature and volume of wastes described in the application and other supporting data. No variances to applicable rules governing the construction and / or operation of the permitted facilities are granted unless specifically requested and granted in this permit.
4. The issuance of this permit does not exempt the Permittee from complying with any and all statutes, rules, regulations, or ordinances, which may be imposed by other government agencies (local, state, and federal) that have jurisdiction. Of particular concern to the Division are applicable river buffer rules in 15A NCAC 02B .0200, erosion and sedimentation control requirements in 15A NCAC Chapter 4 and under the Division's General Permit NCG010000, and any requirements pertaining to wetlands under 15A NCAC 02B .0200 and 02H .0500.
5. In the event there is a desire for the facilities to change ownership, or there is a name change of the Permittee, a formal permit request must be submitted to the Division on official Division form(s), documentation from the parties involved, and other supporting materials as may be appropriate. The approval of this request will be considered on its merits and may or may not be approved. The Permittee of record shall remain fully responsible for compliance until a permit is issued to the new owner.
6. The Permittee shall retain a set of approved plans and specifications for the life of the facilities permitted herein.
7. The Permittee shall maintain this permit until all permitted facilities herein are properly closed or permitted under another permit issued by the appropriate permitting authority.
8. The Permittee must pay the annual fee within thirty (30) days after being billed by the Division. Failure to pay the fee accordingly may cause the Division to initiate action to revoke this permit pursuant to 15A NCAC 02T .0105(e).

Permit issued this the 18th day of May 2009

NORTH CAROLINA ENVIRONMENTAL MANAGEMENT COMMISSION

for Coleen H. Sullins, Director
Division of Water Quality
By Authority of the Environmental Management Commission

Permit Number WQ0028552

Permit No. WQ0028552
May 18, 2009

ENGINEER'S CERTIFICATION

_____ Partial _____ Final

I, _____, as a duly registered Professional Engineer in the State of North Carolina, having been authorized to observe (periodically, weekly, full time) the construction of the project,

Project Name _____ *Location and County*

for the Permittee hereby state that, to the best of my abilities, due care and diligence was used in the observation of the construction such that the construction was observed to be built within substantial compliance and intent of this permit, the approved plans and specifications, and other supporting materials.

Signature _____ Registration No. _____

Date _____

THIS PAGE BLANK

ATTACHMENT A - LIMITATIONS AND MONITORING REQUIREMENTS

Permit Number: WQ0028552

Version: 1.3

PPI 001 – WWTF Effluent

| EFFLUENT CHARACTERISTICS | EFFLUENT LIMITS | | | | MONITORING REQUIREMENTS | |
|--|----------------------|------------------------|---------------|---------------|-------------------------|-------------|
| | Monthly Average | Monthly Geometric Mean | Daily Minimum | Daily Maximum | Measurement Frequency | Sample Type |
| Parameter Description - PCS Code | | | | | | |
| BOD, 5-Day (20 Deg. C) - 00310 | 10 | | | 15 | 2 x Month | Composite |
| Chloride (as Cl) - 00940 | | | | | 3 x Year ² | Composite |
| Chlorine, Total Residual - 50060 | | | | | 5 x Week | Grab |
| Coliform, Fecal MF, M-FC Broth, 44.5C - 31616 | | 14 | | 25 | 2 x Month ¹ | Grab |
| Flow, in conduit or thru treatment plant - 50050 | 316,412 ³ | | | | Continuous | Recording |
| Nitrogen, Ammonia Total (as N) - 00610 | 4 | | | 6 | 2 x Month | Composite |
| Nitrogen, Nitrate Total (as N) - 00620 | | | | | 2 x Month | Composite |
| pH - 00400 | | | 6 | 9 | 5 x Week | Grab |
| Solids, Total Dissolved - 70300 | | | | | 3 x Year ² | Composite |
| Solids, Total Suspended - 00530 - Summer | 5 | | | 10 | 2 x Month | Composite |
| Turbidity, HCH Turbidimeter - 00076 | | | | 10 | Continuous | Recording |

1. Monthly average for Fecal Coliform shall a geometric mean.
2. 3 x Year monitoring shall be conducted in March, July & November.
3. The monthly average daily flow is limited to 316,412 GPD due to available wet weather storage capacity.

THIS PAGE BLANK

ATTACHMENT B - APPROVED LAND APPLICATION SITES AND LIMITATIONS **Permit Number: WQ0028552** **Version: 1.3**
Briar Chapel Utilities, LLC – Briar Chapel Development

| IRRIGATION / UTILIZATION AREA INFORMATION | | | | | | | | | | APPLICATION LIMITATIONS | | | |
|---|----------------------------|---------|-------------|--------------|-------------|----------------------|--|-------------|------------|-------------------------|--|--|--|
| Field | Owner | County | Latitude | Longitude | Net Acreage | Dominant Soil Series | Parameter | Hourly Rate | Yearly Max | Units | | | |
| B-1A | Briar Chapel Utilities LLC | Chatham | 35° 49' 28" | -79° 05' 58" | 9.90 | Wedowee | 01284 - Application Surface Irrigation | 0.10 | 37.31 | inches | | | |
| B-1B | Briar Chapel Utilities LLC | Chatham | 35° 49' 25" | -79° 06' 05" | 1.70 | Helena | 01284 - Application Surface Irrigation | 0.10 | 19.95 | inches | | | |
| B-2A | Briar Chapel Utilities LLC | Chatham | 35° 49' 22" | -79° 06' 15" | 0.30 | Helena | 01284 - Application Surface Irrigation | 0.10 | 19.95 | inches | | | |
| B-3B | Briar Chapel Utilities LLC | Chatham | 35° 49' 36" | -79° 06' 11" | 0.20 | Wedowee | 01284 - Application Surface Irrigation | 0.10 | 37.31 | inches | | | |
| B-3C | Briar Chapel Utilities LLC | Chatham | 35° 49' 41" | -79° 06' 11" | 0.20 | Wedowee | 01284 - Application Surface Irrigation | 0.10 | 37.31 | inches | | | |
| B-4A | Briar Chapel Utilities LLC | Chatham | 35° 49' 42" | -79° 06' 17" | 0.60 | Wedowee | 01284 - Application Surface Irrigation | 0.10 | 37.31 | inches | | | |
| B-5A | Briar Chapel Utilities LLC | Chatham | 35° 49' 07" | -79° 06' 34" | 0.40 | Wedowee | 01284 - Application Surface Irrigation | 0.10 | 37.31 | inches | | | |
| B-6A | Briar Chapel Utilities LLC | Chatham | 35° 49' 07" | -79° 06' 31" | 1.10 | Wedowee | 01284 - Application Surface Irrigation | 0.10 | 37.31 | inches | | | |
| B-7A | Briar Chapel Utilities LLC | Chatham | 35° 49' 59" | -79° 06' 28" | 2.30 | Wedowee | 01284 - Application Surface Irrigation | 0.10 | 37.31 | inches | | | |
| B-7B | Briar Chapel Utilities LLC | Chatham | 35° 50' 16" | -79° 06' 32" | 0.60 | Wedowee | 01284 - Application Surface Irrigation | 0.10 | 37.31 | inches | | | |
| B-8A | Briar Chapel Utilities LLC | Chatham | 35° 50' 14" | -79° 06' 26" | 0.10 | Wedowee | 01284 - Application Surface Irrigation | 0.10 | 37.31 | inches | | | |
| B-8B | Briar Chapel Utilities LLC | Chatham | 35° 50' 32" | -79° 06' 27" | 1.90 | Wedowee | 01284 - Application Surface Irrigation | 0.10 | 37.31 | inches | | | |
| B-8D | Briar Chapel Utilities LLC | Chatham | 35° 50' 25" | -79° 06' 25" | 0.70 | Helena | 01284 - Application Surface Irrigation | 0.10 | 19.95 | inches | | | |
| B-8E | Briar Chapel Utilities LLC | Chatham | 35° 50' 37" | -79° 06' 22" | 0.50 | Helena | 01284 - Application Surface Irrigation | 0.10 | 19.95 | inches | | | |
| B-9A | Briar Chapel Utilities LLC | Chatham | 35° 50' 42" | -79° 06' 26" | 1.10 | Helena | 01284 - Application Surface Irrigation | 0.10 | 19.95 | inches | | | |
| B-9C | Briar Chapel Utilities LLC | Chatham | 35° 50' 41" | -79° 06' 20" | 0.40 | Wedowee | 01284 - Application Surface Irrigation | 0.10 | 37.31 | inches | | | |
| C-1A | Briar Chapel Utilities LLC | Chatham | 35° 48' 35" | -79° 06' 47" | 8.00 | Wedowee | 01284 - Application Surface Irrigation | 0.10 | 37.31 | inches | | | |
| C-2A | Briar Chapel Utilities LLC | Chatham | 35° 48' 45" | -79° 06' 38" | 1.40 | Helena | 01284 - Application Surface Irrigation | 0.10 | 19.95 | inches | | | |
| C-2B | Briar Chapel Utilities LLC | Chatham | 35° 48' 44" | -79° 06' 35" | 0.90 | Helena | 01284 - Application Surface Irrigation | 0.10 | 19.95 | inches | | | |
| C-2C | Briar Chapel Utilities LLC | Chatham | 35° 48' 38" | -79° 06' 35" | 6.10 | Wedowee | 01284 - Application Surface Irrigation | 0.10 | 37.31 | inches | | | |
| C-2D | Briar Chapel Utilities LLC | Chatham | 35° 48' 41" | -79° 06' 36" | 1.80 | Wedowee | 01284 - Application Surface Irrigation | 0.10 | 37.31 | inches | | | |
| C-3A | Briar Chapel Utilities LLC | Chatham | 35° 48' 52" | -79° 06' 55" | 0.90 | Wedowee | 01284 - Application Surface Irrigation | 0.10 | 19.95 | inches | | | |
| C-3B | Briar Chapel Utilities LLC | Chatham | 35° 48' 50" | -79° 06' 50" | 0.80 | Wedowee | 01284 - Application Surface Irrigation | 0.10 | 19.95 | inches | | | |
| C-3C | Briar Chapel Utilities LLC | Chatham | 35° 48' 47" | -79° 06' 49" | 0.40 | Wedowee | 01284 - Application Surface Irrigation | 0.10 | 19.95 | inches | | | |

| | | | | | | | | | | |
|-------|----------------------------|---------|-------------|--------------|-------|---------|--|------|-------|--------|
| C-3D | Briar Chapel Utilities LLC | Chatham | 35° 48' 43" | -79° 06' 46" | 0.40 | Wedowee | 01284 - Application Surface Irrigation | 0.10 | 19.95 | inches |
| C-3E | Briar Chapel Utilities LLC | Chatham | 35° 48' 50" | -79° 06' 53" | 9.80 | Wedowee | 01284 - Application Surface Irrigation | 0.10 | 37.31 | inches |
| C-3F | Briar Chapel Utilities LLC | Chatham | 35° 48' 42" | -79° 06' 44" | 3.40 | Wedowee | 01284 - Application Surface Irrigation | 0.10 | 37.31 | inches |
| C-5A | Briar Chapel Utilities LLC | Chatham | 35° 49' 05" | -79° 06' 25" | 4.10 | Wedowee | 01284 - Application Surface Irrigation | 0.10 | 37.31 | inches |
| C-6A | Briar Chapel Utilities LLC | Chatham | 35° 49' 10" | -79° 06' 01" | 0.50 | Rion | 01284 - Application Surface Irrigation | 0.10 | 19.95 | inches |
| C-6B | Briar Chapel Utilities LLC | Chatham | 35° 49' 10" | -79° 06' 54" | 0.10 | Helena | 01284 - Application Surface Irrigation | 0.10 | 19.95 | inches |
| C-6C | Briar Chapel Utilities LLC | Chatham | 35° 49' 13" | -79° 06' 58" | 0.20 | Wedowee | 01284 - Application Surface Irrigation | 0.10 | 37.31 | inches |
| C-6D | Briar Chapel Utilities LLC | Chatham | 35° 49' 10" | -79° 06' 58" | 0.70 | Wedowee | 01284 - Application Surface Irrigation | 0.10 | 37.31 | inches |
| C-9A | Briar Chapel Utilities LLC | Chatham | 35° 49' 21" | -79° 07' 11" | 4.20 | Helena | 01284 - Application Surface Irrigation | 0.10 | 19.95 | inches |
| C-9B | Briar Chapel Utilities LLC | Chatham | 35° 49' 15" | -79° 07' 09" | 3.20 | Wedowee | 01284 - Application Surface Irrigation | 0.10 | 37.31 | inches |
| C-12A | Briar Chapel Utilities LLC | Chatham | 35° 49' 29" | -79° 07' 23" | 2.00 | Rion | 01284 - Application Surface Irrigation | 0.10 | 19.95 | inches |
| C-12B | Briar Chapel Utilities LLC | Chatham | 35° 49' 28" | -79° 07' 12" | 2.60 | Helena | 01284 - Application Surface Irrigation | 0.10 | 19.95 | inches |
| C-12C | Briar Chapel Utilities LLC | Chatham | 35° 49' 25" | -79° 07' 19" | 3.40 | Wedowee | 01284 - Application Surface Irrigation | 0.10 | 37.31 | inches |
| C-12D | Briar Chapel Utilities LLC | Chatham | 35° 49' 18" | -79° 07' 15" | 0.40 | Wedowee | 01284 - Application Surface Irrigation | 0.10 | 37.31 | inches |
| C-13A | Briar Chapel Utilities LLC | Chatham | 35° 49' 26" | -79° 07' 00" | 0.40 | Helena | 01284 - Application Surface Irrigation | 0.10 | 19.95 | inches |
| C-13B | Briar Chapel Utilities LLC | Chatham | 35° 49' 29" | -79° 06' 59" | 1.00 | Helena | 01284 - Application Surface Irrigation | 0.10 | 19.95 | inches |
| C-13C | Briar Chapel Utilities LLC | Chatham | 35° 49' 33" | -79° 07' 03" | 1.10 | Rion | 01284 - Application Surface Irrigation | 0.10 | 19.95 | inches |
| C-13D | Briar Chapel Utilities LLC | Chatham | 35° 49' 36" | -79° 06' 59" | 1.00 | Rion | 01284 - Application Surface Irrigation | 0.10 | 19.95 | inches |
| C-13E | Briar Chapel Utilities LLC | Chatham | 35° 49' 31" | -79° 06' 59" | 2.70 | Pacolet | 01284 - Application Surface Irrigation | 0.10 | 37.31 | inches |
| C-13F | Briar Chapel Utilities LLC | Chatham | 35° 49' 28" | -79° 07' 03" | 6.40 | Wedowee | 01284 - Application Surface Irrigation | 0.10 | 37.31 | inches |
| C-15A | Briar Chapel Utilities LLC | Chatham | 35° 49' 32" | -79° 06' 46" | 3.50 | Helena | 01284 - Application Surface Irrigation | 0.10 | 19.95 | inches |
| C-15B | Briar Chapel Utilities LLC | Chatham | 35° 49' 38" | -79° 06' 40" | 0.90 | Helena | 01284 - Application Surface Irrigation | 0.10 | 19.95 | inches |
| C-15C | Briar Chapel Utilities LLC | Chatham | 35° 49' 25" | -79° 06' 38" | 0.90 | Wedowee | 01284 - Application Surface Irrigation | 0.10 | 37.31 | inches |
| C-15D | Briar Chapel Utilities LLC | Chatham | 35° 49' 32" | -79° 06' 50" | 0.90 | Wedowee | 01284 - Application Surface Irrigation | 0.10 | 37.31 | inches |
| C-15E | Briar Chapel Utilities LLC | Chatham | 35° 49' 40" | -79° 06' 45" | 1.40 | Wedowee | 01284 - Application Surface Irrigation | 0.10 | 37.31 | inches |
| C-16A | Briar Chapel Utilities LLC | Chatham | 35° 49' 25" | -79° 06' 26" | 6.20 | Wedowee | 01284 - Application Surface Irrigation | 0.10 | 37.31 | inches |
| C-20A | Briar Chapel Utilities LLC | Chatham | 35° 49' 48" | -79° 07' 00" | 0.40 | Helena | 01284 - Application Surface Irrigation | 0.10 | 37.31 | inches |
| E-1A | Briar Chapel Utilities LLC | Chatham | 35° 49' 21" | -79° 06' 01" | 10.40 | Wedowee | 01284 - Application Surface Irrigation | 0.10 | 37.31 | inches |
| E-2A | Briar Chapel Utilities LLC | Chatham | 35° 49' 16" | -79° 06' 49" | 9.00 | Wedowee | 01284 - Application Surface Irrigation | 0.10 | 37.31 | inches |

| | | | | | | | | | | |
|--------------|----------------------------|---------|-------------|--------------|---------------|---------|--|------|-------|--------|
| E-3A | Briar Chapel Utilities LLC | Chatham | 35° 49' 13" | -79° 05' 30" | 0.80 | Helena | 01284 - Application Surface Irrigation | 0.10 | 19.95 | inches |
| E-3B | Briar Chapel Utilities LLC | Chatham | 35° 49' 11" | -79° 05' 22" | 2.20 | Helena | 01284 - Application Surface Irrigation | 0.10 | 19.95 | inches |
| E-3C | Briar Chapel Utilities LLC | Chatham | 35° 49' 10" | -79° 05' 27" | 3.50 | Wedowee | 01284 - Application Surface Irrigation | 0.10 | 37.31 | inches |
| E-3D | Briar Chapel Utilities LLC | Chatham | 35° 49' 12" | -79° 05' 39" | 0.90 | Rion | 01284 - Application Surface Irrigation | 0.10 | 37.31 | inches |
| E-4A | Briar Chapel Utilities LLC | Chatham | 35° 49' 16" | -79° 05' 35" | 3.10 | Helena | 01284 - Application Surface Irrigation | 0.10 | 19.95 | inches |
| E-4B | Briar Chapel Utilities LLC | Chatham | 35° 49' 18" | -79° 05' 18" | 2.90 | Helena | 01284 - Application Surface Irrigation | 0.10 | 19.95 | inches |
| E-4C | Briar Chapel Utilities LLC | Chatham | 35° 49' 16" | -79° 05' 26" | 9.30 | Rion | 01284 - Application Surface Irrigation | 0.10 | 37.31 | inches |
| Phase 1C | Briar Chapel Utilities LLC | Chatham | 35° 49' 14" | -79° 05' 46" | 9.48 | Wedowee | 01284 - Application Surface Irrigation | 0.10 | 30.84 | inches |
| TOTAL | | | | | 155.68 | | | | | |

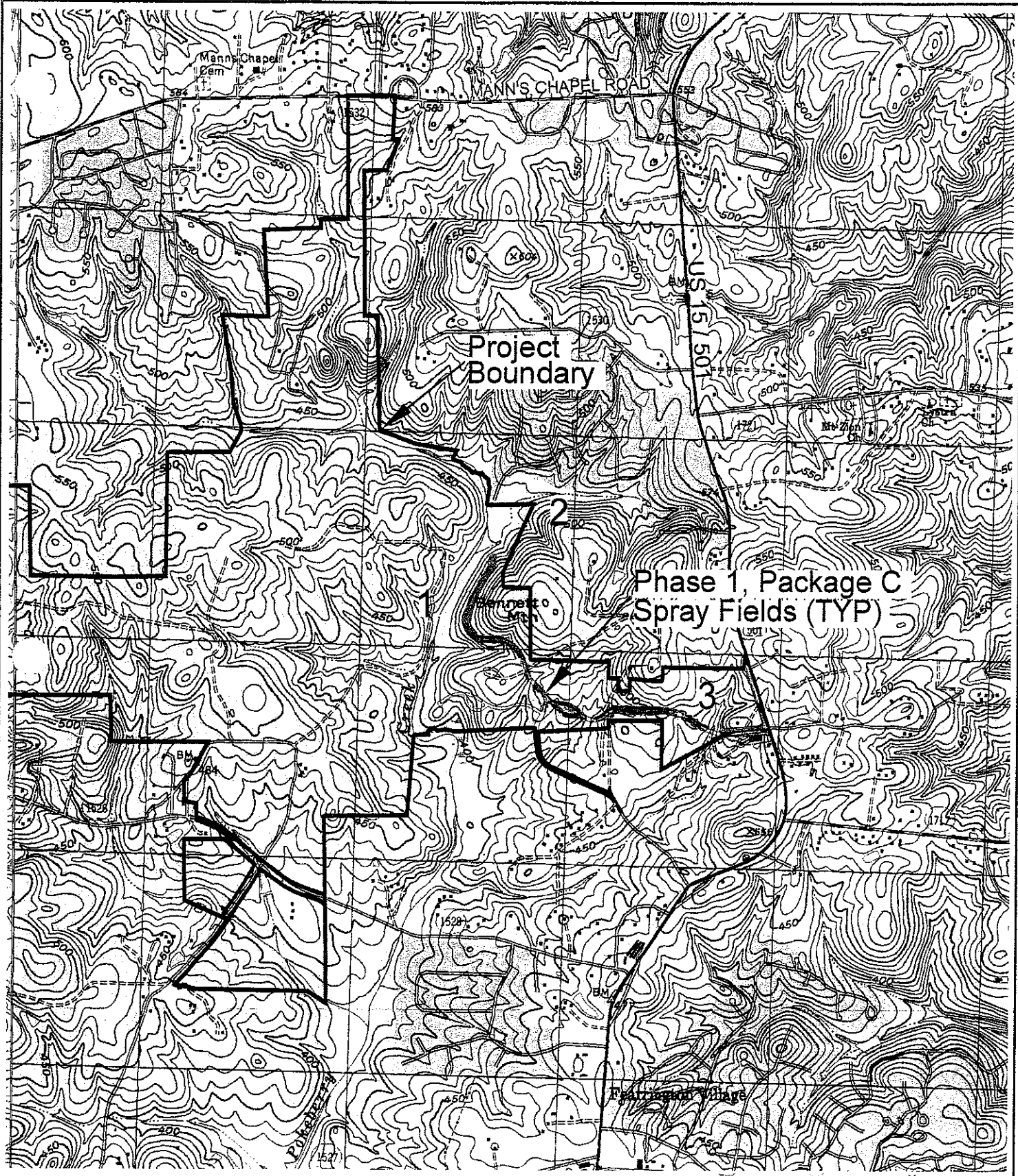

0 2000' 4000'

SCALE: 1" = 2000'













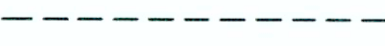
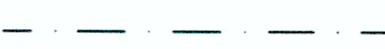

NORTH

FARRINGTON, NC
1993
NIMA 6155 I SE-SERIES V842

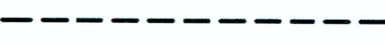

LEGEND:

-  EXISTING WETLANDS
-  PERMANENT PERMITTED STREAM IMPACTS
-  TEMPORARY PERMITTED STREAM IMPACTS
-  R/W LINE
-  HOA EASEMENT LINE
-  PUBLIC UTILITY EASEMENT LINE
-  PUBLIC DRAINAGE EASEMENT
-  EXISTING POWER LINE EASEMENT
-  OVERHEAD POWER LINE
-  10' NO BUILD BUFFER LINE
-  RIPARIAN BUFFER LINE
-  BMP MAINTENANCE & ACCESS EASEMENT
-  ROADWAY CENTERLINE
-  EX. FORCE MAIN EASEMENT

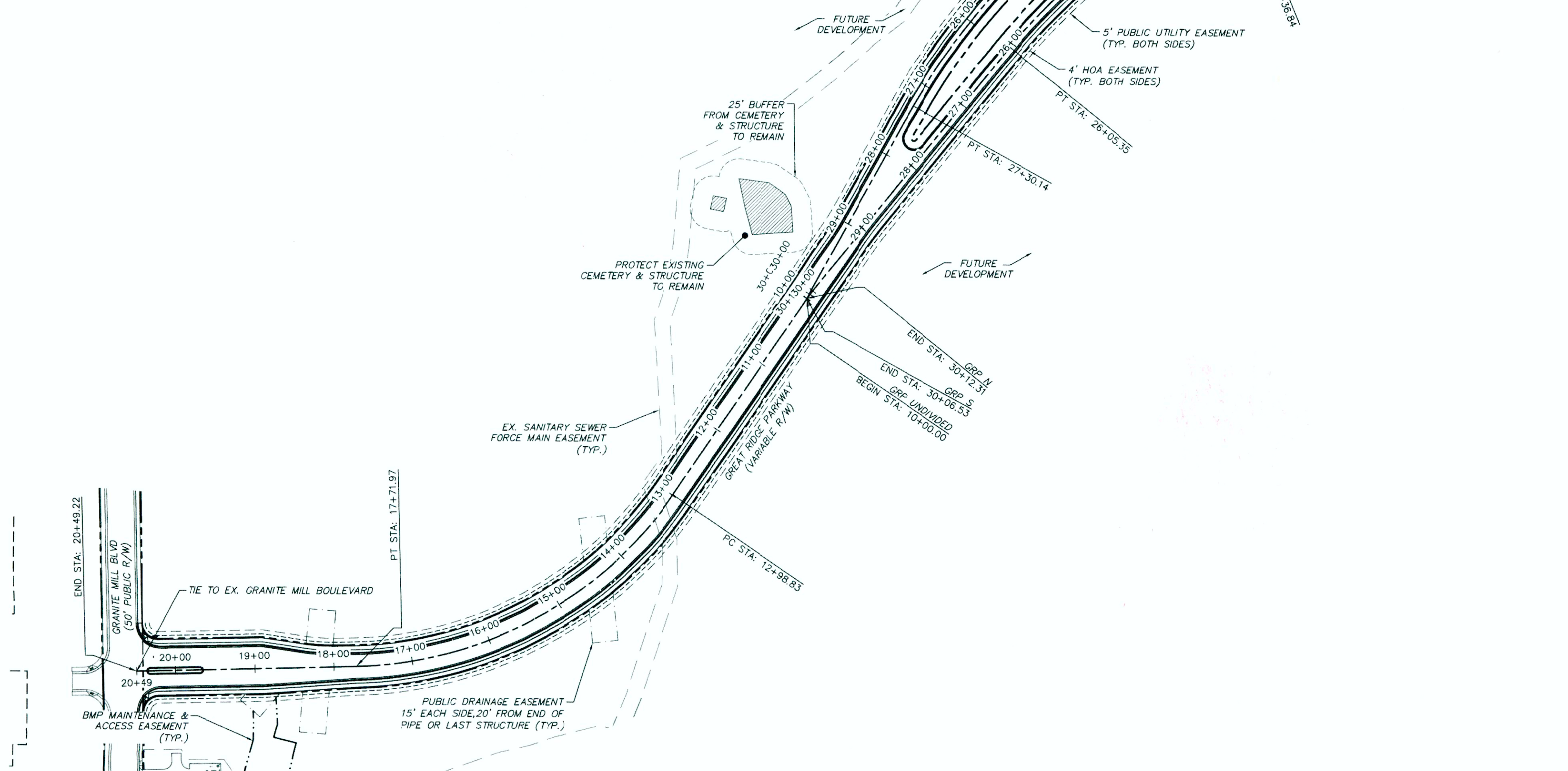
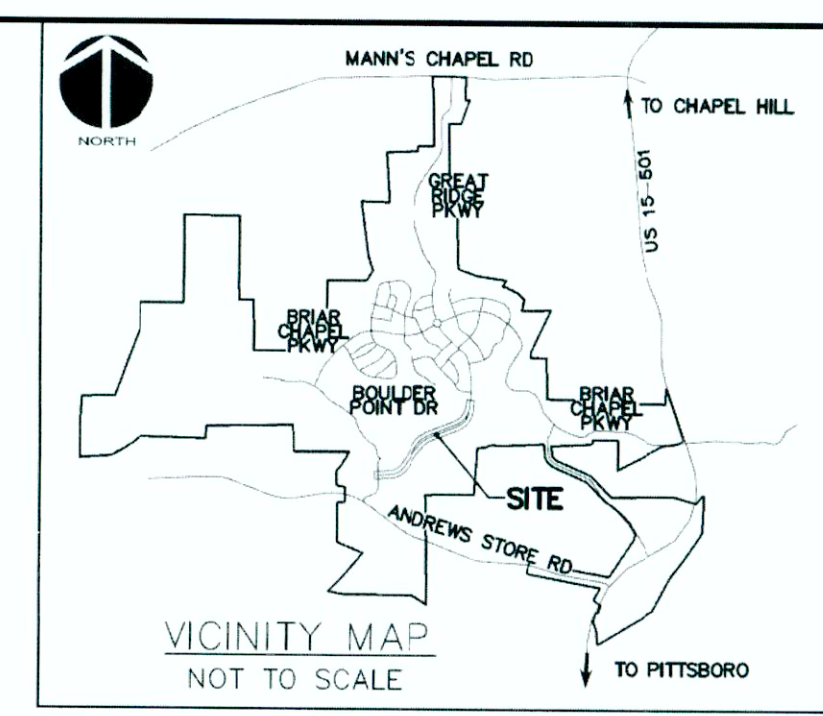
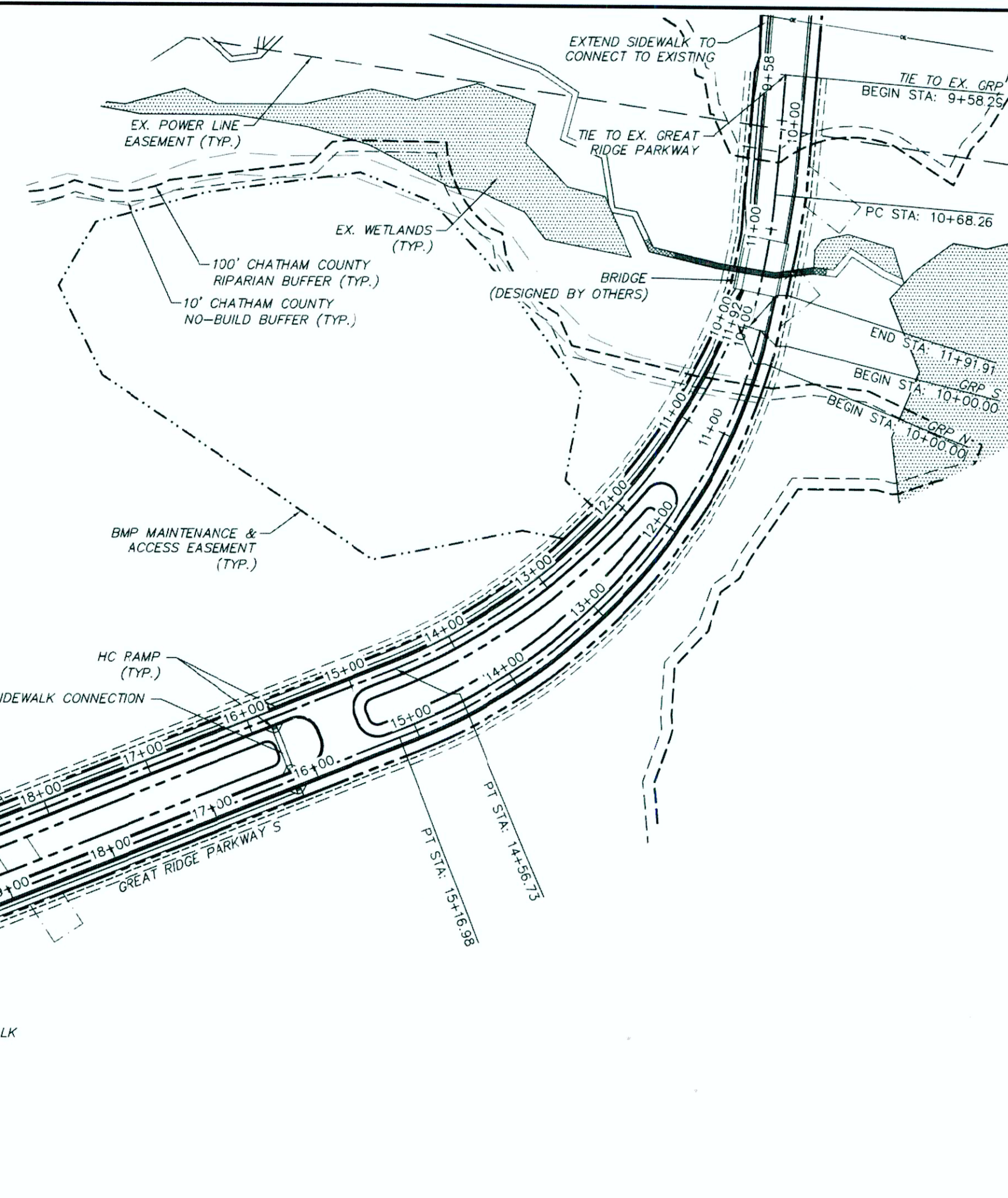

SITE GENERAL NOTES:

1. ALL DIMENSIONS AND GRADES SHOWN ON THE PLANS SHALL BE FIELD VERIFIED BY THE CONTRACTOR PRIOR TO CONSTRUCTION. CONTRACTOR SHALL NOTIFY OWNER IF ANY DISCREPANCIES EXIST PRIOR TO CONSTRUCTION. NO ADDITIONAL COMPENSATION WILL BE PAID TO THE CONTRACTOR FOR ANY WORK DONE DUE TO DIMENSIONS OR GRADES SHOWN INCORRECTLY ON THE PLANS IF SUCH NOTIFICATION HAS NOT BEEN GIVEN.
2. REFER TO THE FOLLOWING MCKIM & CREED, INC. CONSTRUCTION PLANS, AND ALL SUBSEQUENT CONSTRUCTION BULLETINS FOR INFORMATION ON EXISTING SITE INFRASTRUCTURE:
 - BRIAR CHAPEL - RECLAMATION FACILITY EROSION CONTROL PLAN SEALED JULY 29, 2005
 - BRIAR CHAPEL - PHASE 1 CONSTRUCTION PLANS SEALED OCTOBER 21, 2005
 - BRIAR CHAPEL - WEST EXTENSION GRADING PLAN (INTERIM) SEALED MARCH 1, 2007
 - BRIAR CHAPEL - PHASE 3 CONSTRUCTION PLANS SEALED DECEMBER 4, 2006
 - BRIAR CHAPEL - PHASE 4 CONSTRUCTION PLANS SEALED JANUARY 15, 2007
 - BRIAR CHAPEL - WATER QUALITY PONDS 5 AND 6 CONSTRUCTION PLANS SEALED AUGUST 24, 2006
 - BRIAR CHAPEL - PUMP STATION CONSTRUCTION PLANS DATED APRIL 3, 2006
 - BRIAR CHAPEL - PHASE 4 - FLOOD CONSTRUCTION PLANS SEALED SEPT. 17, 2007
 - BRIAR CHAPEL - PHASE 3 & 4 EROSION CONTROL PLANS SEALED JULY 26, 2007
 - BRIAR CHAPEL - PHASE 5 SOUTH SECTION 1 CONSTRUCTION PLANS SEALED NOVEMBER 9, 2009
 - BRIAR CHAPEL - PHASE 5 SOUTH SECTION 2 CONSTRUCTION PLANS SEALED OCTOBER 8, 2009
 - BRIAR CHAPEL - PHASE 6 NORTH SECTIONS 1 AND 2 CONSTRUCTION PLANS SEALED OCTOBER 8, 2012
3. REFER TO THE FOLLOWING JOHN R. MCADAMS COMPANY, INC. CONSTRUCTION PLANS, AND ALL SUBSEQUENT CONSTRUCTION BULLETINS FOR INFORMATION ON EXISTING SITE INFRASTRUCTURE:
 - BRIAR CHAPEL - RECLAMATION FACILITY EROSION CONTROL PLAN SEALED JULY 29, 2005
 - BRIAR CHAPEL - PHASE 1 CONSTRUCTION PLANS SEALED OCTOBER 21, 2005
 - BRIAR CHAPEL - WEST EXTENSION GRADING PLAN (INTERIM) SEALED MARCH 1, 2007
 - BRIAR CHAPEL - PHASE 3 CONSTRUCTION PLANS SEALED DECEMBER 4, 2006
 - BRIAR CHAPEL - PHASE 4 CONSTRUCTION PLANS SEALED JANUARY 15, 2007
 - BRIAR CHAPEL - WATER QUALITY PONDS 5 AND 6 CONSTRUCTION PLANS SEALED AUGUST 24, 2006
 - BRIAR CHAPEL - PUMP STATION CONSTRUCTION PLANS DATED APRIL 3, 2006
 - BRIAR CHAPEL - PHASE 4 - FLOOD CONSTRUCTION PLANS SEALED SEPT. 17, 2007
 - BRIAR CHAPEL - PHASE 3 & 4 EROSION CONTROL PLANS SEALED JULY 26, 2007
 - BRIAR CHAPEL - PHASE 5 SOUTH SECTION 1 CONSTRUCTION PLANS SEALED NOVEMBER 9, 2009
 - BRIAR CHAPEL - PHASE 5 SOUTH SECTION 2 CONSTRUCTION PLANS SEALED OCTOBER 8, 2009
 - BRIAR CHAPEL - PHASE 6 NORTH SECTIONS 1 AND 2 CONSTRUCTION PLANS SEALED OCTOBER 8, 2012
4. STREAM AND WETLAND LOCATIONS ARE BASED ON DELINEATIONS PROVIDED BY SOIL AND ENVIRONMENTAL CONSULTANTS IN RALEIGH, NC - CONTACT NIKKI THOMSON AT 919-846-5900.
5. A PORTION OF THIS PROPERTY IS LOCATED IN SPECIAL FLOOD HAZARD AREA "AE" AS SHOWN ON FEMA FIRM MAP #3710976500J DATED FEBRUARY 2, 2007.
6. ALL PROPOSED ROADWAY DIMENSIONS AS SHOWN ARE MEASURED FROM BACK OF CURB TO BACK OF CURB, ALL PROPOSED ALLEY DIMENSIONS AS SHOWN ARE MEASURED FROM EDGE OF PAVEMENT TO EDGE OF PAVEMENT, UNLESS NOTED OTHERWISE.
7. BEFORE STARTING ANY CONSTRUCTION OF IMPROVEMENTS WITHIN ANY NCDOT STREET OR HIGHWAY RIGHT-OF-WAY, CONTACT NCDOT DISTRICT OFFICE AND OBTAIN ALL PERMITS AND ENCROACHMENTS. KEEP COPIES ON CONSTRUCTION SITE. ALSO CONTACT NCDOT DISTRICT OFFICE 24 HOURS IN ADVANCE BEFORE PLACING CURB AND GUTTER AT 336-629-1423.
8. REFER TO PLAN AND PROFILE SHEETS FOR DETAILED SANITARY SEWER AND STORM DRAINAGE INFORMATION WITHIN PUBLIC ROADS AND PRIVATE ALLEYS.

CHATHAM COUNTY REQUIRED SITE NOTES

1. PROPERTY OWNER/DEVELOPER:
NMP BRIAR CHAPEL, LLC
16 WINDY KNOLL CIRCLE
CHAPEL HILL, NC 27516
PHONE: (919) 951-0700
2. SITE AKPAR # 82826

UTILITIES PLAN REVIEW
 Reviewer is for general conformance with Chatham County Significations, NCDOT, NCDENR and Material standards. This review does not waive plans from other review requirements.
 Approved
 Approved with Modifications
 Revises and Resubmit
 Disapproved
 CHATHAM COUNTY PUBLIC UTILITIES & WATER DIVISION
 P.O. Box 910, Pittsboro, NC 27312
 Date: 2/1/13 By: [Signature]

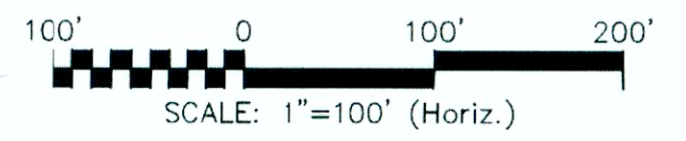

| REV. NO. | DESCRIPTIONS | DATE |
|----------|---|------------|
| 2 | REVISIONS PER CHATHAM COUNTY PUBLIC UTILITIES DEPARTMENT COMMENTS | 2012.01.09 |
| 1 | ISSUED FOR PERMITTING | 2012.12.19 |
| | REVISIONS | |

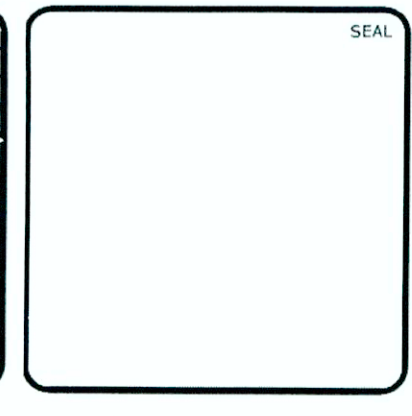

MCKIM & CREED
 1730 Varsity Drive, Suite 500
 Raleigh, North Carolina 27606
 Phone: (919)233-8091, Fax: (919)233-8031
 F-1222
 www.mckimcreed.com

BRIAR CHAPEL™
 by
Newland COMMUNITIES

**BRIAR CHAPEL
 GREAT RIDGE PARKWAY EXTENSION
 CHATHAM COUNTY, NORTH CAROLINA**
**RIGHT-OF-WAY DEDICATION &
 OVERALL SITE PLAN**

| | | |
|-------------------------|-----------------------------|-----------------------|
| DATE: DECEMBER 19, 2012 | SCALE: HORIZONTAL: AS NOTED | M&C FILE NUMBER: C1.X |
| MCE PROJ. #: 02735-0080 | VERTICAL: N/A | DRAWING NUMBER: C1.1 |
| DRAWN: GCA | | |
| DESIGNED: GCA | | |
| CHECKED: CHS | | |
| PROJ. MGR.: CHS | | |
| STATUS: FOR PERMIT ONLY | | REVISION: 2 |



North Carolina Department of Environment and Natural Resources
Division of Water Resources

Pat McCrory
Governor

Thomas A. Reeder
Director

John E. Skvarla III
Secretary

March 1, 2013

Mr. Charlie Horne, County Manager
Chatham County
12 East Street, Courthouse Annex
Pittsboro, NC 27312

Re: Engineering Plans and Specifications Approval
Water Main Extension
Briar Chapel/Great Ridge Parkway Extension
Water System No: NC0319126
Serial Number: 13-00154—Chatham County

This is not an Authorization to Construct

Dear Mr. Horne:

Enclosed please find one copy of the "Application for Approval..." together with one copy of the referenced engineering plans and specifications bearing the Division of Water Resources stamp of approval for the referenced project. These engineering plans and specifications are approved under serial number 13-00154, dated March 1, 2013.

Engineering plans prepared by Grant M. Livengood, P.E. call for the installation and construction of approximately 3,410 linear feet of 8-inch ductile iron pipe water main, 350 linear feet of 6-inch ductile iron pipe water main, 50 linear feet of 16-inch steel encasement pipe, seven fire hydrants assemblies, and other appurtenances. This information is shown on plans titled "Briar Chapel—Great Ridge Parkway Extension—Preliminary Plat Submittal", signed and sealed December 19, 2012, January 9, 2013, January 29, 2013 and most recently February 28, 2013.

Please note that an "Authorization to Construct" requires both this approval of Engineering Plans and Specifications and submittal of a complete Water System Management Plan. No construction shall be undertaken, and no contract for construction, alteration, or installation shall be entered into until the Department issues an Authorization to Construct letter in accordance with 15A NCAC 18C.0305(a).

These plans and specifications cited in the foregoing application are approved insofar as the protection of public health is concerned as provided in the rules, standards and criteria adopted under the authority of Chapter 130A-317 of the General Statutes. This approval does not constitute a warranty of the design, construction or future operation of the water system.

One copy of each enclosed document is being forwarded to our Raleigh Regional Office. The third copy is being retained in our permanent files.

Public Water Supply Section – Jessica C. Godreau, Chief
1634 Mail Service Center, Raleigh, North Carolina 27699-1634
Phone: 919-707-9100 \ FAX: 919-715-4374 \ Lab Form FAX: 919-715-6637 \ Internet: ncdinkingwater.state.nc.us

An Equal Opportunity \ Affirmative Action Employer

Mr. Charlie Horne
Chatham County
Briar Chapel—Great Ridge Parkway Extension
March 1, 2013

page 2 of 2

If the Public Water Supply section can be of further service, please call (919) 707-9100.

Sincerely,

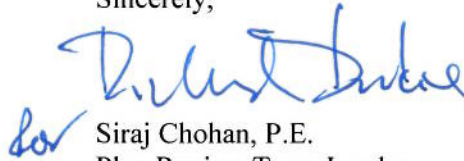

Siraj Chohan, P.E.
Plan Review Team Leader
Technical Services Branch

SMC/RJD/db

Enclosures: Approval Documents

cc: Michael Douglas, P.E., Raleigh Regional Office
Chatham County Health Department
Grant. M. Livengood, P.E., McKim & Creed, Inc.
Leonard McBryde, III, P.E., Chatham County-Public Works Department-Utilities and Water Division

Consultant's mailing info:
McKim & Creed, Inc.
1730 Varsity Drive, Suite 500
Raleigh, NC 27606

Chatham County-Utilities and Water Division
964 East Street, Suite 205
Pittsboro, NC 27312



North Carolina Department of Environment and Natural Resources
Division of Water Resources

Pat McCrory
Governor

Thomas A. Reeder
Director

John E. Skvarla III
Secretary

March 04, 2013

CHARLIE HORNE, COUNTY MANAGER
COUNTY OF CHATHAM
12 EAST STREET COURTHOUSE ANNEX
PITTSBORO, NC 27312

Re: **Authorization to Construct**
BRIAR CHAPEL - GREAT RIDGE PARKWAY EXTENSION
CHATHAM CO WATER SYSTEM
CHATHAM COUNTY, NC0319126

Authorization to Construct (This is not a Final Approval)

Dear Applicant:

This letter is to confirm that a complete Engineer's Report and a Water System Management Plan have been received, and that engineering plans and specifications have been approved by the Department for **BRIAR CHAPEL - GREAT RIDGE PARKWAY EXTENSION, Serial No. 13-00154**.

The Authorization to Construct is valid for 24 months from the **Issue Date** (refer to next page). Authorization to Construct may be extended if the Rules Governing Public Water Supplies and site conditions have not changed (see Rule .0305). The Authorization to Construct and the engineering plans and specifications approval letter shall be posted at the primary entrance of the job site before and during construction.

Upon completion of the construction or modification, and prior to **placing the new construction or modification into service**, the applicant must submit an Engineer's Certification and Applicant Certification directly to RICHARD DICKIE, P.E. of this office.

- **Engineer Certification:** in accordance with Rule .0303 (a), the applicant shall submit a certification statement signed and sealed by a registered professional engineer stating that construction was completed in accordance with approved engineering plans and specifications, including any provisions stipulated in the Department's engineering plan and specification approval letter.
- **Applicant Certification:** in accordance with Rule .0303 (c), the applicant shall submit a signed certification statement indicating that the requirements for an Operation and Maintenance Plan and Emergency Management Plan have been satisfied in accordance with Rule .0307 (d) and (e) and that the system has a certified operator in accordance with Rule .1300. The "Applicant Certification" form is available at <http://www.deh.enr.state.nc.us/pws/> (click on Plan Review Forms, under Plan Review heading).

If this Authorization to Construct is for a new public water system, the owner must submit a completed **application for an Operating Permit** and the appropriate fee. For a copy of the application for an Operating Permit please call (919) 707-9085.

Once the certifications and permit application and fee, (if applicable), are received and determined adequate, the Department will issue a Final Approval letter to the applicant. In accordance with Rule .0309 (a), **no portion of this project shall be placed into service until the Department has issued Final Approval**.

Sincerely,

Siraj Chohan, P.E.
Plan Review Team Leader

cc: Michael Douglas, P.E., REGIONAL ENGINEER
MCKIM AND CREED PA-CARY



North Carolina Department of Environment and Natural Resources
Division of Water Resources

Public Water System Authorization to Construct

| | |
|---|--|
| Public Water System Name and Water System No.: | CHATHAM CO WATER SYSTEM NC0319126 |
| Project Name: | BRIAR CHAPEL - GREAT RIDGE PARKWAY EXTENSION |
| Serial No.: | 13-00154 |
| Issue Date: | 03/01/2013 |
| Expiration Date: | 24 Months after Issue Date |

In accordance with NCAC 18C .0305, this Authorization to Construct must be posted
at the primary entrance to the job site during construction.

MCKIM AND CREED PA-CARY
1730 VARSITY DR
SUITE 500
RALEIGH

NC 27606