

NOTE:  
PAVEMENT DESIGN REQUIREMENTS FOR EACH BUILDING PARKING AREA SHALL BE 6" AGGREGATE BASE COURSE (ABC) AND 2" ASPHALT PAVING IN THE DRIVE AREAS. 6" ABC AND 2" ASPHALT PAVING CAN BE USED IN THE PARKING BAY AREAS OUTSIDE OF THE TRAVEL AISLES.  
ALL CURB AND GUTTER SHALL BE 24" AND PLACED ON MINIMUM OF 3" ABC.

LARRY STURDIVANT  
PLAT BOOK 10, PAGE 82

SHOPPING CENTER  
ENTRANCE ONLY

JANE  
STURDIVANT

3 SUBDIVISION  
6, PAGE 64

2

1

NORTH BOUND/  
SOUTH BOUND  
US 15-501

NORTH BOUND/  
SOUTH BOUND  
US 15-501

NORTH BOUND/  
SOUTH BOUND  
US 15-501

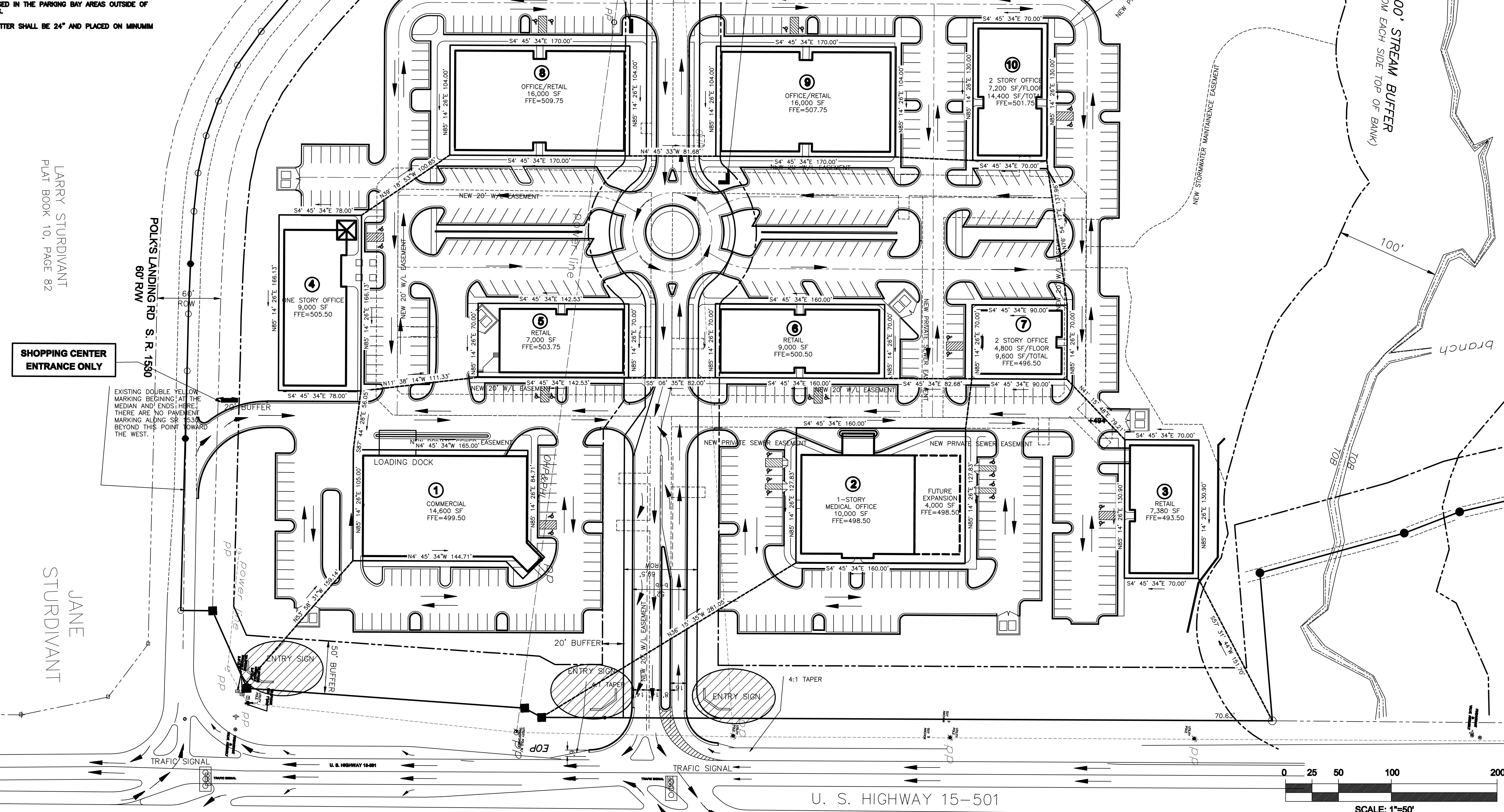

1071 CLASSIC ROAD  
APEX, NC 27539  
TELEPHONE: 919 363-1422  
FACSIMILE: 919 363-1477

**POLKS VILLAGE**  
OWNER/DEVELOPER: POLKS VILLAGE, INC.  
CHATHAM COUNTY NORTH CAROLINA

DRAWN BY	CHECKED BY
TDS	TDS

DATE	REVISIONS
11-21-07	

NO.	DATE	REVISIONS
1	1-26-09	

**SHEET TITLE**  
OVERALL SITE LAYOUT PLAN

**SHEET NUMBER**

**C-1**  
1 OF X