

MOLDENHAUER LANDSCAPING, INC.

MULCH GRINDING FACILITY

CONDITIONAL USE DISCTRICT and PERMIT APPLICATION

1957 LYSTRA ROAD
WILLIAMS TOWNSHIP - CHATHAM COUNTY, NORTH CAROLINA

DRAWING INDEX

SHEET	TITLE
C-1	COVER SHEET
C-2	EXISTING CONDITIONS
C-3	GRINDING SITE PLAN
C-4	UTILITY PLAN
C-5	SITE DETAILS
C-6	SAND FILTER DETAILS

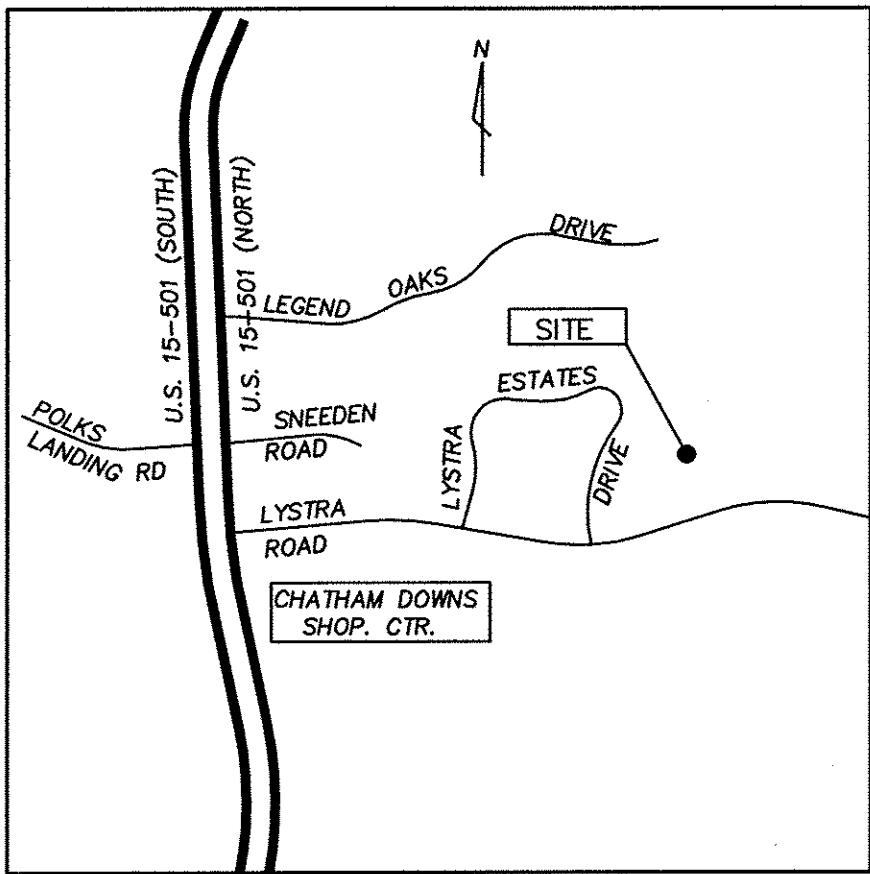

VICINITY MAP
NO SCALE

SITE DATA:

PARCEL PIN:	9785 00 48 0000 (PARCEL ID 0043162)
PARCEL NO.	67592
TOTAL PARCEL SIZE:	5.032 AC.
CURRENT ZONING DISTRICT:	R-1
DEED REFERENCE:	BOOK 554, PAGE 647
PLAT REFERENCE:	BOOK 90, PAGE 67
PARCEL ADDRESS:	1957 LYSTRA ROAD, CHAPEL HILL, NC 27517
EXISTING USE:	LCID LANDFILL SITE
PROPOSED DISTURBED AREA:	37,635 SF (0.864 AC.)
LOCAL WATERSHED:	WS-IV PA (PROTECTED AREA)

CIVIL ENGINEER

PHILIP POST & ASSOCIATES
401 PROVIDENCE ROAD SUITE 200
CHAPEL HILL, NC 27514
TEL. (919) 929-1173
FAX: (919) 493-4568

LANDFILL OPERATOR/APPLICANT

MARK MOLDENHAUER
MOLDENHAUER LANDSCAPING, INC.
611 LYSTRA ESTATES DR.
CHAPEL HILL, NC 27517

OWNER

JOAN COUNCIL SPENCER
7 MISTY CREEK COURT
DURHAM, NC 27705

ENGINEERS
PLANNERS
SURVEYORS
PHILIP
POST
&
ASSOCIATES
401 Providence Rd. #200
Chapel Hill, NC 27514
919.929.1173
919.493.2600
Greensboro: 336.580.8169
Firm License C-0347

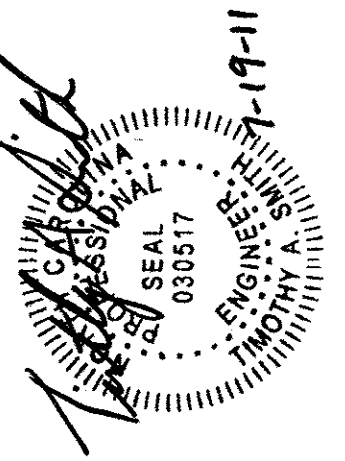

COVER SHEET

MOLDENHAUER LANDSCAPING, INC.
MULCH GRINDING FACILITY

WILLIAMS TOWNSHIP CHATHAM COUNTY, N.C.

SCALE 1" = 30'
DRAWN BY: MKM
CHECKED BY: TAS
DATE: 4/12/10
PROJECT NO. 400802
DRAWING NO. C499T002 (Gridiron)
This drawing is the property of Philip Post & Associates, Inc. and is not to be reproduced or copied in whole or in part without the written consent of Philip Post & Associates, Inc. The user of this drawing assumes all liability for any errors or omissions and agrees to indemnify and hold Philip Post & Associates, Inc. harmless from all claims, damages, costs and expenses, including reasonable attorneys' fees, arising out of or from the use of this drawing. COPYRIGHT 2010 Philip Post & Associates, Inc.

REVISIONS
1. ADD BATHROOM FACILITY AND SAND FILTER SYSTEM

SHEET 1
OF 6

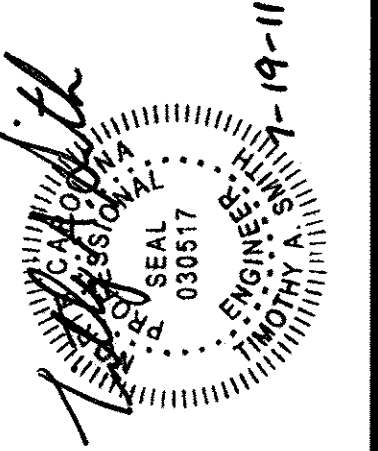

MOLDENHAUER LANDSCAPING, INC.
MULCH GRINDING FACILITY

WILLIAMS TOWNSHIP
CHATHAM COUNTY, N.C.

DRAWN BY MKM
CHECKED BY TAS
DATE 4/12/10
PROJECT NO. 400802
DRAWING NO. C499TDP02 (Carlson)

This drawing is the property of Philip Post and Associates Inc. and is not to be reproduced or copied in whole or in part. It is only to be used for the project and for the site specifically identified herein and is not to be used on any other project or site. It is to be returned upon the written request of Philip Post & Associates, Inc.
COPYRIGHT 2010 Philip Post & Associates, Inc.

REVISIONS

1. ADD BATHROOM FACILITY AND SAND FILTER SYSTEM

HEET 2

F 6



PHILIP POST & ASSOCIATES
ENGINEERS PLANNERS SURVEYORS
401 Providence Rd. #200
Chapel Hill, NC 27514
(919) 933-1775
919-453-2600
Greensboro: 336-580-8169
Firm License C-0347

A circular seal of the Federal Bureau of Investigation (FBI) is shown. The outer ring contains the text "FEDERAL BUREAU OF INVESTIGATION" at the top and "DEPARTMENT OF JUSTICE" at the bottom. Inside the ring, the words "FIDELITY BRAVERY INTEGRITY" are written in a circle. In the center, the words "FEDERAL BUREAU OF INVESTIGATION" are written in a circle. Overlaid on the seal are two handwritten signatures and two dates. The signature "J. Edgar Hoover" is written across the top half of the seal. The date "1-19-11" is written across the bottom half of the seal. The seal is stamped in black ink on a white background.

SITE PLAN

MOLDENHAUER LANDSCAPING, INC.
MULCH GRINDING FACILITY

WILLIAMS TOWNSHIP
CHATHAM COUNTY, N.C.

SCALE 1" = 30'

DRAWN BY MKM

CHECKED BY TAS

DATE 4/12/10

PROJECT NO. 400802

DRAWING NO. C499TP02 (Carlson)

This drawing is the property of Philip Post and Associates Inc. It is to only be used for the project and for the site specifically identified herein and is not to be used on any other project or site. It is to be returned upon the written request of Philip Post and Associates. Philip Post & Associates, Inc. COPYRIGHT 2010

REVISIONS

1. ADD BATHROOM FACILITY AND SAND FILTER SYSTEM

SHEET 3

OF 6



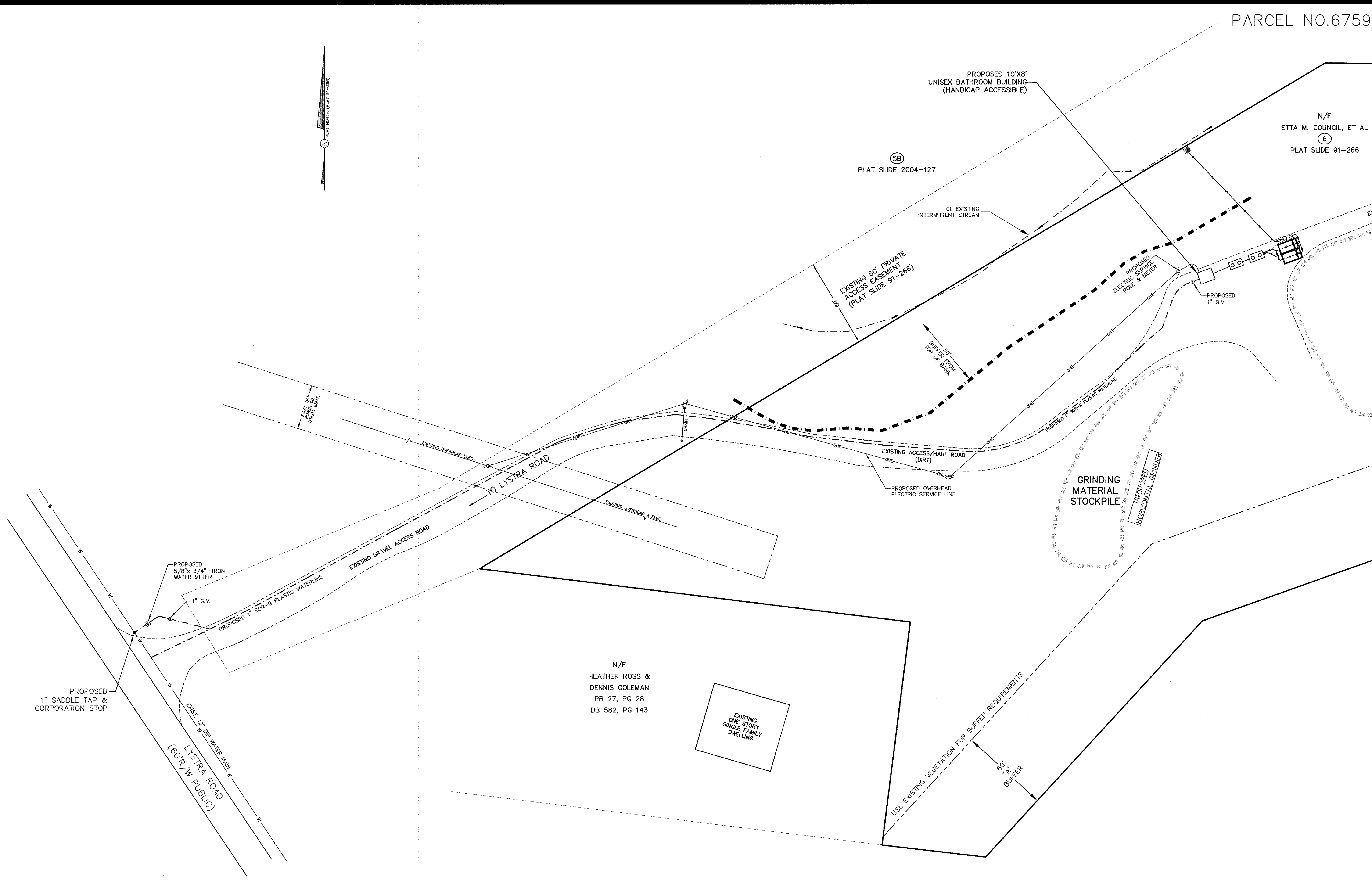

PARCEL NO.67592

N/F
ETTA M. COUNCIL, ET AL
6
PLAT SLIDE 91-266

5B
PLAT SLIDE 2004-127

PROPOSED 10'x8'
UNISEX BATHROOM BUILDING
(HANDICAP ACCESSIBLE)

CL. EXISTING
INTERMITTENT STREAM

EXISTING 60' PRIVATE
ACCESS EASEMENT
(PLAT SLIDE 91-266)

PROPOSED
ELECTRIC SERVICE
POLE & METER

PROPOSED
1" G.V.

EXISTING ACCESS/HAUL ROAD
(DIRT)

PROPOSED OVERHEAD
ELECTRIC SERVICE LINE

GRINDING
MATERIAL
STOCKPILE

PROPOSED
HORIZONTAL GRINDER

N/F
HEATHER ROSS &
DENNIS COLEMAN
PB 27, PG 28
DB 582, PG 143

EXISTING
ONE STORY
SINGLE FAMILY
DWELLING

PROPOSED
1" SADDLE TAP &
CORPORATION STOP

PROPOSED
5/8" x 3/4" IRON
WATER METER

1" G.V.

PROPOSED 1" SDR-9 PLASTIC WATERLINE

EXIST 12" W. DI. WATER MAIN W

LYSTRA ROAD
(60' R/W PUBLIC)

LEGEND

- W — W — EXISTING WATER MAIN
- PROPOSED 1" SDR-9 PLASTIC WATERLINE
- PROPOSED 1" BLACK PLASTIC WATER SERVICE
- PROPOSED NEW WATER METER
- OHE — PROPOSED OVERHEAD ELECTRIC SERVICE w/POLE

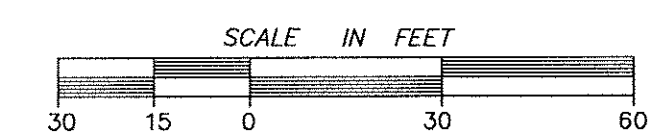

PREPARED FOR:
MARK MOLDENHAUER
MOLDENHAUER LANDSCAPING
611 LYSTRA ESTATES DR.
CHAPEL HILL, NC 27517

ENGINEERS
PLANNERS
SURVEYORS
PHILIP POST & ASSOCIATES
401 Providence Rd. #200
Chapel Hill, NC 27514
919.929.1173
919.493.2600
Greensboro: 336.580.8169
Firm License C-0347

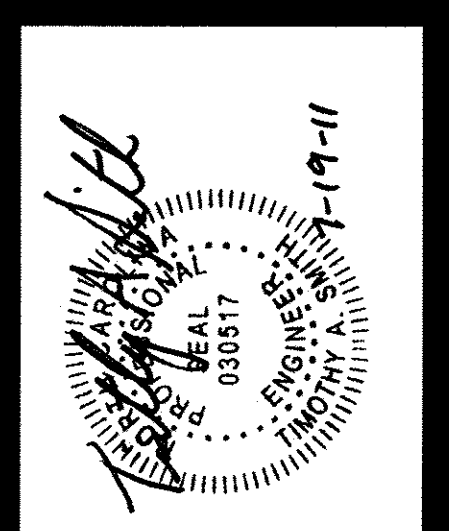

UTILITY PLAN
MOLDENHAUER LANDSCAPING, INC.
MULCH GRINDING FACILITY
WILLIAMS TOWNSHIP
CHATHAM COUNTY, N.C.

SCALE: 1" = 30'
DRAWN BY: MKM
CHECKED BY: TJS
DATE: 4/12/10
PROJECT NO.: 400802
DRAWING NO.: C499TP02 (Carlson)
This drawing is the property of Philip Post and Associates, Inc. and is not to be used or reproduced in any form without the written consent of Philip Post and Associates, Inc. It is to be used only for the project and site for which it was prepared.

REVISIONS	
1. ADD BATHROOM FACILITY AND SAND FILTER SYSTEM	

SHEET 4
OF 6

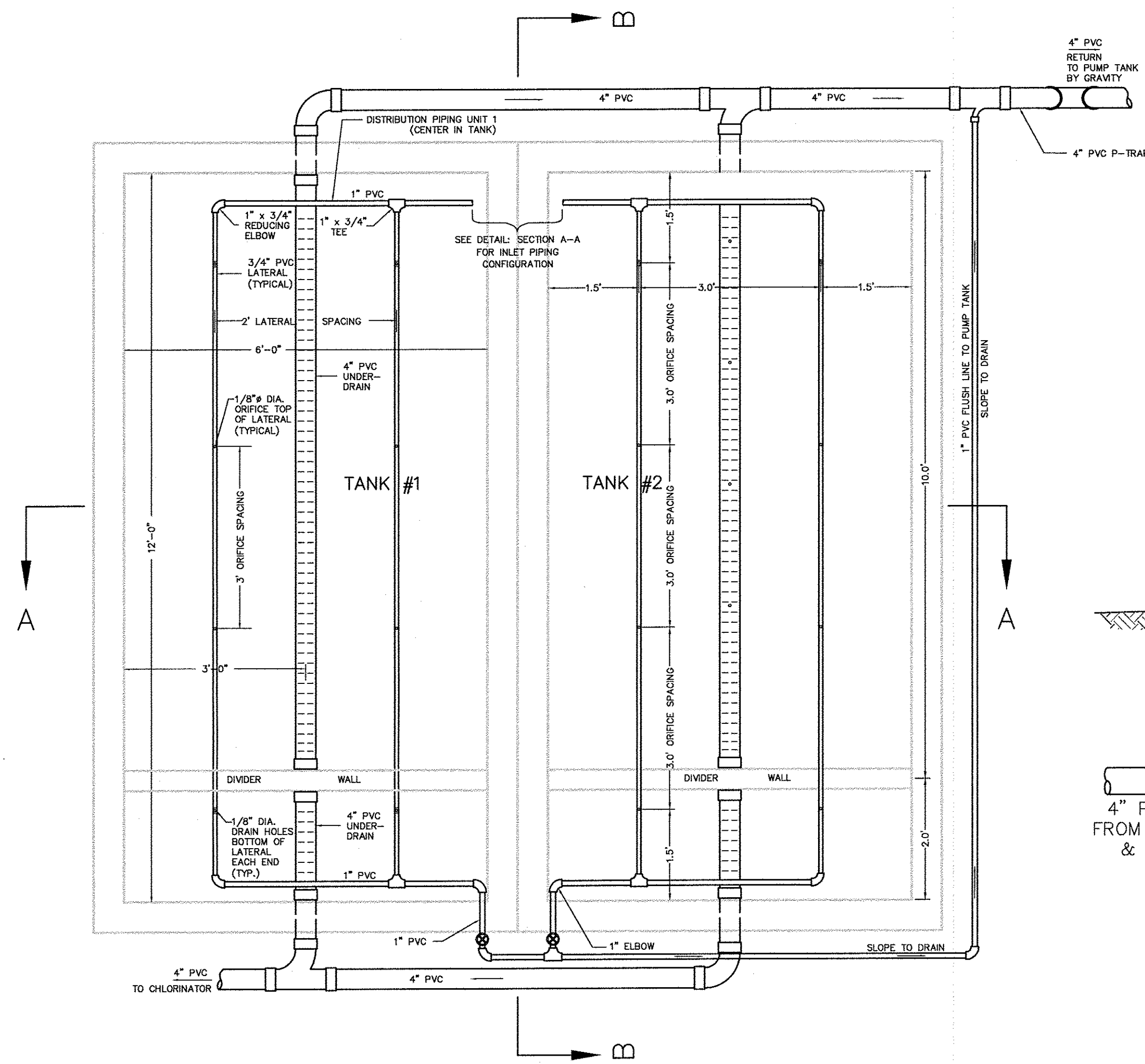

SAND FILTER DETAIL - PLAN VIEW

NTS

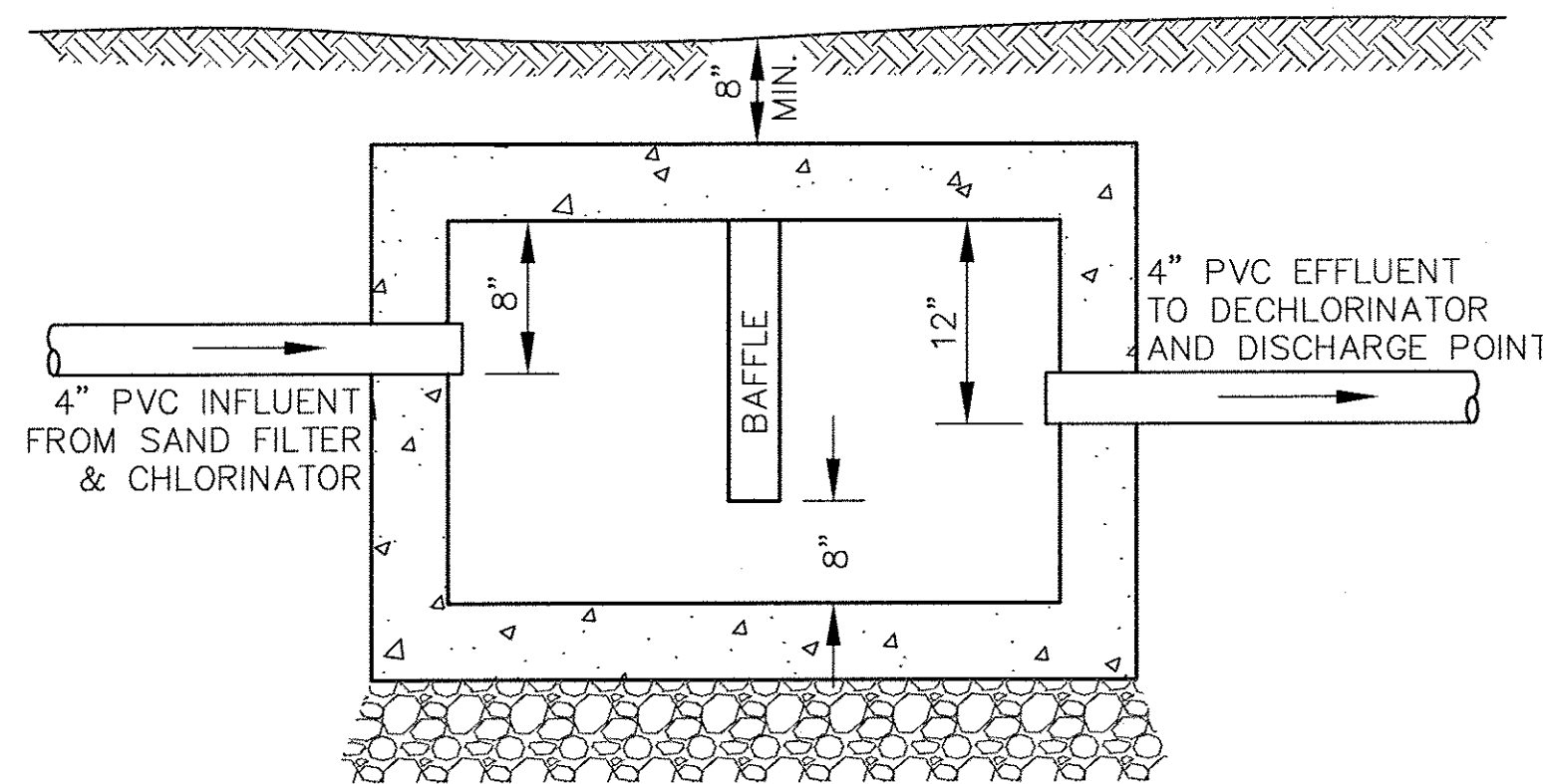

TYPICAL CHLORINE CONTACT TANK

NO SCALE

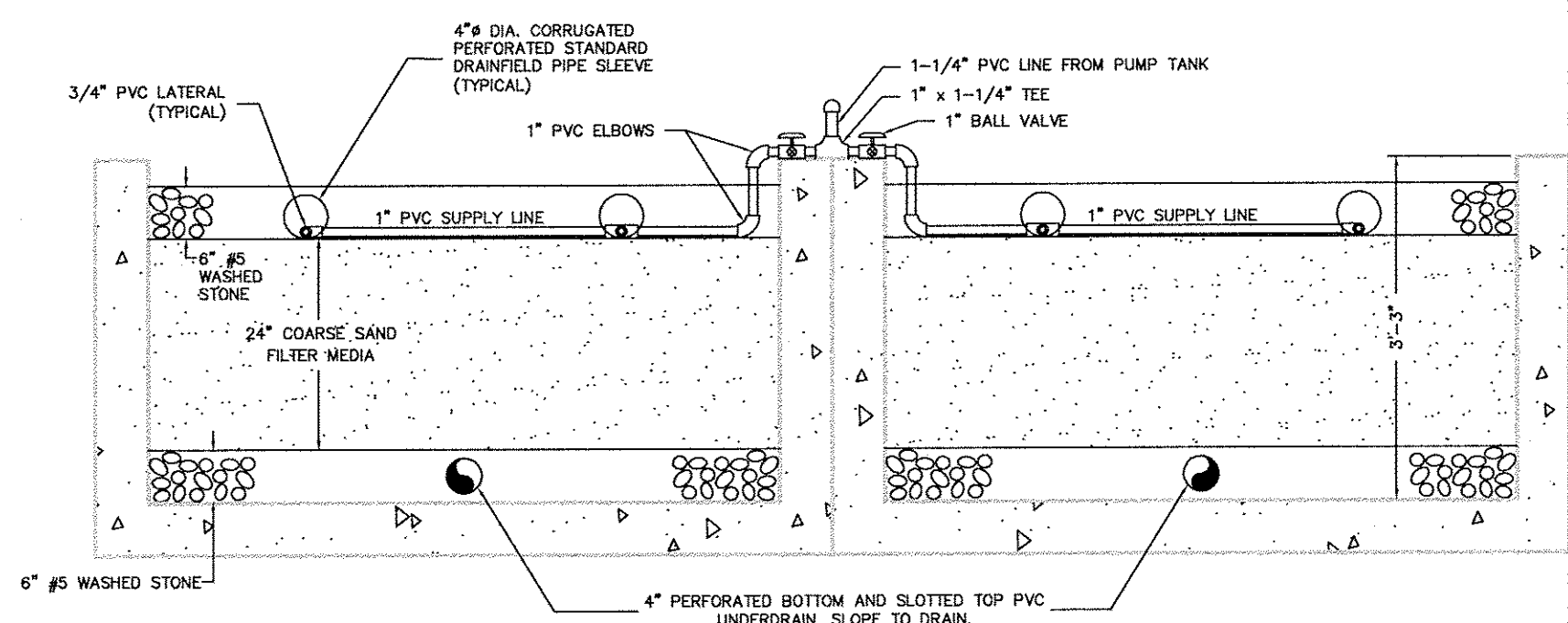
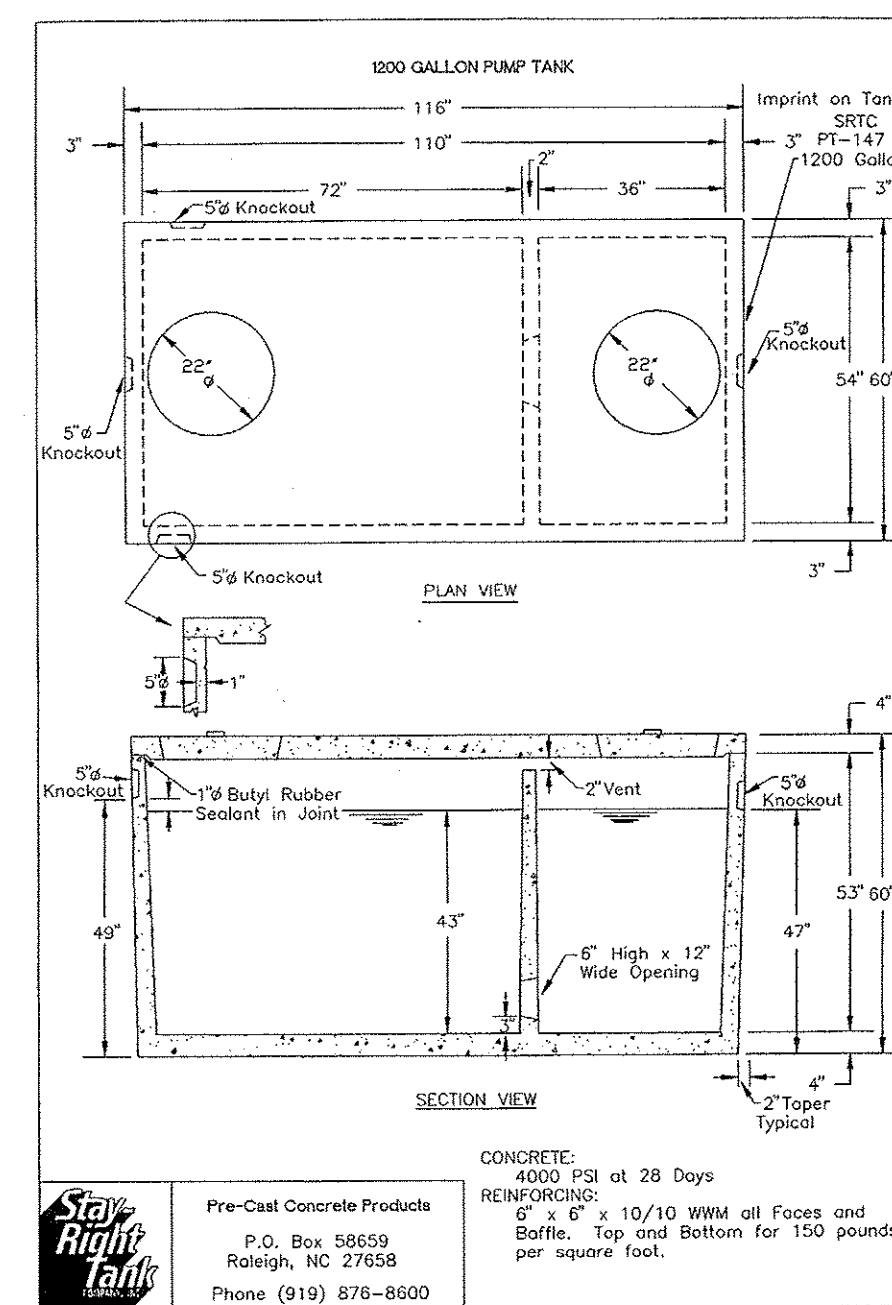
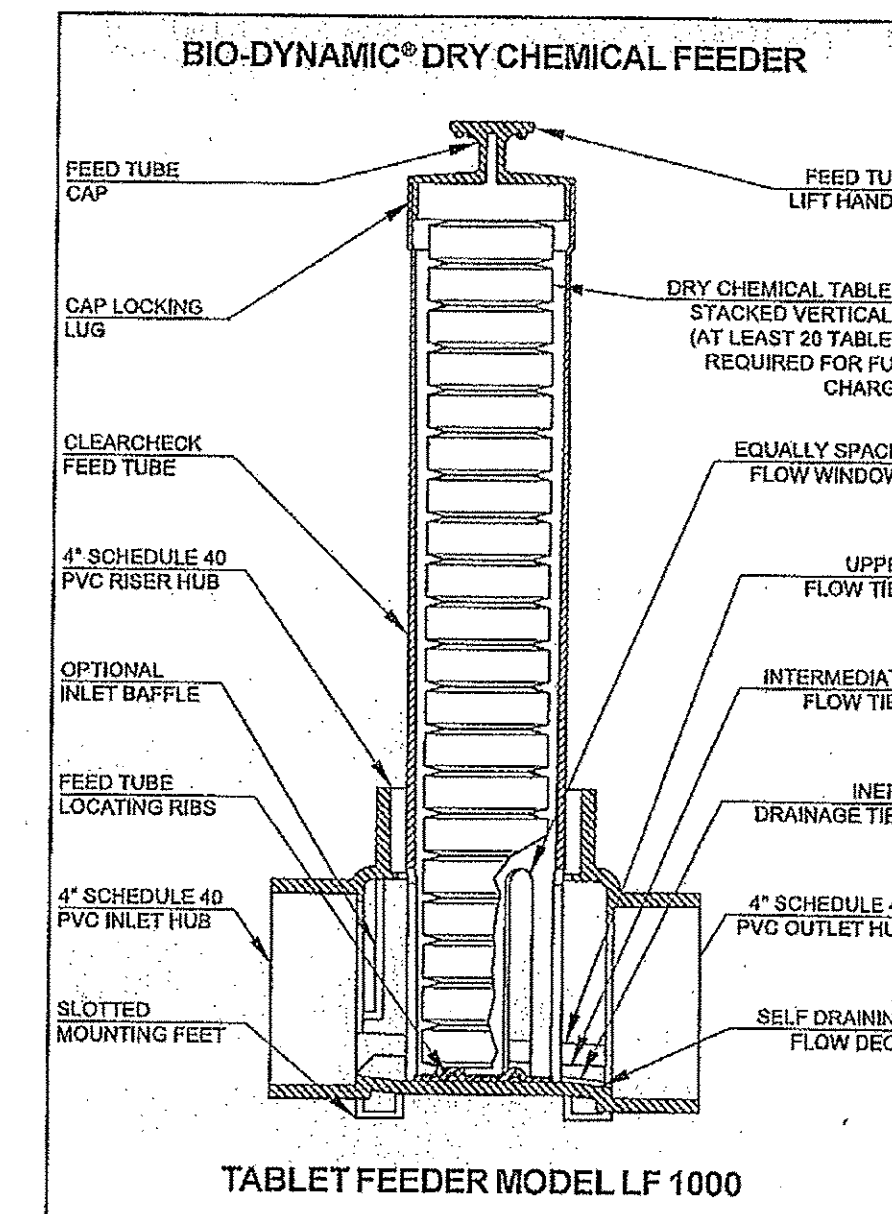
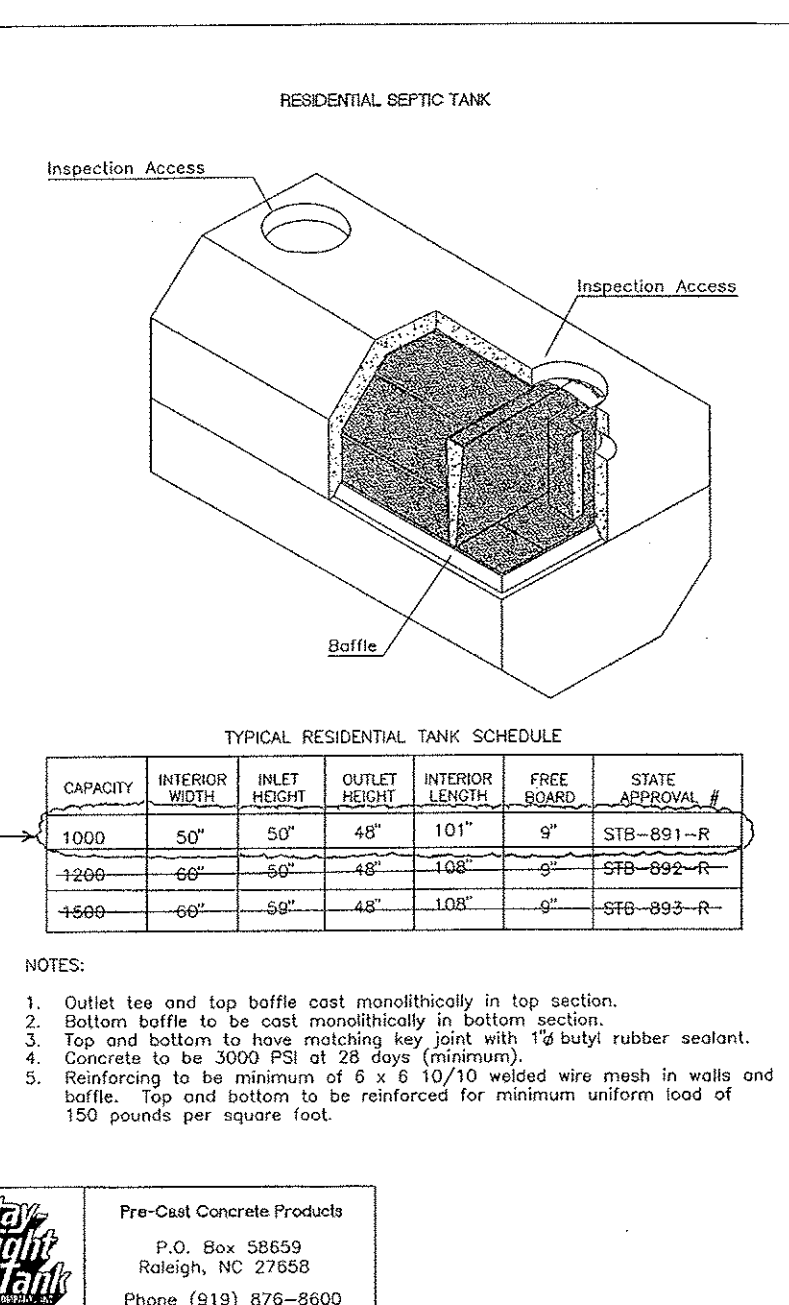
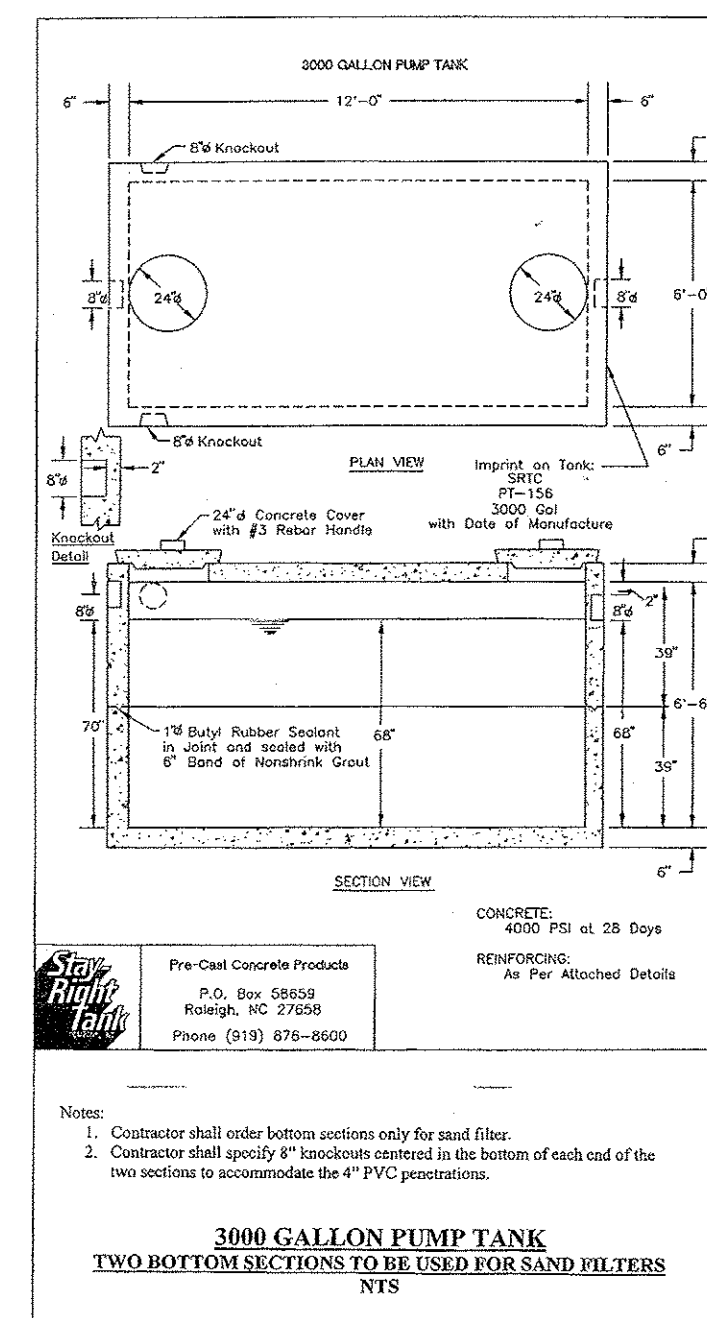

SAND FILTER DETAIL - SECTION A - A

SCALE:

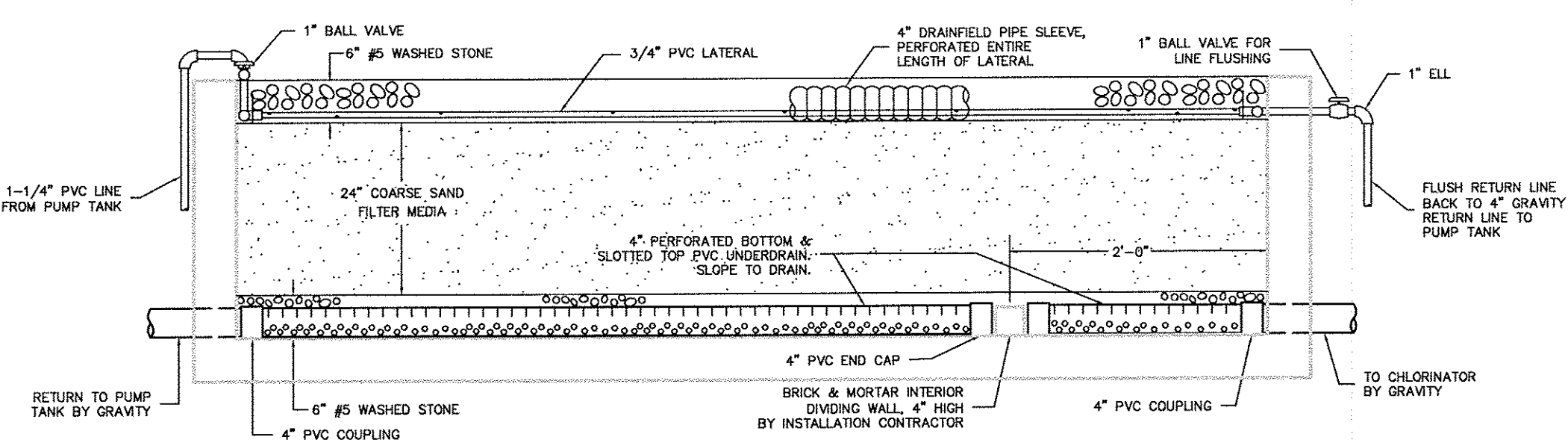

SAND FILTER DETAIL - SECTION B - B

NTS

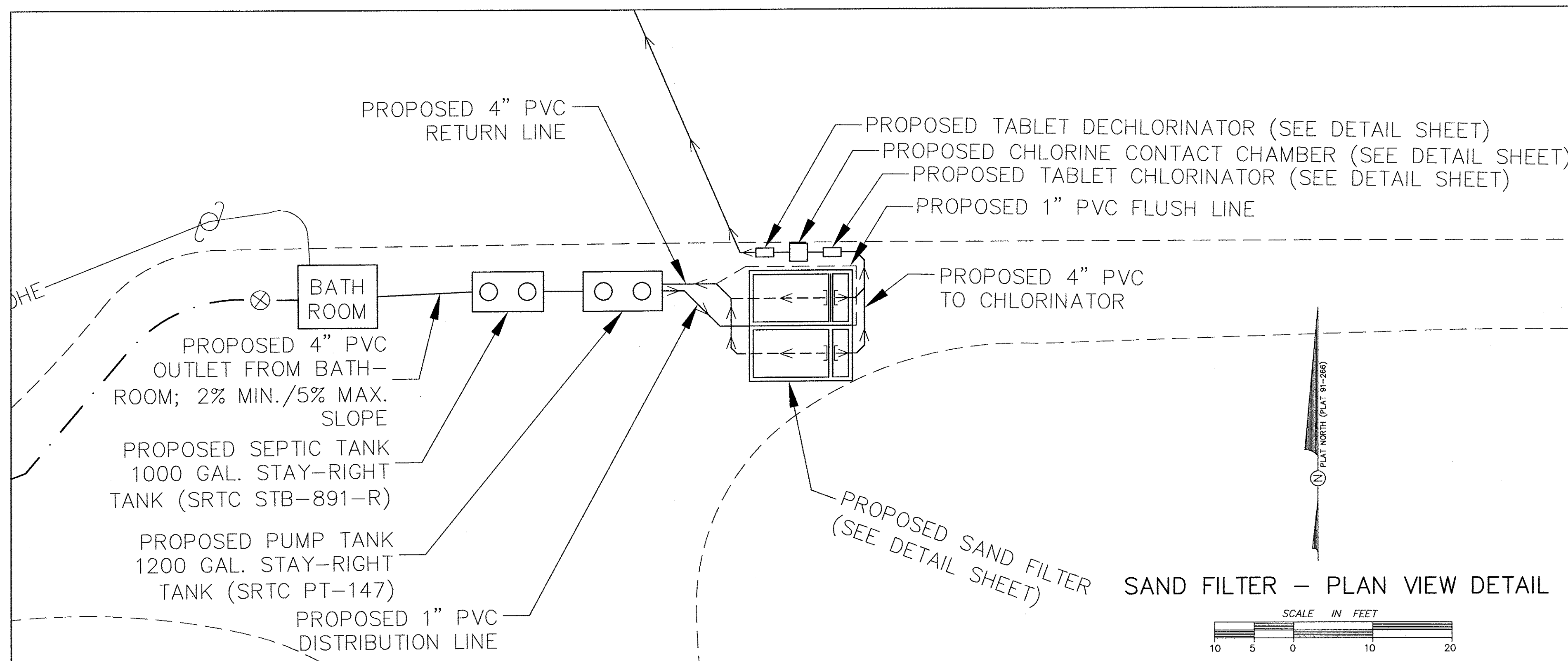

ENGINEERS
PLANNERS
SURVEYORS
PHILIP POST & ASSOCIATES
401 Providence Rd., #200
Chapel Hill, NC 27514
919.929.1173
919.495.2600
Greensboro: 336.580.8169
Firm License C-0347

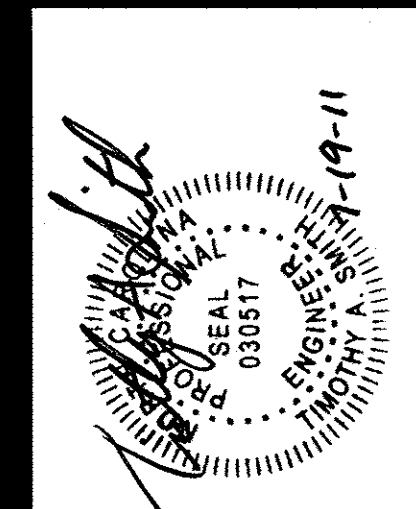

SAND FILTER DETAILS
MOLDENHAUER LANDSCAPING, INC.
MULCH GRINDING FACILITY
WILLIAMS TOWNSHIP
CHATHAM COUNTY, N.C.

SCALE: NOTED
DRAWN BY: MOP
CHECKED BY: TJS
DATE: 4/12/10
PROJECT NO. C49802
DRAWING NO. C49802 (Continued)
This drawing is the property of Philip Post and Associates, Inc. and is not to be reproduced or copied in whole or in part without the written consent of Philip Post and Associates, Inc. The information contained herein is for the use of the client only and is not to be used for any other purpose without the written consent of Philip Post and Associates, Inc. COPYRIGHT 2010 Philip Post & Associates, Inc.

REVISIONS
1. ADD BATHROOM FACILITY AND SAND FILTER SYSTEM

SHEET 6
OF 6

05/18/11