

LEGEND

	14 CORNUS FLORIDA	FLOWERING DOGWOOD	5'-6', 15 GAL.
	18 CERCIS CANADENSIS	EASTERN REDBUD	5'-6', 15 GAL.
	12 MORELLA CERIFERA (FORMERLY MYRICA CERIFERA)	WAX MYRTLE	3-4', 10 GAL.
	11 ILEX OPACA	AMERICAN HOLLY	24-36", 7 GAL.
	CORNUS AMOMUM	SWAMP DOGWOOD	LIVE STAKES

RIPARIAN BUFFER MIX ERNMX-1T8 FROM ERNST CONSERVATION SEEDS, PA SHALL BE USED WITHIN RIPARIAN PLANTING AREA.





NO MECHANIZED REMOVAL OF ROCK CHECK DAMS. HAND TOOLS TO BE USED ONLY.

McADAMS	PROJECT NO. NEW-09007
	FILENAME: RETWALL.DWG
	SCALE: 1" = 20'
	DATE: 07-22-2010

BRIAR CHAPEL
PHASE 5 SOUTH SECTION 1
MITIGATION PLAN
OVERALL WALL EXHIBIT

THE JOHN R. McADAMS COMPANY, INC.
 ENGINEERS • PLANNERS • SURVEYORS • ENVIRONMENTAL
 RESEARCH TRIANGLE PARK • CHARLOTTE • WILMINGTON
 2805 Meridian Parkway, Durham NC 27713
 800-733-5646 • www.johnr-mcadams.com • License No.: C-0283

LEGEND

	14	CORNUS FLORIDA	FLOWERING DOGWOOD	5'-6", 15 GAL.
	18	CERCIS CANADENSIS	EASTERN REDBUD	5'-6", 15 GAL.
	12	MORELLA CERIFERA (FORMERLY MYRICA CERIFERA)	WAX MYRTLE	3-4', 10 GAL.
	11	ILEX OPACA	AMERICAN HOLLY	24-36", 7 GAL.
		CORNUS AMOMUM	SWAMP DOGWOOD	LIVE STAKES

RIPARIAN BUFFER MIX ERNMX-17D FROM ERNST CONSERVATION SEEDS, PA SHALL BE USED WITHIN RIPARIAN PLANTING AREA.
NO MECHANIZED REMOVAL OF ROCK CHECK DAMS. HAND TOOLS TO BE USED ONLY.

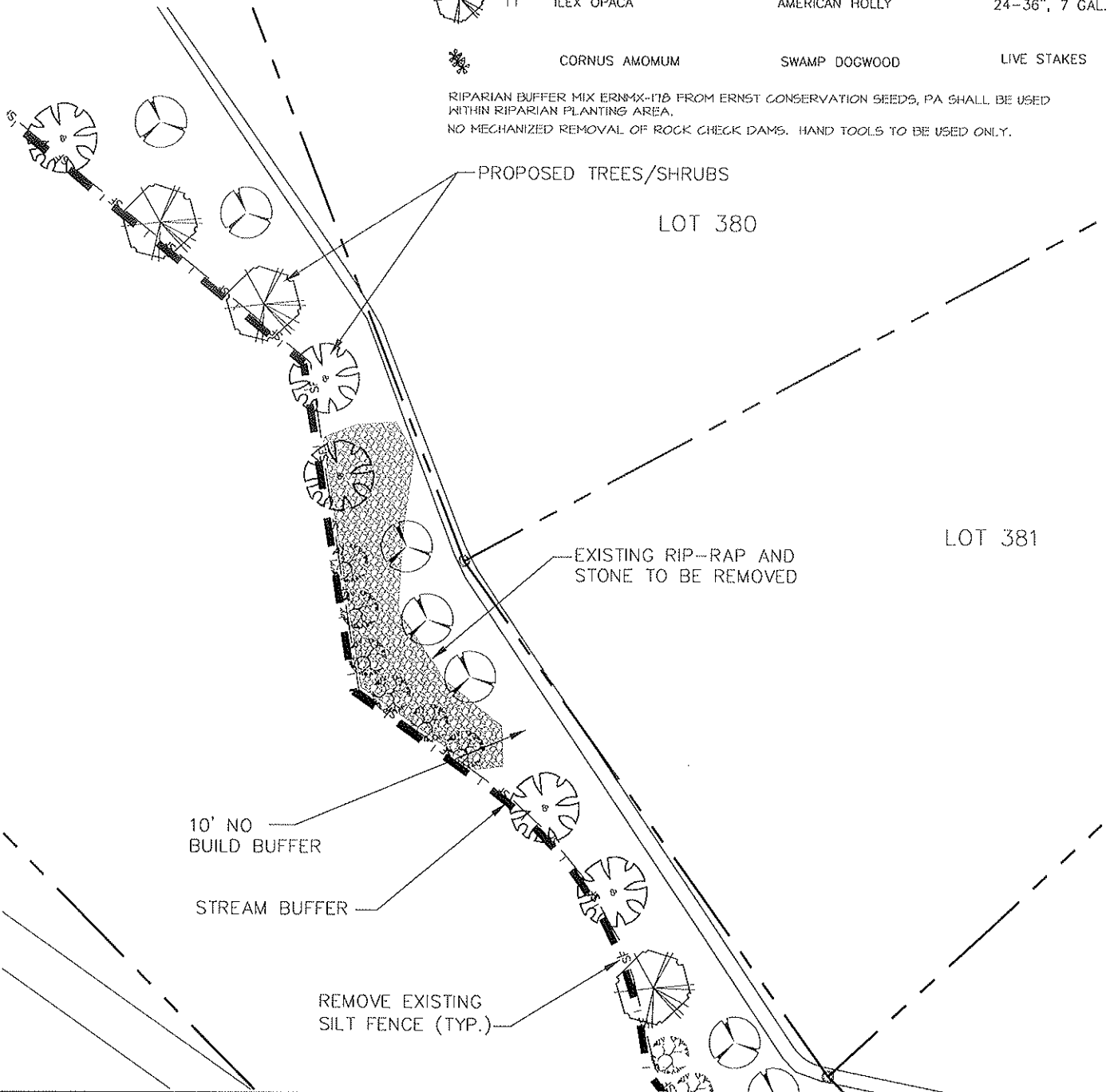





McADAMS	PROJECT NO.	NEW-09007
	FILENAME:	RETWALL.DWG
	SCALE:	1" = 20'
	DATE:	07-22-2010

BRIAR CHAPEL
PHASE 5 SOUTH SECTION 1
MITIGATION PLAN
WALL #1 EXHIBIT 1 OF 2

 **THE JOHN R. McADAMS COMPANY, INC.**
 ENGINEERS • PLANNERS • SURVEYORS • ENVIRONMENTAL
 RESEARCH TRIANGLE PARK • CHARLOTTE • WILMINGTON
 2905 Meridian Parkway, Durham NC 27713
 800-733-5646 • www.johnmcadams.com • License No.: C-0293

LEGEND

	14	CORNUS FLORIDA	FLOWERING DOGWOOD	5'-6", 15 GAL.
	18	CERCIS CANADENSIS	EASTERN REDBUD	5'-6", 15 GAL.
	12	MORELLA CERIFERA (FORMERLY MYRICA CERIFERA)	WAX MYRTLE	3-4', 10 GAL.
	11	ILEX OPACA	AMERICAN HOLLY	24-36", 7 GAL.
		CORNUS AMOMUM	SWAMP DOGWOOD	LIVE STAKES

RIPARIAN BUFFER MIX ERNMX-ITB FROM ERNST CONSERVATION SEEDS, PA SHALL BE USED WITHIN RIPARIAN PLANTING AREA.
NO MECHANIZED REMOVAL OF ROCK CHECK DAMS. HAND TOOLS TO BE USED ONLY.

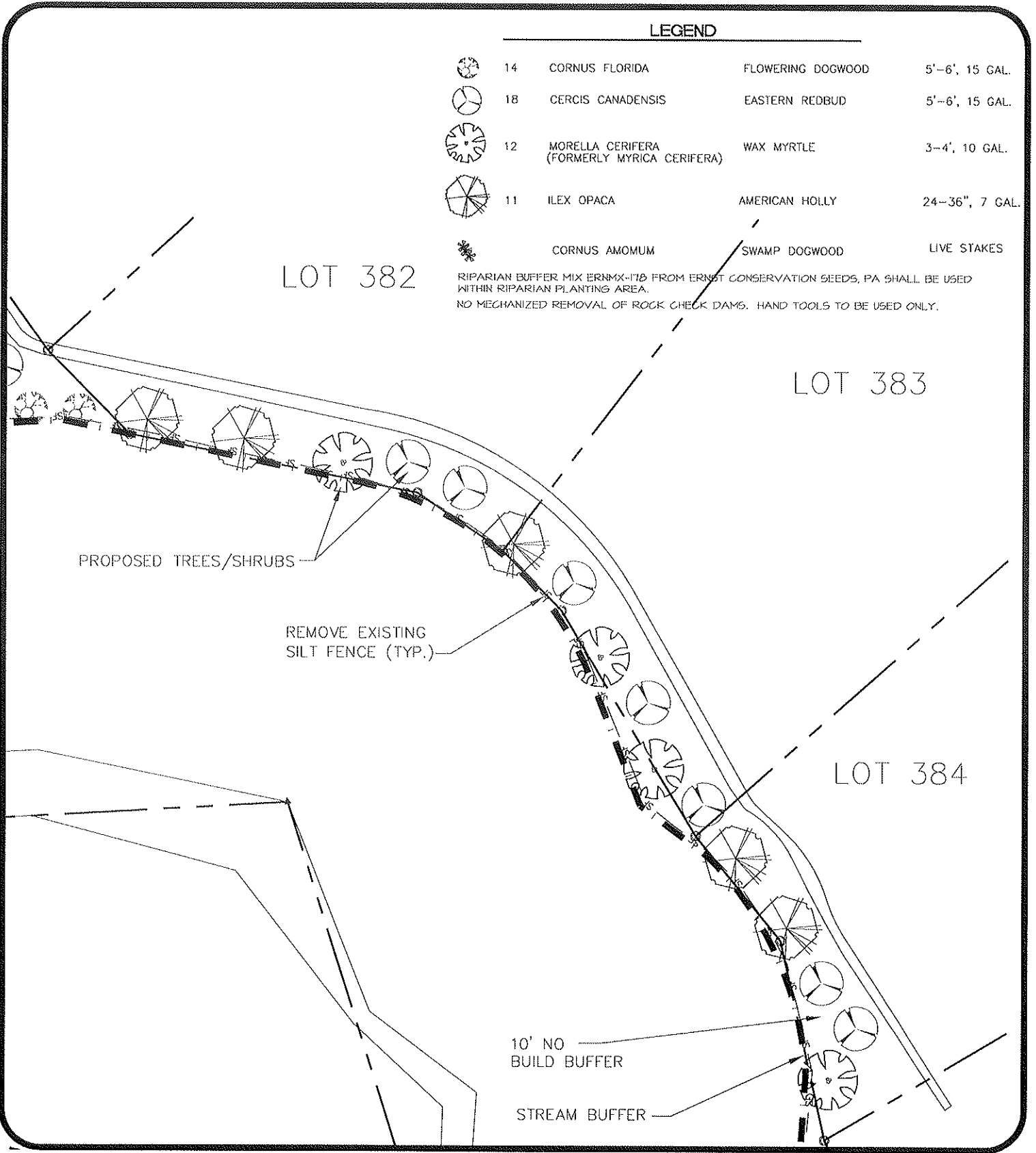

McADAMS	PROJECT NO.	NEW-09007
	FILENAME:	RETWALL.DWG
	SCALE:	1"=20'
	DATE:	07-22-2010

BRIAR CHAPEL
PHASE 5 SOUTH SECTION 1
MITIGATION PLAN
WALL #1 EXHIBIT 2 OF 2

 **THE JOHN R. McADAMS COMPANY, INC.**
 ENGINEERS • PLANNERS • SURVEYORS • ENVIRONMENTAL
 RESEARCH TRIANGLE PARK • CHARLOTTE • WILMINGTON
 2905 Meridian Parkway, Durham NC 27713
 800-733-5646 • www.johnmcadams.com • License No.: C-0293

LEGEND

	14	CORNUS FLORIDA	FLOWERING DOGWOOD	5'-6', 15 GAL.
	18	CERCIS CANADENSIS	EASTERN REDBUD	5'-6', 15 GAL.
	12	MORELLA CERIFERA (FORMERLY MYRICA CERIFERA)	WAX MYRTLE	3-4', 10 GAL.
	11	ILEX OPACA	AMERICAN HOLLY	24-36", 7 GAL.
		CORNUS AMOMUM	SWAMP DOGWOOD	LIVE STAKES

RIPARIAN BUFFER MIX ERNMX-17B FROM ERNST CONSERVATION SEEDS, PA SHALL BE USED WITHIN RIPARIAN PLANTING AREA.
NO MECHANIZED REMOVAL OF ROCK CHECK DAMS. HAND TOOLS TO BE USED ONLY.

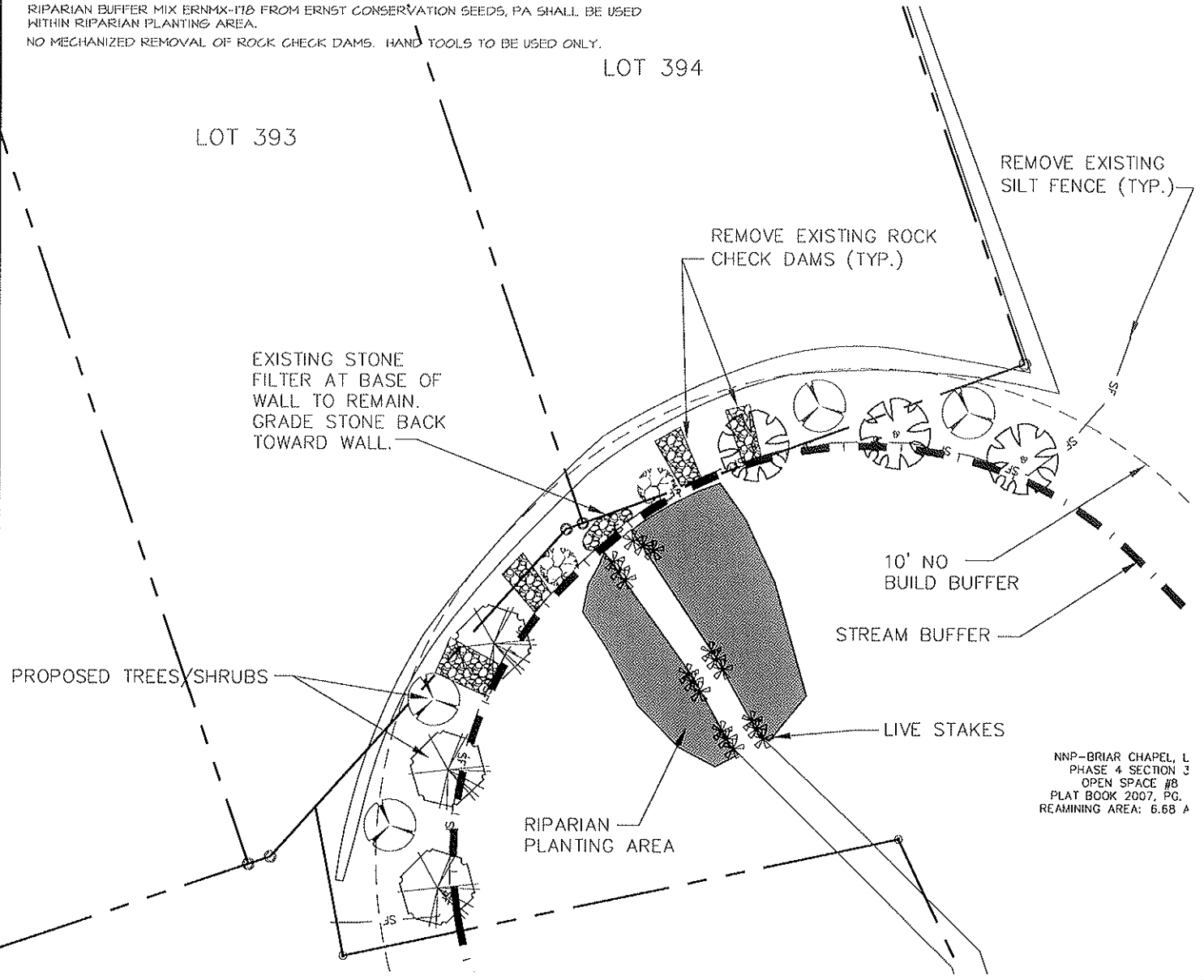

NNP-BRIAR CHAPEL, L
PHASE 4 SECTION 3
OPEN SPACE #8
PLAT BOOK 2007, PG.
REMAINING AREA: 6.68 A

	PROJECT NO.	NEW-09007
	FILENAME:	RETWALL.DWG
	SCALE:	1"=20'
	DATE:	07-22-2010

BRIAR CHAPEL
PHASE 5 SOUTH SECTION 1
MITIGATION PLAN
WALL #3 EXHIBIT

THE JOHN R. McADAMS COMPANY, INC.
ENGINEERS • PLANNERS • SURVEYORS • ENVIRONMENTAL
RESEARCH TRIANGLE PARK • CHARLOTTE • WILMINGTON
2905 Meridian Parkway, Durham NC 27713
800-733-5646 • www.johnmcadams.com • License No.: C-0293

CONSTRUCTION SEQUENCE:

1. PRIOR TO PERFORMING ANY WORK, OBTAIN APPROPRIATE EROSION AND SEDIMENTATION CONTROL APPROVAL FOR THE REMOVAL OF EROSION AND SEDIMENTATION CONTROL STRUCTURES.
2. REMOVE SILT FENCE, ROCK CHECK DAMS, RIP-RAP AND STONE AS INDICATED WITH AS LITTLE DISTURBANCE AS POSSIBLE USING HAND TOOLS. NO MECHANIZED REMOVAL IS PERMITTED. DISPOSE OF SPOIL MATERIAL IN AN APPROPRIATE LANDFILL AREA.
3. THE EXISTING STONE FILTER LOCATED AT THE BASE OF WALL #3 IS TO REMAIN FOR PURPOSES OF WALL INTEGRITY AND STABILITY. GRADE EXISTING STONE TOWARDS THE WALL.
4. PLANTING OF SPECIFIED SPECIES SHALL TAKE PLACE BETWEEN OCTOBER 1, 2010 AN NOVEMBER, 20 2010.

GENERAL NOTES:

1. FOR ALL PLANTED MATERIAL, THE CONTRACTOR SHALL BE RESPONSIBLE FOR MAINTAINING (I.E. A WARRANTY) AN 80% SURVIVAL RATE FOR THE DURATION OF THE FIRST YEAR. ANY COSTS ASSOCIATED WITH REPLACING PERMANENT PLANTINGS THAT DO NOT SURVIVE THE FIRST YEAR SHALL BE THE RESPONSIBILITY OF THE CONTRACTOR. AT THE END OF THE FIRST YEAR, AN ON-SITE INSPECTION WILL BE CONDUCTED BETWEEN THE CONTRACTOR AND DESIGNER. AT THAT TIME, THE CONTRACTOR WILL BE DIRECTED ACCORDINGLY ON REPLACEMENT OF ANY NECESSARY PLANTINGS.
2. THE ONE-YEAR WARRANTY SHALL INCLUDE MORTALITY AND POOR GROWTH DEFECTS, BUT SHALL NOT INCLUDE DEFECTS RESULTING FROM ABUSE BY OTHER PARTIES AND ABNORMAL WEATHER CONDITIONS. PLEASE NOTE THE 80% SURVIVAL RATE IS A MINIMUM STANDARD AND THE CONTRACTOR MAY PROVIDE ADDITIONAL MEASURES THEY DETERMINE WILL BE BENEFICIAL TO PLANT SURVIVABILITY. ANY ADDITIONAL MEASURES WILL BE CONSIDERED PART OF THE 80% SURVIVAL CLAUSE AND WILL NOT CONSTITUTE A CHANGE ORDER. THIS MAY INCLUDE, BUT IS NOT LIMITED TO, SOIL AMENDMENTS, IRRIGATION, AND MULCH.

McADAMS

PROJECT NO. NEW-09007
FILENAME: RETWALL.DWG
SCALE: 1" = 20'
DATE: 07-22-2010

BRIAR CHAPEL

PHASE 5 SOUTH SECTION 1

MITIGATION PLAN

CONSTRUCTION SEQUENCE



THE JOHN R. McADAMS
COMPANY, INC.

ENGINEERS • PLANNERS • SURVEYORS • ENVIRONMENTAL
RESEARCH TRIANGLE PARK • CHARLOTTE • WILMINGTON
2805 Meridian Parkway, Durham NC 27713
800-733-5646 • www.johnmcadams.com • License No.: C-0203