

NOTE: These parcels are located near an area that is presently used for agricultural purposes. Normal agricultural operations may conflict with residential land use. NC law (General Statutes Section 106-703) provides some protection for existing agricultural operations against subsequent rezoning.

USABLE AREA			
LOT	TOTAL AREA	BUFFER	NET AREA
LOT 1	1.61 Ac.	---	1.50 Ac.
LOT 2	1.51 Ac.	---	1.51 Ac.
LOT 3	1.62 Ac.	---	1.62 Ac.
LOT 4	2.62 Ac.	0.94 Ac.	1.68 Ac.
LOT 5	2.97 Ac.	1.45 Ac.	1.52 Ac.
LOT 6	1.68 Ac.	---	1.60 Ac.
LOT 7	3.33 Ac.	1.55 Ac.	0.11 Ac.
LOT 8	2.65 Ac.	0.87 Ac.	0.14 Ac.
LOT 9	2.01 Ac.	0.06 Ac.	0.11 Ac.
LOT 10	1.65 Ac.	---	0.10 Ac.
LOT 11	2.59 Ac.	0.41 Ac.	0.63 Ac.

TROY K. HOWARD ENTERPRISES, LLC
D.B. 1415 PG. 738

RUTH R. CLARK
D.B. 248 PG. 288

BILLIE SHAMBLEY
JOY SHAMBLEY
D.B. 482 PG. 377
PLAT SLUG 93-411

JOAN V. IDHATA
D.B. 1096 PG. 593
P.B. 14 PG. 37

JOAN V. IDHATA
D.B. 1096 PG. 593
P.B. 14 PG. 37

- NOTES**
- REFERENCE: Data Book 1415, Page 740 P.L.N. 9711-38-9544 Parcel # 87384
 - Approximate acreage to be subdivided: 25.01 Ac.
 - Approximate lineal feet of proposed road: 345'
 - A public water system is not presently available to this subdivision.
 - All lots to have individual well and septic systems.
 - All lots to be used for single family residential.
 - Average lot size: 2.20 Acres ±
 - Topo obtained from Chatham County GIS.
 - Zoning: unzoned
 - All distances and acreages shown are approximate.
 - The water features shown have been delineated by Chatham County and riparian buffers are measured from the top of bank. Refer to the Chatham County Watershed Protection Ordinance Section 404 for allowable and prohibited uses within the buffer area.
 - Owner: H & A PROPERTIES, INC. 625 E. Providence Church Rd. Pittsboro, N.C. 27312 (919) 544-1253
 - The water supply watershed district designation for this property is Local Watershed Area.
 - There are no State Designated Wet Head Protection Areas on this property.
 - Element Occurrences of natural diversity have been determined by and tracked by MCHWP, MCHWC, and USFWS on this property as per staff review. Loggerhead Shrike is an element occurrence in this general area.
 - This property does not contain or is not adjacent to a Significant Natural Heritage Area as shown on the Chatham County GIS website.
 - This property is not located within a designated 14 digit hydrological unit drainage basin that supports aquatic species that are federally listed or are listed as Federal Species of Concern.

- ADDITIONAL NOTES**
- A 404 permit/401 certification is not necessary for this property.
 - This property does not contain steep slopes, as defined in the Chatham County Soil Erosion and Sedimentation Ordinance and shown on the Chatham County GIS Website.
 - There are no existing covenants on this property.
 - There are no significant cultural or historical sites on this property.
 - A Non-Discharge Permit for a long application waste disposal system is not necessary for this property.
 - A permit for any subsurface wastewater disposal system of 3000 gallons/day or larger is not necessary for this property.
 - Professional Engineering services provided by: Wiann Engineering 1910 Saddleback Road Suite 200C Durham, N.C. 27713 919-506-5082

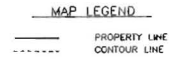

FIRST PLAT

FOR
**SHAMBLEY MEADOWS
PHASE IV**

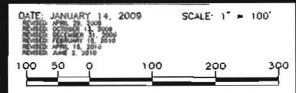

HICKORY HATH TOWNSHIP CHATHAM COUNTY, N.C.
VAN R. FINCH — LAND SURVEYS, P.A.
109 Hillsboro St. Pittsboro, N.C. 27312
919-542-2508