

Vicinity Map
Not To Scale

NOTE: 8' HIGH OVANGLE AND INTERMITTENT VISUAL OBSTRUCTION TO 20' HIGH

PLANT LEGEND — PROPOSED			
SYMBOL	QTY	BOTANICAL NAME, COMMON NAME	HEIGHT CAULPHER
TREES			
	24	AMRICA CERIFERA, SOUTHERN WAX MYRTLE	10-20' N/A
	24	ILEX YOMITORIA, YALPON HOLLY	15-20' N/A
	24	OSMANTHUS HETEROPHYLLUS, HOLLY TEA OLIVE	8-10' N/A
	20	JUNIPERUS VIRGINIANA, EASTERN RED CEDAR	30-40' 2.5"
SHRUBS			
	47	ILEX YOMITORIA "NANA", DWARF YALPON HOLLY	3-5' N/A
	28	ABELIA X GRANDIFLORA, GLOSSY ABELIA	3-6' N/A

- Landscape Notes:
- The landscape Buffer is 15 feet, and it is screen type "A".
 - The Chatham County street tree standards require 1 tree with a height of 30 feet at maturity per 40 feet of frontage. The site has approximately 500 feet of frontage along HWY 87 N and therefore requires 13 trees. We have provided 14 trees.
 - Chatham County requires 1 large tree of 35 feet at maturity and 4 shrubs per 2000 square feet of parking space. The site contains approximately 8500 square feet and therefore requires a minimum of 5 large trees and 17 shrubs. We have provided 14 trees and 75 shrubs.
 - The parking lot large tree requirements are covered by those planted along the street. The Eastern Red Cedars have a mature height of 40 feet, greater than the 30 foot and 35 foot requirements for the street and parking lot.
 - Existing trees shall be utilized wherever possible replacing proposed trees (based off field verification). Tree/Shrub substitution may be allowed on a case by case basis.

- PROPOSED LIGHTING INFORMATION:
- WALL PACK
 - POLE LIGHT
- Wall packs will be mounted 9-15' off the ground.
 - Wattage shall be typically 175 watts and a few 400 watt metal halide.
 - The pole lights shall be photocell lights mounted on 15' wooden poles and tilted downward.

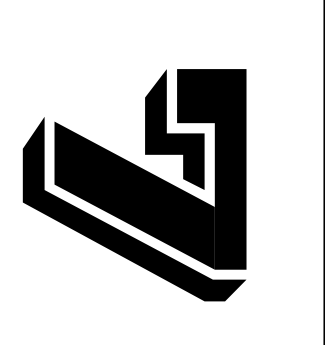
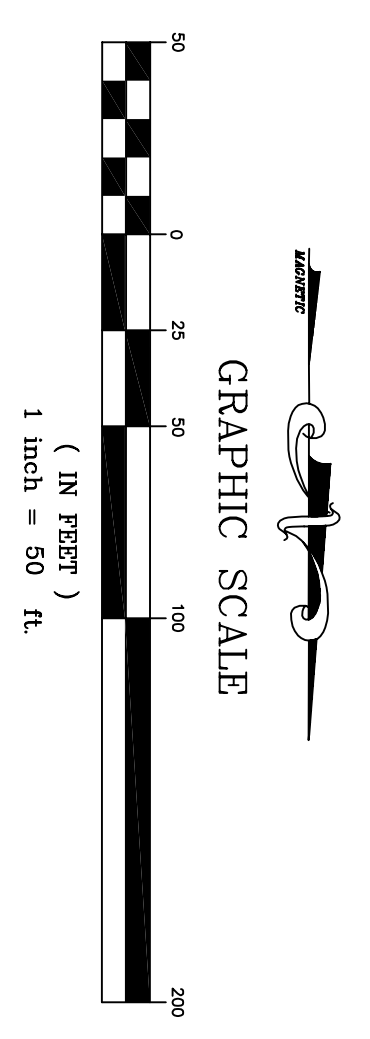
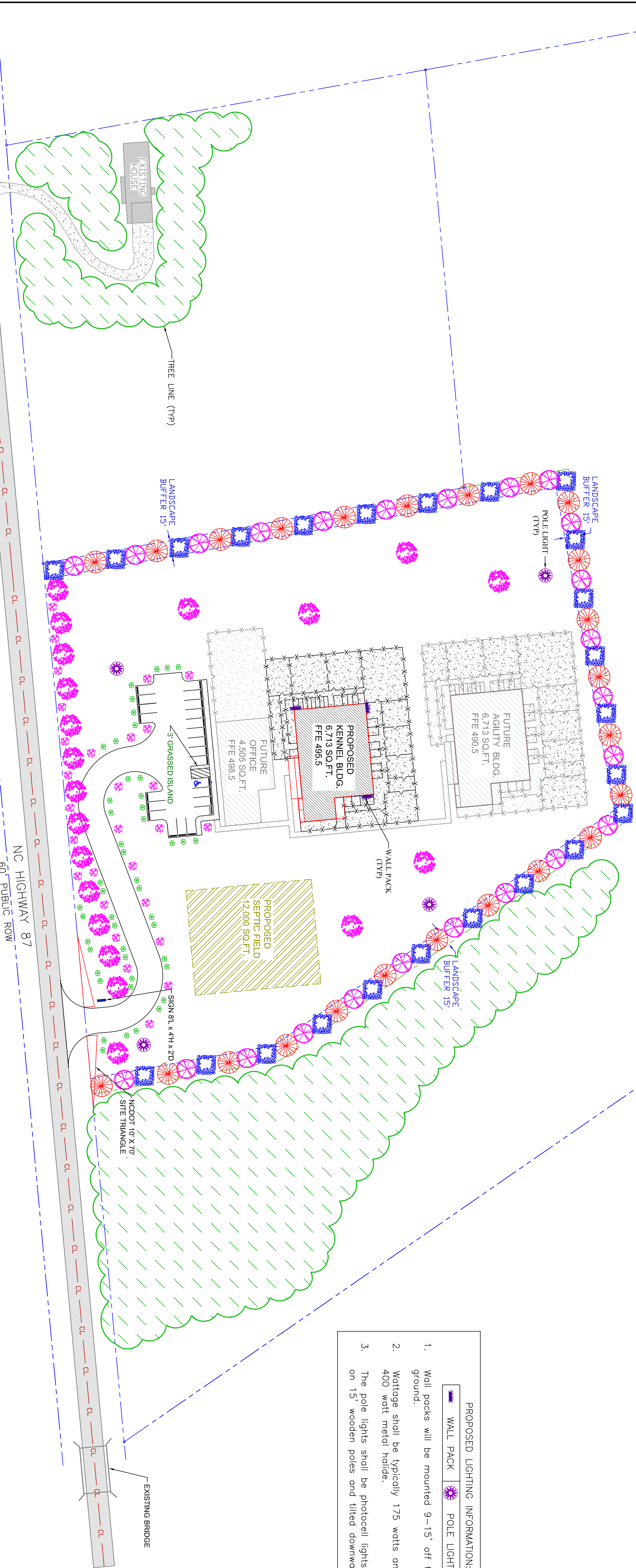

Landscape/Lighting Plan

For
Schultz Kennel

Date: 8-1-08
 Scale: 1" = 50'
 Drawn By: EDS/RLH
 Job #: 79-1107
 File: Schultz072908.dwg
 Revision:

John W. Harris, P.E.
 Consulting Engineer, Inc.
 5112 Bur Oak Circle
 Raleigh, N.C. 27612
 (919) 789-0744

