

LIBERTY ENTERPRISE, INC.

STORMWATER MANAGEMENT:
All new construction shall comply with the County
requirement of detention of the 2-year 24 hour storm
event.

Disturbed area: 1.09 acres

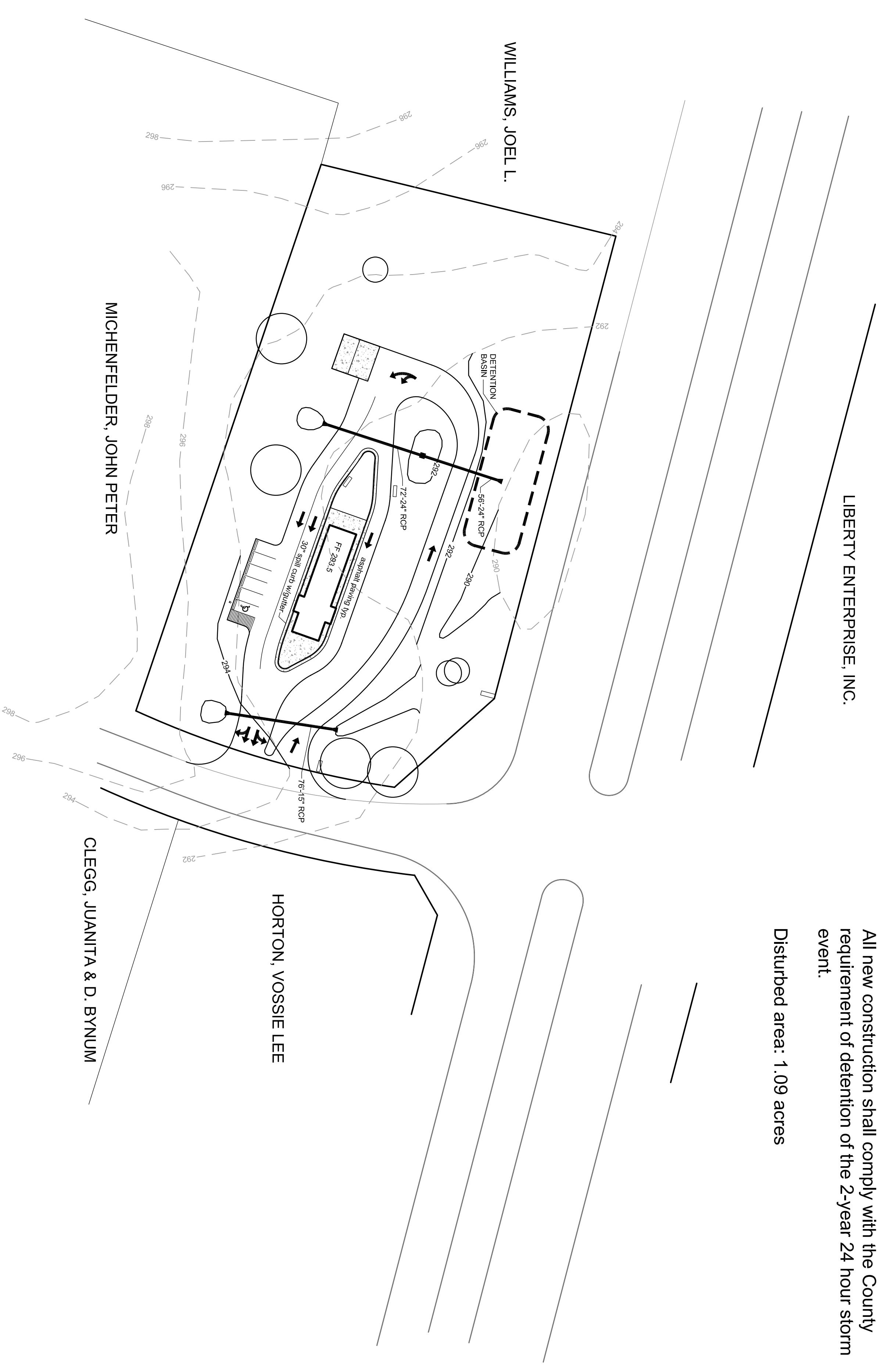

Grading and Drainage Plan

October 15, 2008

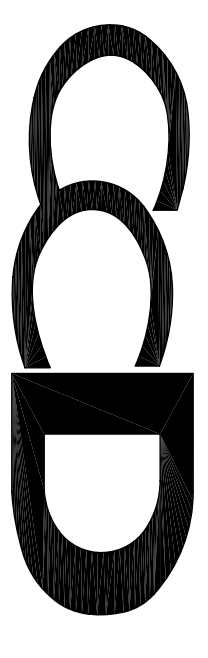
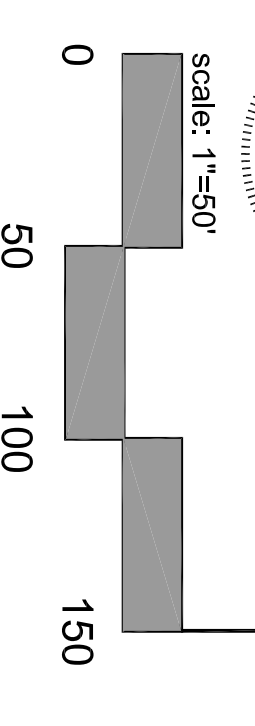
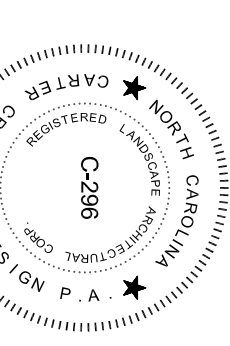

Carter Crawford DESIGN
Land Planning Landscape Architecture Urban Design
400 Heritage Village Lane Apex, NC 27502
919 387 8218 voice 919 387 6548 fax