

LIBERTY ENTERPRISE, INC.

STORMWATER MANAGEMENT:
All new construction shall comply with the County
requirement of detention of the 2-year 24 hour storm
event.

Disturbed area: 1.09 acres

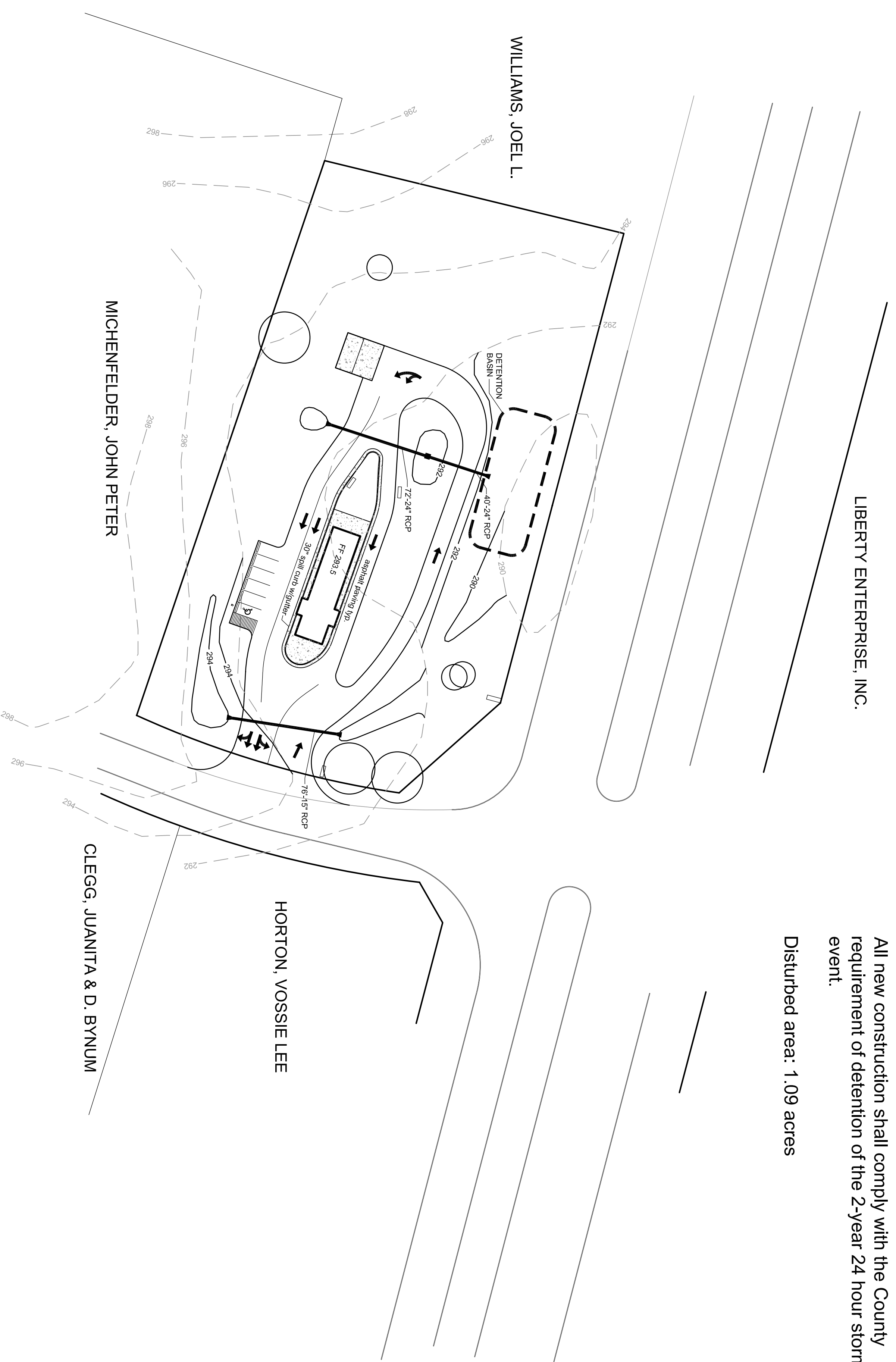

Grading and Drainage Plan

December 1, 2008

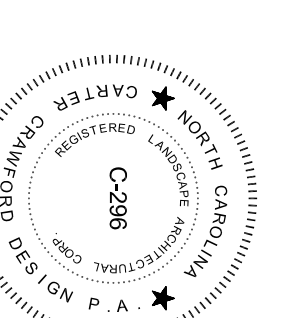

scale: 1"=50'

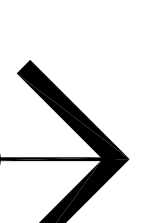
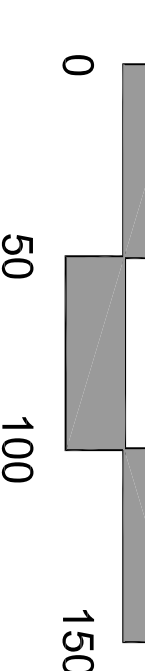

Carter Crawford Design
Land Planning, Landscape Architecture, Urban Design
400 Heritage Village Lane, Apex, NC 27502
919 387 8218 voice, 919 387 6548 fax
www.cartercrawford.com

This document is an electronic file. All rights are reserved. No part of this document may be reproduced, stored in a retrieval system, or transmitted in any form or by any means, electronic, mechanical, photocopying, recording, or by any information storage and retrieval system, without the prior written permission of Carter Crawford Design, P.A. Use of this document or associated electronic files for any purpose other than that for which it was provided, including copying, are the sole property of Carter Crawford Design, P.A. All other rights reserved.