

Sheet No.	1
Project No.	1000
Scale	1" = 100'
Date	11/21/2013
Drawn by	JW/MS
Checked by	JW/MS
Project Name	THE HAMPTONS
Location	NORTH CAROLINA

THE HAMPTONS
NORTH CAROLINA

PRELIMINARY SKETCH DESIGN

WITHERS & RAVENEL
ENGINEERS, PLANNERS & SURVEYORS

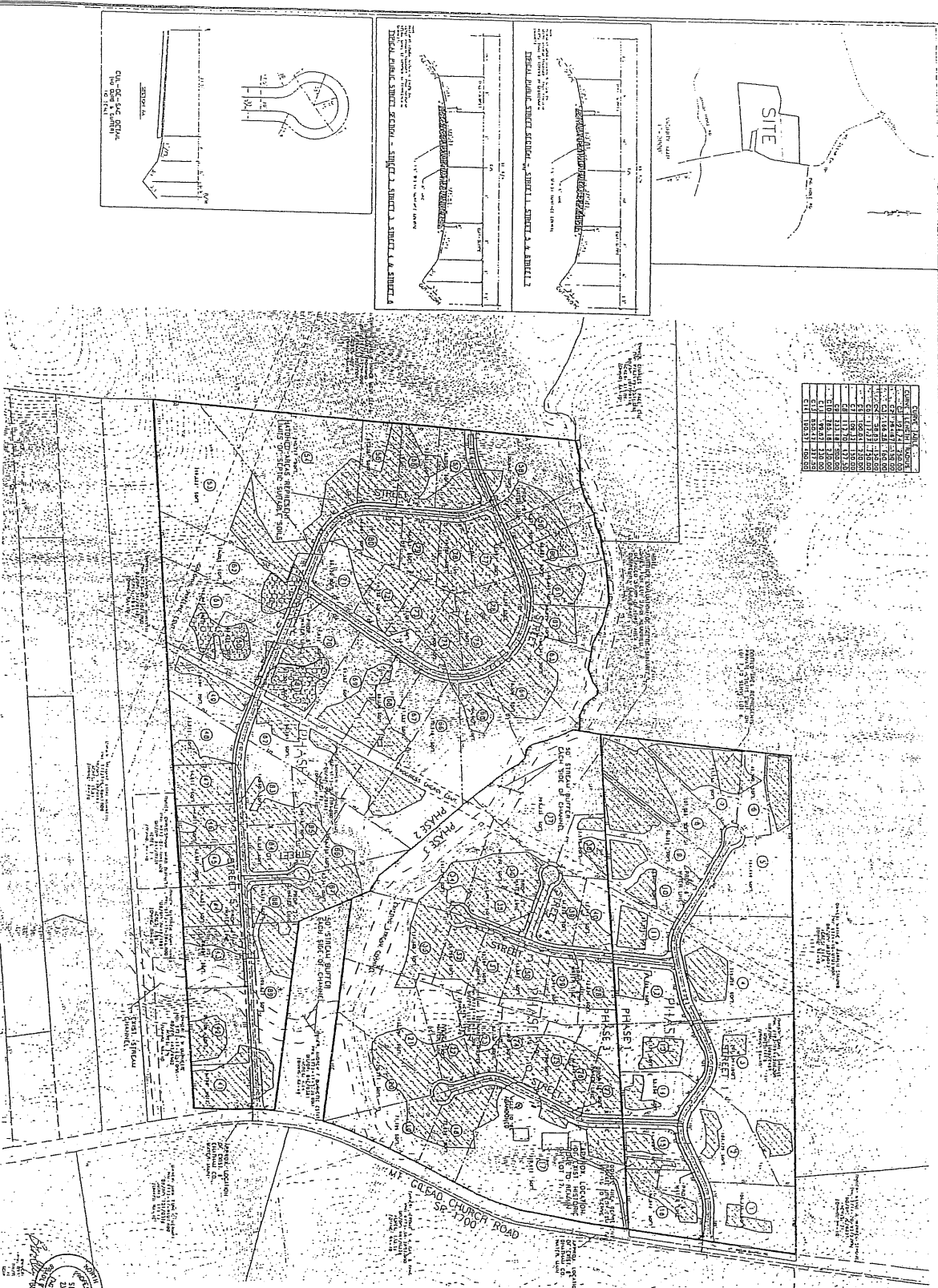

Lot No.	Area (Ac.)	Area (Sq. Ft.)
1	0.10	6,900
2	0.10	6,900
3	0.10	6,900
4	0.10	6,900
5	0.10	6,900
6	0.10	6,900
7	0.10	6,900
8	0.10	6,900
9	0.10	6,900
10	0.10	6,900
11	0.10	6,900
12	0.10	6,900
13	0.10	6,900
14	0.10	6,900
15	0.10	6,900
16	0.10	6,900
17	0.10	6,900
18	0.10	6,900
19	0.10	6,900
20	0.10	6,900
21	0.10	6,900
22	0.10	6,900
23	0.10	6,900
24	0.10	6,900
25	0.10	6,900
26	0.10	6,900
27	0.10	6,900
28	0.10	6,900
29	0.10	6,900
30	0.10	6,900
31	0.10	6,900
32	0.10	6,900
33	0.10	6,900
34	0.10	6,900
35	0.10	6,900
36	0.10	6,900
37	0.10	6,900
38	0.10	6,900
39	0.10	6,900
40	0.10	6,900
41	0.10	6,900
42	0.10	6,900
43	0.10	6,900
44	0.10	6,900
45	0.10	6,900
46	0.10	6,900
47	0.10	6,900
48	0.10	6,900
49	0.10	6,900
50	0.10	6,900
51	0.10	6,900
52	0.10	6,900
53	0.10	6,900
54	0.10	6,900
55	0.10	6,900
56	0.10	6,900
57	0.10	6,900
58	0.10	6,900
59	0.10	6,900
60	0.10	6,900
61	0.10	6,900
62	0.10	6,900
63	0.10	6,900
64	0.10	6,900
65	0.10	6,900
66	0.10	6,900
67	0.10	6,900
68	0.10	6,900
69	0.10	6,900
70	0.10	6,900
71	0.10	6,900
72	0.10	6,900
73	0.10	6,900
74	0.10	6,900
75	0.10	6,900
76	0.10	6,900
77	0.10	6,900
78	0.10	6,900
79	0.10	6,900
80	0.10	6,900
81	0.10	6,900
82	0.10	6,900
83	0.10	6,900
84	0.10	6,900
85	0.10	6,900
86	0.10	6,900
87	0.10	6,900
88	0.10	6,900
89	0.10	6,900
90	0.10	6,900
91	0.10	6,900
92	0.10	6,900
93	0.10	6,900
94	0.10	6,900
95	0.10	6,900
96	0.10	6,900
97	0.10	6,900
98	0.10	6,900
99	0.10	6,900
100	0.10	6,900

- NOTICE:
1. SETBACK PROPERTY BOUNDARIES SHOWN ARE FROM GRANITE COUNTY GIS INFORMATION.
 2. EXISTING & WATER UTILITIES SHOWN AS FROM GRANITE COUNTY GIS INFORMATION.
 3. EXISTING TOPOGRAPHY AND STREAK LOCATIONS ARE BASED ON LIDAR DATA ELEVATION MODEL.
 4. ALL PROPOSED STREETS ARE TO BE CONSTRUCTED IN ACCORDANCE WITH NCDOA AND GRANITE COUNTY REQUIREMENTS AND SHALL BE DESIGNED AS PUBLIC.
 5. ALL PROPOSED STREETS FOR ALL LOTS WITHIN THIS PROJECT SHALL BE VA SERVICE STREETS. STAKE SETS SHALL BE MAINTAINED IN PLACE 1 YEAR AFTER FIELD SURVEY AND STAKE REMOVAL THROUGH BY JOHN P. GAY OR HIS DESIGNATION PROVIDED IN PER A COMBINATION.
 6. THE PROPOSED PAVING AND PROPOSED LAND PAVING INFORMATION FOR PHASES 1 THROUGH 10 ARE AS FOLLOWS:

ESTIMATED PROJECT DEVELOPMENT SCHEDULE:

PHASE 1	COMPLETION DATE	NOVEMBER 2013
PHASE 2	COMPLETION DATE	DECEMBER 2013
PHASE 3	COMPLETION DATE	JANUARY 2014

ENGINEERING CONSULTANT:

WITHERS & RAVENEL, INC.
1000 W. HARRIS STREET
RICHMOND, NC 28804
PH: 813-453-2100
FAX: 813-233-2220
E-MAIL: WITHERS@WITHERSRAVENEL.COM

DRAWN BY: JAMES W. WITHERS
CHECKED BY: MICHAEL S. RAVENEL
DATE: 11/21/2013

THE HAMPTONS - PROJECT DATA

TOTAL PROJECT SITE: 107.2 AC

PHASE 1: 10.72 AC

PHASE 2: 10.72 AC

PHASE 3: 10.72 AC

PHASE 4: 10.72 AC

PHASE 5: 10.72 AC

PHASE 6: 10.72 AC

PHASE 7: 10.72 AC

PHASE 8: 10.72 AC

PHASE 9: 10.72 AC

PHASE 10: 10.72 AC

PROPOSED LOT 1015: 0.10 AC

PROPOSED LOT 1016: 0.10 AC

PROPOSED LOT 1017: 0.10 AC

PROPOSED LOT 1018: 0.10 AC

PROPOSED LOT 1019: 0.10 AC

PROPOSED LOT 1020: 0.10 AC

PROPOSED LOT 1021: 0.10 AC

PROPOSED LOT 1022: 0.10 AC

PROPOSED LOT 1023: 0.10 AC

PROPOSED LOT 1024: 0.10 AC

PROPOSED LOT 1025: 0.10 AC

PROPOSED LOT 1026: 0.10 AC

PROPOSED LOT 1027: 0.10 AC

PROPOSED LOT 1028: 0.10 AC

PROPOSED LOT 1029: 0.10 AC

PROPOSED LOT 1030: 0.10 AC

PROPOSED LOT 1031: 0.10 AC

PROPOSED LOT 1032: 0.10 AC

PROPOSED LOT 1033: 0.10 AC

PROPOSED LOT 1034: 0.10 AC

PROPOSED LOT 1035: 0.10 AC

PROPOSED LOT 1036: 0.10 AC

PROPOSED LOT 1037: 0.10 AC

PROPOSED LOT 1038: 0.10 AC

PROPOSED LOT 1039: 0.10 AC

PROPOSED LOT 1040: 0.10 AC

PROPOSED LOT 1041: 0.10 AC

PROPOSED LOT 1042: 0.10 AC

PROPOSED LOT 1043: 0.10 AC

PROPOSED LOT 1044: 0.10 AC

PROPOSED LOT 1045: 0.10 AC

PROPOSED LOT 1046: 0.10 AC

PROPOSED LOT 1047: 0.10 AC

PROPOSED LOT 1048: 0.10 AC

PROPOSED LOT 1049: 0.10 AC

PROPOSED LOT 1050: 0.10 AC

PROPOSED LOT 1051: 0.10 AC

PROPOSED LOT 1052: 0.10 AC

PROPOSED LOT 1053: 0.10 AC

PROPOSED LOT 1054: 0.10 AC

PROPOSED LOT 1055: 0.10 AC

PROPOSED LOT 1056: 0.10 AC

PROPOSED LOT 1057: 0.10 AC

PROPOSED LOT 1058: 0.10 AC

PROPOSED LOT 1059: 0.10 AC

PROPOSED LOT 1060: 0.10 AC

PROPOSED LOT 1061: 0.10 AC

PROPOSED LOT 1062: 0.10 AC

PROPOSED LOT 1063: 0.10 AC

PROPOSED LOT 1064: 0.10 AC

PROPOSED LOT 1065: 0.10 AC

PROPOSED LOT 1066: 0.10 AC

PROPOSED LOT 1067: 0.10 AC

PROPOSED LOT 1068: 0.10 AC

PROPOSED LOT 1069: 0.10 AC

PROPOSED LOT 1070: 0.10 AC

PROPOSED LOT 1071: 0.10 AC

PROPOSED LOT 1072: 0.10 AC

PROPOSED LOT 1073: 0.10 AC

PROPOSED LOT 1074: 0.10 AC

PROPOSED LOT 1075: 0.10 AC

PROPOSED LOT 1076: 0.10 AC

PROPOSED LOT 1077: 0.10 AC

PROPOSED LOT 1078: 0.10 AC

PROPOSED LOT 1079: 0.10 AC

PROPOSED LOT 1080: 0.10 AC

PROPOSED LOT 1081: 0.10 AC

PROPOSED LOT 1082: 0.10 AC

PROPOSED LOT 1083: 0.10 AC

PROPOSED LOT 1084: 0.10 AC

PROPOSED LOT 1085: 0.10 AC

PROPOSED LOT 1086: 0.10 AC

PROPOSED LOT 1087: 0.10 AC

PROPOSED LOT 1088: 0.10 AC

PROPOSED LOT 1089: 0.10 AC

PROPOSED LOT 1090: 0.10 AC

PROPOSED LOT 1091: 0.10 AC

PROPOSED LOT 1092: 0.10 AC

PROPOSED LOT 1093: 0.10 AC

PROPOSED LOT 1094: 0.10 AC

PROPOSED LOT 1095: 0.10 AC

PROPOSED LOT 1096: 0.10 AC

PROPOSED LOT 1097: 0.10 AC

PROPOSED LOT 1098: 0.10 AC

PROPOSED LOT 1099: 0.10 AC

PROPOSED LOT 1100: 0.10 AC

