



**VICINITY MAP**  
MADE BY STATE

**SITE DATA**

TOTAL NUMBER OF PROPOSED SINGLE FAMILY LOTS = 27  
 AREA RESERVED BY OWNER: 20 AC.  
 AREA RESERVED FOR FUTURE DEVELOPMENT: 20.42 AC.  
 AREA RESERVED FOR SINGLE FAMILY DEVELOPMENT: 43.02 AC.

TOTAL TRACT AREA: 83.44 AC.

PIN No. 9766-10-8516 (JAMES E. DIXON)  
 9766-20-6324 (JAMES E. DIXON)

PARCEL No. 62205 (JAMES E. DIXON)  
 80775 (JAMES E. DIXON)

ZONING: RA-40

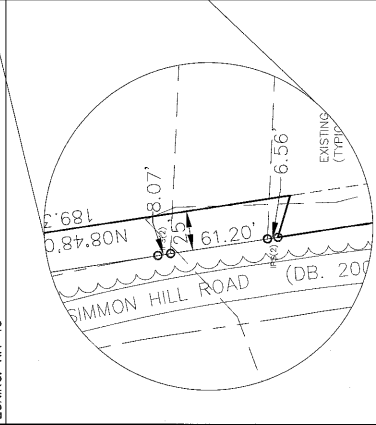

**GENERAL NOTES:**

1. TOPOGRAPHIC INFORMATION OBTAINED FROM CHATHAM COUNTY GIS.
2. PUBLIC WATER IS AVAILABLE WITHIN WATERS CHAPEL ROAD AND THE WATER DISTRIBUTION SYSTEM HAS BEEN APPROVED BY CHATHAM COUNTY.

**LEGEND**

SOIL SUITABLE TO SUPPORT CONVENTIONAL SEPTIC SYSTEMS AS DETERMINED BY G&REC WITHIN THEIR REPORT DATED DECEMBER 1A, 2004

LINE	LENGTH	BEARING
L1	78.80'	S56°34'11"W
L2	103.90'	S14°22'11"W
L3	185.60'	S13°40'45"E
L4	15.67'	S88°43'19"E
L5	109.99'	N51°22'24"E

**OTHER INFORMATION**

DATE: 12/15/04  
 DRAWN BY: J.E. DIXON  
 CHECKED BY: J.E. DIXON  
 APPROVED BY: J.E. DIXON

**FIELDSTONE SUBDIVISION**

**SKETCH PLAT**

**SD 1**

SCALE: 1" = 100'

DATE: 12 JAN 05  
 DRAWN BY: J.E. DIXON  
 CHECKED BY: J.E. DIXON  
 APPROVED BY: J.E. DIXON

FOR RECORDATION  
 TO CHATHAM COUNTY  
 18 SEP 05  
 19 OCT 05  
 20 NOV 05  
 21 DEC 05

**BALLENTE ASSOCIATES, P.A.**  
 101 WEST MAIN STREET, SUITE 200  
 FAYETTEVILLE, GA 30215  
 (770) 842-1111

**CHATHAM COUNTY**

REVIEW DRAWING  
 NOT ISSUED FOR CONSTRUCTION

GRAPHIC SCALE  
 1" = 100' FT  
 1" = 100' FT