

# Austinville

Buckhorn Road, Corinth  
Chatham County, North Carolina

Parcel Number 73961



Progress Energy Cutoff Enclosed Fixtures on 30' wooden poles  
Light Pattern: IESNA Type III (Oval)  
IESNA Cutoff Classification: Full Cutoff  
All wall packs on buildings shall also be full cutoff.

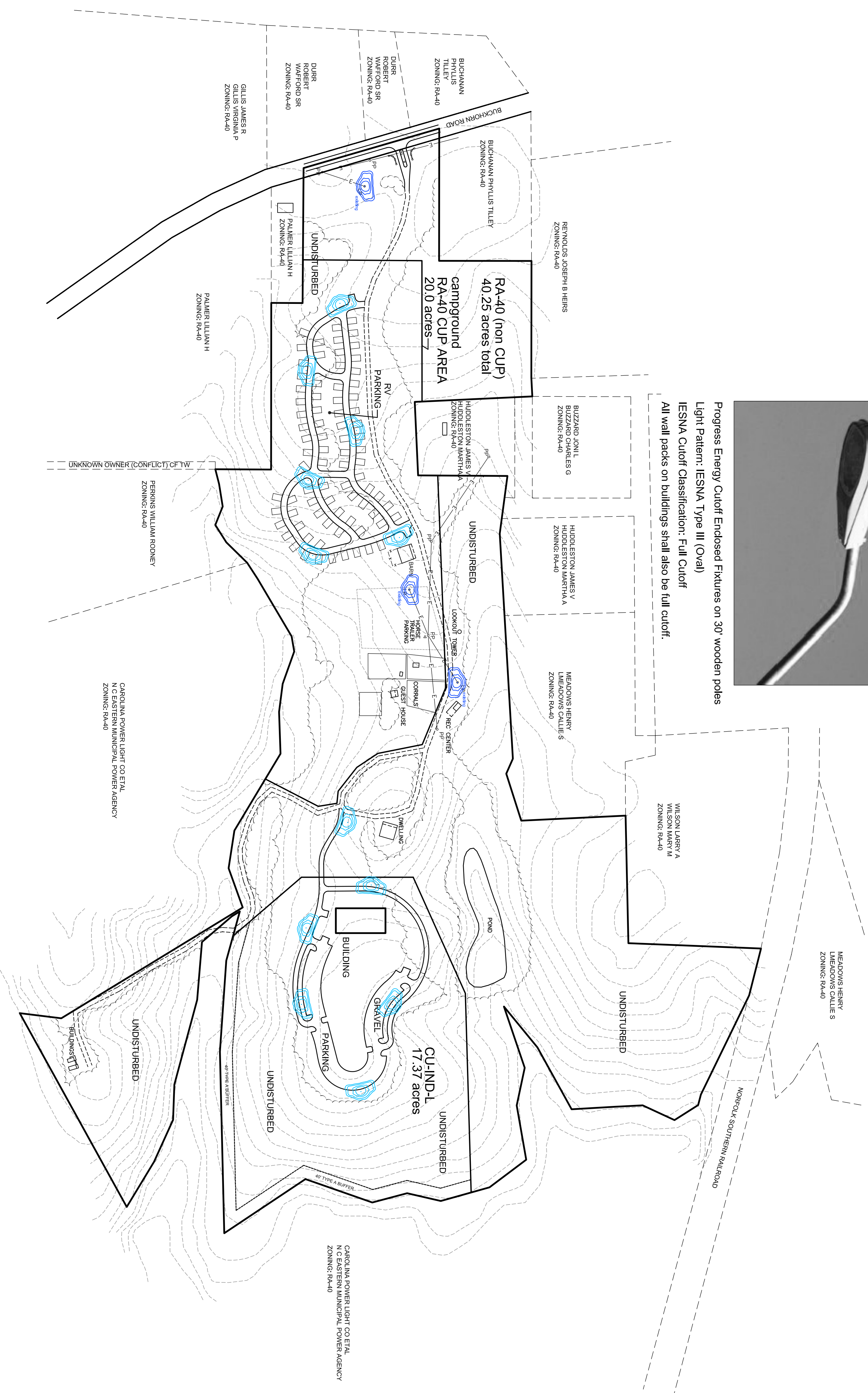

## Lighting Plan

April 20, 2007

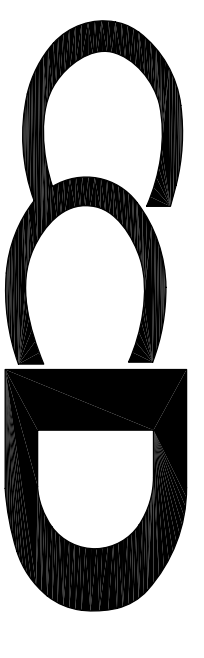
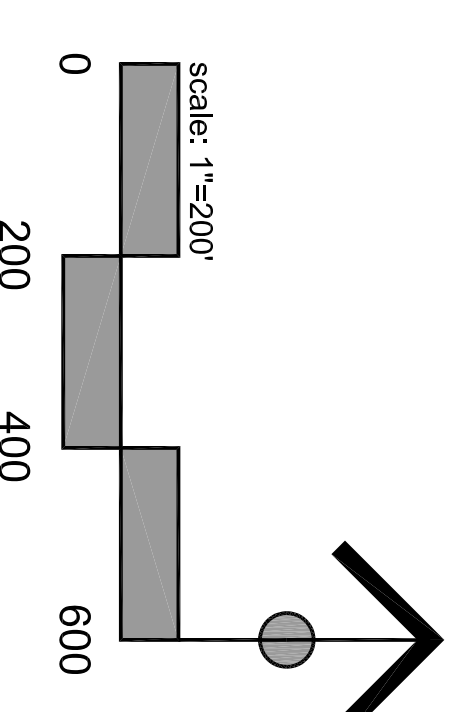

**Carter Crawford DESIGN**  
Landscape Architecture Urban Design  
400 Heritage Village Lane Apex, NC 27502  
919 387 8218 voice 919 387 8548 fax  
919 387 8218 voice 919 387 8548 fax

This document is an instrument of service. All rights to this document and to the electronic files associated with this document are reserved. Use of this document or associated electronic files for any purpose not approved by Carter Crawford Design, P.A. is prohibited.