

# Austinville

Buckhorn Road, Corinth  
Chatham County, North Carolina

Parcel Number 73961

## Description of existing buildings, etc.:

The site includes a main residential structure and several outbuildings, including a guest house, cabins, recreation building, lookout tower, barn, and stables.  
The site is served by public water and by Progress Energy electricity.

## Description of requested uses:

**CUP-RA-40:** In the designated 20 acre area, uses allowed would include all uses allowed within the RA-40 district and would also include the conditional use "Public and private recreational camps and grounds".

**CU-IND-L:** In the designated 17.37 acre area, uses allowed would include assembly halls and similar structures; blacksmith or horseshoeing shops; exhibition shows, trade shows, flea markets, banquets, conventions, religious events, arts and crafts shows, stage shows, athletic events, and other similar events; clubs and other places of entertainment operated as commercial enterprises; flea markets and rummage sales conducted either within a building or outdoors provided that no principal building or sales area shall be located in the required yard; grounds and facilities for open air games and sports; open-air sales or displays and sales or displays from temporary building or structure; communications towers.

## Phasing:

The first phase of the RV Parking facility will be comprised of approximately 20 pads. It will commence upon approval of Site Plan documents and will be completed within 24 months. The second and subsequent phases shall also be comprised of approximately 20 pads and shall be commenced upon approval of Site Plan documents for each phase. Each phase shall be completed within 24 months of commencement. Phases may be combined.

The multi-use building and associated parking in the CU-IND-L area shall be constructed when Site Plan documents have been approved and construction shall be complete within 24 months of such approval.

## SITE TABULATION

public highways serving the site:	Buckhorn Road (SR 1921)
current zoning	NC 42
watershed designation	RA-40
Major Wildlife Area	NOTE: all surrounding properties are zoned RA-40
site area	Local Watershed
current easements	77.62 acres
current use	none
other Conditional Use permits	none
percent impervious surface allowed	36% (non-C&G)
percent impervious surface existing	3.6%
percent impervious surface proposed	9.5%
Impervious surface calculations	
existing drives	1.4 acres
existing roofs	0.3 acres
gravel drives and parking (RA-40-CUP)	2.3 acres
gravel drives and parking (CU-IND-L)	1.9 acres
roofs (CU-IND-L)	0.3 acres
horse trailer parking	1.1 acres
total impervious surface	7.4 acres

Parking Calculations for CU-IND-L  
170 spaces shown  
(parking for approx. 500 people)

**STORMWATER MANAGEMENT:**  
All new construction shall comply with the County requirement of detention of the 2-year 24 hour storm event. Such compliance shall be accomplished through the use of Best Management Practices which shall be submitted with Site Plan approval documents.

**WASTEWATER MANAGEMENT:**  
Wastewater generated by the RV park is planned to be disposed of through the installation of a drip and/or spray system in the area shown on the plan to the east of the RV park.  
Wastewater generated by the multi-use building is planned to be disposed of through the use of a conventional drain field and repair area as shown on the plan to the south of the multi-use building.

**SIGNAGE:**  
All site signage shall conform to the Chatham County sign ordinance and shall be submitted for approval with the first Site Plan submittal.

The site has been the subject of a preliminary soils investigation (included in this submittal package). Final detailed design of wastewater treatment measures will be submitted with Site Plan approval documents.

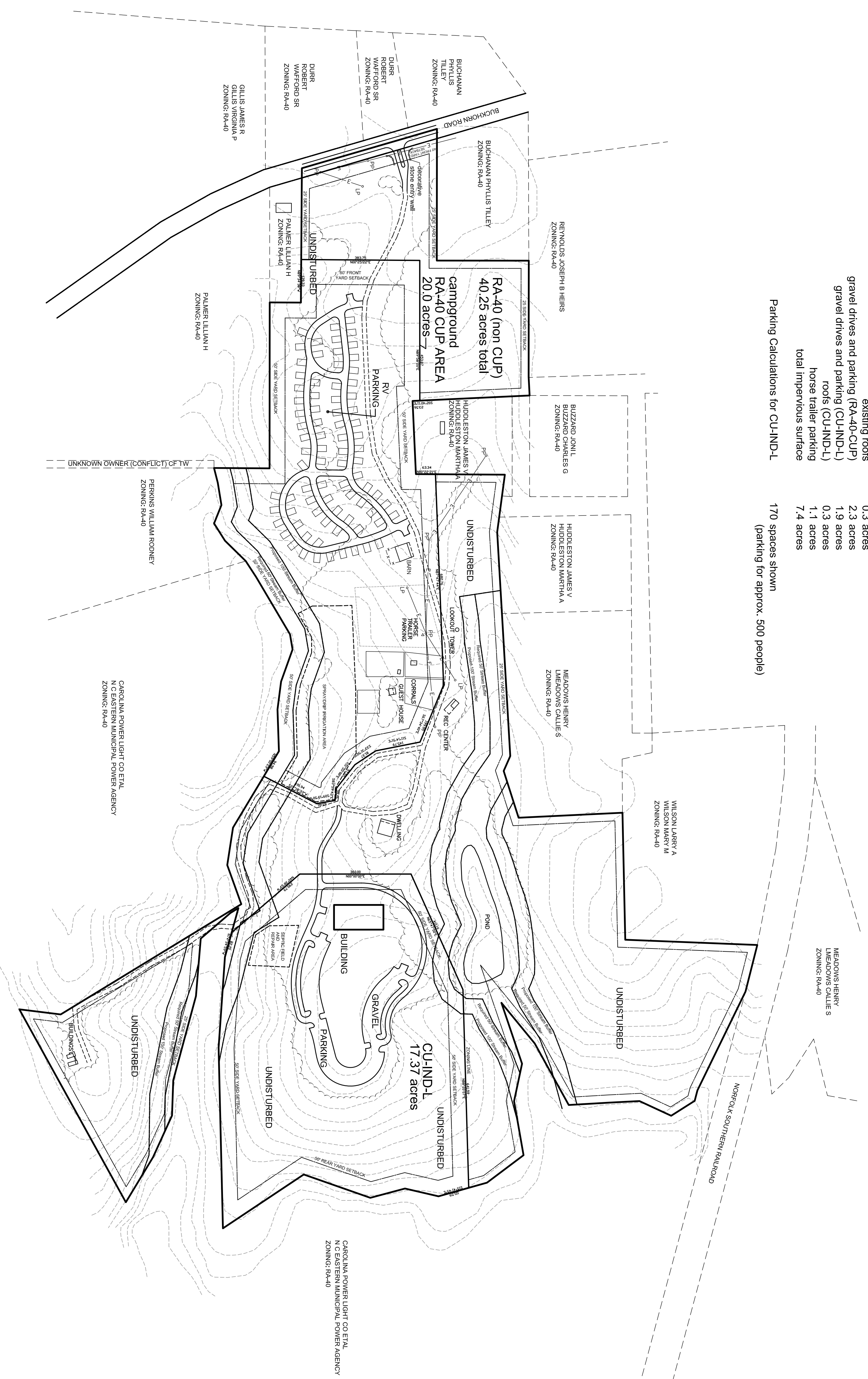

## Site Plan

April 20, 2007

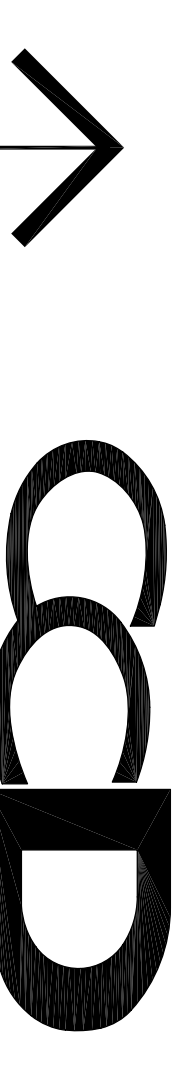

**Carter Crawford DESIGN**  
Land Planning Landscape Architecture Urban Design  
400 Heritage Village Lane Apex, NC 27502  
919 387 8218 Voice 919 387 6548 fax

