

THE PARKS
at
Meadowview

COMMUNITY TRAILS MASTER PLAN

FEBRUARY 8, 2007

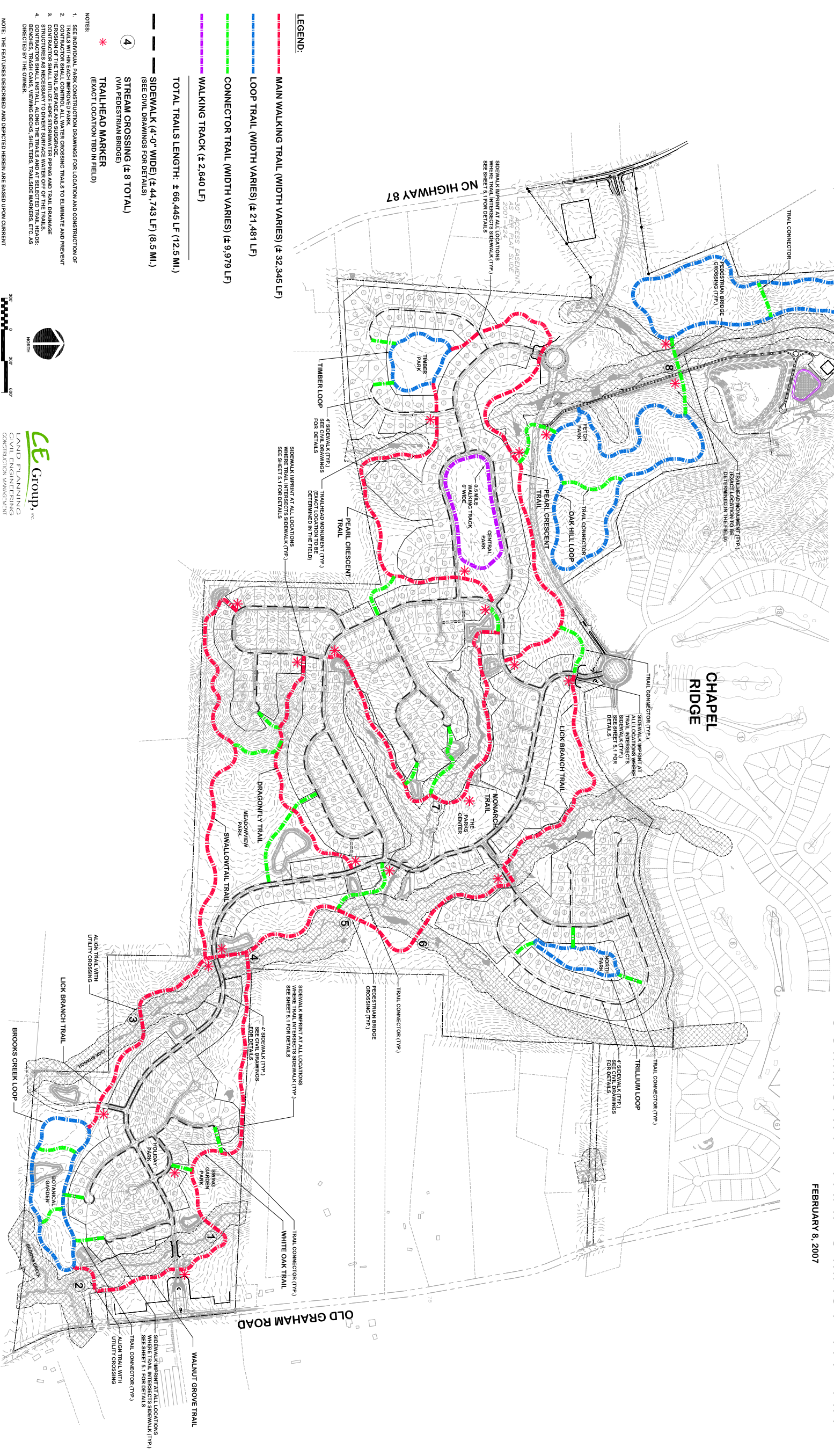

LEGEND:

- MAIN WALKING TRAIL (WIDTH VARIES) (± 32,345 LF)
- LOOP TRAIL (WIDTH VARIES) (± 21,481 LF)
- CONNECTOR TRAIL (WIDTH VARIES) (± 9,979 LF)
- WALKING TRACK (± 2,640 LF)

TOTAL TRAILS LENGTH: ± 66,445 LF (12.5 MI.)

- SIDEWALK (4'-0" WIDE) (± 44,743 LF) (8.5 MI.)
(SEE CIVIL DRAWINGS FOR DETAILS)
- ④ STREAM CROSSING (± 8 TOTAL)
(VIA PEDESTRIAN BRIDGE)
- * TRAILHEAD MARKER
(EXACT LOCATION TBD IN FIELD)

NOTES:

1. SEE INDIVIDUAL PARK CONSTRUCTION DRAWINGS FOR LOCATION AND CONSTRUCTION OF TRAILS WITHIN EACH IMPROVED PARK.
2. CONTRACTOR SHALL CONSTRUCT PEDESTRIAN CROSSING TRAILS TO ELIMINATE AND PREVENT EXCESSIVE TRAIL CROSSINGS AT PEDESTRIAN BRIDGES.
3. CONTRACTOR SHALL UTILIZE HIDE STORMWATER PIPING AND TRAIL DRAINAGE STRUCTURES AS NECESSARY TO DIVERT SURFACE WATER OFF OF THE TRAILS.
4. BENCHES, TRASH CANS, VIEWING DECKS, SHELTERS, TRAILSIDE MARKERS, ETC. AS DIRECTED BY THE OWNER.

NOTE: THE FEATURES DESCRIBED AND DEPICTED HEREIN ARE BASED UPON CURRENT DEVELOPMENT PLANS. ACTUAL DEVELOPMENT MAY BE SUBJECT TO CHANGE.

