

# PRELIMINARY SOIL/SITE EVALUATION

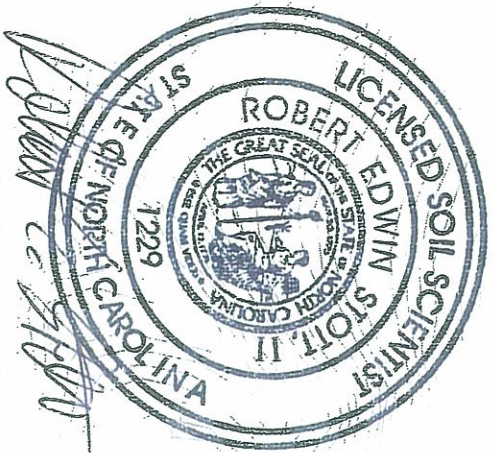

*Robert Edwin Stott, II*

- \*\*\*\* NOT A SURVEY
- \*\*\*\* LINES NOT LOCATED
- \*\*\*\* BASE MAP FROM CHATHAM COUNTY GIS
- \*\*\*\* ACTUAL ALIGNMENT IN FIELD MAY VARY SLIGHTLY FROM MAP REPRESENTATION

\*\*SUITABLE FOR PRELIMINARY PLANNED PURPOSES ONLY. ALL LINES WILL REQUIRE FIELD VERIFICATION. FIELD VERIFICATION OF LPP OR LFP LINES SHOULD BE USED AS A CHECK. CHECK SOME ADJUSTMENTS WILL BE NECESSARY IN THE FIELD DUE TO SOIL VARIABILITY AND TOPOGRAPHIC IRREGULARITIES. THIS MAP ONLY REFLECTS EXISTING SOIL SURVEYS FOR ON-SITE SEPTIC TANK SYSTEMS. SOME OTHER CONSIDERATIONS THAT AFFECT SITE SUITABILITY THAT SHOULD BE CONSIDERED IN DEVELOPMENT DESIGN ARE:

- 1) 10' SETBACK FROM PROPERTY LINE
- 2) 100' SETBACK FROM AIR WELLS
- 3) 50' SETBACK FROM STREAMS, PONDS OR LAKES.

See accompanying state report.

\*\*Base Map from Chatham County Cadastral

GRAPHIC SCALE  
1" = 200'

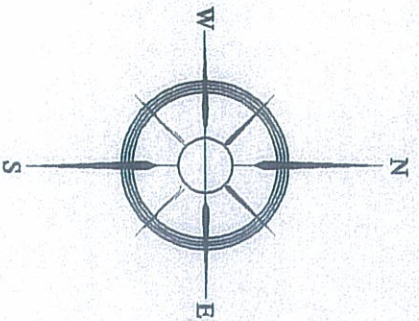

## PRELIMINARY SOIL/SITE EVALUATION

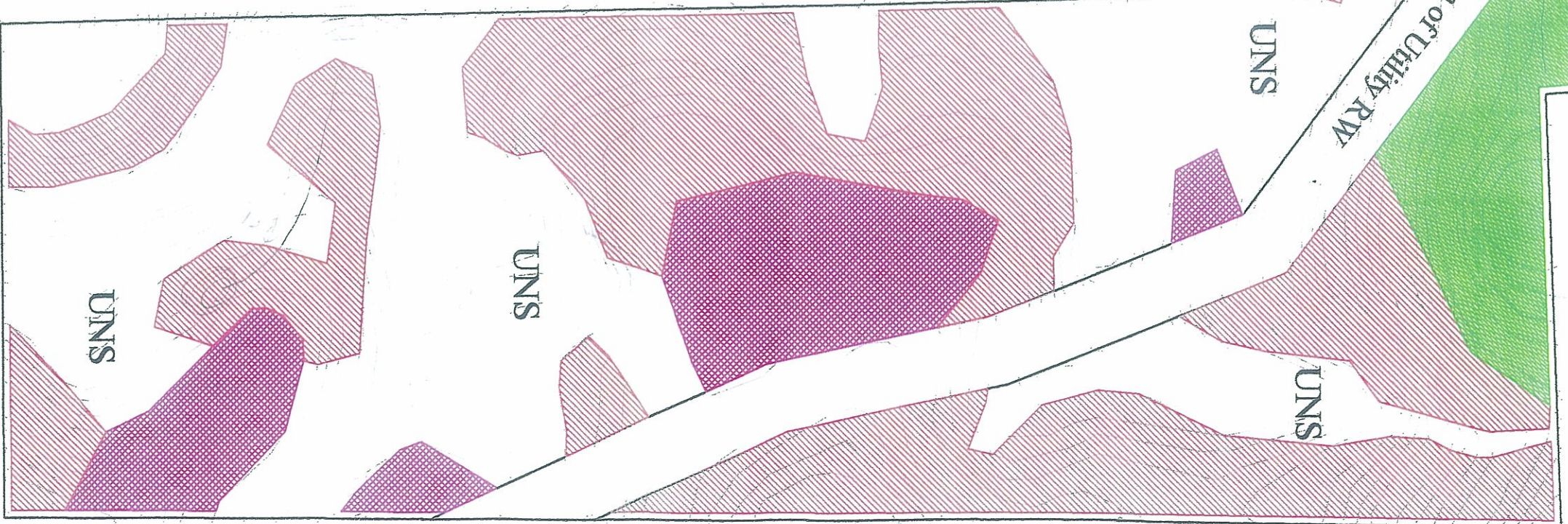

**BOULDERY SURFACE**  
Areas contain soils with 30 inches or more of usable material and have potential for conventional type septic systems. May include areas of 24 to 30 inches of soil suitable for LPP or ultra-shallow conventional.

**BOULDERY SURFACE**  
Areas contain soils with 24 inches or more of marginal material and have potential for modified conventional or LPP type septic systems. **MARGINAL SOILS.**

**EXTREMELY BOULDERY - NOT EVALUATED**  
Not evaluated due to an extremely bouldery surface.

**UNUSUITABLE**

**NOTE:** This site contains highly variable soils, marginal soils, and a bouldery to extremely bouldery surface. Evaluation with a backhoe is necessary to accurately determine suitability. Bouldery surfaces may also have implications regarding septic system installation costs. See S&E/C Report.

### LEGEND

SHEET TITLE <b>Preliminary Soil/Site Evaluation</b> SHEET 1 of 1		PROJECT NAME: Edward Shankman Chatham County, NC May 2006		Soil and Environmental Consultants, PA 3817 E. Laramie Drive, Greensboro, North Carolina 27455 Phone (336) 540-8234 Fax (336) 540-8235 Web Page www.SandEC.com		REVISIONS:		JOB NO. 4-1633.S1	
FIELD WORK JT, JS		DRAWN BS		PROJECT MGR. BS		FILE prelimsoilmapp.dwg		SCALE 1" = 200'	
4-1633.S1		BS		BS		BS		BS	

# PRELIMINARY WETLANDS APPROXIMATION

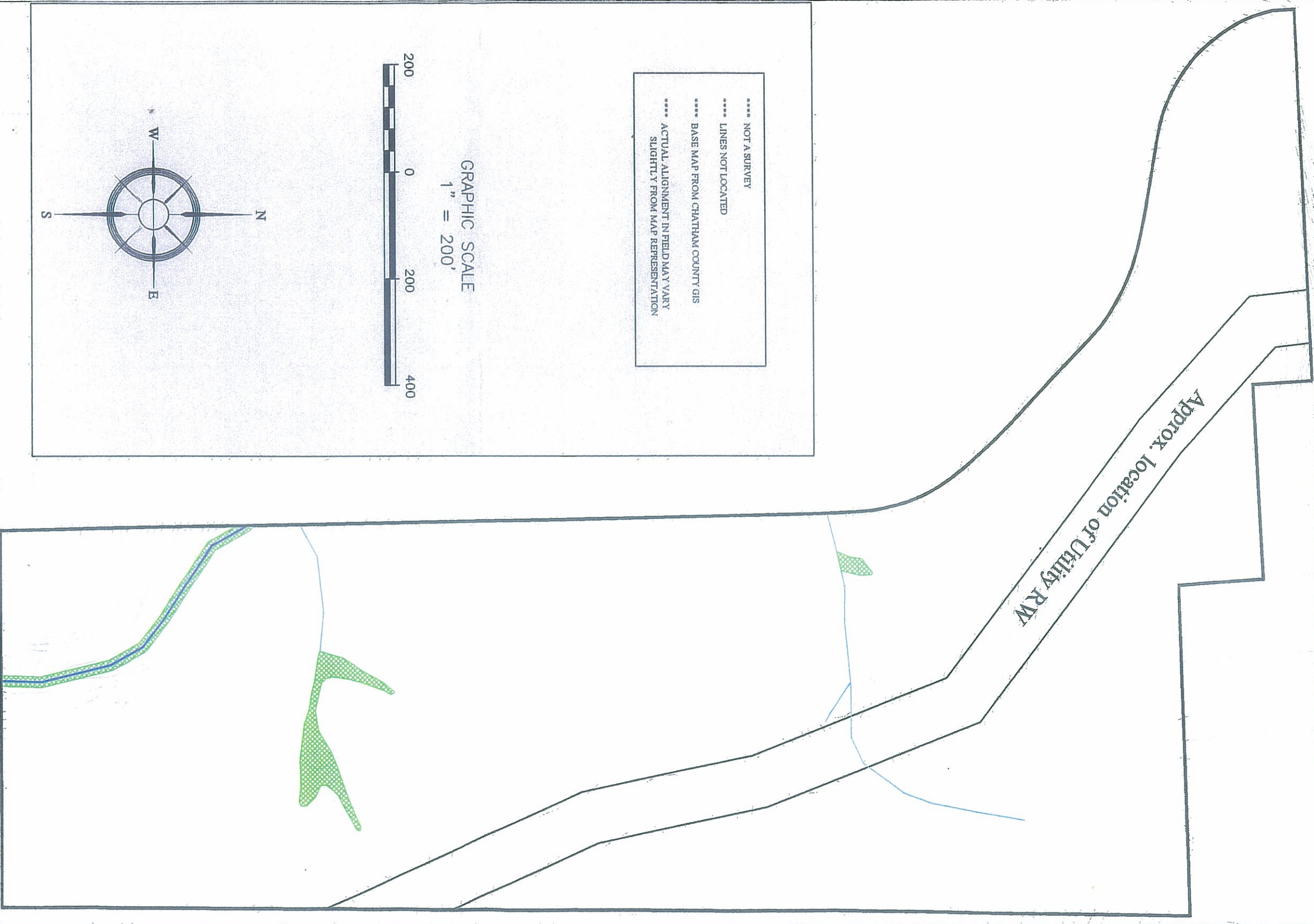

# PRELIMINARY WETLANDS APPROXIMATION

## LEGEND

<p><b>PRELIMINARY WETLANDS APPROXIMATION</b>                  Lines indicate approximate location of PERENNIAL STREAMS.</p> <p><b>PRELIMINARY WETLANDS APPROXIMATION</b>                  Areas indicate approximate size, location, and extent of jurisdictional wetlands.</p>	<p><b>PRELIMINARY WETLANDS APPROXIMATION</b>                  Lines indicate approximate location of INTERMITTENT STREAMS.</p> <p>See S&amp;EC Report.</p>
---	--

<p><b>SHEET TITLE</b>                  Preliminary Wetlands Approximation                  SHEET 1 of 1</p>	<p><b>PROJECT NAME:</b>                  45ac Andrews Shore Rd                  Edward Sheinkman                  Chatham County, NC                  May 2006</p>	<p><b>S&amp;EC</b>                  Soil and Environmental Consultants, PA                  3917-B Lamada Drive, Greensboro, North Carolina 27455                  Phone (336) 540-9234 Fax (336) 540-9235                  Web Page www.SandEC.com</p>	<p><b>REVISIONS:</b></p> <table border="1"> <tr> <td>4-1633.91</td> <td>PROJECT MGR.</td> <td>ES</td> </tr> <tr> <td></td> <td>DRAWN</td> <td>JT</td> </tr> <tr> <td></td> <td>FIELD WORK</td> <td>JT, ES</td> </tr> <tr> <td></td> <td>SCALE</td> <td>1" = 200'</td> </tr> <tr> <td></td> <td>FILE</td> <td>prelimwetmap.dwg</td> </tr> <tr> <td></td> <td></td> <td>1633</td> </tr> </table>	4-1633.91	PROJECT MGR.	ES		DRAWN	JT		FIELD WORK	JT, ES		SCALE	1" = 200'		FILE	prelimwetmap.dwg			1633
4-1633.91	PROJECT MGR.	ES																			
	DRAWN	JT																			
	FIELD WORK	JT, ES																			
	SCALE	1" = 200'																			
	FILE	prelimwetmap.dwg																			
		1633																			