

VICINITY MAP

I, STATE C. SMITH, do hereby certify that this plat was drawn under my supervision from an actual survey made under my supervision using references shown hereon, that the boundaries not surveyed are shown as broken lines plotted as calculated by altitudes and departures is 1:10,000, and that this plat was prepared in accordance with G.S. 47-20 or amended. Witness my original signature and seal this 14th day of September, 2007.

Professional Land Surveyor
L-3768
License Number

This survey shown hereon creates a subdivision of land within the area of a county or municipality that has an ordinance that regulates parcels of land.

N.C. GRID NORTH - NAD83/86

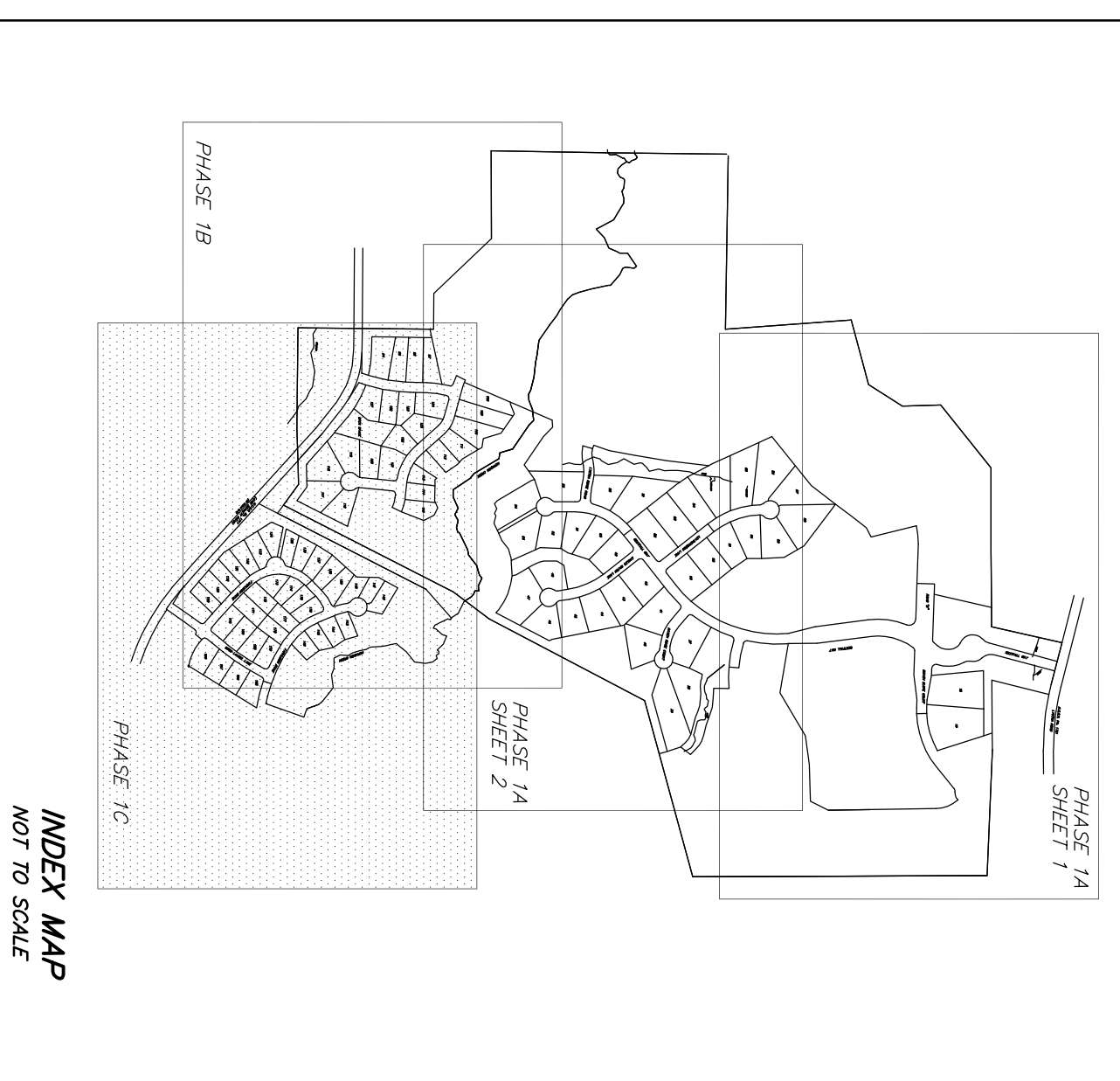

INDEX MAP NOT TO SCALE

All lots shown hereon will be conveyed subject to restrictions, conditions, covenants and easements as shown hereon and as recorded in the public records of the State of North Carolina. The private roads shown hereon are to be jointly constructed and maintained by the developer, its successors and assigns, until such time as the same are turned over to a properly constituted property owners association.

All open space and water hazard/negative stream buffers and voluntary buffers are to be maintained by the developer, its successors and assigns, until such time as the same are conveyed or turned over to a properly constituted property owners association.

There is a 10 foot multi-purpose utility easement along all lot fronts, unless otherwise noted.

THIS SURVEY WAS BALANCED USING THE COMPASS RULE ADJUSTMENT.

ALL DISTANCES ARE HORIZONTAL GROUND MEASUREMENTS.

AREA DETERMINED USING D.M.D. METHOD.

REFERENCES: DEED BOOK 1235, PAGE 770
DEED BOOK 1235, PAGE 775
PLAT SLIDE 2002-387

IRON PIPES SET AT ALL LOT CORNERS, UNLESS OTHERWISE NOTED.

NOTES:
(a) THE PROPERTY SHOWN HEREON IS SUBJECT TO THE EASEMENTS OF RECORD BY THIS FIRM DURING THE COURSE OF THIS SURVEY DOES NOT CARRY TO THE EXISTENCE OR NON-EXISTENCE OF ANY RECORDING PRESENT ON THIS SITE OR MAY NOT BE PRESENT ON THIS SITE.

LEGEND:
Existing Iron Pipe
Existing Concrete Monument
Concrete Monument Set
600' Not Found
Existing Railroad Spike
Metamorphic Point (Not Set)
Utility Pole
Street Address (Typical)
Right of Way

RECORDED IN PLAT SLIDE _____

Certificate of Approval for Recording
I hereby certify that the subdivision plat shown hereon has been found to comply with the regulations of Chatham County with the Board of County Commissioners and that it has been approved by the Board for recording in the Office of the County Register of Deeds.

Chairman, Board of County Commissioners
_____, 20____

State of North Carolina
County of Chatham

Review Officer: _____ Title: _____
Date: _____

Certificate of Ownership and Dedication
The undersigned hereby certify that on (one or two) the (date) of (month) (year) I (we) hereby adopt this plat with my (our) free consent, and dedicate all streets, roads, and other open spaces to public or private use as noted.

Owner: _____ Date: _____

MACKIE W. LAMBERT
D.B. 1028, P.C. 494
PLAT SLIDE 2002-387

OVER JORDAN, LLC
PART OF MAPAR # 18931
FOR FUTURE DEVELOPMENT

SITE DATA

TOTAL LOTS	35
MINIMUM LOT SIZE	0.30 ACRE
MAXIMUM LOT SIZE	0.51 ACRE
AVERAGE LOT SIZE	0.40 ACRE

PAID LOTS MINIMUM BUILDING SETBACKS

FRONT YARD	15 FEET
SIDE YARD	5 FEET
REAR YARD	10 FEET

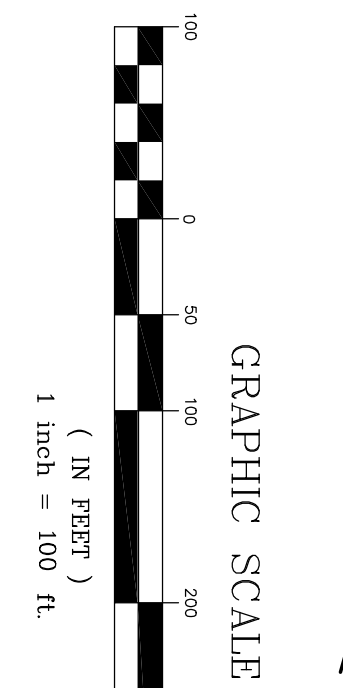

C:\pawp\Drawings\ang

BOARD OF EDUCATION OF CHATHAM COUNTY
D.B. 885, P.C. 624
PLAT SLIDE 2007-295

LINE TABLE

LINE	BEARING	LENGTH
177	N 7417'28" W	54.37
178	N 72'48'55" W	53.53
179	N 70'52'52" W	53.53
180	N 69'52'52" W	56.19
181	N 68'25'37" W	54.84
182	N 67'43'12" W	54.43
183	N 67'12'56" W	53.51
184	N 66'15'38" W	50.48
185	N 65'51'46" W	56.96
186	N 65'31'48" W	52.55
187	N 65'11'48" W	51.50
188	N 64'17'40" W	66.38
189	N 47'57'40" W	103.39
190	N 47'57'40" W	201.68
191	N 51'30'29" W	51.72
192	N 57'48'28" W	51.72
193	N 57'48'28" W	26.68
194	N 69'38'27" W	26.68

CURVE DATA TABLE

CURVE	LENGTH	RADIUS	BEARING	CHORD
C82	58.00'	23.00'	N 50'56'52" W	28.63'
C83	58.00'	23.00'	N 50'56'52" W	28.63'
C84	34.81'	55.00'	S 08'09'00" E	34.25'
C85	20.39'	55.00'	S 20'36'47" W	20.28'
C86	42.97'	55.00'	S 53'36'55" W	41.88'
C87	28.08'	25.00'	N 43'46'08" E	26.63'
C88	16.76'	25.00'	S 13'21'17" E	16.76'
C89	217.88'	225.00'	S 08'27'55" E	208.47'
C90	1.86'	225.00'	S 32'23'42" W	1.86'
C91	110.90'	225.00'	S 32'23'42" W	108.78'
C92	79.31'	225.00'	S 32'23'42" W	78.02'
C93	110.90'	225.00'	S 56'14'34" W	108.78'
C94	93.35'	225.00'	S 55'52'55" W	92.91'
C95	16.91'	20.00'	N 42'10'42" E	16.14'
C96	16.91'	20.00'	N 42'10'42" E	16.14'
C97	74.29'	325.00'	S 14'11'32" E	74.13'
C98	20.12'	25.00'	S 30'42'03" W	19.89'
C99	53.56'	55.00'	S 29'51'48" W	51.46'
C100	66.06'	55.00'	S 36'26'54" W	62.16'
C101	40.65'	55.00'	N 09'12'22" W	39.73'
C102	110.88'	55.00'	N 09'12'22" W	92.88'
C103	51.72'	25.00'	S 10'46'09" E	51.72'
C104	61.56'	225.00'	S 16'02'56" E	61.43'
C105	32.22'	20.00'	N 68'36'47" W	28.85'
C106	8.84'	375.00'	S 23'08'15" E	8.84'
C107	91.65'	375.00'	S 23'08'15" E	91.42'
C108	108.08'	425.00'	S 29'44'46" E	101.77'
C109	108.08'	425.00'	S 29'44'46" E	101.77'
C110	82.14'	425.00'	S 42'30'11" E	85.89'
C111	57.64'	425.00'	S 52'31'41" E	57.60'
C112	10.78'	375.00'	S 55'55'24" E	10.78'
C113	19.53'	1024.97'	S 58'57'34" E	19.53'
C114	246.60'	975.00'	S 61'42'41" E	246.94'
C115	150.48'	1024.97'	S 61'42'41" E	150.50'
C116	53.49'	20.00'	S 69'22'26" W	53.89'
C117	21.45'	20.00'	S 75'30'46" E	164.70'
C118	164.88'	1025.00'	S 75'30'46" E	164.70'
C119	88.02'	975.00'	N 32'50'25" E	102.78'
C120	88.02'	1025.00'	N 32'50'25" E	87.99'
C121	61.28'	975.00'	N 37'38'44" E	61.27'
C122	84.50'	1025.00'	N 37'38'44" E	84.47'
C123	42.35'	2025.00'	S 38'38'55" W	42.35'
C124	42.35'	2025.00'	S 38'38'55" W	42.35'
C125	31.23'	20.00'	S 38'58'21" W	48.35'
C126	151.23'	300.00'	S 62'25'38" E	148.63'
C127	151.23'	300.00'	S 62'25'38" E	148.63'
C128	174.79'	2043.50'	S 77'42'01" E	228.23'
C129	147.67'	1048.92'	S 77'42'01" E	174.74'
C130	147.67'	1048.92'	S 67'55'46" E	149.55'
C131	122.46'	289.90'	S 48'38'45" E	122.45'
C132	122.46'	289.90'	S 48'38'45" E	122.45'
C133	204.02'	1455.66'	N 68'52'25" W	203.85'

UNITED STATES OF AMERICA
PARCEL # 104-2
D.B. 536, P.C. 533

NANCY W. BRITT
D.B. 803, P.C. 812
PLAT SLIDE 2006-03

FINAL PLAT OF
WESTFALL - PHASE 1C
WILLIAMS TOWNSHIP, CHATHAM COUNTY, NORTH CAROLINA

DATE: SEPTEMBER 28, 2007
SCALE: 1" = 100'
DRAWN BY: JLB
PROJECT NO. P9-464

PRELIMINARY ONLY
Not For Sales Or Conveyance