

VICINITY MAP

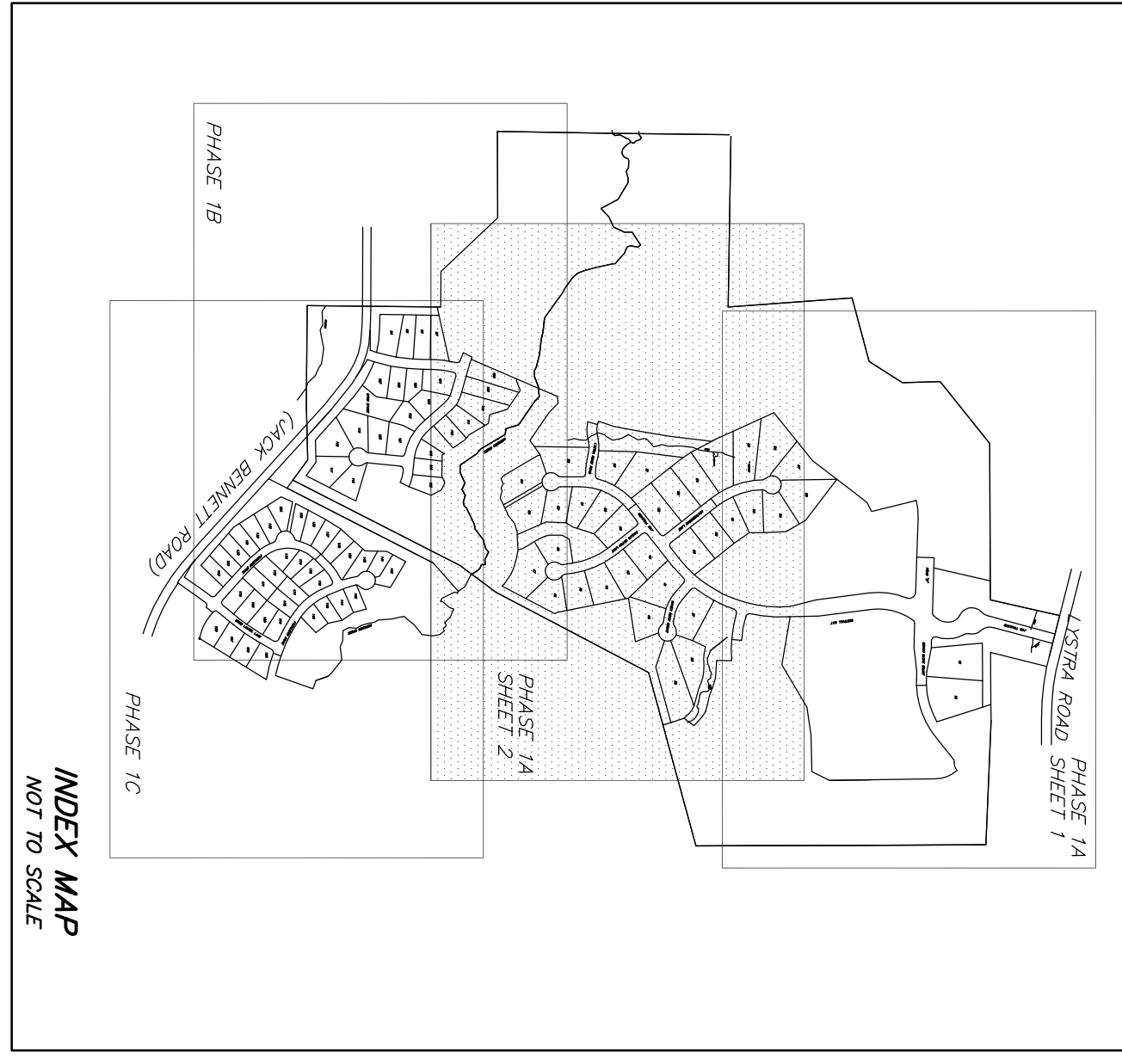

INDEX MAP
NOT TO SCALE

CURVE	LENGTH	RADIUS	BEARING	CHORD
C107	123.61'	975.00'	S 74.31°12' E	123.57'
C108	83.85'	84.00'	S 131°40' E	80.41'
C109	75.14'	50.00'	N 151°52' W	72.41'
C110	35.29'	80.00'	S 08°31'23" E	34.56'
C111	46.86'	84.00'	S 101°25'4" E	46.25'
C112	180.16'	80.00'	S 101°25'4" E	154.72'
C113	153.83'	50.00'	N 49°42'28" W	150.83'
C114	153.83'	50.00'	S 34°41'11" E	140.17'
C115	46.65'	25.00'	N 03°37'45" E	45.77'
C116	123.46'	100.00'	N 69°25'45" E	115.77'
C117	18.45'	20.00'	N 69°25'45" E	17.81'
C118	34.52'	420.00'	N 89°59'42" E	34.02'
C119	34.52'	420.00'	N 89°59'42" E	34.02'
C120	232.70'	420.00'	N 73°58'43" E	230.33'
C121	232.70'	420.00'	N 73°58'43" E	230.33'
C122	20.21'	25.00'	S 74°23'21" W	19.76'
C123	42.89'	55.00'	N 70°07'31" E	50.87'
C124	143.66'	200.00'	N 21°25'51" W	140.60'
C125	235.72'	830.00'	N 04°10'38" E	234.93'
C126	30.24'	20.00'	S 31°00'03" E	27.44'
C127	143.29'	280.00'	S 80°03'58" E	143.06'
C128	143.29'	280.00'	S 80°03'58" E	143.06'
C129	37.02'	200.00'	S 84°48'48" W	36.97'
C130	80.89'	180.00'	S 87°37'00" E	80.20'
C131	20.47'	120.00'	S 69°51'28" E	20.44'
C132	110.17'	397.50'	S 83°55'16" W	109.82'
C133	19.12'	20.00'	S 64°28'41" W	18.40'
C134	77.04'	40.00'	N 32°57'54" W	65.61'
C135	77.04'	40.00'	N 32°57'54" W	65.61'
C136	155.27'	780.00'	S 62°22'17" W	154.89'
C137	30.24'	20.00'	S 62°22'17" W	27.44'
C138	628.39'	770.00'	N 18°20'42" E	611.10'
C139	133.15'	830.00'	N 23°59'12" E	133.01'
C140	133.15'	830.00'	N 23°59'12" E	133.01'
C141	132.96'	830.00'	N 23°59'12" E	132.81'
C142	20.21'	25.00'	S 69°25'45" E	19.76'
C143	20.21'	25.00'	S 69°25'45" E	19.76'
C144	56.67'	55.00'	S 79°16'06" W	54.20'
C145	49.34'	55.00'	N 45°30'06" W	47.70'
C146	36.79'	55.00'	N 00°28'29" W	36.11'
C147	63.39'	55.00'	N 51°32'01" E	59.93'
C148	56.01'	55.00'	S 66°16'42" E	53.62'
C149	52.82'	280.00'	N 62°31'01" E	51.76'
C150	110.49'	280.00'	S 60°50'17" E	109.77'
C151	30.24'	20.00'	S 60°50'17" E	27.44'
C152	30.24'	20.00'	S 60°50'17" E	27.44'
C153	108.57'	770.00'	N 46°41'44" E	108.50'
C154	108.57'	770.00'	N 46°41'44" E	108.50'
C155	31.42'	20.00'	N 47°55'09" E	31.33'45"
C156	31.42'	20.00'	N 47°55'09" E	31.33'45"
C157	31.42'	20.00'	N 47°55'09" E	31.33'45"
C158	60.82'	530.00'	S 35°02'28" E	60.88'
C159	96.70'	530.00'	S 28°51'17" E	96.56'
C160	185.15'	470.00'	S 131°7'03" E	183.99'
C161	131.85'	530.00'	S 04°15'41" E	131.51'
C162	51.42'	530.00'	S 04°15'41" E	51.40'
C163	18.39'	25.00'	N 23°41'01" W	18.91'
C164	18.39'	25.00'	N 23°41'01" W	18.91'
C165	32.24'	55.00'	S 28°59'47" E	32.04'
C166	75.14'	55.00'	S 27°05'56" W	69.43'
C167	67.65'	55.00'	N 78°32'10" W	63.46'
C168	88.81'	55.00'	N 01°54'48" E	78.07'
C169	31.42'	20.00'	S 08°40'00" W	28.28'
C170	80.87'	530.00'	N 33°58'23" W	80.59'
C171	60.28'	530.00'	N 12°08'45" W	60.25'
C172	23.23'	25.00'	S 34°49'09" E	22.41'
C173	94.39'	55.00'	N 03°19'00" W	83.23'
C174	87.34'	55.00'	S 88°19'27" E	78.45'
C175	77.64'	25.00'	S 02°43'33" E	71.35'
C176	20.32'	25.00'	N 14°25'46" E	19.76'
C177	10.59'	470.00'	N 33°10'17" W	10.5891'
C178	10.59'	470.00'	N 33°10'17" W	10.5891'
C179	31.42'	20.00'	N 83°20'00" W	28.28'
C180	43.61'	430.00'	S 48°45'41" W	43.59'
C181	47.39'	370.00'	S 47°59'52" W	47.35'
C182	127.12'	430.00'	S 37°23'14" W	126.66'
C183	157.80'	370.00'	S 32°08'09" W	156.61'
C184	129.47'	370.00'	S 20°58'53" W	129.32'
C185	27.48'	20.00'	N 53°44'19" E	25.37'
C186	30.88'	20.00'	N 42°39'52" W	27.91'
C187	45.38'	260.00'	S 81°54'11" E	45.32'
C188	34.91'	200.00'	S 81°54'11" E	34.86'
C189	34.91'	200.00'	S 81°54'11" E	34.86'
C190	38.60'	260.00'	N 81°09'24" W	38.57'
C191	38.60'	260.00'	N 81°09'24" W	38.57'
C192	65.31'	200.00'	N 83°23'01" W	63.22'
C193	65.31'	200.00'	N 83°23'01" W	63.22'
C194	53.89'	120.00'	S 87°37'00" E	53.47'
C195	11.12'	430.00'	S 03°50'00" W	11.12'
C196	20.21'	25.00'	S 23°11'29" E	19.76'
C197	68.35'	55.00'	N 10°52'02" W	64.05'
C198	38.54'	55.00'	N 44°48'48" E	37.75'
C199	20.21'	25.00'	N 73°48'08" E	20.03'
C200	20.21'	25.00'	N 73°48'08" E	20.03'
C201	21.03'	55.00'	S 08°17'21" W	19.76'
C202	20.21'	25.00'	N 23°22'34" E	19.76'
C203	30.24'	20.00'	S 05°31'27" E	27.44'

OVER JORDAN, LLC
PART OF APPAR # 20092
D.B. 1235, PG. 775

All lots shown hereon will be conveyed subject to restrictions, conditions, covenants and provisions for setbacks, use, maintenance, easements, assessments, and other matters contained in a recorded declaration of covenants.

The private roads shown hereon are to be initially constructed and maintained by the developer, its successors and assigns, until such time as the same are turned over to a properly constituted property owners association.

All open space and water hazard/negative stream buffers and voluntary buffers on the same are conveyed or turned over to a properly constituted property owners association.

There is a 10 foot multi-purpose utility easement along all lot fronts, unless otherwise noted.

THIS SURVEY WAS BALANCED USING THE COMPASS RULE ADJUSTMENT.
ALL DISTANCES ARE HORIZONTAL GROUND MEASUREMENTS.
AREA DETERMINED USING D.M.D. METHOD.
REFERENCES: DEED BOOK 1235, PAGE 770
DEED BOOK 1235, PAGE 775
PLAT SLOPE 2002-397

IRON PINS SET AT ALL LOT CORNERS, UNLESS OTHERWISE NOTED.

NOTES:
(a) THE PROPERTY SHOWN HEREON IS SUBJECT TO ALL EASEMENTS OF RECORD AFFECTING SAME.
(b) NO TITLE SEARCH HAS BEEN PERFORMED BY THIS SURVEYOR.
(c) THIS SURVEY DOES NOT CERTIFY TO ANY UNDERGROUND UTILITIES THAT MAY OR MAY NOT BE PRESENT ON THIS SITE.



OVER JORDAN, LLC
D.B. 1235, PG. 775
PART OF APPAR # 20092
For Future Development

2 OF 2

Sheet No.
2 OF 2

FINAL PLAT OF
WESTFALL - PHASE 1A
WILLIAMS TOWNSHIP, CHATHAM COUNTY, NORTH CAROLINA

OWNER'S ADDRESS:
OVER JORDAN, LLC
201 SHAWNOX OAKS CIRCLE
CARY, N.C. 27511

PRELIMINARY ONLY
Not For Sales Or Conveyance

DATE: SEPTEMBER 28, 2007
SCALE: 1" = 100'
DRAWN BY: J.A.B.
PROJECT NO.: P04-464

PLAT MINIMUM BUILDING SETBACKS:
FRONT YARD 40 FEET
SIDE YARD 15 FEET
REAR YARD 25 FEET

GRAPHIC SCALE
1 inch = 100 ft.

N.C. GRID NORTH - NAD83/86