



STATE OF NORTH CAROLINA  
DEPARTMENT OF TRANSPORTATION  
DIVISION OF HIGHWAYS

MICHAEL F. EASLEY,  
GOVERNOR

LYNDO TIPPETT  
SECRETARY

October 1, 2007

Chatham County

County Driveway Permit File Number 19-734

Subject: Commercial Driveway Permit Application with Entrance onto SR 1714  
(Cooper Subdivision)

Mr. Dan Sullivan  
5112 Burr Oak Circle  
Raleigh, NC 27612

Dear Mr. Sullivan:

Personnel assigned to this office have conducted a review of the permit Application and approval is granted subject to the following stipulations:

1. The entrance onto SR 1714 to be constructed in accordance with the attached detail sheet.
2. The entrance onto SR 1714 shall be paved for at least 50' along the centerline of the entrance.
3. The entrance onto SR 1714 shall require radii on each side of the driveway as shown on the attached drawing.
4. No parking or outdoor advertising (signs) shall be allowed inside the right of way of SR 1714.
5. Any areas inside the right of way disturbed during construction shall be seeded and mulched immediately upon completion of construction.
6. Upon completion of construction, final approval by the District Engineer is required prior to opening the access connection for public use (page 9 Driveway Manual).

Attached to this correspondence please find an approved copy of TEB Form 65-04 (Driveway Permit Application - N. C. Department of Transportation). Upon completion of the driveway entrance construction please notify the Chatham County Maintenance Department (Phone 919-742-3431) so a final inspection of the entrance can be made.

Yours very truly,

  
R. E. Blakley, P.E.  
District Engineer

REB/jek

Attachments

Cc: Mr. Timothy Johnson, P.E., Division Engineer  
Mr. B.F. Sloan, Chatham County Maintenance Engineer  
Ms. Lynn Richardson, Chatham County Planner  
Mr. John Harris, P.E., Consulting Engineer  
File

P.O. BOX 1164, ASHEBORO, NORTH CAROLINA 27204  
PHONE (336) 629-1423 FAX (336)629-7228

<b>LOCATION OF PROPERTY:</b> County <u>Chatham</u> Access to Route No. <u>SR1714</u>		<b>N.C. DEPARTMENT OF TRANSPORTATION</b>  <b>STREET AND DRIVEWAY ACCESS</b> <b>PERMIT APPLICATION</b>																												
Exact Distance <u>3795</u>	<input type="checkbox"/> Miles <input checked="" type="checkbox"/> Feet    N S E W <input type="checkbox"/> <input type="checkbox"/> <input checked="" type="checkbox"/> <input type="checkbox"/>																													
From the Intersection of Route No. <u>SR-1700</u> and Route No. <u>SR-1714</u> Toward <u>SR-1781</u>																														
PROPERTY WILL BE USED FOR: <input type="checkbox"/> Special Commercial <input type="checkbox"/> Regular Commercial <input checked="" type="checkbox"/> Residential /Subdivision <input type="checkbox"/> Other PROPERTY <input type="checkbox"/> is <input type="checkbox"/> is not    within ___ City Zoning Area. PROPERTY IS LOCATED IN: <input type="checkbox"/> Rural <input type="checkbox"/> Urban    Development Classification																														
<b>AGREEMENT</b>																														
I, the undersigned property owner, request access and permission to construct driveway(s) or street(s) on public right-of-way at the above location. I agree to construct and maintain driveway(s) or street entrance(s) in absolute conformance with the current "Policy on Street and Driveway Access to North Carolina Highways" as adopted by the North Carolina Department of Transportation. I agree that no signs or objects will be placed on or over the public right-of-way. I agree that the driveway(s) or street(s) will be constructed as shown on the sketch on (the reverse side) (the attached plans). I agree that that driveway(s) or street(s) as used in this agreement include any approach tapers, storage lanes or speed change lanes as deemed necessary. I agree that if any future improvements to the roadway become necessary, the portion of driveway(s) or street(s) located on public right-of-way will be considered the property of the North Carolina Department of Transportation, and I will not be entitled to reimbursement or have any claim for present expenditures for driveway or street construction. I agree that this permit becomes void if construction of driveway(s) or street(s) is not completed within the time specified by the "Policy on Street and Driveway Access to North Carolina Highways". I agree to pay an installation fee for pipe installed by the Division of Highways or pay a \$50 inspection fee for installation by others. Make checks payable to NCDOT. The inspection fee will be reimbursed if application is denied. I agree to construct and maintain the driveway(s) or street(s) in a safe manner so as not to interfere with or endanger the public travel. I agree to provide during construction proper signs, signal lights, flaggers and other warning devices for the protection of traffic in conformance with the current "Manual on Uniform Traffic Control Devices for Streets and Highways" and Amendments or Supplements thereto. Information as to the above rules and regulations may be obtained for the Division Engineer. I agree to indemnify and save harmless the North Carolina Department of Transportation from all damages and claims for damage that may arise by reason of this construction. I agree that the North Carolina Department of Transportation will assume no responsibility for any damages that may be caused to such facilities, within the highway right-of-way limits, in carrying out its construction. I agree to provide a Performance Bond in the amount specified by the Division of Highways for any construction proposed on the State Highway system.																														
<b>I AGREE TO NOTIFY THE DISTRICT ENGINEER WHEN THE PROPOSED WORK BEGINS AND WHEN IT IS COMPLETED.</b>																														
<table border="1" style="width:100%; border-collapse: collapse;"> <thead> <tr> <th>Entrance Width(s)</th> <th>Pipe Size</th> <th>Pipe Length</th> <th>Pipe installation Costs</th> <th>Inspection Satisfactory (Yes/No)</th> <th>AMOUNT RECEIVED</th> <th>INSTALLATION BY: <input type="checkbox"/> NCDOT    <input type="checkbox"/> OTHERS</th> </tr> </thead> <tbody> <tr> <td>1.</td> <td></td> <td></td> <td>\$</td> <td></td> <td><u>50.00</u></td> <td>Dollars \$</td> </tr> <tr> <td>2.</td> <td></td> <td></td> <td>\$</td> <td></td> <td></td> <td></td> </tr> <tr> <td>3.</td> <td></td> <td></td> <td>\$</td> <td></td> <td></td> <td></td> </tr> </tbody> </table>		Entrance Width(s)	Pipe Size	Pipe Length	Pipe installation Costs	Inspection Satisfactory (Yes/No)	AMOUNT RECEIVED	INSTALLATION BY: <input type="checkbox"/> NCDOT <input type="checkbox"/> OTHERS	1.			\$		<u>50.00</u>	Dollars \$	2.			\$				3.			\$				SIGNATURE <u>[Signature]</u> (TITLE) <u>TTIV</u> DATE <u>8/17/07</u> INSPECTION BY NCDOT
Entrance Width(s)	Pipe Size	Pipe Length	Pipe installation Costs	Inspection Satisfactory (Yes/No)	AMOUNT RECEIVED	INSTALLATION BY: <input type="checkbox"/> NCDOT <input type="checkbox"/> OTHERS																								
1.			\$		<u>50.00</u>	Dollars \$																								
2.			\$																											
3.			\$																											
<b>PROPERTY OWNER</b> NAME <u>Jonna Birtcher</u> SIGNATURE <u>[Signature]</u> ADDRESS <u>5112 Burr Oak Cir. Ral. NC 27612</u> Phone No. <u>264-6251</u>		<b>WITNESS</b> NAME <u>John Harris</u> SIGNATURE <u>[Signature]</u> ADDRESS <u>5112 Burr Oak Circle Raleigh NC 27612</u>																												
<b>APPLICANT</b> NAME <u>Dan Sullivan</u> SIGNATURE <u>[Signature]</u> ADDRESS <u>5112 Burr Oak Circle Ral. NC 27612</u> Phone No. <u>264-6251</u>		<b>WITNESS</b> NAME <u>John Harris</u> SIGNATURE <u>[Signature]</u> ADDRESS <u>5112 Burr Oak Circle Raleigh, NC 27612</u>																												

10-1-86 NOTE: Submit Four Copies of Application to Local District Engineer, N.C. Department of Transportation 61-03419

TEB 65-04

**APPROVALS**

APPROVAL BY: Local Governmental Authority (when required)

\_\_\_\_\_  
SIGNATURE TITLE DATE

APPLICATION RECEIVED BY DISTRICT ENGINEER

APPLICATION APPROVED BY DISTRICT ENGINEER

RE Blakely 8/17/07 RE Blakely 10-1-07  
SIGNATURE DATE SIGNATURE DATE

COMMENTS:

SHOW:

1. LOCATION OF DRIVEWAYS
2. DETAILS OF WORK, INCLUDING PIPES
3. EXISTING BUILDING, WALL, ETC. OR DRIVEWAYS
4. PROPOSED BUILDING, WALL, ETC.
5. HIGHWAY FEATURES

PROPOSED PLANS

DRAW OR SKETCH BELOW, OR ATTACH  
CONSTRUCTION PLANS FOR STREETS

INDICATE  
NORTH

[Large empty rectangular area for drawing or sketching proposed plans]

**RECEIVED**  
AUG 17 2007  
DIVISION OF DISTRICT 1  
DEPT. OF TRANSPORTATION

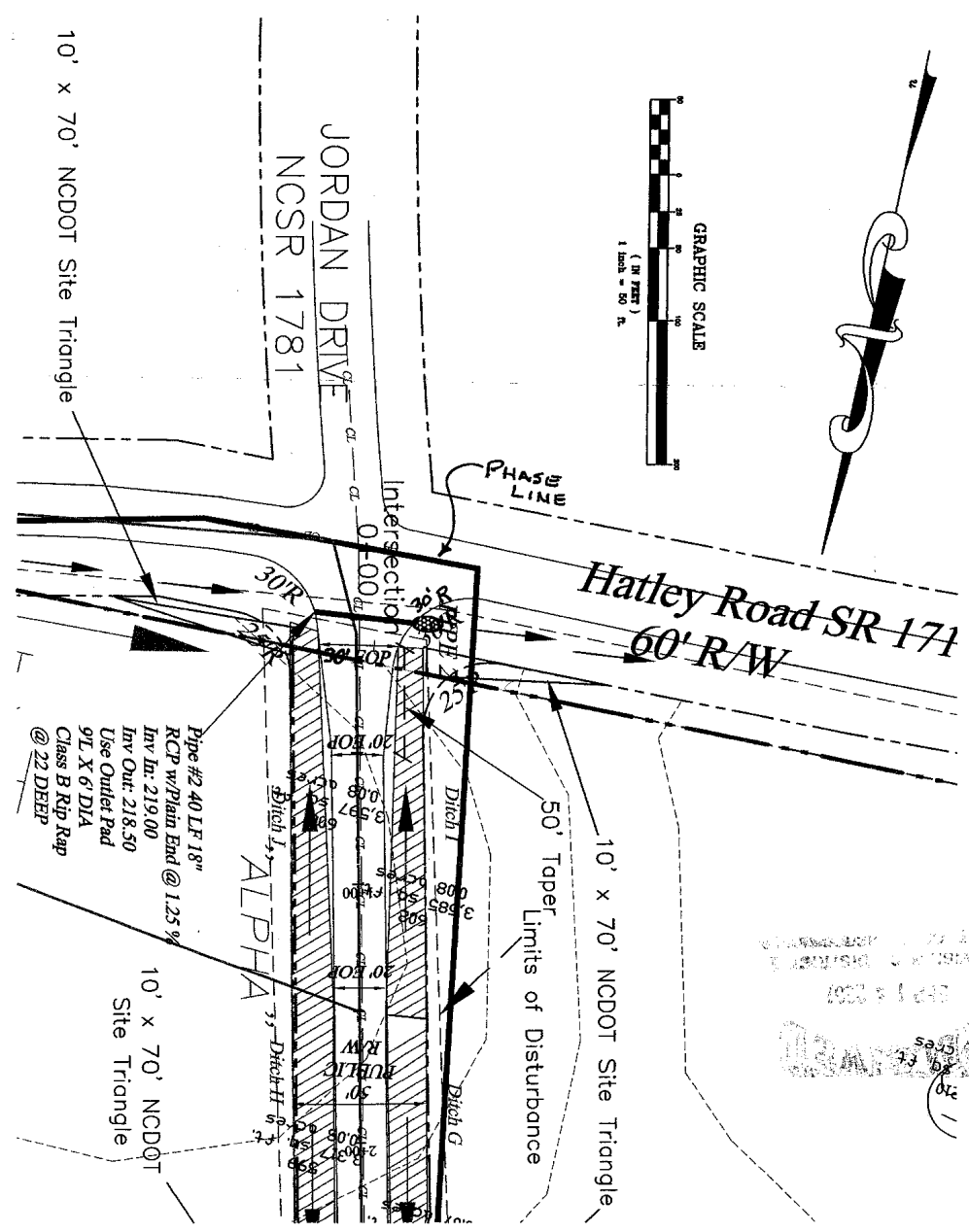
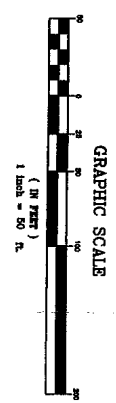

REVISIONS  
DATE: 1/20/07  
BY: [Signature]  
SCALE: AS SHOWN