

I HEREBY CERTIFY THAT THIS PLAT IS OF THE FOLLOWING TYPE:
G.S. 47-30 (f)(1)(g). THIS SURVEY CREATES SUBDIVISION OF
LAND WITHIN THE AREA OF A COUNTY OR MUNICIPALITY THAT
HAS AN ORDINANCE THAT REGULATES PARCELS OF LAND.

JOSEPH N. GRADY, JR. PLS L-4163

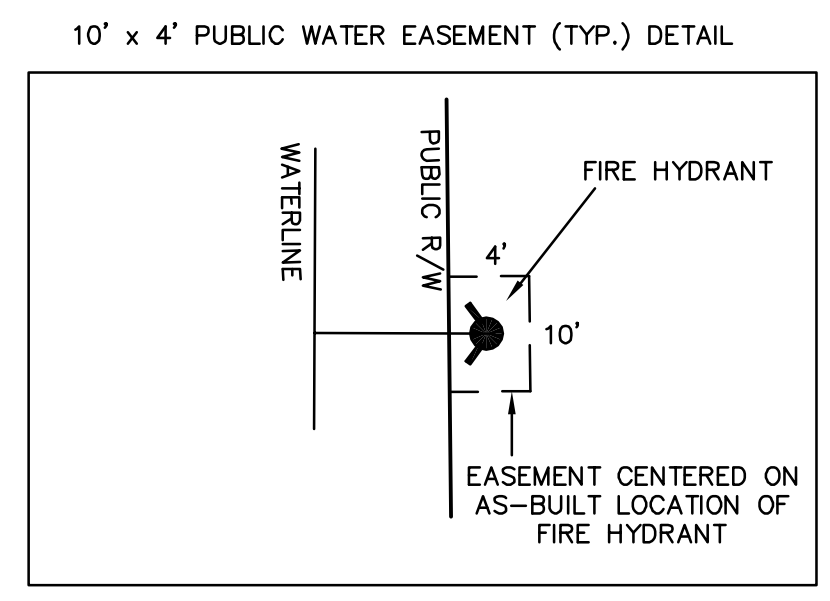
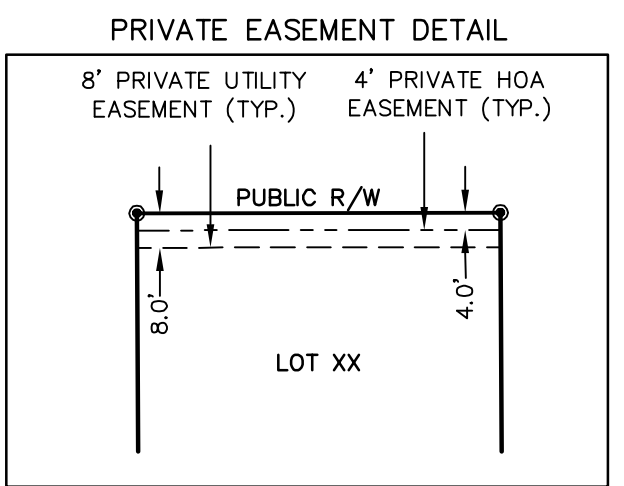

LINE	LENGTH	BEARING
E200	17.07'	N 62°25'26" W
E201	166.21'	N 79°55'23" E
E202	135.00'	S 09°30'41" E
E203	39.40'	N 33°23'13" W
E204	208.57'	S 83°47'16" E
E205	33.70'	S 52°44'30" E
E206	142.25'	S 13°57'22" E
E207	29.86'	S 10°11'04" W
E208	62.41'	N 62°46'50" E
E209	74.91'	S 84°00'21" W
E210	61.61'	N 82°24'08" W
E211	29.64'	N 03°56'15" W
E212	92.10'	N 26°55'32" W
E213	43.98'	N 05°26'19" W
E214	36.14'	N 47°55'47" E
E215	22.71'	N 84°52'51" E
E216	57.14'	N 79°03'28" E
E217	81.06'	N 73°07'55" E
E218	33.42'	S 37°18'41" E
E219	30.44'	N 14°28'40" E
E220	24.09'	N 58°06'56" E

LINE	LENGTH	BEARING
T301	40.08'	N 62°25'26" E
T302	40.00'	N 21°53'06" W
T303	66.85'	N 37°37'15" E
T304	43.75'	N 81°10'29" E
T305	95.69'	N 71°26'11" W

CURVE	RADIUS	LENGTH	BEARING	CHORD DISTANCE	DELTA	TANGENT
C1	1020.00'	37.24'	S 161°01'56" E	37.24'	2°05'31"	18.63
C2	220.00'	67.17'	S 06°23'24" E	37.24'	17°29'33"	33.85
C3	220.00'	75.98'	S 12°15'02" W	75.60'	19°47'18"	38.37
C4	15.00'	5.09'	N 12°25'55" E	5.06'	19°25'30"	2.57
C5	15.00'	8.60'	N 13°42'41" W	8.49'	32°51'44"	4.42
C6	55.00'	78.43'	S 10°42'28" W	71.95'	81°42'03"	47.56
C7	55.00'	54.28'	S 79°49'55" W	52.11'	56°32'51"	29.58
C8	55.00'	10.01'	N 10°04'37" W	10.00'	10°25'53"	5.02
C9	55.00'	90.17'	N 42°06'28" E	80.41'	93°56'15"	58.92
C10	15.00'	18.34'	S 54°02'33" W	17.22'	70°04'04"	10.52
C11	180.00'	70.47'	S 07°47'32" W	70.03'	22°25'58"	35.69
C12	180.00'	36.79'	S 09°16'49" E	36.73'	11°42'44"	18.46
C13	980.00'	33.25'	S 16°06'29" E	33.25'	1°56'38"	16.63
C14	10.00'	16.55'	S 64°28'57" E	14.72'	94°48'17"	10.88
C15	1425.00'	57.97'	S 69°16'49" W	57.96'	2°19'51"	28.99
C16	1425.00'	83.26'	S 72°07'10" W	83.25'	3°20'52"	41.64
C17	1425.00'	83.26'	S 75°28'02" W	83.25'	3°20'52"	41.64
C18	1425.00'	10.00'	S 80°29'19" W	10.00'	0°24'07"	5.00
C19	1425.00'	78.26'	S 82°15'47" W	78.25'	3°08'48"	39.14
C20	1425.00'	97.93'	S 85°48'18" W	97.91'	3°56'14"	48.98
C21	1425.00'	97.96'	S 89°44'35" W	97.94'	3°56'19"	49.00
C22	1425.00'	99.67'	S 91°17'02" W	99.65'	4°00'27"	49.86
C23	1425.00'	99.67'	S 92°16'35" W	99.65'	4°00'27"	49.86
C24	1385.00'	53.40'	N 81°22'38" E	53.40'	2°12'33"	26.70
C25	10.00'	15.20'	S 53°57'43" W	13.78'	87°06'44"	9.51
C26	12.00'	18.16'	S 32°56'39" E	16.47'	86°42'01"	11.33
C27	1111.29'	31.40'	N 83°53'11" W	31.40'	1°37'08"	15.70
C28	1110.00'	30.76'	N 85°32'47" W	30.76'	1°35'15"	15.38
C29	12.00'	17.44'	N 52°01'58" E	15.94'	83°15'14"	10.66
C30	10.00'	16.65'	N 37°17'30" W	14.79'	95°23'39"	10.99
C31	1385.00'	117.35'	N 87°24'58" W	117.32'	4°51'17"	58.71
C32	1385.00'	108.16'	S 87°55'09" W	108.14'	4°28'29"	54.11
C33	1385.00'	108.14'	S 83°26'42" W	108.11'	4°28'25"	54.10
C34	1385.00'	108.15'	S 78°58'16" W	108.12'	4°28'27"	54.10
C35	1385.00'	109.40'	S 74°28'44" W	109.37'	4°31'32"	54.73
C36	1385.00'	98.95'	S 70°09'42" W	98.93'	4°05'36"	49.50
C37	1255.00'	98.96'	S 70°00'11" W	98.94'	4°31'05"	49.51
C38	1255.00'	97.95'	S 74°29'53" W	97.93'	4°28'19"	49.00
C39	1255.00'	98.00'	S 78°58'16" W	97.98'	4°28'27"	49.03
C40	1255.00'	97.99'	S 83°26'42" W	97.97'	4°28'25"	49.02
C41	1255.00'	98.01'	S 87°55'09" W	97.99'	4°28'29"	49.03
C42	1255.00'	109.05'	N 87°28'44" W	109.02'	4°47'45"	52.56
C43	1235.00'	119.26'	N 87°54'10" W	119.22'	5°31'59"	59.68
C44	1235.00'	92.37'	S 87°11'18" W	92.35'	4°17'07"	46.21
C45	1235.00'	91.81'	S 82°54'57" W	91.79'	4°15'34"	45.93
C46	1235.00'	91.48'	S 78°39'51" W	91.46'	4°14'38"	45.76
C47	1235.00'	91.16'	S 74°25'39" W	91.14'	4°13'46"	45.60
C48	1235.00'	98.81'	S 70°01'32" W	98.59'	4°34'30"	49.33
C49	1110.00'	81.86'	S 74°25'21" W	81.84'	4°31'32"	40.95
C50	1110.00'	82.15'	S 78°39'19" W	82.13'	4°14'25"	41.09
C51	1110.00'	82.44'	S 82°54'11" W	82.43'	4°15'20"	41.24
C52	1110.00'	82.95'	S 87°10'18" W	82.93'	4°16'54"	41.49
C53	1110.00'	84.22'	N 88°30'50" W	84.20'	4°20'50"	42.13
C264	1425.00'	78.26'	S 78°42'52" W	78.25'	3°08'48"	39.14
C265	55.00'	54.33'	N 43°35'37" W	52.15'	56°36'06"	29.62

GENERAL NOTES

- SEE SHEET 1 OF 6 FOR GENERAL NOTES AND CERTIFICATES.
- 4' PRIVATE HOA EASEMENT OFFSET AND PARALLEL TO R/W.
- 8' PRIVATE UTILITY EASEMENT OFFSET AND PARALLEL TO R/W. SEE PRIVATE EASEMENT DETAIL.

LEGEND

- EXISTING IRON PIPE
- IRON PIPE SET
- CALCULATED POINT
- EXISTING NCGS GRID MONUMENT
- STORM DRAIN EASEMENT
- VARIABLE WIDTH PUBLIC STORM DRAIN EASEMENT
- WATER LINE EASEMENT
- PRIVATE A&U
- PRIVATE ACCESS AND UTILITY EASEMENT

GRAPHIC SCALE
1 inch = 50 ft.

NC GRID (NAD 83)

THE JOHN R. McADAMS COMPANY, INC.
ENGINEERS/PLANNERS/SURVEYORS
RESEARCH TRIANGLE PARK, NC
P.O. BOX 14005 ZIP 27709-4005
(919) 361-5000

REVISIONS:

SURVEY FOR:

BRIAR CHAPEL COMMUNITIES
NEWLAND COMMUNITIES
5850 FAYETTEVILLE ROAD
SUITE 201
DURHAM, NORTH CAROLINA 27713

BRIAR CHAPEL PHASE 4 SECTION 2
SUBDIVISION, EASEMENT DEDICATION
& RIGHT-OF-WAY DEDICATION PLAT

BALDWIN TOWNSHIP, CHATHAM COUNTY, NORTH CAROLINA

PROJECT NO: NEW-05000
FILENAME: NEW-05000-F14
SURVEYOR: JNG
DRAWN BY: EMM
SCALE: 1"=50'
DATE: 08/08/2007
SHEET NO: **2-6**

McADAMS