



STATE OF NORTH CAROLINA  
DEPARTMENT OF TRANSPORTATION  
DIVISION OF HIGHWAYS

MICHAEL F. EASLEY,  
GOVERNOR

LYNDO TIPPETT  
SECRETARY

August 7, 2006

Chatham County

Subject: Subdivision - Plan Review - Shadow Creek off of SR 1740

Roy Mashburn  
Perimeter Realty  
130 Edinburgh - South, Suite 204  
Cary, North Carolina 27511

Dear Mr. Mashburn:

The N. C. Department of Transportation, Division of Highways has reviewed the construction plans as submitted to this office and approval is granted subject to the following stipulations and recommendations:

1. All Construction is to be in accordance with the details and changes in red as shown on the plans. Please note the change in asphalt type. Any asphalt pavement construction after March 1, 2003 shall be of the Superpave type (See Attached).
2. A driveway permit has been issued along with this package.
3. The entire 60' right of way is to be cleared and grubbed throughout the whole phase of the project. Please be aware that the areas within the sight distance quadrants are to be treated as right of way.
4. All soil areas within the proposed right of way and any other soil areas disturbed during construction shall be seeded and mulched immediately upon completion of roadway construction. The seeding shall be done as outlined in the seeding specification attachment.
5. There was crossline drainage proposed on the construction plans. If, however field conditions dictate any changes these shall be made. If any of the property owners desire to pipe their ditches within the proposed N C DOT right of way, please advise them that this work should conform to NC DOT specifications for this type of work (see attached). If any ditches are piped and not done to the NC DOT specifications, this could result in the road not being accepted for addition to the state maintained system of roads. Any ditches piped prior to addition to the state maintained system are subject to an encroachment agreement, as are utility companies, when the road is added.
6. The typicals as shown in the plans, are approved.
7. The Division of Highways will only allow mailboxes, with non-rigid type post, such as 4" x 4" wooden or small diameter metal type on new additions. Brick columns or mailboxes on rigid stands such as block,

P.O. Box 1164, Asheboro, North Carolina 27204  
Phone (336) 629-1423 Fax (336) 629-7228

stone or any other type felt to be a traffic hazard will not be allowed within the right of way. This policy applies to all roads being considered for addition to the State Maintained System.

8. An erosion control plan shall require approval from the Department of Natural Resources and Community Development. The developer should forward this plan to Mr. John Holley, P.E., Department of Natural Resources and Community Development, P.O. Box 27687, Raleigh, N.C. 27611, phone (919) 571-4718 for his review and approval.
9. As this subdivision is proposed to be public and is likely to be requested to be added to the state maintained system of roads, the developer will be responsible for providing a PE Certification, (See Attached) and testing results for base and asphalt density stating that the streets have been built in accordance with the most current "Subdivision Roads: Minimum Construction Standards" manual and with the attached approved plans. Please be advised that this PE Certification does not approve the road for addition to the State Highway System for maintenance. When the proper home density is achieved and roads have been satisfactorily maintained, the developer or property owners must submit Form SR-1, Petition for Road Addition (copy attached to this correspondence), and four (4) copies of the recorded plat to request that the road or roads be added to the State Highway system. Any maintenance problems found when the road is requested to be added must be repaired by the developer prior to the road becoming state maintained. As stated in GS 136-102.6, final acceptance by the Division of Highways of the public streets and placing them on the State highway system for maintenance shall be conclusive proof that the streets have been constructed according to the minimum standards of the board of Transportation.
10. The developer shall comply with all applicable local, state, and federal environmental regulations, and shall obtain all necessary local, state, and federal environmental permits, including, but not limited to, those related to sediment control, stormwater, wetlands, streams, endangered species, and historical sites.
11. In preparing the final plat for certification by this office and subsequent recording, the following information will be incorporated
  - A. The sight distance quadrants at the intersections shall be shown either as an easement or as the property line.
  - B. Easements for drainage throughout the development.
  - C. All roads shall be shown as public and the right of way width shown.

If you have any further questions regarding this matter, please do not hesitate to call this office at (336) 629-1423.

Yours truly,



Reuben Blakley, PE  
District Engineer

REB/saw  
Attachments

cc: Mr. Tim Johnson, P.E., Division Engineer  
File



STATE OF NORTH CAROLINA  
DEPARTMENT OF TRANSPORTATION  
DIVISION OF HIGHWAYS

MICHAEL F. EASLEY  
GOVERNOR

LYNDO TIPPETT  
SECRETARY

PROFESSIONAL ENGINEER CERTIFICATION  
SUBDIVISIONS AND COMMERCIAL DRIVEWAYS  
DIVISION 8, DISTRICT 1

DATE: \_\_\_\_\_

COUNTY: \_\_\_\_\_

SUBDIVISION NAME: \_\_\_\_\_

STREET NAMES	From Sta. No.	To Sta. No.
_____	_____	_____
_____	_____	_____
_____	_____	_____
_____	_____	_____
_____	_____	_____
_____	_____	_____
_____	_____	_____
_____	_____	_____
_____	_____	_____
_____	_____	_____

This is to certify that the above listed roads have been constructed in accordance with the approved plans and all aspects of the most current Subdivision Roads; Minimum Construction Standards manual.

NAME: \_\_\_\_\_  
SIGNATURE: \_\_\_\_\_  
NC PE LICENSE #: \_\_\_\_\_

Professional Engineer Seal

## ATTACHMENT "A"

Seeding and mulching shall be in accordance with Section 880 of the North Carolina Standard Specifications for Roads and Structures, except that Articles 880-8(B) shall not apply. Final determination of soil type shall be made by the Engineer. The following rates in pounds per acre shall apply:

<u>SANDY SOIL</u>	<u>CLAY SOIL</u>
50# - KY 31 Tall Fescue or Alta Tall Fescue	100# - KY 31 Tall Fescue or Alta Tall Fescue
5# - Centipede	15# - Kenblue Bluegrass
50# - Pensacola Bahiagrass	500# - Fertilizer
500# - Fertilizer	4000# - Limestone
4000# - Limestone	

Add 10# Kobe or Korean Lespedeza and 10# Millet to the above mixture from May 1 to August 31.

On cut and fill slopes 2:1 or steeper, add 30# Sericea Lespedeza from January 1 to December 31.

Fertilizer shall be 10-20-20 analysis. Upon written approval of the Engineer, a different analysis of fertilizer may be used provided the 1-2-2 ratio is maintained and the rate of application adjusted to provide the same amount of plant food as a 10-20-20 analysis.

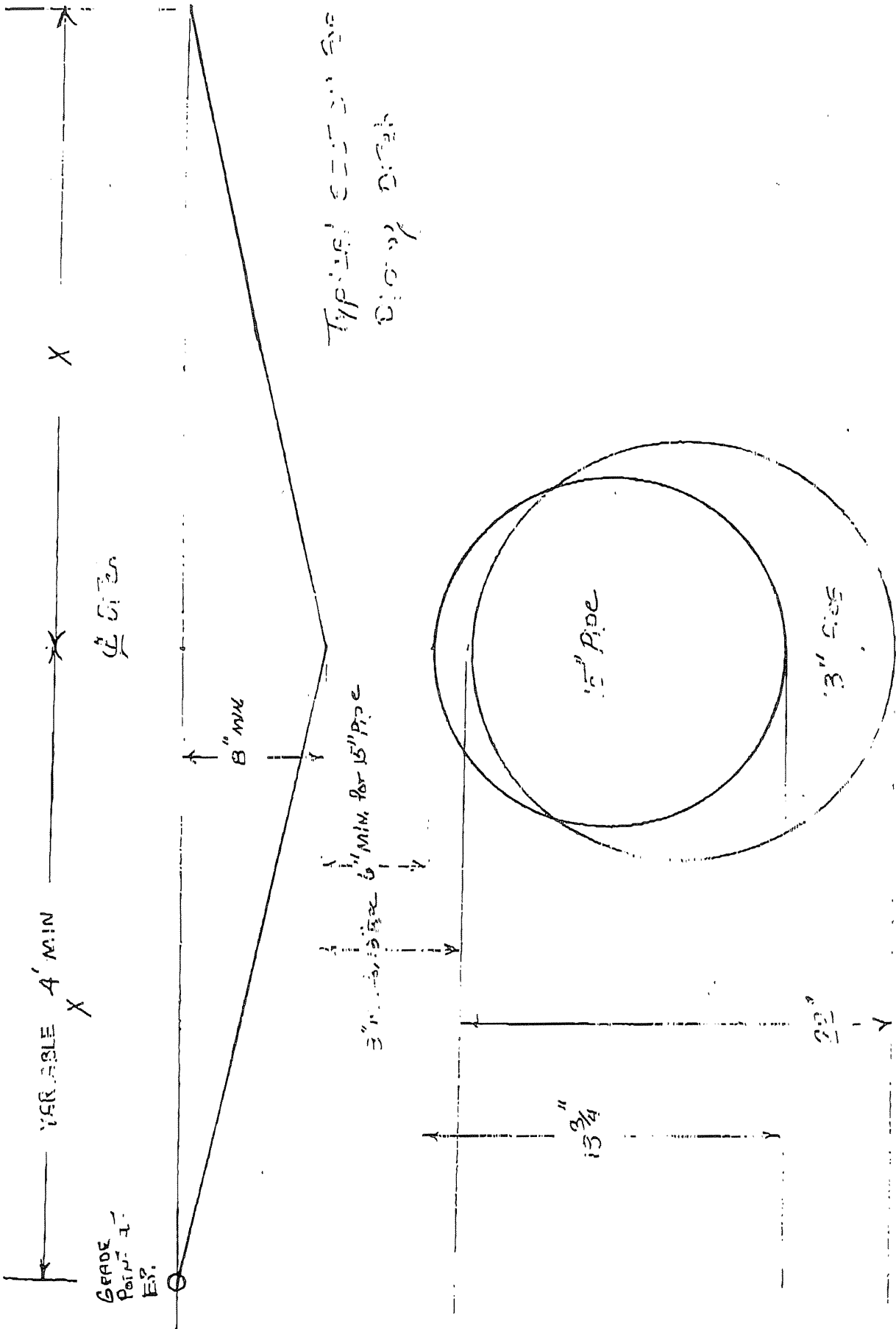

SEE ATTACHED  
DIA. FOR  
DETAILS

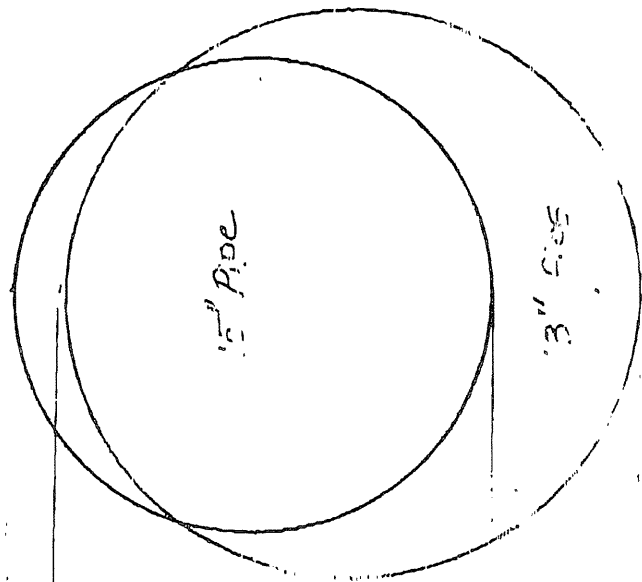

3\"/>

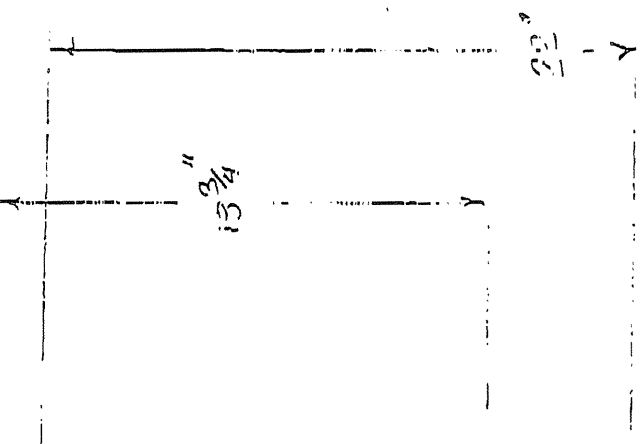

VERIFICATION OF COMPLIANCE WITH  
DEPARTMENT OF ENVIRONMENT AND NATURAL RESOURCES (DENR)

( Check Appropriate Box )

The required permits from the Department of Environment and Natural Resources is not required for this project; however, the current EPA guidelines will be followed during our construction operations.

The required permits from the Department of Environment and Natural Resources has been filed for this project and a copy of the Approval is attached.

The required permits from the Department of Environment and Natural Resources has been filed for this project and a copy of the Approval will be forwarded to the North Carolina Department of Transportation upon receipt.

Project Name: \_\_\_\_\_

Township: \_\_\_\_\_

County: \_\_\_\_\_

Project Engineer: \_\_\_\_\_

Phone No.: \_\_\_\_\_

Project Contact: \_\_\_\_\_

Phone No.: \_\_\_\_\_

Applicants Name: \_\_\_\_\_

Date Submitted : \_\_\_\_\_

( Reference Page 11, Item 10 )