

Wastewater Management System Development

Farrell / Craft Property



Integrated Water Strategies

C. Halford House, PhD, President
Beth Fogleman, M.S. Environmental Chemist
Anjali Munjal, B.A. Research and Education
Tyler P. Nethers, B.A. Research and Site Development

Overview of Integrated Water Strategies

What We Do:

Implement on-site wastewater treatment and rainwater management systems that emulate natural filtration and purification.

System Advantages:

- ◆ Low Impact, On-site Treatment
- ◆ Stormwater and Pollutant Mitigation
- ◆ Water Re-Use and Nutrient Reclamation

Overview of Integrated Water Strategies

Examples of System Design and Components:

- ◆ Constructed Wetlands
- ◆ Vegetated Treatment Berms
- ◆ Rainwater Collection
- ◆ Stormwater Retention

Example of End Use:

- ◆ Drip and Spray Irrigation



System Example:

Montessori School of Raleigh, Middle School Campus

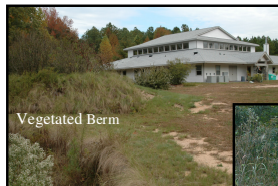

System Example:

Montessori School of Raleigh, Middle School Campus

- Forest Irrigation
- 11 Irrigation Fields at 2845 sq ft per Field
- 6 Spray Irrigation
- 5 Drip Irrigation



System Example:

Montessori School of Raleigh, Middle School Campus



Drip Irrigation

System Example:

Montessori School of Raleigh, Middle School Campus



Spray Irrigation

Farrell Property Proposal: Site Development and Design

Goals:

- Develop Property while Maintaining Greenspace
- Irrigate Forest with a Low Impact Design

Low Impact Forest Irrigation Proposal

Drip: 0' Property Line Setback

Total flow of 2480 GPD at a 0.25 inches per week loading rate

Irrigation Area # 1 = 40,730 sq ft

Irrigation Area # 2 = 70,945 sq ft

Site Location

Intersection of Farrington Point Rd. (SR 1008)
and McGhee Rd, At 354 McGee Rd.



Forest Irrigation Locations

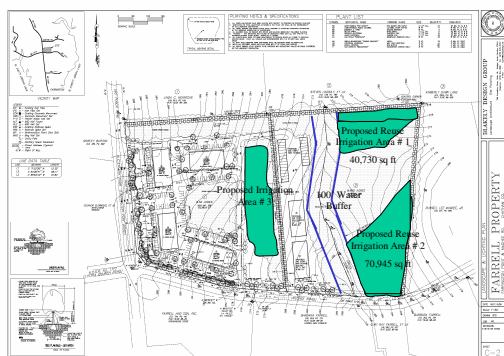

Irrigation Area # 3 - Pine Forest Irrigation Areas # 1, 2 -Oak Forest

Soils Map: Reuse

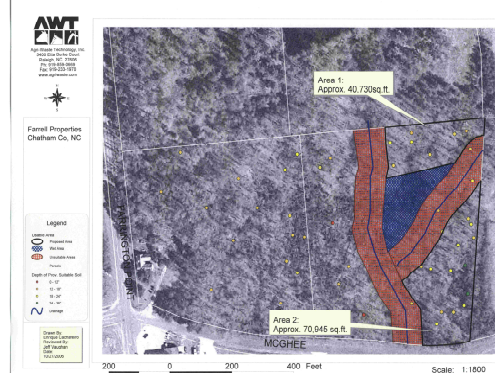

Rainbird Drip Irrigation

- **AG-5/Maxi-Paw®**
Deluxe Pop-Up Impact Rotor
Sprinkler



Xeri-Sprays™ 360° True Spray
Broadcast Emission Devices



Montessori and Farrell Properties: Site Comparison



Montessori School

Similar Tree Characteristics:

Diameter Range--10" to 36"

Species-- Oak, Sweet Gum, Maple, Hickory, Elm



Farrell Property, Proposed Treatment Site

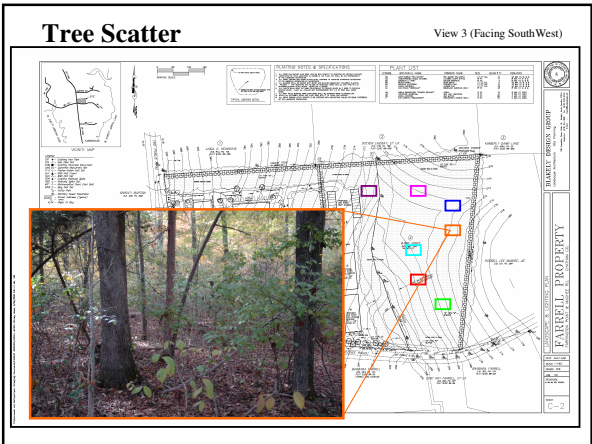
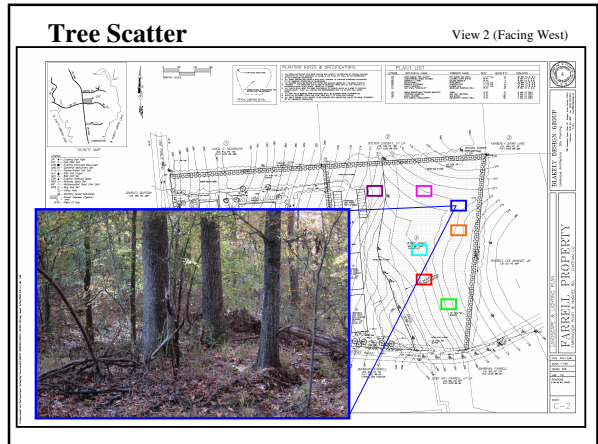
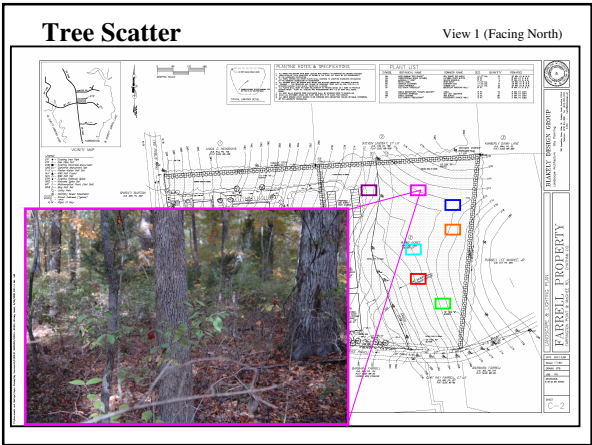
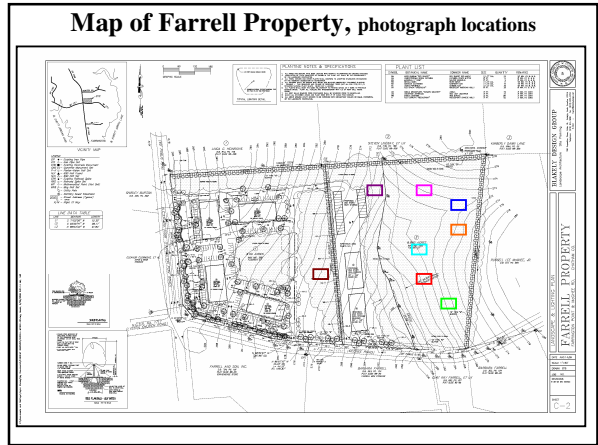

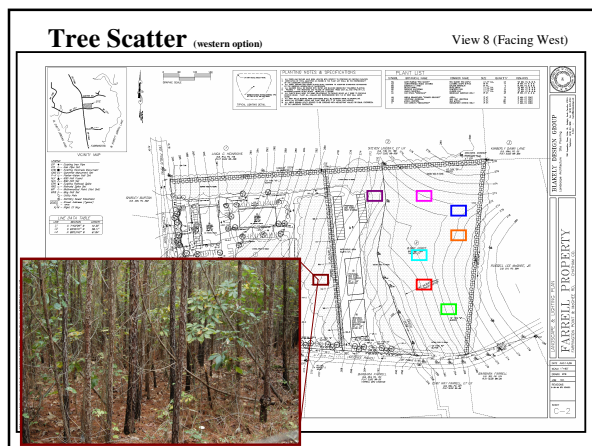
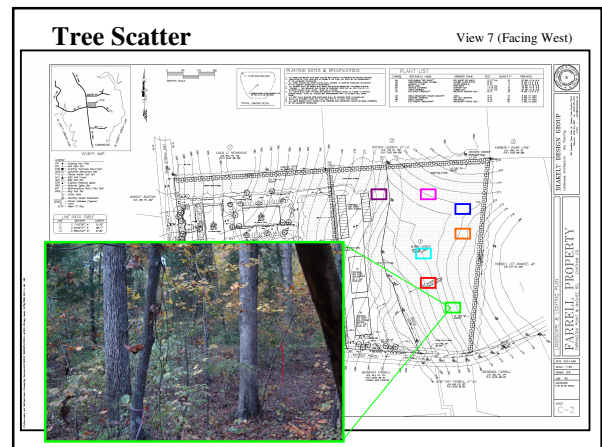
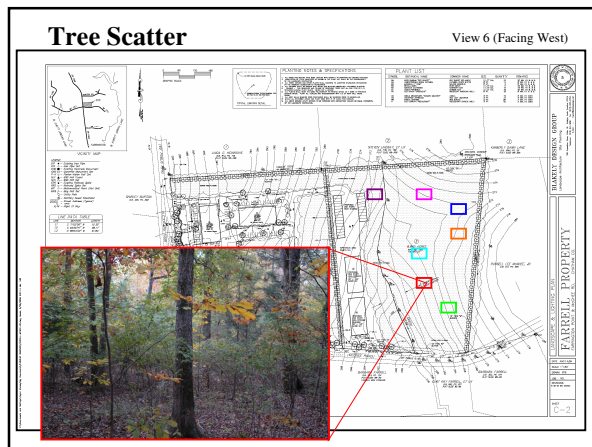
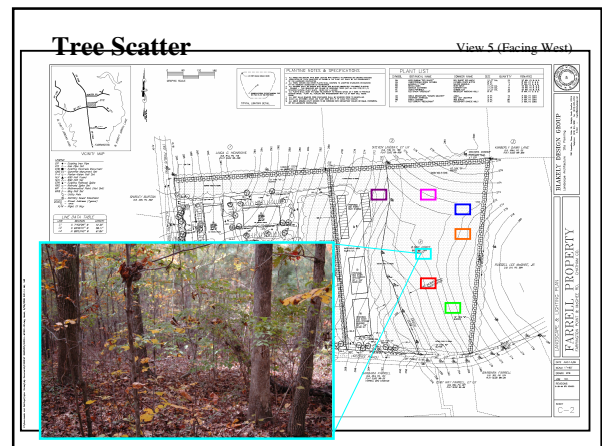
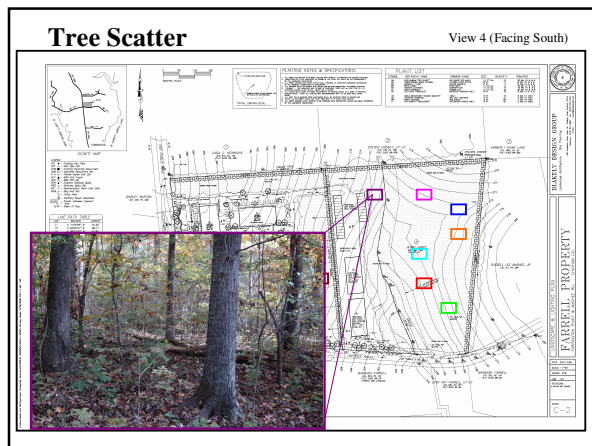



IWS
integrated water strategies

1434 Farrington Road
Apex, NC 27502
919-367-8565