

H:\Projects\Polks Landing\Notes\map 10-2-07.dwg, 10/15/2007 10:21:14 AM, David J. DeSantis
 © JERRY TURNER & ASSOCIATES, INC. THIS DOCUMENT IS THE PROPERTY OF JERRY TURNER & ASSOCIATES, INC. ALL RIGHTS ARE RESERVED AND ANY REPRODUCTION, REPRODUCTION, OR OTHER USE OF THIS DOCUMENT WITHOUT THE PRIOR PERMISSION OF JERRY TURNER & ASSOCIATES IS EXPRESSLY PROHIBITED.

POLKS LANDING SUBDIVISION

SITE DATA

| | |
|-------------------------|------------|
| TOTAL SITE | 110,400 sf |
| DAY CARE | 5,000 sf |
| COMMERCIAL (OUTPARCELS) | 24,800 sf |
| COMMERCIAL (OTHER) | 32,200 sf |
| OFFICE | 48,400 sf |

ZONING FOR 124,000 SF

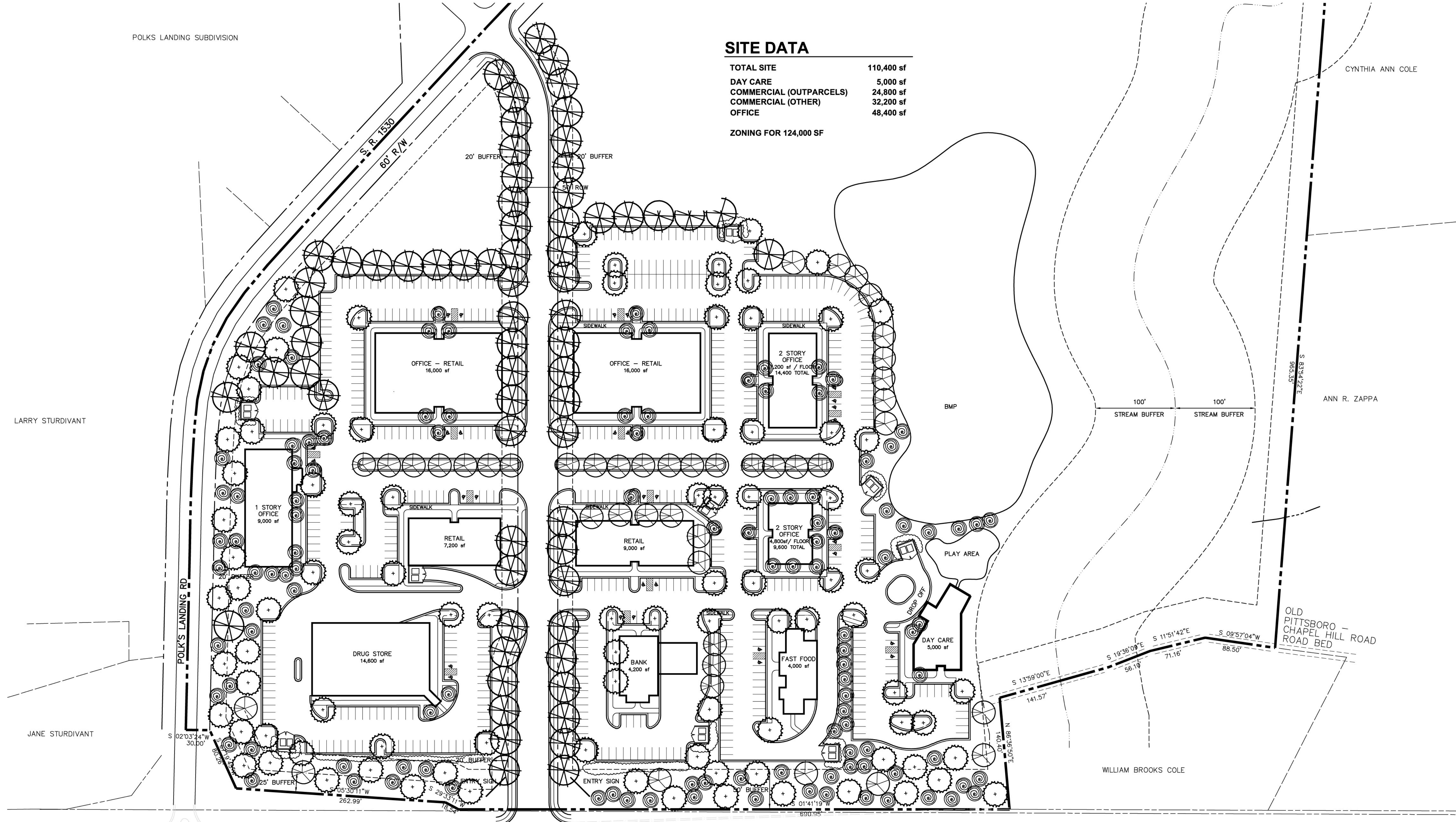

U. S. HIGHWAY 15-501



JERRY TURNER & ASSOCIATES, INC.

Landscape Architecture
Land Planning
Environmental Design

905 Jones Franklin Road
Raleigh, North Carolina 27606
(919) 851-7150 fax. (919) 851-7547

277 S.E. 5th Avenue
Delray Beach, Florida 33483
(561) 276-0453 fax. (561) 272-7593

PROJECT

POLKS LANDING

North Carolina

REVISIONS

DRAWN: _____ CHECKED: _____
 D.J.D. J.T.
 SCALE: _____ DATE: _____
 1" = 60' 09/26/07
 TITLE: _____

MIXED USE SKETCH PLAN

FILE NO. _____ JOB NO. _____
 SEAL _____ SHEET NO. _____

SK-1

