

Chatham County Planning Department

P.O. Box 54  
Pittsboro, NC 27312  
Tel: (919) 542-8204  
Fax: (919) 542-2698

Type of Review  
 Sketch  
 Preliminary  
 Final

MAJOR SUBDIVISION APPLICATION

Name of Subdivision: Chatham Land and Timber Property

Subdivision Applicant: \_\_\_\_\_ Subdivision Owner: \_\_\_\_\_

Name: Mr. Jim Anderson

Name: See attached

Address: Crosland  
4000 Westchase Blvd. Suite 390 Raleigh, NC 27607

Address: \_\_\_\_\_

Phone:(W) 919-754-8990

Phone:(W) \_\_\_\_\_

Phone:(H) \_\_\_\_\_ Fax: 919-754-8995

Phone:(H) \_\_\_\_\_ Fax: \_\_\_\_\_

E-Mail janderson@crosland.com

E-Mail \_\_\_\_\_

Township: 2 Zoning: RA-40

P. I. N. # 9763-77-2294.00

Flood Map # \_\_\_\_\_ Zone: \_\_\_\_\_

Parcel # 3025

Watershed: WS-IV-PA

Existing Access Road: S.R. # 1711

S.R. road name Bynum Ridge

Total Acreage: 302.1

Total # of Lots: 169

Min. Lot Size: 40,000SF

Ph. I Acreage \_\_\_\_\_

Ph. I # of lots See Attached

Max. Lot Size: N/A

Ph. II Acreage \_\_\_\_\_

Ph. II # of lots \_\_\_\_\_

Avg. Lot Size: \_\_\_\_\_

Ph. III Acreage \_\_\_\_\_

Ph. III # of lots \_\_\_\_\_

Type of new road:  Private/ Length \_\_\_\_\_

Public/ Length 15,300SF

Road Surface:

paved  
 gravel

Water System:

individual wells  
 community wells  
 public system  
name \_\_\_\_\_

Sewer System:

septic systems  
 community system  
 public system  
name \_\_\_\_\_

List other facilities: commercial, recreation, etc., and the approximate acreage or square footage:

Community Open Space (+/- 88.9Ac.) Amenity Area (+/- 4.99)

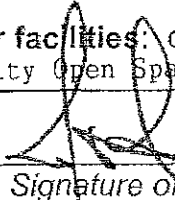
  
Signature of Applicant

Date 5/12/06

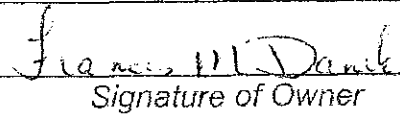
 Date May 12, 2006  
Signature of Owner

For Office Use Only:

Notes: \_\_\_\_\_

Approved by County Commissioners: Sketch \_\_\_\_\_  
Preliminary \_\_\_\_\_  
Final \_\_\_\_\_

Payment: Date \_\_\_\_\_ Amount: \$ \_\_\_\_\_

Subdivision Owners:

Margaret Browning  
2313 Byrd Street  
Raleigh, NC 27608  
919.510.8196

Chatham Land & Timber Management, LLC  
981 Old Graham Road  
Pittsboro, NC 27312  
919.542.3461

## PHASING PLAN

Ph. I # of lots = 49

Ph. II # of lots = 40

Ph. III # of lots = 40

Ph. IV # of lots = 40

ADJACENT LAND OWNERS

1. PIN 9763-69-3534.000 CHARLES T. PACE ETAL 319 YADKIN DRIVE RALEIGH, NC 27609	10. PIN 9763-84-5702.000 CHERYL S. AND WALTER THOMAS KLEIN 1718 BYNUM RIDGE RD. PITTSBORO, NC 27312
2. PIN 9773-07-4781.000 JOHN J. BURNETTE 8119 MCARTHUR PARK DR. EFLAND, NC 27243	11. PIN 9763-74-9835.000 RANDALL A. FIELDS AND JANET A. COLM 44 POKEBERRY LANE PITTSBORO, NC 27312
3. PIN 9773-07-2091.000 CHRISTOPHER BURNETTE, TAYLOR ROBBIN B. AND CHERYL B. HAINS 2817 MT. GILEAD CHURCH RD. PITTSBORO, NC 27312	12. PIN 9763-74-7913.000 KENNETH A. AND LIBBY S. HAMILTON 1530 BYNUM RIDGE RD. PITTSBORO, NC 27312
4. PIN 9773-06-9883.000 RICHARD LYNN BURNETTE 2675 MT. GILEAD CHURCH RD. PITTSBORO, NC 27312	13. PIN 9763-74-3989.000 ROLAND AND KATHRYN J. MCREYNOLDS 1424 BYNUM RIDGE RD. PITTSBORO, NC 27312
5. PIN 9763-96-1448.000 RUSSELL D. AND MARLINA L. ROBERSON 6655 64 WEST PITTSBORO, NC 27312	14. PIN 9763-65-6034.000 JOANNE J. ROBB 1396 BYNUM RIDGE RD. PITTSBORO, NC 27312
6. PIN 9763-96-7393.000 RICHARD DANIEL CAMPBELL 2675 MT. GILEAD CHURCH RD. PITTSBORO, NC 27312	15. PIN 9763-54-7344.000 POLK SULLIVAN LLC AND CHATHAM PARTNERS LLC 1000 ST. ALBANS DR., STE. 400 RALEIGH, NC 27609
7. PIN 9763-96-1047.000 KELLY LYNN POPP VICKERS AND ERIC EUGENE VICKERS 120 HIDDEN VALLEY CHAPEL HILL, NC 27516	16. PIN 9763-26-3783.000 WILLIAMS FAMILY LTD PARTNERSHIP C/O TED L. WILLIAMS 4210 TROTTER RIDGE RD. DURHAM, 27707
8. PIN 9773-05-6540.000 JOHN J. BURNETTE LIFE ESTATES 8119 MCARTHUR PARK DR. EFLAND, NC 27243	17. PIN 9763-38-1356.000 JAMES LOWELL WILLIAMS PO BOX 156 BYNUM, NC 27228-0156
9. PIN 9763-84-9616.000 AMY K. WHINERY AND STEVE OSBORNE 101 HUDSON HILLS PITTSBORO, NC 27312	(END OF LIST)

MAP OF ADJOINING OWNERS

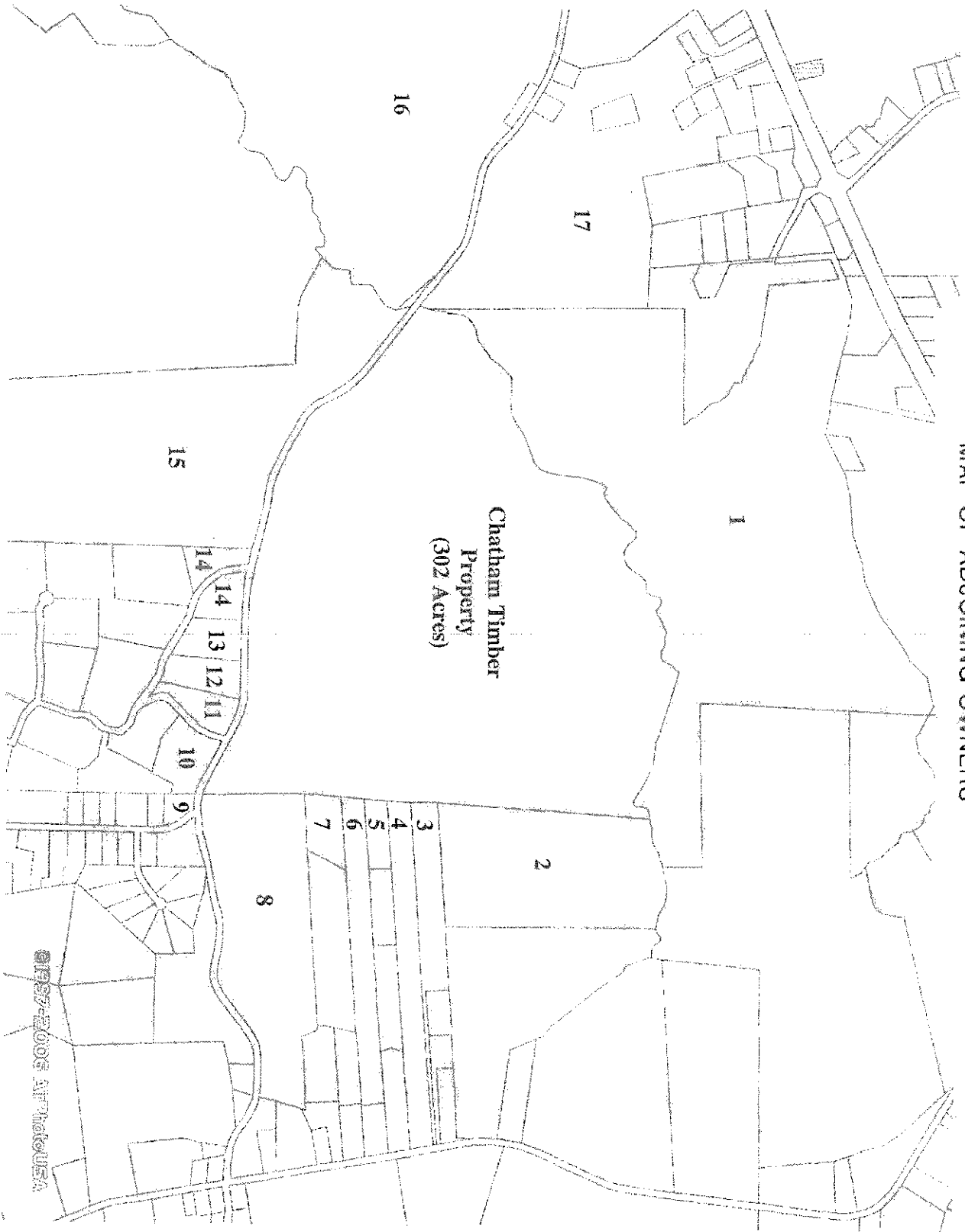

01927-2006 AIR PHOTOGRAPH