

**DEVELOPER:**

MacGregor Development Company  
201 Shannon Oaks Circle, Suite 201  
Cary, North Carolina 27511

**CONSULTANTS:**

Attorneys ..... Bradshaw & Robinson, LLP  
Civil Engineer/Land Planner ..... C. E. Group, Inc.  
Wastewater Treatment Design ..... W. Lee Fleming, Jr. Engineering  
Hydrologist ..... Edwin Andrews & Associates, P.C.  
Ecologist/Soils Evaluation ..... Soil & Environmental Consultants, P.A.  
Surveyor ..... Smith and Smith Surveyors  
Transportation Engineer ..... Ramey Kemp & Associates

\* DENOTES LOTS WITH 200'  
NO BUILD SETBACK FROM  
PROJECT BOUNDARY

\*\* DENOTES LOTS WITH 100'  
NO BUILD SETBACK FROM  
PROJECT BOUNDARY

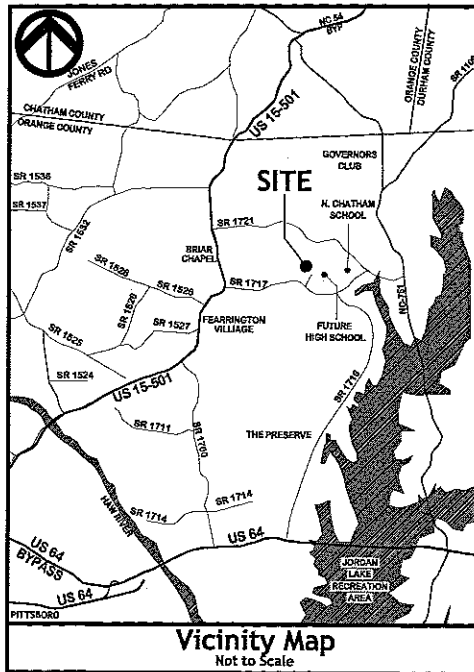

**SITE SUMMARY:**

**SINGLE FAMILY HOMESITES (180 TOTAL)**  
93 Estate Lots  
34 Neighborhood Lots  
53 Village Lots

**TOTAL SITE AREA (294.32 ACRES)**

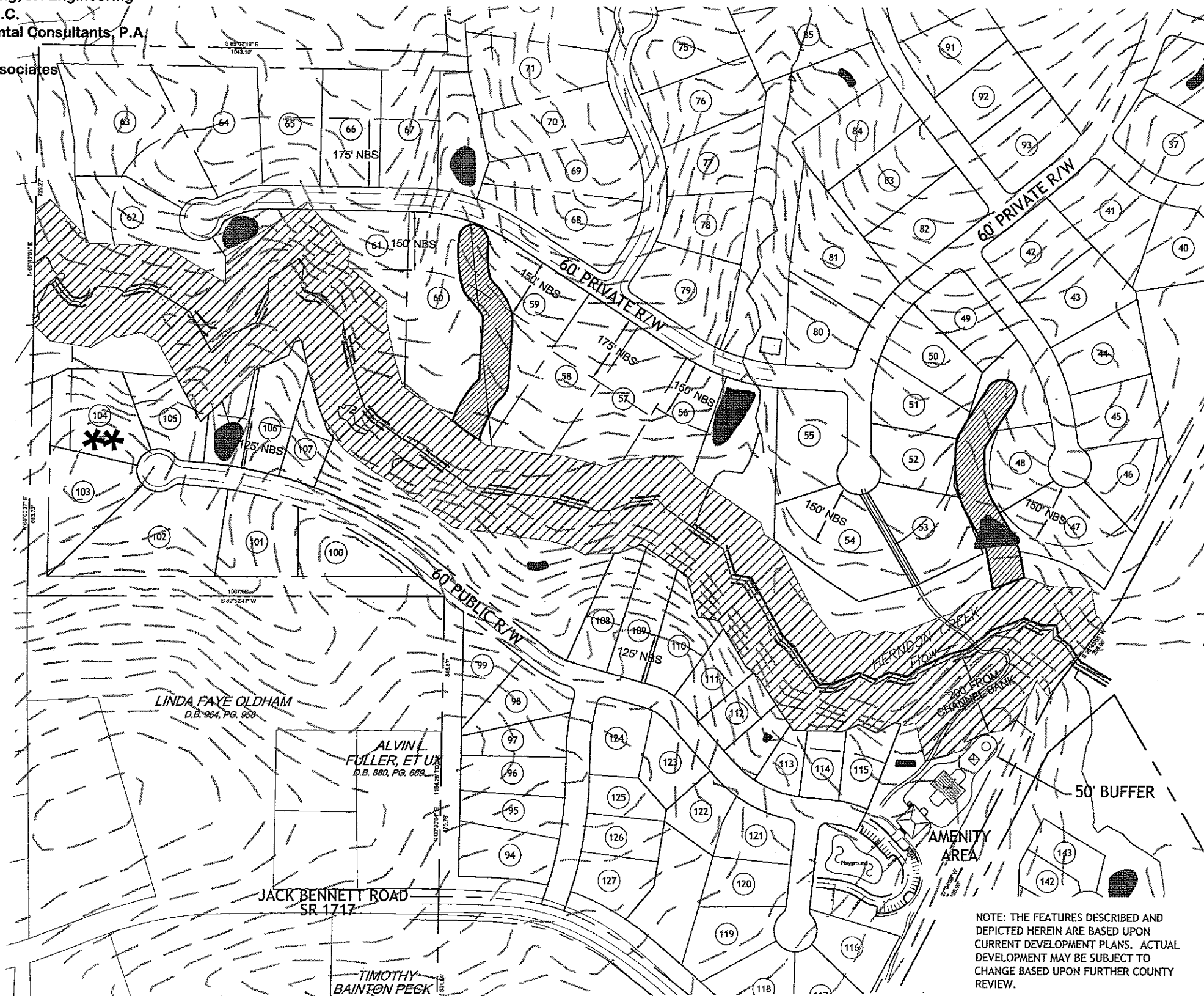

NOTE: THE FEATURES DESCRIBED AND  
DEPICTED HEREIN ARE BASED UPON  
CURRENT DEVELOPMENT PLANS. ACTUAL  
DEVELOPMENT MAY BE SUBJECT TO  
CHANGE BASED UPON FURTHER COUNTY  
REVIEW.

**BOOTH MOUNTAIN, CHATHAM COUNTY, NORTH CAROLINA**

Booth Mountain Community

**REVISED SKETCH MASTER PLAN  
AMENITY RELOCATION  
EXHIBIT MAP**



NORTH



SCALE: 1" = 300'



**C.E. Group, Inc.**  
LAND PLANNING  
CIVIL ENGINEERING  
CONSTRUCTION MANAGEMENT  
11000 Regency Parkway, Suite 410, Cary, N.C. 27511  
Voice (919) 367-8790 Fax (919) 367-8791

February 20, 2006