

NOTE: THE FEATURES DESCRIBED AND DEPICTED HEREIN ARE BASED UPON CURRENT DEVELOPMENT PLANS. ACTUAL DEVELOPMENT MAY BE SUBJECT TO CHANGE BASED UPON FURTHER COUNTY REVIEW.

**DEVELOPER:**

MacGregor Development Company  
201 Shannon Oaks Circle, Suite 201  
Cary, North Carolina 27511

**CONSULTANTS:**

Attorneys ..... Bradshaw & Robinson, LLP  
Civil Engineer/Land Planner ..... C. E. Group, Inc.  
Wastewater Treatment Design ..... W. Lee Fleming, Jr. Engineering  
Hydrologist ..... Edwin Andrews & Associates, P.C.  
Ecologist/Soils Evaluation ..... Soil & Environmental Consultants, P.A.  
Surveyor ..... Smith and Smith Surveyors  
Transportation Engineer ..... Ramey Kemp & Associates

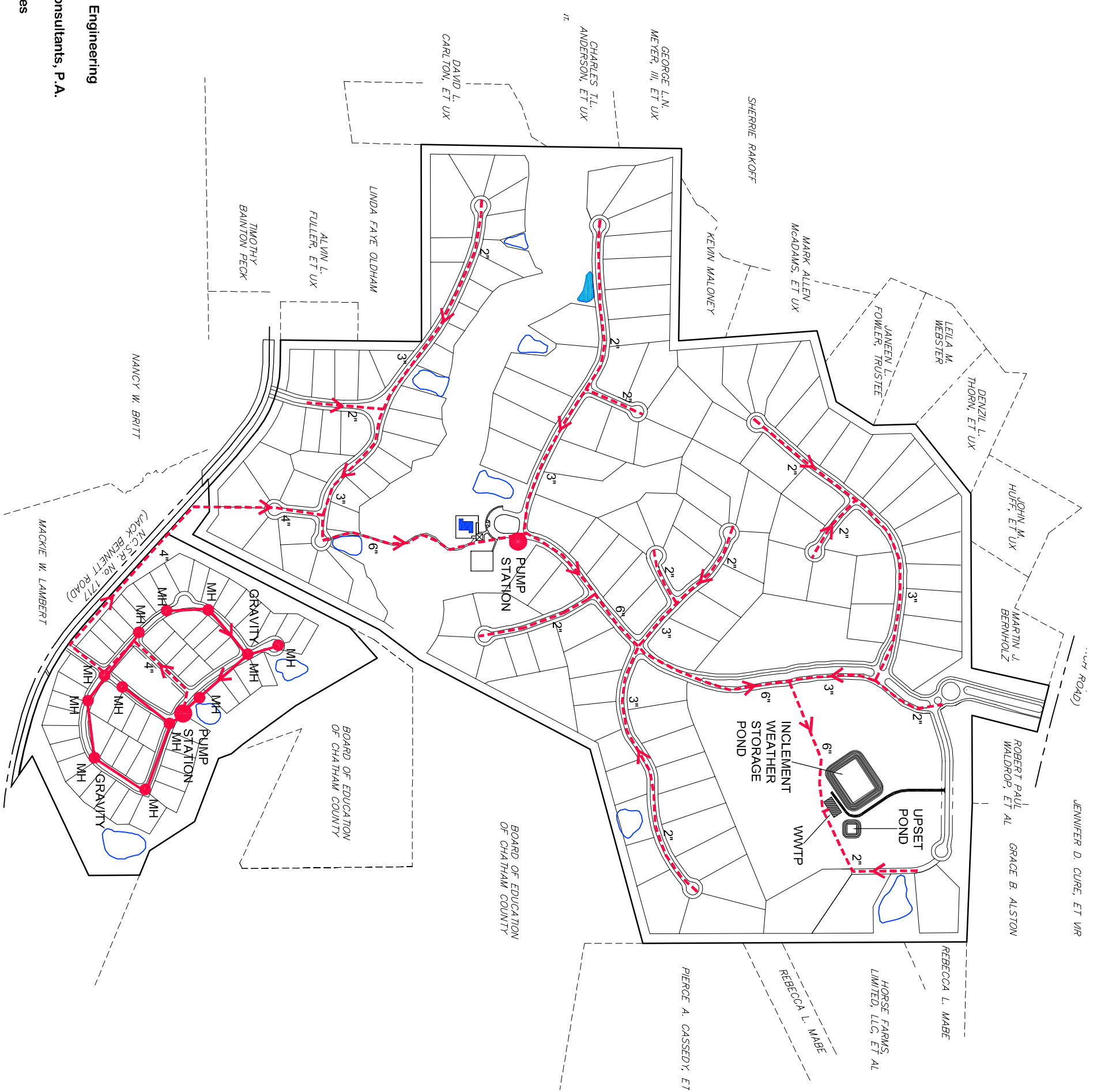

**BOOTH MOUNTAIN, CHATHAM COUNTY, NORTH CAROLINA**

Booth Mountain Community  
**Utility Plan  
Sewer  
EXHIBIT MAP**

August 2004



**NORTH**



SCALE: 1" = 600'



LAND USE EVALUATION  
CIVIL ENGINEERING  
CONSTRUCTION MANAGEMENT  
1051 Pemberton Hill Road, Suite 201, Apex, N.C. 27502  
voice (919) 367-8790- fax (919) 367-8791