

LEGEND

-  Proposed Water Quality Pond/Feature
-  200' Buffer (100' each side)

NOTE: THE FEATURES DESCRIBED AND DEPICTED HEREIN ARE BASED UPON CURRENT DEVELOPMENT PLANS. ACTUAL DEVELOPMENT MAY BE SUBJECT TO CHANGE BASED UPON FURTHER COUNTY REVIEW.

DEVELOPER:

MacGregor Development Company
201 Shannon Oaks Circle, Suite 201
Cary, North Carolina 27511

CONSULTANTS:

Attorneys Bradshaw & Robinson, LLP
Civil Engineer/Land Planner C. E. Group, Inc.
Wastewater Treatment Design W. Lee Fleming, Jr. Engineering
Hydrologist Edwin Andrews & Associates, P.C.
Ecologist/Soils Evaluation Soil & Environmental Consultants, P.A.
Surveyor Smith and Smith Surveyors
Transportation Engineer Ramey Kemp & Associates

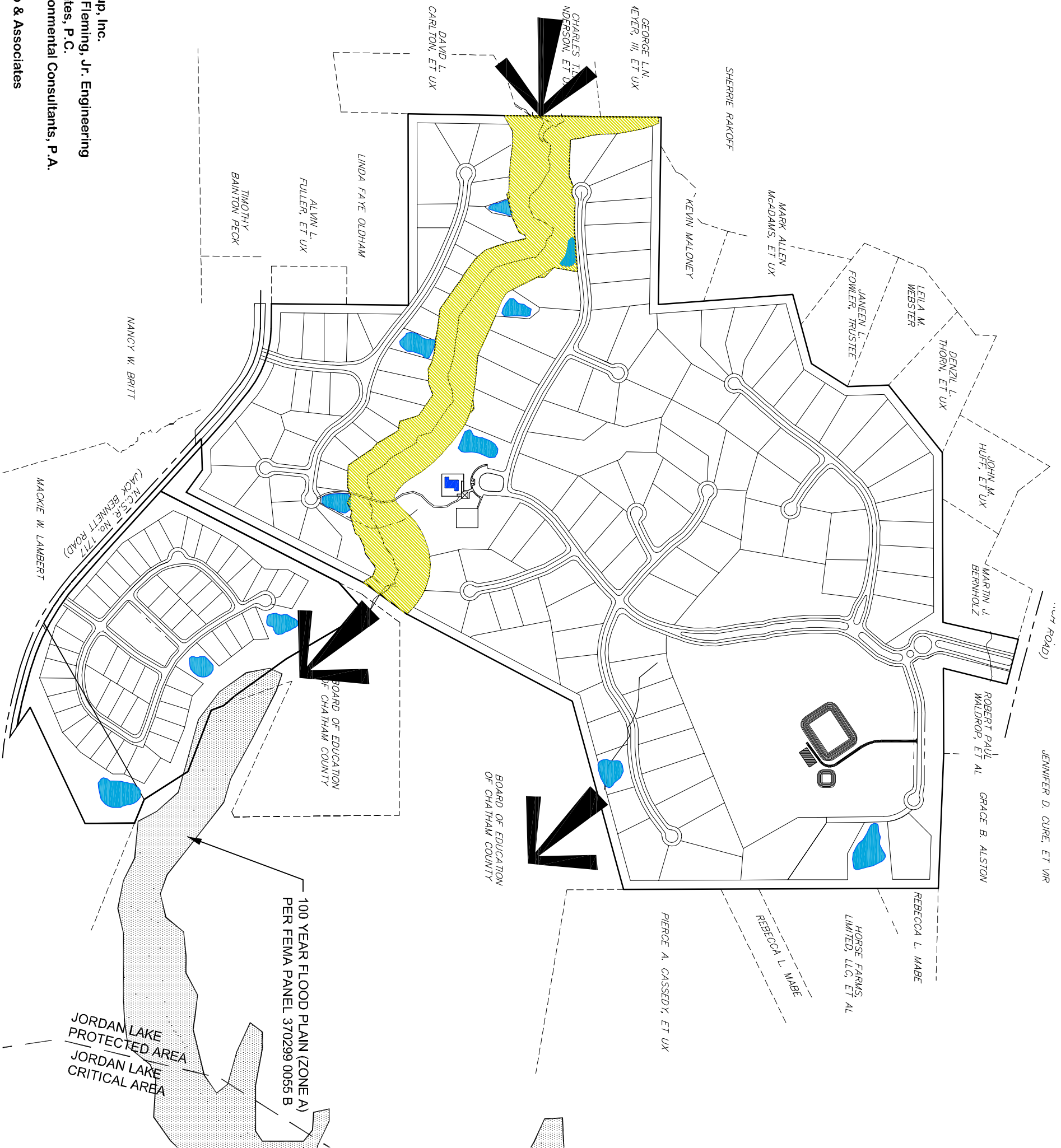

BOOTH MOUNTAIN, CHATHAM COUNTY, NORTH CAROLINA

Booth Mountain Community

**Stormwater
Master Plan
EXHIBIT MAP**

August 2004



NORTH

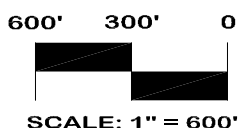

SCALE: 1" = 600'



LAND USE EVALUATION
CIVIL ENGINEERING
CONSTRUCTION MANAGEMENT

1051 Pemberton Hill Road, Suite 201, Apex, N.C. 27502
voice (919) 367-8790- fax (919) 367-8791