

Legend

- Proposed Monitoring Well
- Proposed Dry/Wet Water Quality Feature
- ~ Existing Wetlands

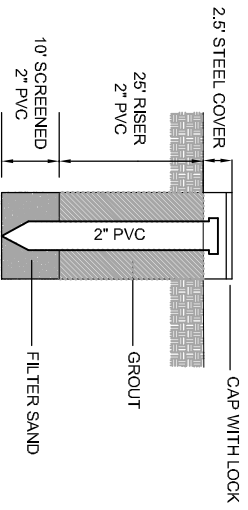

TYPICAL MONITORING WELL

NOTE: THE FEATURES DESCRIBED AND DEPICTED HEREIN ARE BASED UPON CURRENT DEVELOPMENT PLANS. ACTUAL DEVELOPMENT MAY BE SUBJECT TO CHANGE BASED UPON FURTHER COUNTY REVIEW.

DEVELOPER:

MacGregor Development Company
201 Shannon Oaks Circle, Suite 201
Cary, North Carolina 27511

CONSULTANTS:

Attorneys Bradshaw & Robinson, LLP
Civil Engineer/Land Planner C. E. Group, Inc.
Wastewater Treatment Design W. Lee Fleming, Jr. Engineering
Hydrologist Edwin Andrews & Associates, P.C.
Ecologists/Soils Evaluation Soil & Environmental Consultants, P.A.
Surveyor Smith and Smith Surveyors
Transportation Engineer Ramey Kemp & Associates

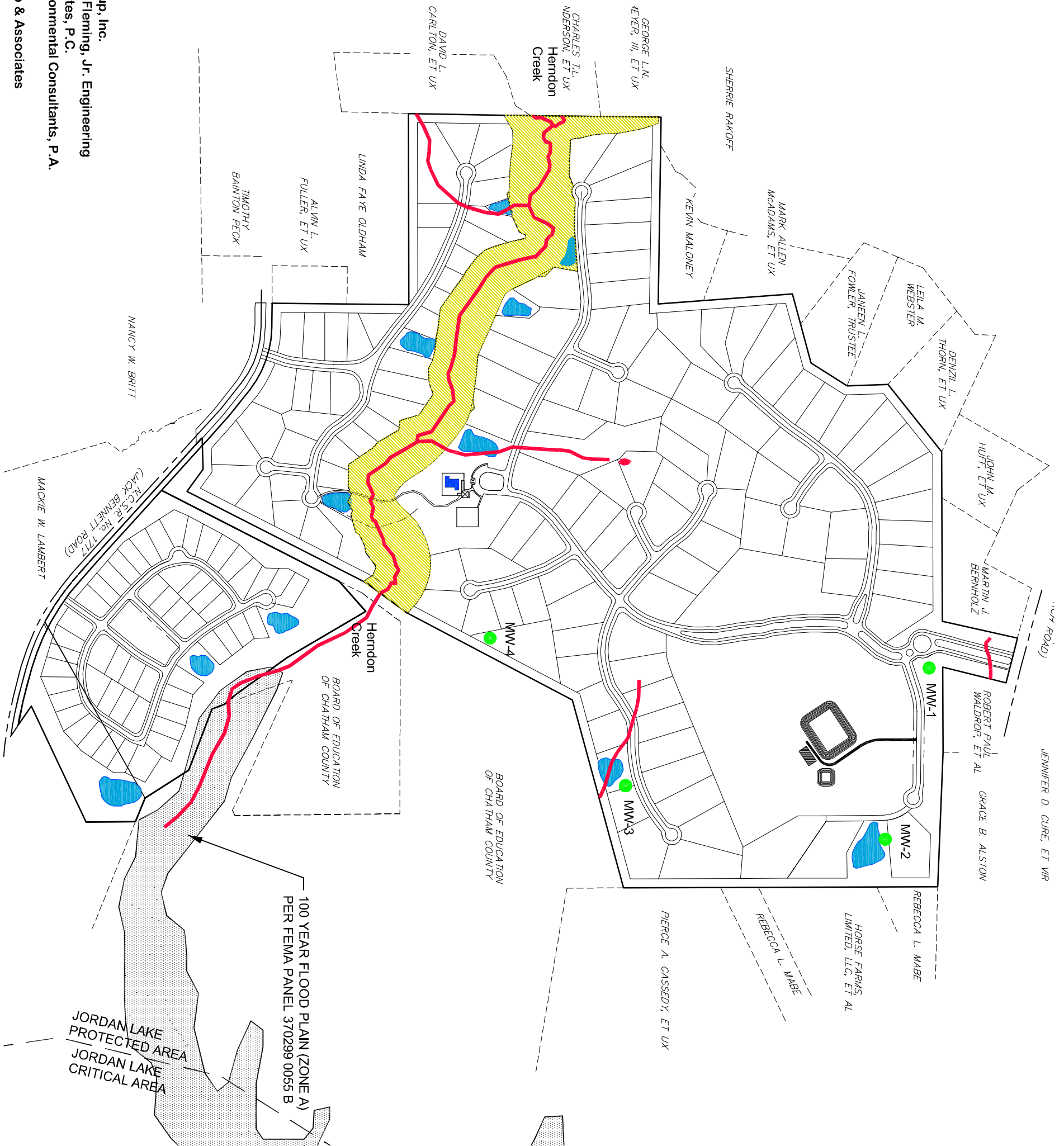

BOOTH MOUNTAIN, CHATHAM COUNTY, NORTH CAROLINA

**Booth Mountain Community
Subsurface
Monitoring Plan
EXHIBIT MAP**

August 2004



NORTH

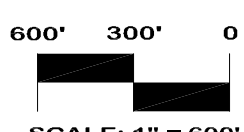

SCALE: 1" = 600'



LAND USE EVALUATION
CIVIL ENGINEERING
CONSTRUCTION MANAGEMENT
1051 Pemberton Hill Road, Suite 201, Apex, N.C. 27502
voice (919) 367-8790- fax (919) 367-8791