

HERNDON CREEK

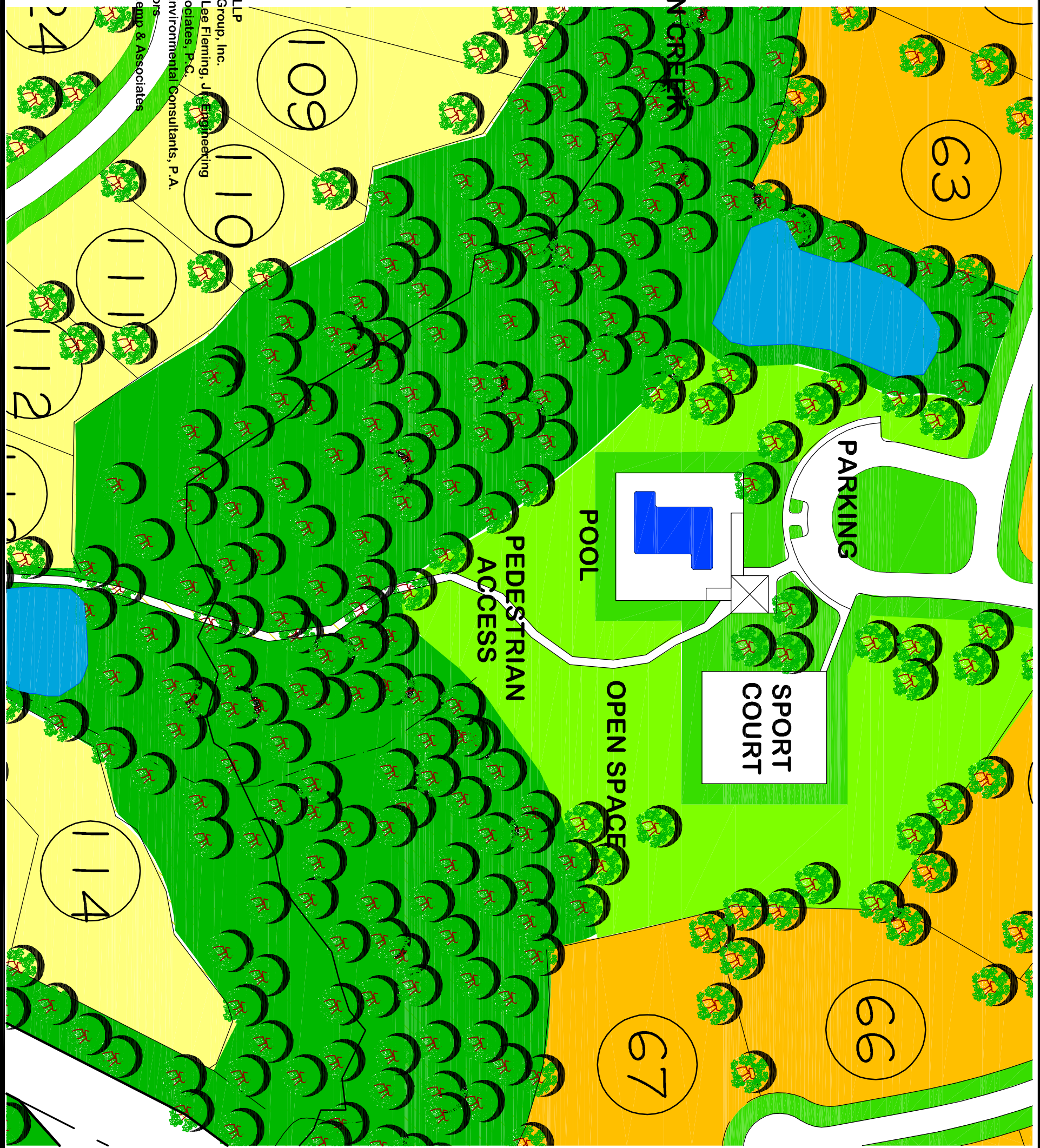

DEVELOPER:
 MacGregor Development Company
 201 Shannon Oaks Circle, Suite 201
 Cary, North Carolina 27511

CONSULTANTS:
 Attorneys Bradshaw & Robinson, LLP
 Civil Engineer/Land Planner C. E. Group, Inc.
 Wastewater Treatment Design W. Lee Fleming, Jr. Engineering
 Hydrologist Edwin Andrews & Associates, P.C.
 Ecologist/Soils Evaluation Soil & Environmental Consultants, P.A.
 Surveyor Smith and Smith Surveyors
 Transportation Engineer Ramey Kemp & Associates

NOTE: THE FEATURES DESCRIBED AND
 DEPICTED HEREIN ARE BASED UPON
 CURRENT DEVELOPMENT PLANS. ACTUAL
 DEVELOPMENT MAY BE SUBJECT TO
 CHANGE BASED UPON FURTHER COUNTY
 REVIEW.

BOOTH MOUNTAIN, CHATHAM COUNTY, NORTH CAROLINA

Booth Mountain Community
RECREATION AMENITY PLAN

EXHIBIT MAP

August 2004



NORTH

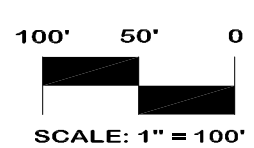

CE Group, inc.

LAND USE EVALUATION
 CIVIL ENGINEERING
 CONSTRUCTION MANAGEMENT
 1051 Pemberton Hill Road, Suite 201, Apex, N.C. 27502
 voice (919) 367-8790- fax (919) 367-8791